

Mini-Com® One-Port Adapters

specifications

Mini-Com® One-Port Adapters shall allow a variety of Mini-Com® Modules to securely mount to select third party frames and faceplates. Select adapters shall snap to specific modular furniture systems and/or unexpected areas that require an additional port.



technical information

Mounting options:	Snap in feature, mounts to a variety of faceplates and openings
Packaging:	Supplied in packages of 10 units per bag
Cutout dimensions:	CMAA1**-X: 1 in. x 1 in. (25mm x 25mm) Panel thickness: 0.06 in. x 0.08 in. (1.5mm x 2.0mm) CMNZA**-X: 0.827 in. x 0.827 in. (21mm x 21mm) Panel thickness: 0.046 in. x 0.056 in. (1.17mm x 1.42mm)
Material:	ABS

key features and benefits

Modular	Accepts all Mini-Com® Modules, which snap in and out for easy moves, adds and changes
Compatibility	Adapters are compatible with a variety of third-party frames and/or openings
Low profile design	Mounts flush with faceplate or opening

applications

Panduit® offers a selection of one-port adapters that accept all Mini-Com® Modules. Clipsal adapters are available in two designs, one compatible with iconic series and one with 30 series faceplates. Two additional adapters allow Mini-Com® Modules to mount to select modular furniture systems common in Australia.

These adapters can also be used in unusual areas where an additional port is required and can be attained by cutting a square opening that meets specified dimensions.

Adapters

Clipsal 30 Series & HPM:	CAFPA**-X
Clipsal Iconic:	CIFPA**-X
Australian adapter:	CMAA1^X
New Zealand:	CMNZA**-X

**BL (Black) or WH (White)

^BL (Black), WH (White) or IW (Off White)

Mini-Com® One-Port Adapters

CAFPA -X**

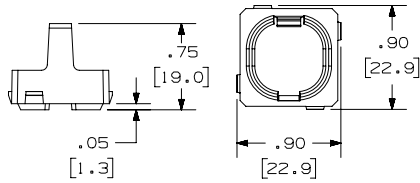

CIFPA -X**

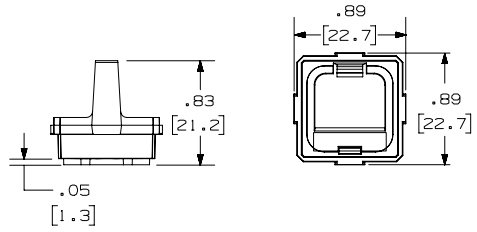

CMAA1^ -X

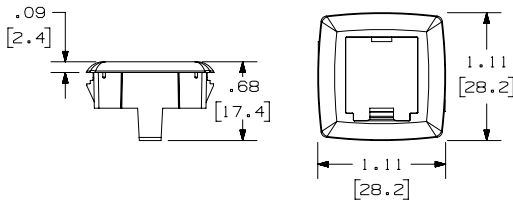

CMNZA -X**

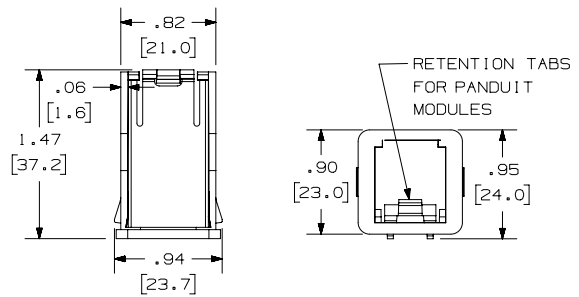

Dimensions are in inches. (Dimensions in brackets are metric).

WORLDWIDE SUBSIDIARIES AND SALES OFFICES

PANDUIT US/CANADA
Phone: 800.777.3300

PANDUIT EUROPE LTD.
London, UK
Phone: 44.20.8601.7200

PANDUIT SINGAPORE PTE. LTD.
Republic of Singapore
Phone: 65.6305.7575

PANDUIT JAPAN
Tokyo, Japan
Phone: 81.3.6863.6000

PANDUIT LATIN AMERICA
Guadalajara, Mexico
Phone: 52.33.3777.6000

PANDUIT AUSTRALIA PTY. LTD.
Victoria, Australia
Phone: 61.3.9794.9020

For a copy of Panduit product warranties, log on to www.panduit.com/warranty

For more information

Visit us at www.panduit.com
Contact Customer Service by email: cs@panduit.com
or by phone: 800.777.3300



© 2020 Panduit Corp.
ALL RIGHTS RESERVED.
COSP500--WW-ENG
11/2020