

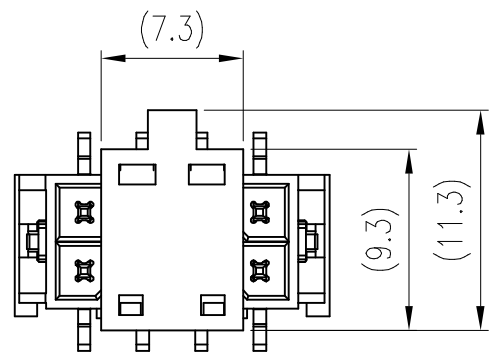

Amphenol
FCi

© 2016 AFci

© 2016 AFci

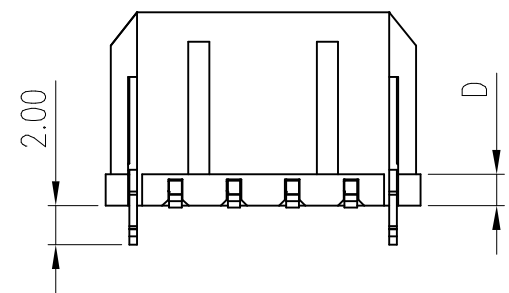
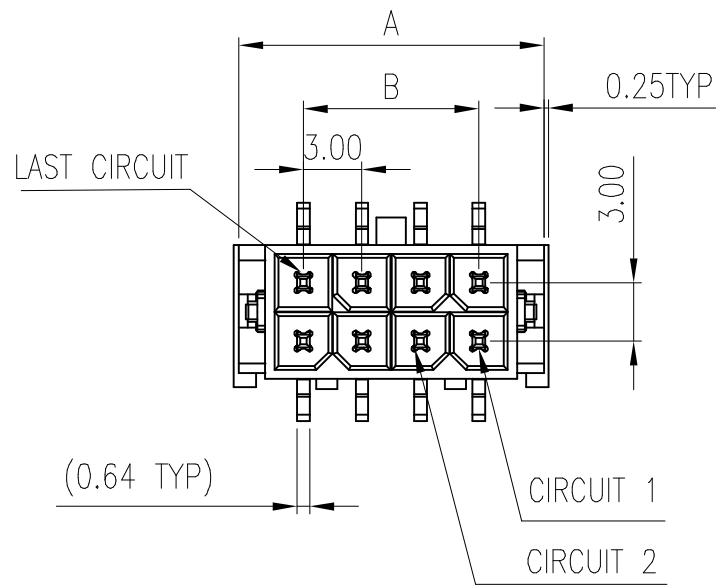

SHOWN WITH DISPOSABLE CAP

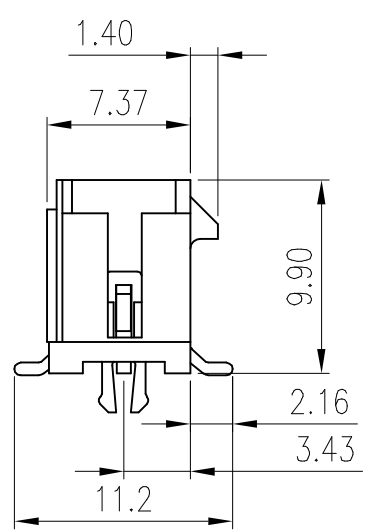

NOTE:

1. MATERIAL:
HOUSING: LCP, UL94V-0, HALOGEN FREE, COLOR: BLACK
CONTACT: COPPER ALLOY.
HOLD DOWN: COPPER ALLOY
2. CONTACT FINISH: NICKEL 50u" Min. UNDERPLATED OVERALL.
OPTIONAL PLATING ON CONTACT AREA, 100u" MIN MATTE TIN ON SOLDER TAIL.
HOLD DOWN: 100u" MIN MATTE TIN OVER 50u" Min. NICKEL
3. REFER GS-20-0399 APPLICATION SPECIFICATION FOR MATING CONNECTOR.
4. PRODUCT SPECIFICATION: GS-12-1177.
5. TAPE & REEL PACKAGE SPECIFICATION: GS-14-2359.
6. APPLICATION SPECIFICATION: GS-20-0399
7. THE HOUSING WILL WITHSTAND EXPOSURE TO 260°C PEAK TEMPERATURE FOR 10 SECONDS IN A REFLOW OVEN.
8. LEAD FREE PRODUCTS MEET EUROPEAN UNION DIRECTIVES AND OTHER COUNTRY REGULATIONS AS DESCRIBED IN GS-47-0004
9. PART NUMBER SCHEME:
10137927- XX X X LF
 - POS. CODE:
 - 02: 2 POS
 - 04: 4 POS
 - 8: 8 POS
 - 24: 24 POS
 - LEAD FREE
 - GLOW WIRE COMPATIBLE:
 - 1: COMPATIBLE
 - 2: NON-COMPATIBLE
 - PLATING CODE:
 - 1: 100u" Min. MATTE TIN OVERALL
 - 2: GOLD FLASH ON CONTACT AREA, 100u"Min MATTE TIN ON TAIL
 - 3: 15u"Min Au ON CONTACT AREA, 100u"Min MATTE TIN ON TAIL
 - 4: 30u"Min Au ON CONTACT AREA, 100u"Min MATTE TIN ON TAIL

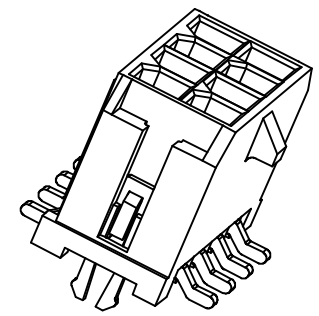

P/N & DIMENSION TABLE

PART NO:	POS	A	B	C	D
10137927-02XXLF	02	6.65	NA	4.30	6.74
10137927-04XXLF	04	9.65	3.00	7.30	
10137927-06XXLF	06	12.65	6.00	10.30	1.60
10137927-08XXLF	08	15.65	9.00	13.30	
10137927-10XXLF	10	18.65	12.00	16.30	
10137927-12XXLF	12	21.65	15.00	19.30	
10137927-14XXLF	14	24.65	18.00	22.30	
10137927-16XXLF	16	27.65	21.00	25.30	
10137927-18XXLF	18	30.65	24.00	28.30	
10137927-20XXLF	20	33.65	27.00	31.30	
10137927-22XXLF	22	36.65	30.00	34.30	
10137927-24XXLF	24	39.65	33.00	37.30	

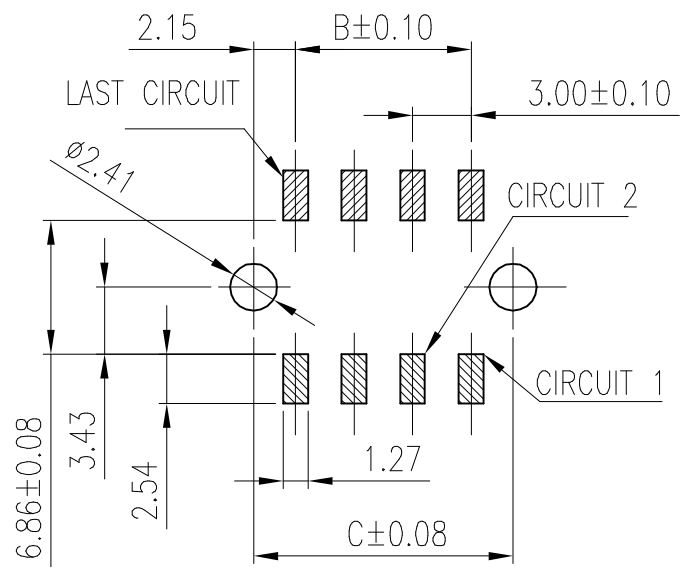

RECOMMENDED PCB LAYOUT
 GENERAL TOLERANCE: ±0.05
 PCB THICKNESS=1.60MM

mat'l. code		surface		tolerance		projection		product family	
		ISO 1302		ISO 406		ISO 1101		MINITEK PWR3.0	
ltr		ecn no		dr		date		title	
A				TAI		2015-11-30		MINITEK PWR3.0 V/T HEADER, DUAL ROW	
B		ELX-T-24982		TAI		2016-09-21		SMT TAILS AND DIP HOLD DOWN	
C		ELX-N-28689		TONY		2017-12-05		dwg no	
D		ELX-I-43460		AKHIL		2022-01-21		sheet 1 of 2	
				dr		KENNY TAI		2015-11-26	
				enr		AKHIL RAJAN		2022-01-21	
				chr		MITHUN PAUL		2022-01-21	
				app		SPK		2022-01-21	
sheet		revision		D		D		type	
index		sheet		1		2		Product Customer Drawing	



Amphenol
FCi

© 2016 AFci

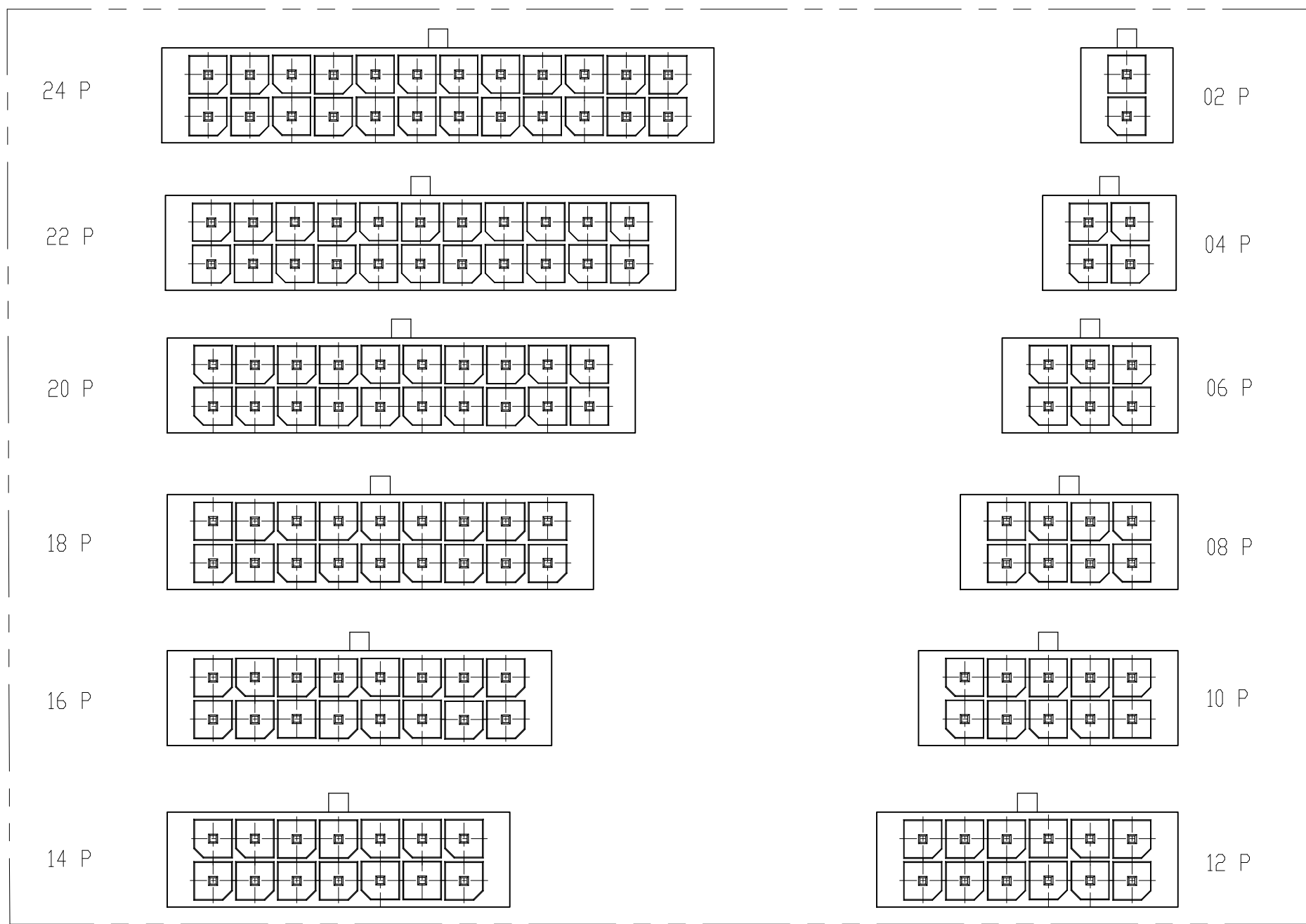
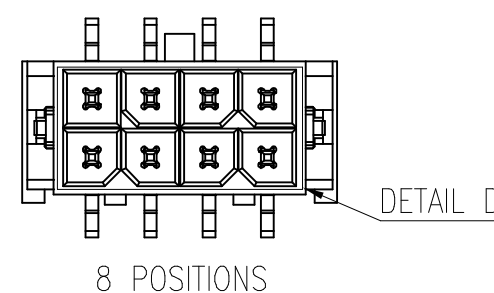

DETAIL D

mat'l. code		surface		tolerance		projection		product family	
		ISO 1302		ISO 406		ISO 1101		MINITEK PWR3.0	
ltr		ecn no		dr		date		title	
								MINITEK PWR3.0 V/T HEADER, DUAL ROW SMT TAILS AND DIP HOLD DOWN	
		angles		linear		mm		dwg no	
		0°±2'				scale		sheet 2 of 2	
				dr		KENNY TAI		2015-11-26	
				enr		AKHIL RAJAN		2022-01-21	
				chr		MITHUN PAUL		2022-01-21	
				app		SPK		2022-01-21	
sheet index		revision sheet		D		D		type	
		1 2						Product Customer Drawing	