

Introducing 3.5mm Spring Type Flush Mount Plug with Mating Unshrouded Header

The new 3.5mm Spring Type Flush Mount Plug with Mating Unshrouded Header now allows for a quick and easy way to insert the wire in signal applications without the use of special tools. The Spring Type Flush Mount Plug is customizable, reduces labor cost of installation and provides superior wire retention with proven quality in automation and drives technology or signal controls.

While the plug is available in 2 through 8 positions, the header is available with a standard narrow base or with a wider base for stability.

KEY FEATURES

- Compact design
- Male insertion from double directions
- Fast wire connections
- Male in high temperature
- Also available with wider base for stability

APPLICATIONS

- Automation and Drives technology
- Signal controls
- Control boxes for HVAC and Thermostats
- Controls for sound recordings/
TV or Radio production

MECHANICAL

- Insertion Force per pole 2.5N
- Withdrawal force per pole 4.5N min
- Stripping Length 8.5-10mm
- Operating temperature range -40°C to +110°C

ELECTRICAL

- Wire range 20-16 solid and stranded
- 150V, 2A per UL
- UL File E60677

MATERIALS

- Clamping Spring: lead-free tin plated steel
- Housing: 94VO rated Polyamide
- Pin Terminals: tin plated copper alloy

STANDARDS AND SPECIFICATIONS

UL 1059

PRODUCT DIMENSIONS

Plug:

Height 12.5 mm, Width 17 mm, Length dependent on number of positions

Standard Unshrouded Header:

Height 12.5 mm, Width 2.8 mm, Length dependent on number of positions

Wide Base Unshrouded Header:

Height 16.5 mm, Width 8 mm, Length dependent on position size

te.com/industrial



FLUSH MOUNT PLUG

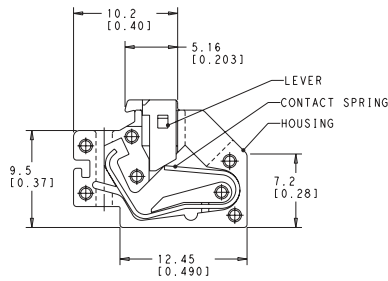
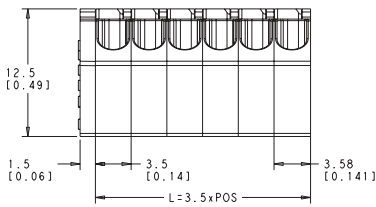

Part Number	Description
1986716-2	Flush Mt Plug, Spring Type, 3.5MM, 2 posn
1986716-3	Flush Mt Plug, Spring Type, 3.5MM, 3 posn
1986716-4	Flush Mt Plug, Spring Type, 3.5MM, 4 posn
1986716-5	Flush Mt Plug, Spring Type, 3.5MM, 5 posn
1986716-6	Flush Mt Plug, Spring Type, 3.5MM, 6 posn
1986716-7	Flush Mt Plug, Spring Type, 3.5MM, 7 posn
1986716-8	Flush Mt Plug, Spring Type, 3.5MM, 8 posn

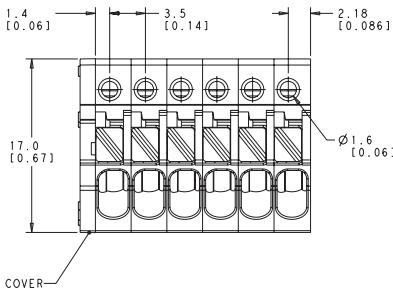

UNSHROUDED HEADER 12.5 HEIGHT

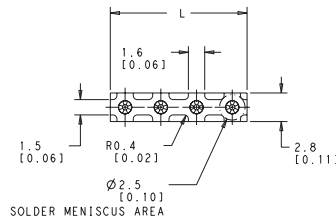
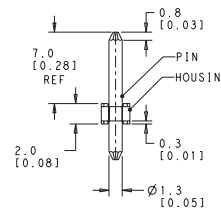
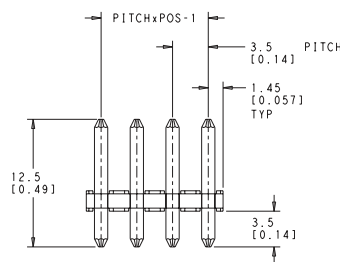

Part Number	Description
1986717-2	Unshrouded Header, 3.5MM, 2 posn
1986717-3	Unshrouded Header, 3.5MM, 3 posn
1986717-4	Unshrouded Header, 3.5MM, 4 posn
1986717-5	Unshrouded Header, 3.5MM, 5 posn
1986717-6	Unshrouded Header, 3.5MM, 6 posn
1986717-7	Unshrouded Header, 3.5MM, 7 posn
1986717-8	Unshrouded Header, 3.5MM, 8 posn

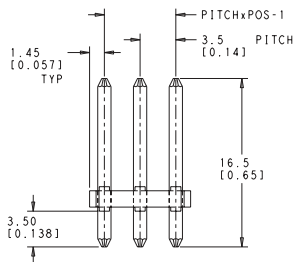

UNSHROUDED HEADER 16.5 HEIGHT

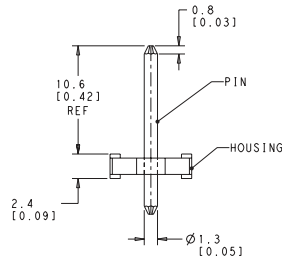
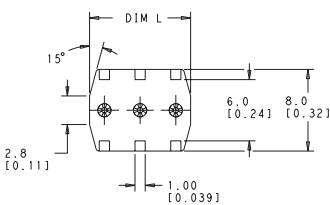

Part Number	Description
1986718-2	Unshrouded Header, 3.5MM, Wide Flange, 2 posn
1986718-3	Unshrouded Header, 3.5MM, Wide Flange, 3 posn
1986718-4	Unshrouded Header, 3.5MM, Wide Flange, 4 posn
1986718-5	Unshrouded Header, 3.5MM, Wide Flange, 5 posn
1986718-6	Unshrouded Header, 3.5MM, Wide Flange, 6 posn
1986718-7	Unshrouded Header, 3.5MM, Wide Flange, 7 posn
1986718-8	Unshrouded Header, 3.5MM, Wide Flange, 8 posn

While TE has made every reasonable effort to ensure the accuracy of the information in this brochure, TE does not guarantee that it is error-free, nor does TE make any other representation, warranty or guarantee that the information is accurate, correct, reliable or current. TE reserves the right to make any adjustments to the information contained herein at any time without notice. TE expressly disclaims all implied warranties regarding the information contained herein, including, but not limited to, any implied warranties of merchantability or fitness for a particular purpose. The dimensions in this catalog are for reference purposes only and are subject to change without notice. Specifications are subject to change without notice. Consult TE for the latest dimensions and design specifications.

te.com/industrial

