

- 1
- 2
- 3
- 4
- 5
- 6
- 7
- 8
- 9
- 10
- 11
- 12
- 13
- 14
- 15
- 16
- 17
- 18

## MATERIAL

Glass-fibre reinforced polyamide based (PA) technopolymer, black colour, glossy finish.

## ARMS

Matte chrome-plated steel complete with handles I.622 (see page 634) in technopolymer.

## STANDARD EXECUTION

Black-oxide steel boss, uncovered front end with pre-drilled pass-through hole.

## ACCESSORIES ON REQUEST

Axial retaining washer GN 184 (see page 1021).

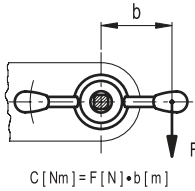

ELESA Original design

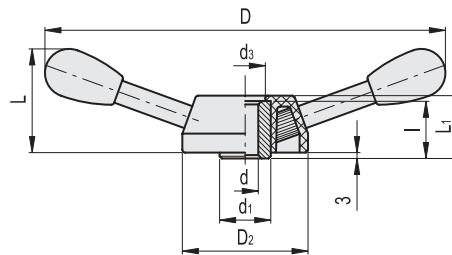

Conversion Table	
1 mm = 0.039 inch	
D	
mm	inch
200	7.87
274	10.79
312	12.28
363	14.29

METRIC

Code	Description	D	dH9	L	L1	D2	d1	d3	l	C# [Nm]	⚖️
65801	VBR.2/200	200	10	60	42	86	35	34	38	195	600
65811	VBR.2/280	274	10	74	42	86	35	34	38	195	715
65821	VBR.2/320	312	10	80	42	86	35	34	38	195	780
65831	VBR.2/370	363	10	90	42	86	35	34	38	195	865

Operating elements