

THIS DRAWING IS UNPUBLISHED. RELEASED FOR PUBLICATION  
 © COPYRIGHT - By - ALL RIGHTS RESERVED.

LOC	DIST	REVISIONS					
GP	00	P	LTR	DESCRIPTION	DATE	DWN	APVD
			B	REVISED PER ECO-19-002705	21MAY2019	AP	DG

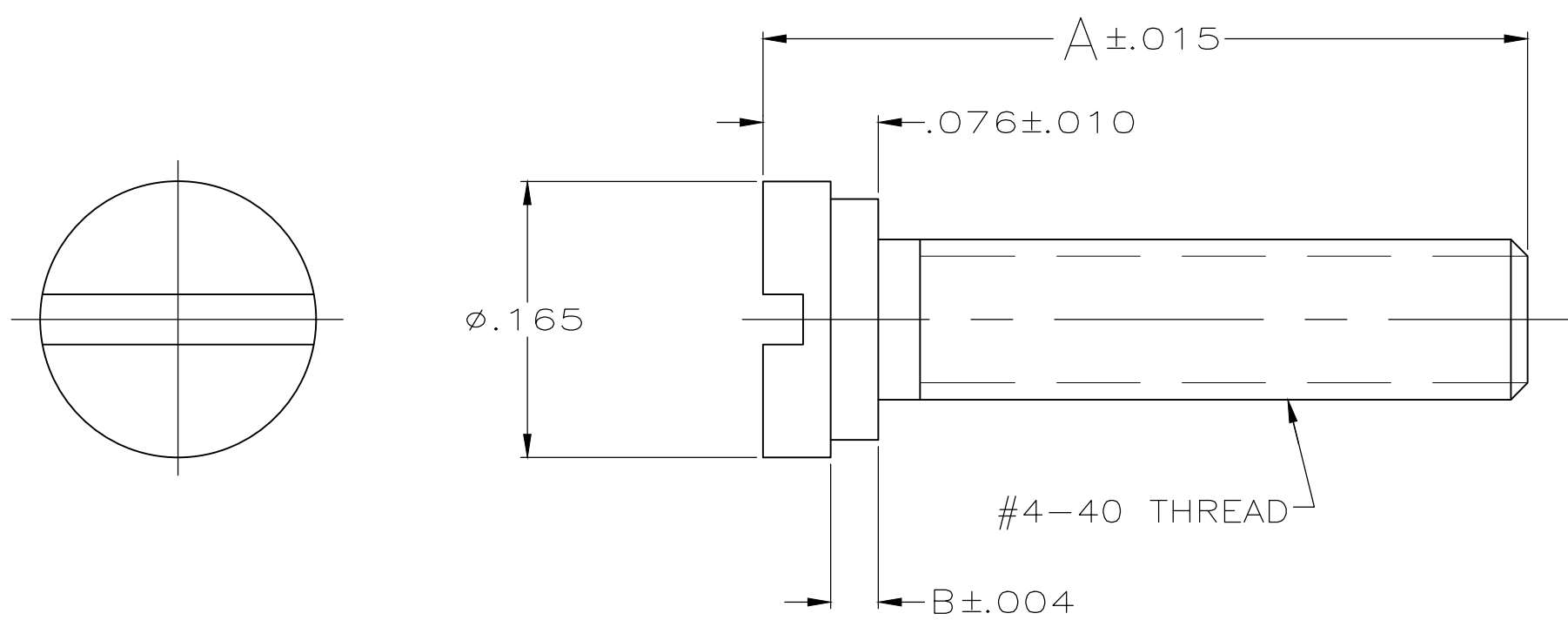

- ① ZINC PLATED .000200-.000400 THICK, YELLOW CHROMATE COATING.
- ② ZINC PLATED .000200-.000400 THICK, CLEAR CHROMATE COATING.

OBSOLETE	①	.042	.415	1-5206943-6
	①	.030	.450	5206943-7
OBSOLETE	①	.030	.290	<del>5206943-5</del>
	②	.030	.415	5206943-3
	①	.030	.415	5206943-2
	FINISH	B	A	PART NO

THIS DRAWING IS A CONTROLLED DOCUMENT.		DWN	R.RICHARDSON	23JUN05	<b>STE</b> TE Connectivity		
DIMENSIONS: INCHES		CHK	C.ROHDE	23JUN05			
TOLERANCES UNLESS OTHERWISE SPECIFIED:		APVD	M.WALMSLEY	23JUN05	NAME		
0 PLC ± -		PRODUCT SPEC		SLIDELATCH SCREW, #4-40, AMPLIMITE			
1 PLC ± -		APPLICATION SPEC		-			
2 PLC ± -		SIZE	A3	CAGE CODE	00779	DRAWING NO	C-5206943
3 PLC ± .005		WEIGHT		RESTRICTED TO		-	
4 PLC ± -		CUSTOMER DRAWING					
ANGLES ± -		SCALE		10:1		SHEET 1 OF 1	
MATERIAL	COLD ROLLED STEEL	FINISH		SEE TABLE		REV B	