

RECOMMENDED PCB LAYOUT

REVISIONS					
REV	ECO	DESCRIPTION	DATE	BY	APPR
A1	-	RELEASED DRAWING	MAY-10-21	VITO	TOMMY

NOTES: UNLESS OTHERWISE SPECIFIED

- MATERIAL:
HOUSING: THERMOPLASTIC; COLOR:BLACK
CONTACT: COPPER ALLOY
SEAL:SILICONE RUBBER
- MODIFICATIONS :RIGHT ANGLE PCB MOUNT ,SNAP FIT
- SPECIFICATIONS:
3.1 CURRENT RATING: 60 AMPS
3.2 OPERATING TEMPERATURE: -55°C TO +125°C
3.3 DIELECTRIC WITHSTANDING VOLTAGE: LESS THAN 2 MILLIAMPS CURRENT LEAKAGE @ 1500 VOLTS AC.
3.4 INSULATION RESISTANCE: 1000 MEGOHMS MIN @ 25°C.
3.5 MOISTURE RESISTANCE: IP67&IP69K (MATED CONDITION)
3.6 MATING CYCLE DURABILITY: 100 CYCLES
3.7 RoHS COMPLIANT
- MATING PART:ATHD06-1-8S-XX PLUG(XX = MODIFICATIONS)
- ALL DIMENSIONS ARE FOR REFERENCE USE ONLY.

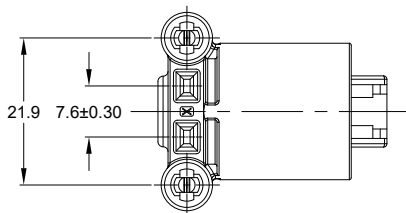

ATFH13-1-8P-BM0X VARIANTS		
CONTACT PLATING	PART NUMBER	WEIGHT (GRAMS)
MATING END: GOLD PCB END: TIN	ATFH13-1-8P-BM01	13.1
MATING END: NICKEL PCB END: TIN	ATFH13-1-8P-BM03	13.1

ATFH13-1-8P-BM0X		DESCRIPTION		ITEM
QUANTITY	PART NUMBER	MATERIALS LIST		
UNLESS OTHERWISE SPECIFIED: 1) All dimensions are in metric(mm). 2) Tolerances are as follows: 1 PL DEC ±0.30 Fractions ±1/64 2 PL DEC ±0.15 Angles ±1° 3 PL DEC ±0.08				
SIGNATURES		DATE		
DRAWN: VITOLI		MAY-10-21		
CHECKED: ORION LI		MAY-12-21		
ENGINEER:				
APPROVAL: TOMMY XIE		MAY-13-21		
MATERIAL SPECIFICATIONS:		CUSTOMER:		
PROCESS SPECIFICATIONS:		THIS DRAWING IS SUPPLIED FOR INFORMATION ONLY. DESIGN FEATURES, SPECIFICATIONS AND PERFORMANCE DATA SHOWN HEREON ARE THE PROPERTY OF THE AMPHENOL CORPORATION. NO RIGHTS OF REPRODUCTION ARE IMPLIED. ALL DIMENSIONS ARE SUBJECT TO NORMAL MANUFACTURING VARIATIONS.		
NEXT ASSY:		SIZE	TYPE	DWG NO
		B	C-	ATFH13-1-8P-BM0X
		SCALE	NONE	REVISION A1
				SHEET 1 OF 1

TITLE: 1 POS,RIGHT ANGLE RECEPTACLE,PIN,ATHD SERIES,SIZE 8,SNAP FIT
DWG NO: ATFH13-1-8P-BM0X
REV: A1
SH: 1
OF: 1