

REVISIONS				
P	LTN	DESCRIPTION	DATE	APPV
B		RELEASED BY RSA 19/006-01	31JAN2019	EL RKL
BI		REVISE BY ECN-21-128042	25NOV2021	PSB RKL

CODINGS  
2294399-1

2294399-1 AS SHOWN

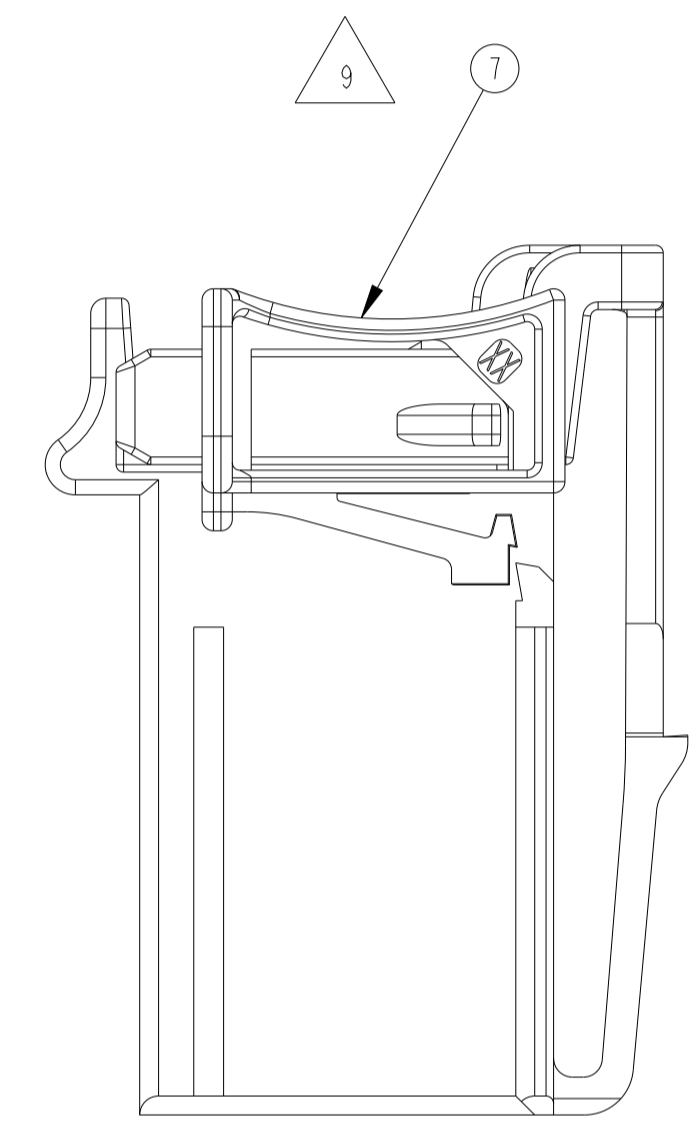
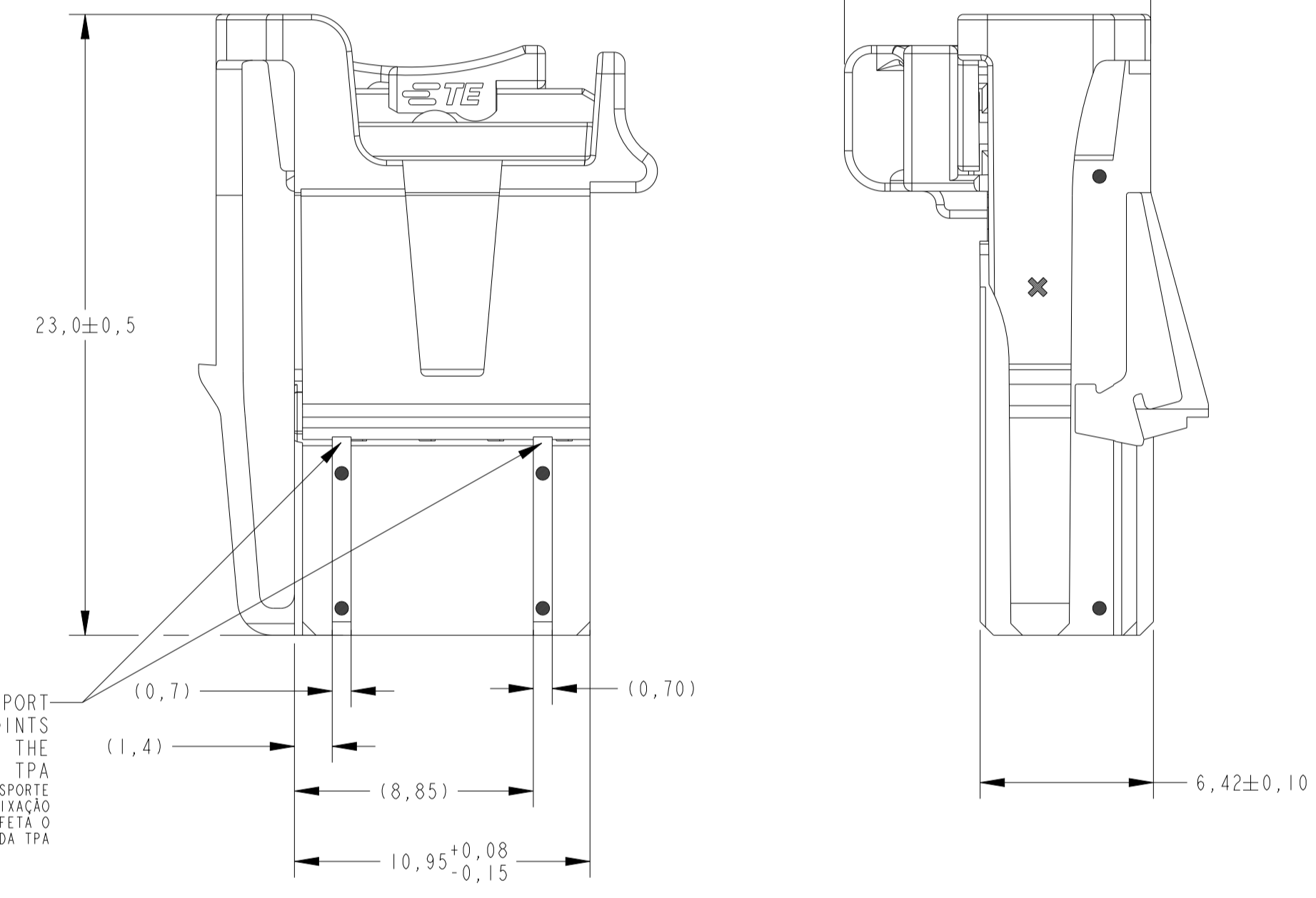
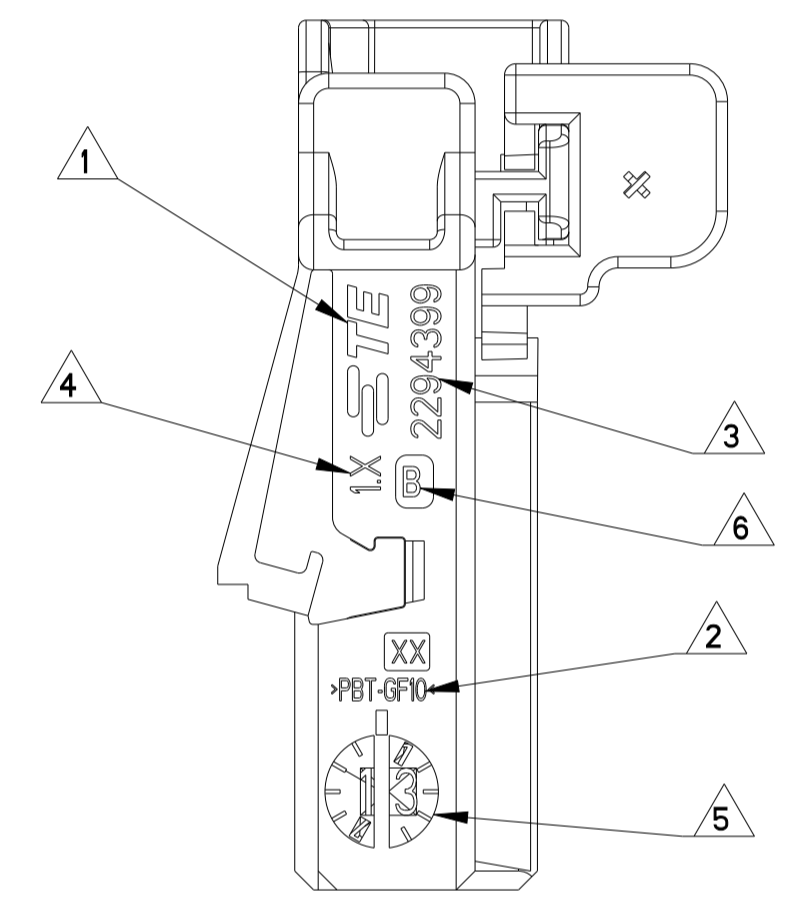
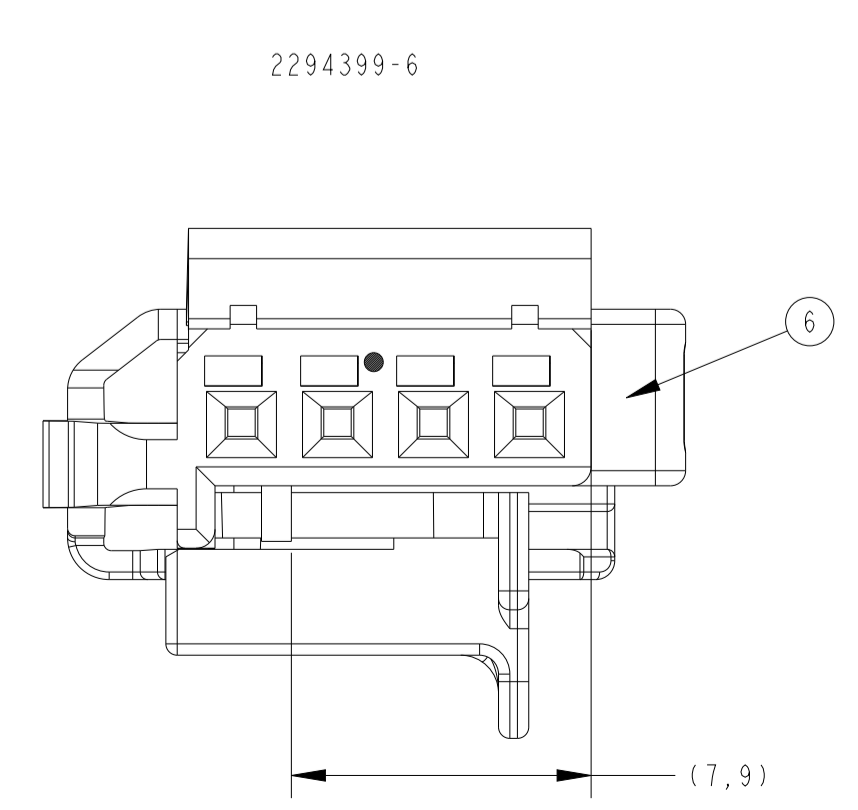
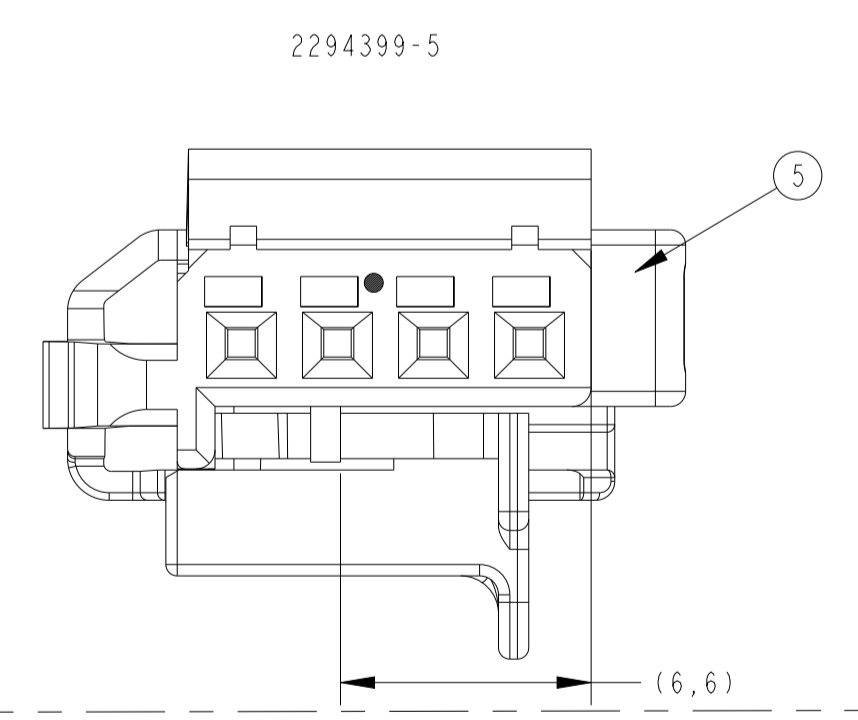
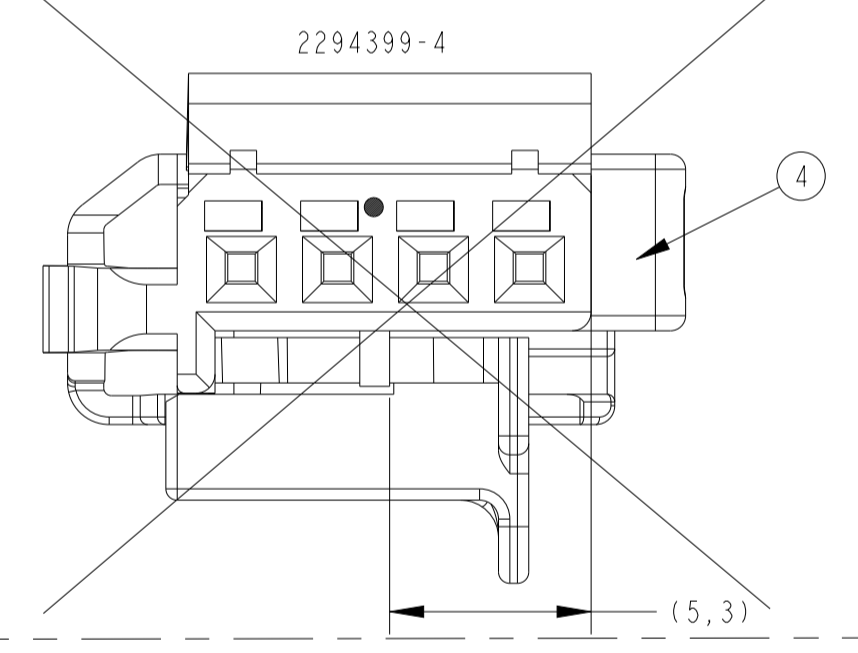
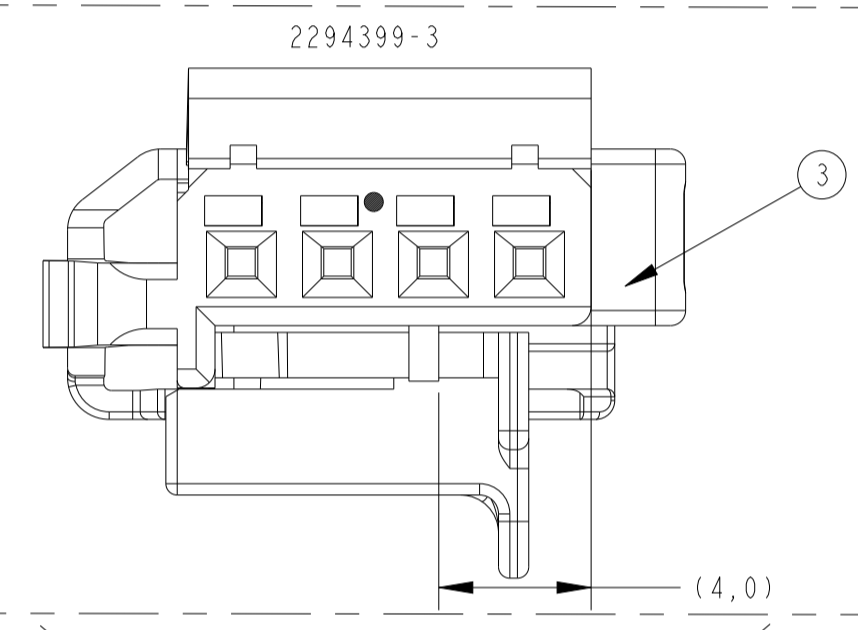
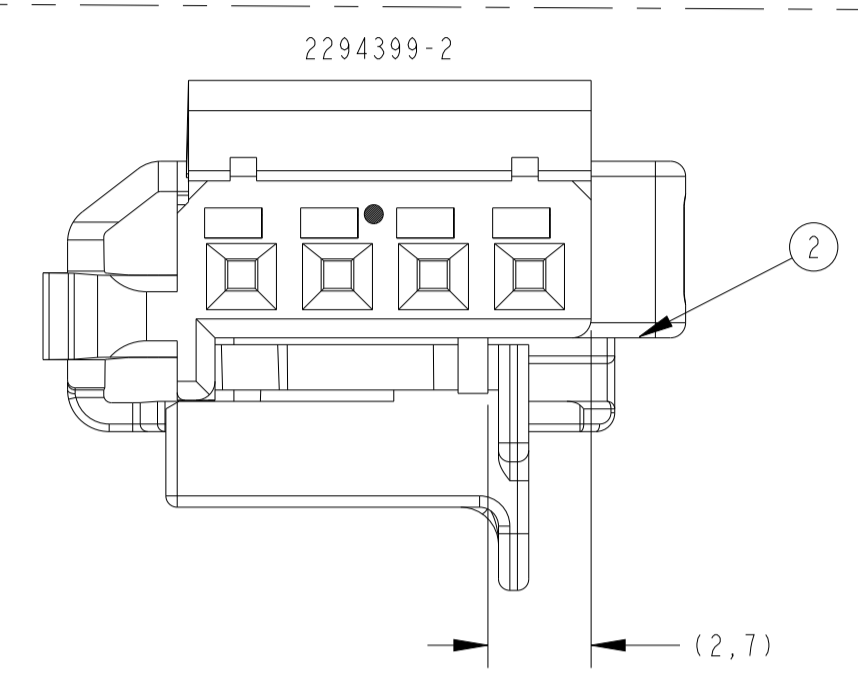
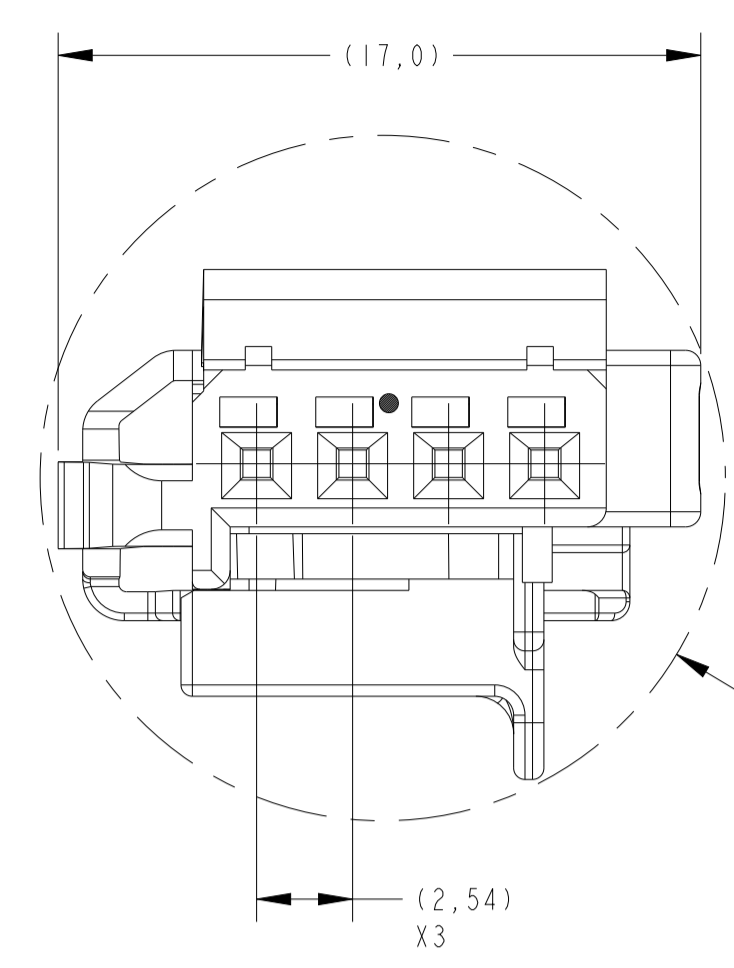
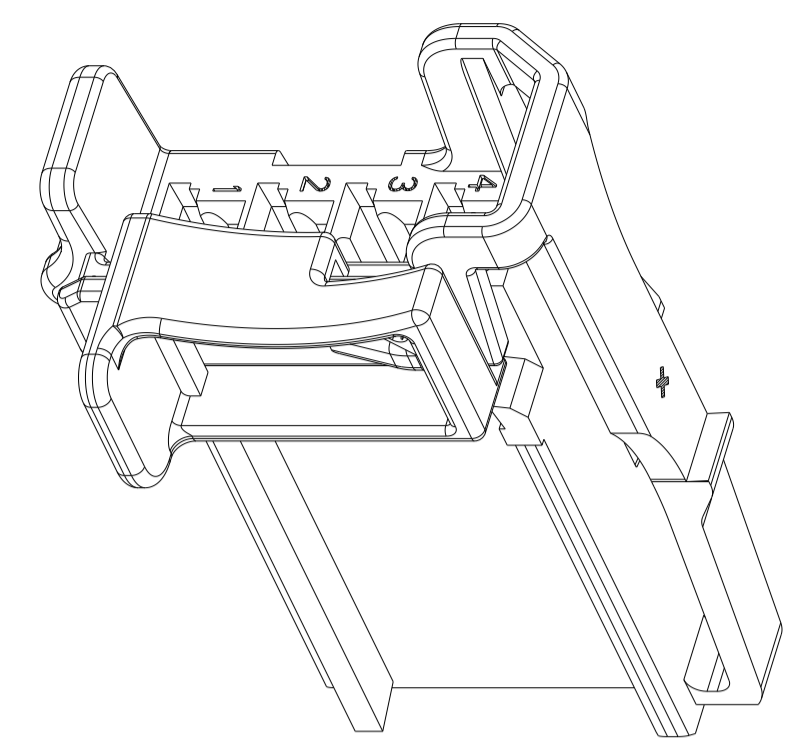
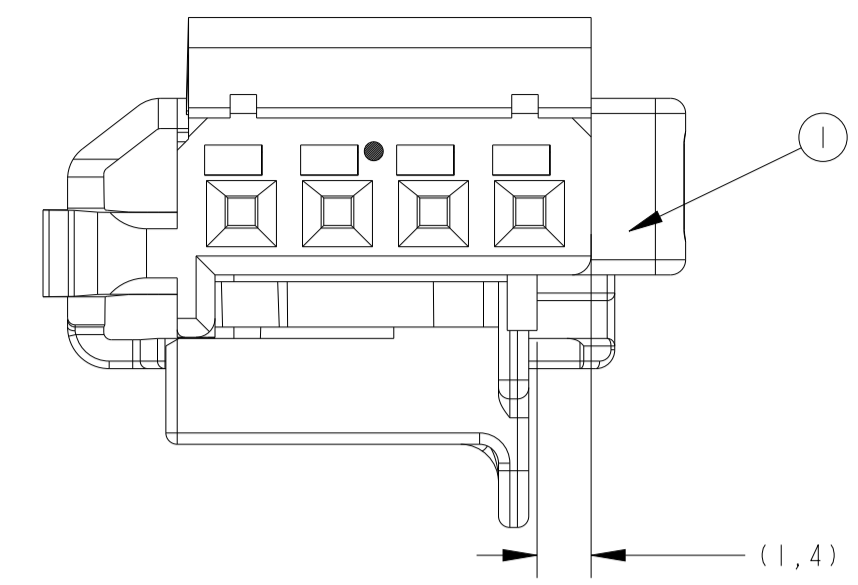

TPA CAN BE SEPERATED AFTER TRANSPORT FROM BOTH FIXATIONPOINTS THIS DOES NOT AFFECT THE PROPER LOCKING FUNCTION OF TPA O TPA PODE SER SEPARADO APOS O TRANSPORTE A PARTIR DE AMBOS OS PONTOS DE FIXAÇÃO ISSO NÃO AFETA O FUNÇÃO DE BLOQUEIO REQUERIDA DA TPA

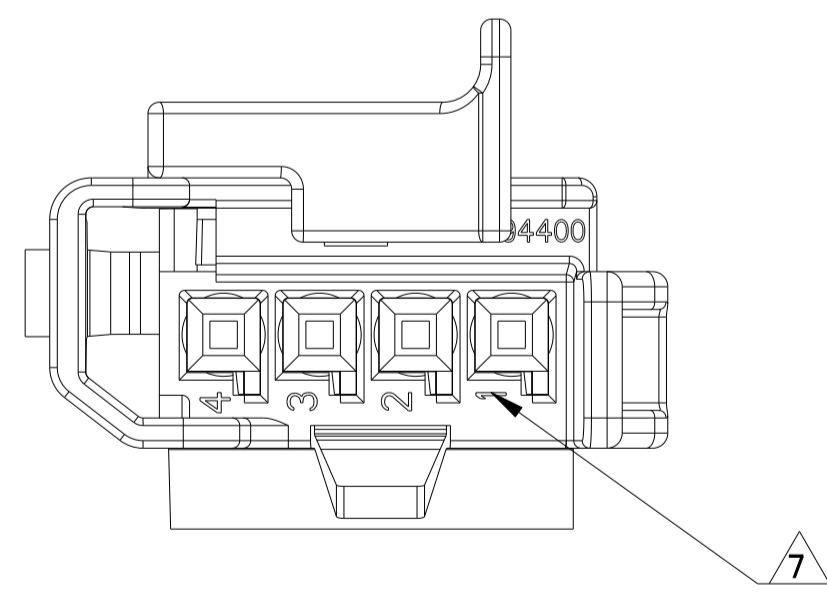

963715	0.50-0.75	CuNiSi
928999	0.25-0.35	CuNiSi
2141824	0.13	CuNiSi
TE BASE NO STRIP FORM	WIRE RANGE mm <sup>2</sup>	MATERIAL
RECOMMENDED CONTACT SYSTEM: MOS; UNSEALED		

NOTES :  
8 - PACKAGING: BULK MATERIAL IN CARDBOARD BOX  
EMBALAGEM ACODICIONADO EM CAIXA DE PAPELAO  
9 - CPA SUPPLIED IN PRE LOCK POSITION  
CPA FORNECIDO NA CONDIÇÃO DE PRÉ POSIÇÃO.

GRAVAÇÕES MARKINGS	
LOGOTIPO TE TE LOGO	1
NOMENCLATURA MATERIAL MATERIAL NOMENCLATURE	2
NÚMERO COMPONENTE TE TE COMPONENT NUMBER	3
NÚMERO CAVIDADE CAVITY NUMBER	4
DATADOR DATE CODE	5
REV+ LETRA REV.DA PEÇA REV.+ PART REV.LETTER	6
IDENTIFICAÇÃO CIRCUITO CIRCUIT IDENTIFICATION	7

REQ. PER ASSY	ITEM	DESCRIPTION	MATERIAL	COLOR
7	CPA		PBT-GF10	RED/VERMELHO
6	REC HSG, COD F		PBT-GF10	BROWN/MARROM
5	REC HSG, COD E		PBT-GF10	GREY/CINZA
4	REC HSG, COD D		PBT-GF10	GREEN/VERDE
3	REC HSG, COD C		PBT-GF10	BLUE/AZUL
2	REC HSG, COD B		PBT-GF10	WHITE/BRANCO
1	REC HSG, COD A		PBT-GF10	BLACK/PRETO

THIS DRAWING IS A CONTROLLED DOCUMENT.

APV: H. K. LEME 31JAN2019

CHK: D. A. OLIVEIRA 31JAN2019

OWN: E. LOPES 31JAN2019

TE Connectivity

HSG, 4 WAY, RECEPTACLE, MOS

SCALE 5:1 SHEET 1 OF 2 REV B1

# POSSIBLE CODINGS SCALE (2:1)

REVISIONS				
P.	LTN.	DESCRIPTION	DATE	APVD.
-	-	SEE SHEET 1	-	-

## PIN DETAILS

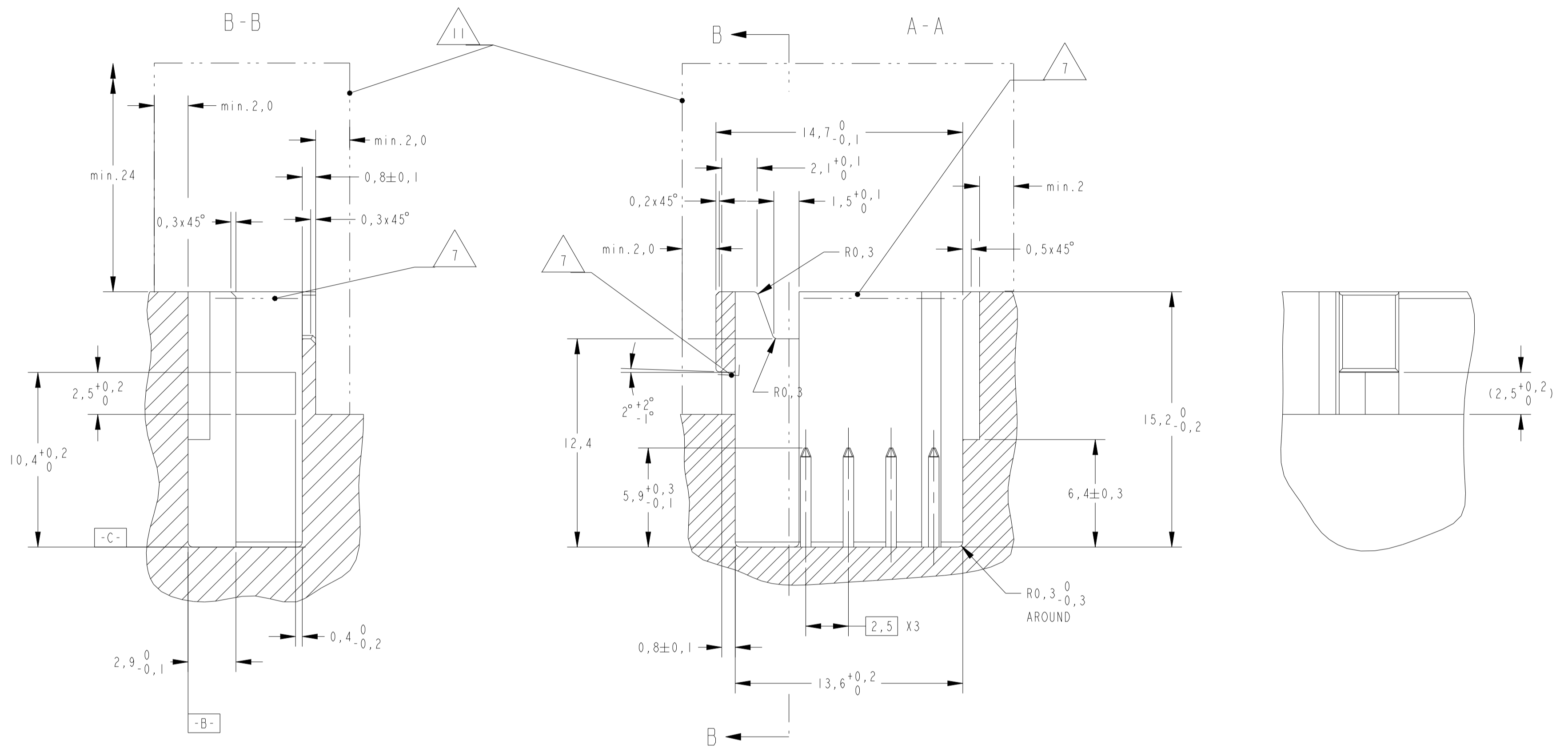
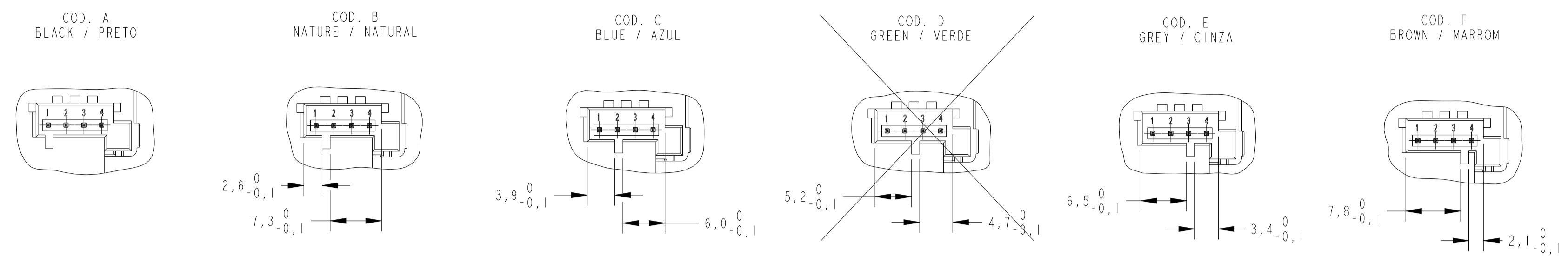
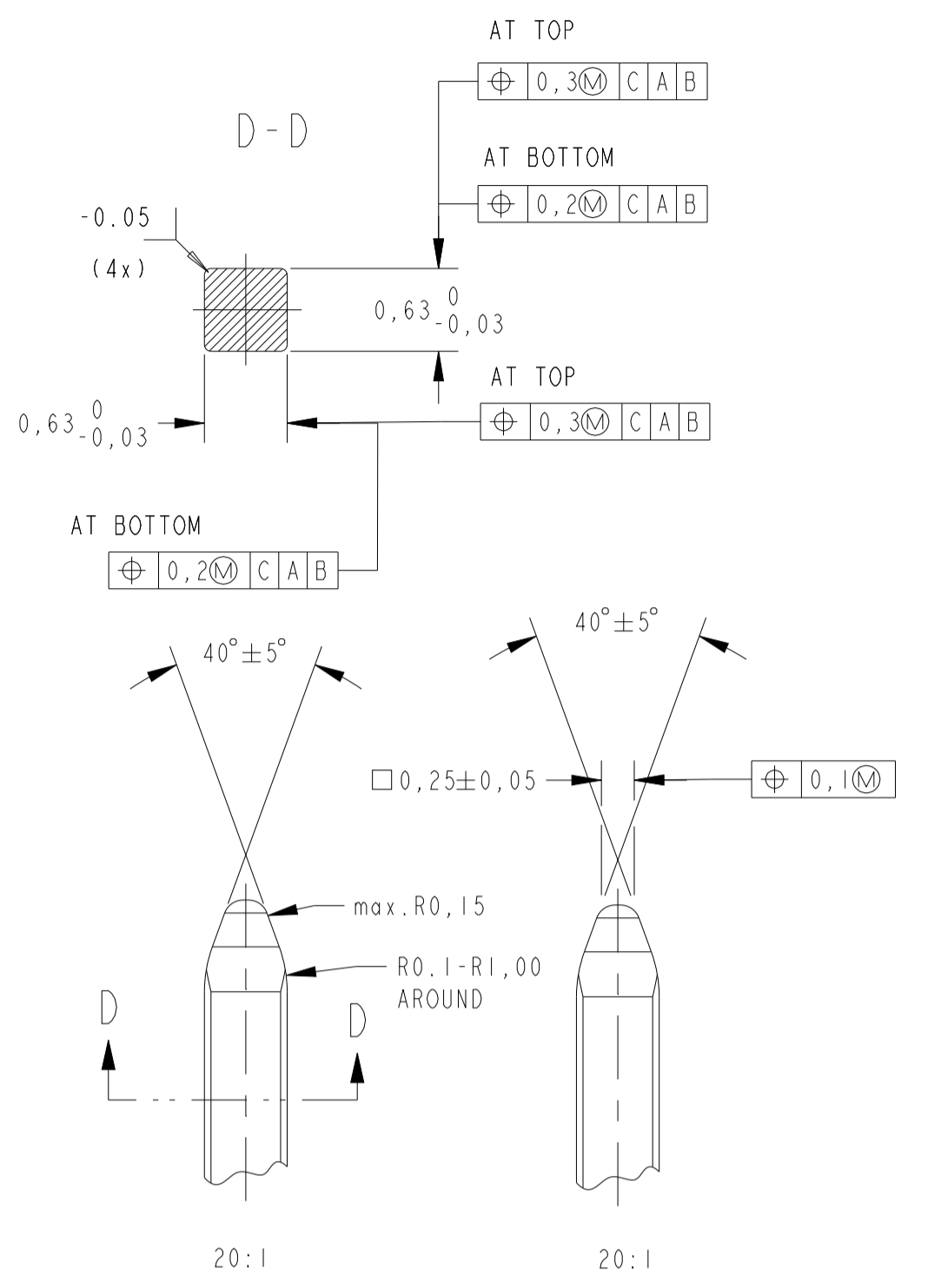

- NOTES:
- CODING A IS SHOWN CODIGO COMO MOSTRADO;
  - REFERENCES [A], [B] FOR CENTERLINE DEFINITION 1 mm ABOVE REFERENCE [C] REFERENCIAS [A], [B] PARA DEFINIÇÃO DA LINHA DE CENTRO 1 mm REFERENCIADO SOBRE O DATUM [C];
  - NO SPECIFIED RADII R0.4 mm RAIOS NÃO ESPECIFICADOS R0.4 mm;
  - CHARACTERS DEEP CARACTERÍSTICA DE ALTURA;
  - RETAIN FORCE FOR TABS ACC. TO USCAR2 REV6 FORÇA DE RETENÇÃO DO TAB CONFORME USCAR REV6;
  - CONTACT PIN: PLATING SURFACE CORRESPONDING TO SOCKET CONTACT CONTATO DOS PINOS: ACABAMENTO SUPERFICIAL IGUAL AO CONTATO DO TERMINAL FEMEA;
  - IN THIS AREA MAX. 0.03 mm BURR PERMITTED NESTA ÁREA 0.03mm DE REBARBA MAX. PERMITIDA;
  - PERMISSIBLE MATERIAL RECESS REBAIXO PERMITIDO;
  - THE USED MATERIAL IS TO BE SELECTED IN SUCH A WAY THAT THE REQUIRED MECHANICAL AND ELECTRICAL CHARACTERISTICS ARE FULFILLED ACC. TO THE VALID DESIGN GUIDELINES AND SPECIFICATIONS: O MATERIAL USADO DEVE SER SELECIONADO DE TAL MANEIRA QUE AS CARACTERÍSTICAS MECÂNICAS E ELÉTRICAS NECESSÁRIAS ESTEJAM CONFORME AS DIRETRIZES E ESPECIFICAÇÕES DO PROJETO;
  - CODING AREA WITHOUT CHAMFER ÁREA DE CHANFRO;
  - MINIMUM ASSEMBLY AREA ÁREA MÍNIMA DE MONTAGEM;

INTERFACE DETAIL ONLY FOR INFORMATION  
DETALHE DA INTERFACE SOMENTE PARA INFORMAÇÃO

THIS DRAWING IS A CONTROLLED DOCUMENT.		OWN: E. LOPES 31JAN2019	TE Connectivity
DIMENSIONS: mm		CHK: D. A. OLIVEIRA 31JAN2019	
TOLERANCES UNLESS OTHERWISE SPECIFIED:		APVD: R. K. LEME 31JAN2019	NAME: HSG, 4 WAY, RECEPTACLE, MOS
0 PLC	$\pm 0.5$	PRODUCT SPEC	-
1 PLC	$\pm 0.5$	108-37111	-
2 PLC	$\pm 0.5$	APPLICATION SPEC	-
3 PLC	$\pm 0.5$	114-94259	-
4 PLC	$\pm 0.5$	WEIGHT: 1.0 g	-
ANGLES	$\pm 5^\circ$	CUSTOMER DRAWING	-
MATERIAL: SEE TABLE	-	SCALE: 5:1	SHEET: 2 OF 2
FINISH: -	-	REV: B1	-