

LOC		DIST		REVISIONS			
FP	LTR	DESCRIPTION	DATE	DRN	APVD		
M3		REVISED PER ECR-21-118795	01AUG22	GR	VS		

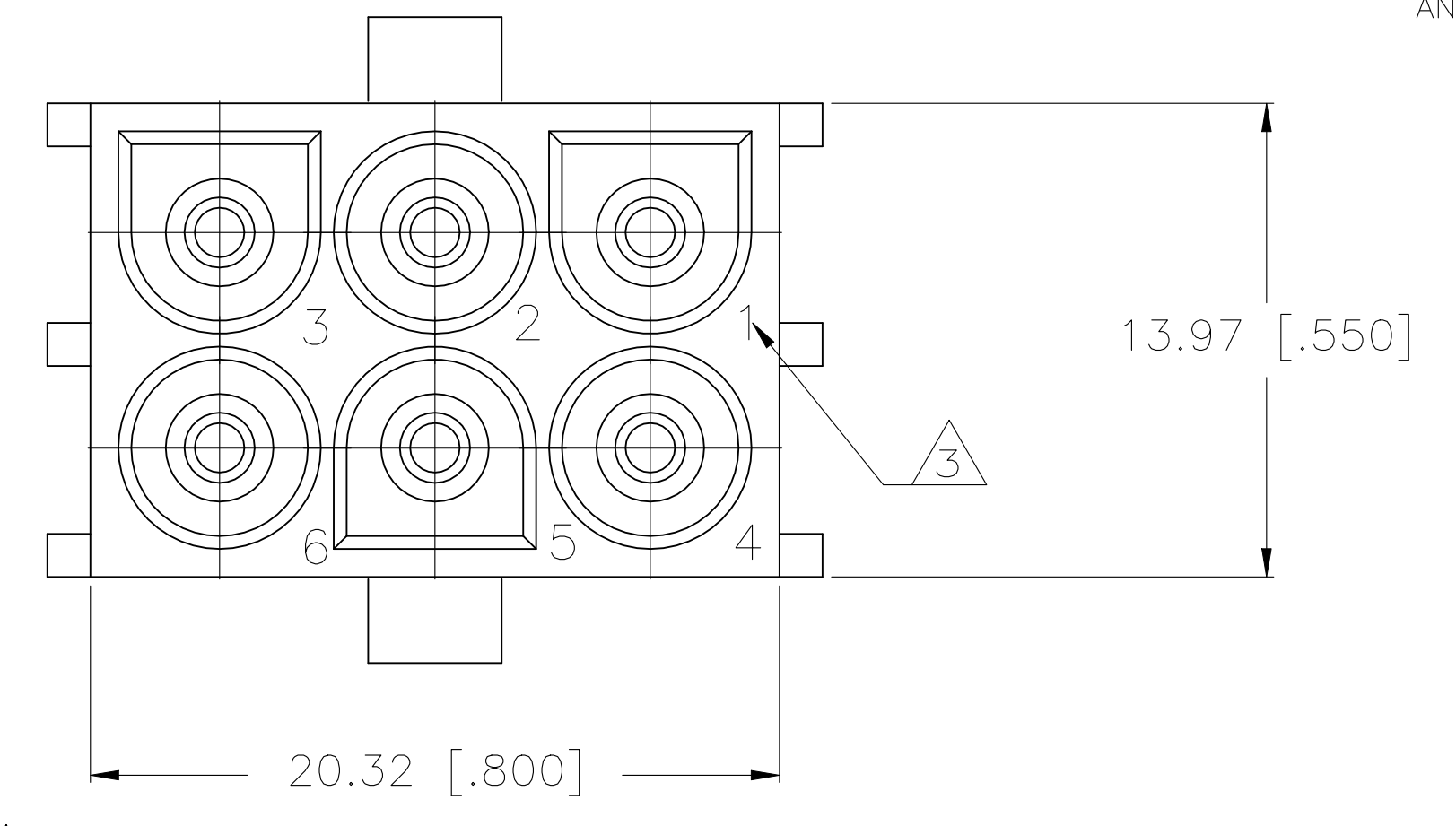

- 1 PARTS MUST COMPLY WITH AMP SOLDERABILITY SPEC 109-11-3.
- 2 CONTACT IS STAMPED FROM PRE-PLATED STOCK WHICH IS PLATED OVERALL WITH 0.00127 [.000050] NICKEL, THEN STRIPED WITH 0.00076 [.000030] GOLD IN CONTACT AREA INDICATED AND TIN-LEAD ON SOLDER TAIL END.
- 3 CIRCUIT IDENTIFICATION CHARACTERS ARE ADJACENT TO THE INDICATED CAVITIES, BUT LOCATION AND ORIENTATION MAY DIFFER FROM PRINT.
- 4 CONTACT IS PLATED OVERALL WITH 0.00127 [.000050] NICKEL, THEN 0.00076 [.000030] GOLD OVER CONTACT LENGTH INDICATED AND MATTE TIN ON SOLDER TAIL END.
- 5 SUPERSEDED BY 350827-4
- 6 DIMENSION SHOWN REPRESENT PRODUCT IN DRY CONDITION. ADDITIONAL 2% GROWTH DUE TO END USE LOCATION MOISTURE ABSORPTION MAY OCCUR AND SHOULD BE ACCOUNTED FOR.

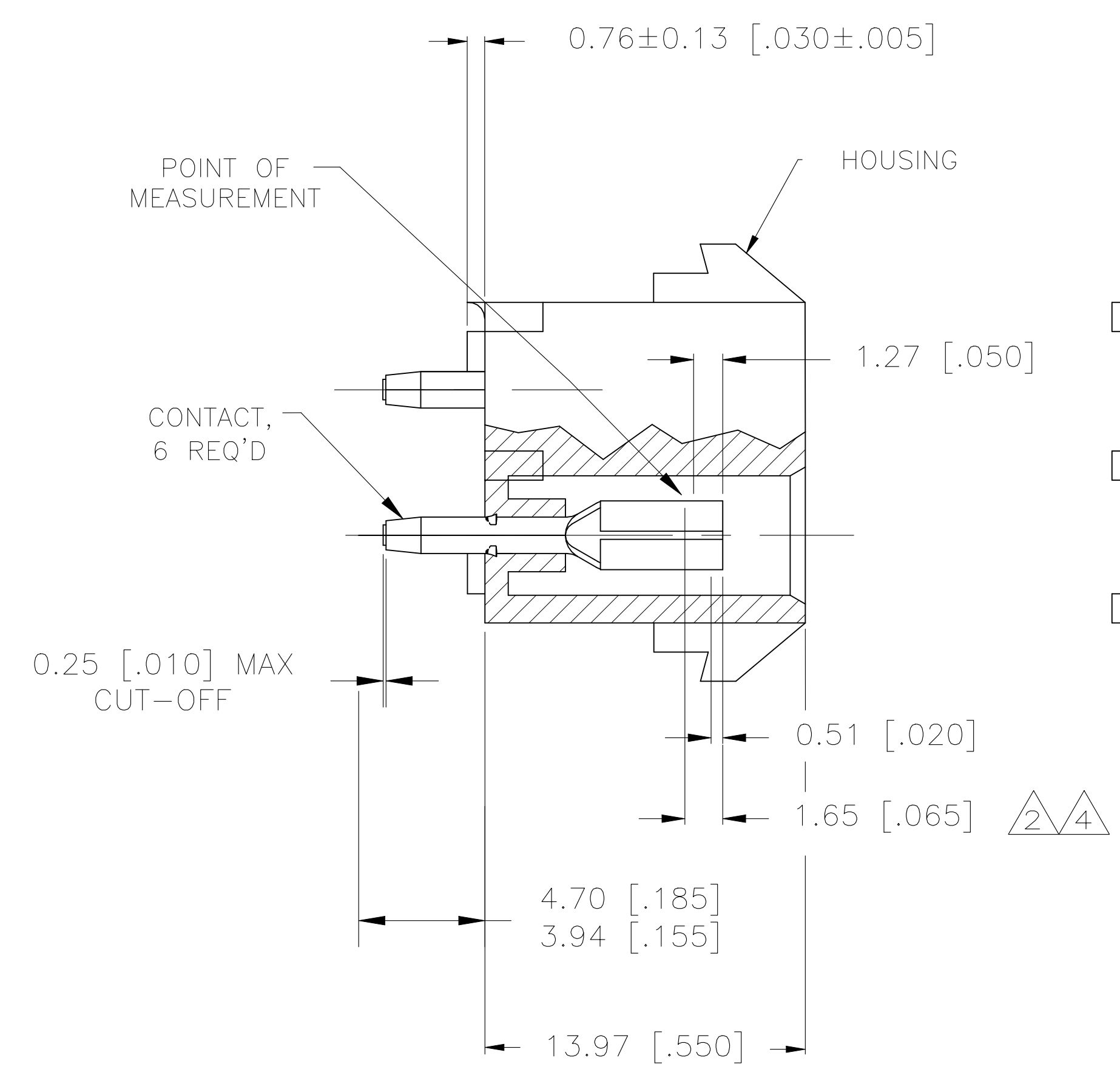
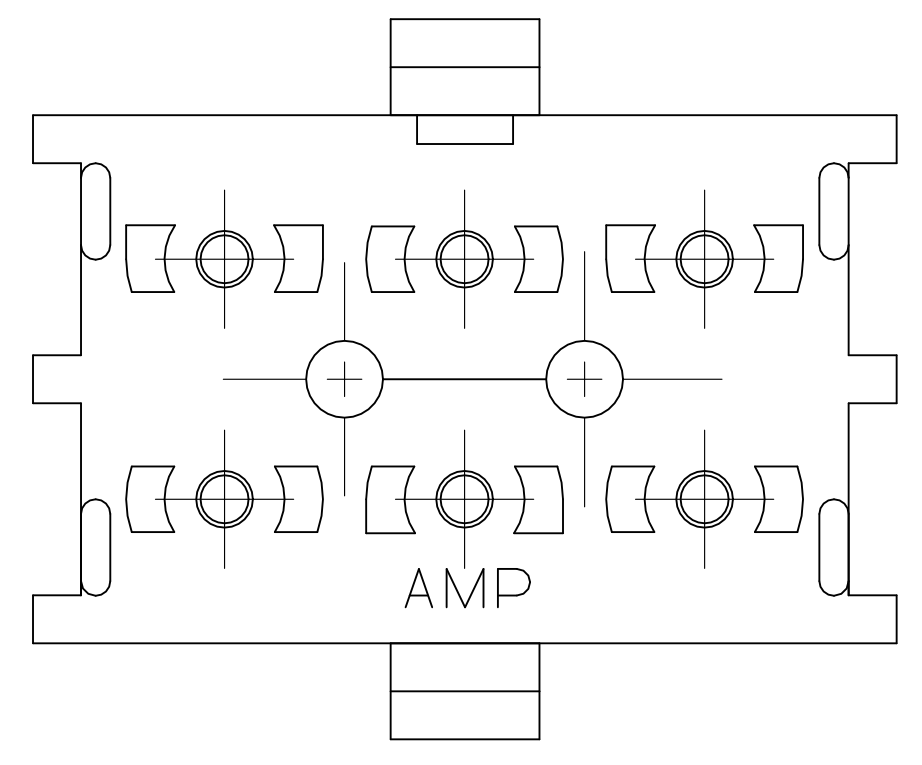
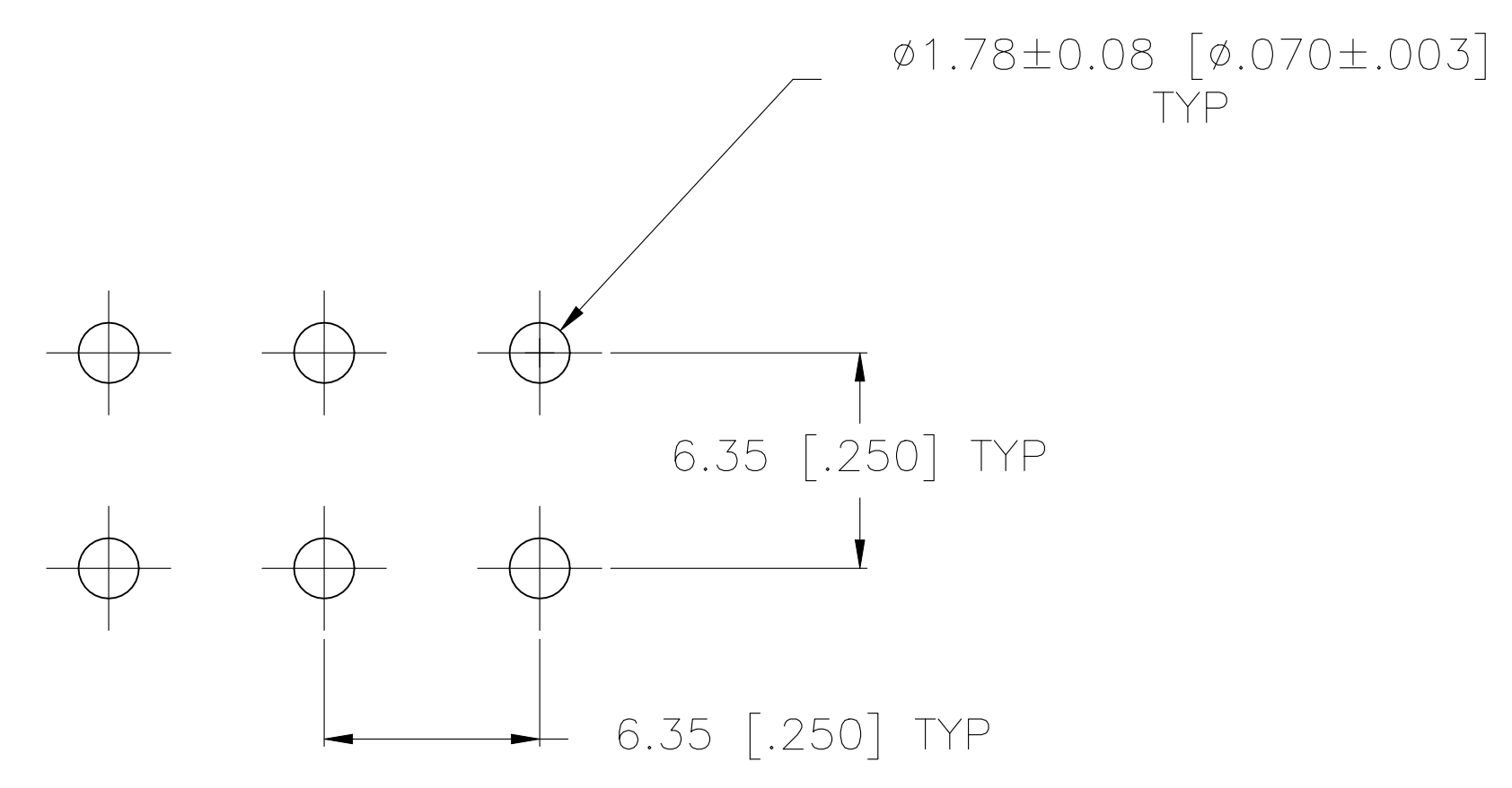

RECOMMENDED LAYOUT FOR 1.58 [.062] THICK PC BOARD

5	PH BRZ GOLD 4	NYLON,UL 94V-0	350827-4
	PH BRZ GOLD 2	NYLON,UL 94V-0	350827-2
	PH BRZ TIN	NYLON,UL 94V-0	350827-1
	CONTACT	HOUSING	PART NO

THIS DRAWING IS A CONTROLLED DOCUMENT.

DIMENSIONS: mm [NCHES]	TOLERANCES UNLESS OTHERWISE SPECIFIED:	DIN K. WHITAKER 11OCT2005 CHK S. RIDGILL 11OCT2005 APVD S. RIDGILL 11OCT2005	NAME STE TE Connectivity
0 PL ± 1 PL ± 2 PL ± 3 PL ± 0.13 [.005] 4 PL ± ANGLES ±	FINISH SEE TABLE	APPLICATION SPEC —	SIZE A1
MATERIAL SEE TABLE	WEIGHT —	RESTRICTED TO —	SCALE 5:1 SHEET 1 of 1 REV M3

CUSTOMER DRAWING 00779 C=350827