

THIS DRAWING IS UNPUBLISHED. RELEASED FOR PUBLICATION .19
 © COPYRIGHT 19 BY AMP INCORPORATED. ALL RIGHTS RESERVED.

LOC		DIST		REVISIONS			
P	LTR	DESCRIPTION	DATE	DWN	APVD		
BD	39	0	REL WAS 96-8301-8 NPR 213	09-JUN-99	MS	JC	

- ① 0.076µm MIN GOLD OVER 0.76µm MIN PALLADIUM-NICKEL OR (0.76µm MIN GOLD) FOR A LENGTH OF 2 MIN ON MATING FACE END, 3.81µm MIN TIN-LEAD FOR A LENGTH OF 2.2 MIN ON OPPOSITE END, ALL OVER 1.27µm MIN NICKEL.
- ② 5.08µm MIN TIN.
- ③ LCP, BLACK, UL 94V-0 RATED.
- ④ DIMENSION TO BE ESTABLISHED BY CUSTOMER, X.XX BSC TO BE 8.45 MIN.

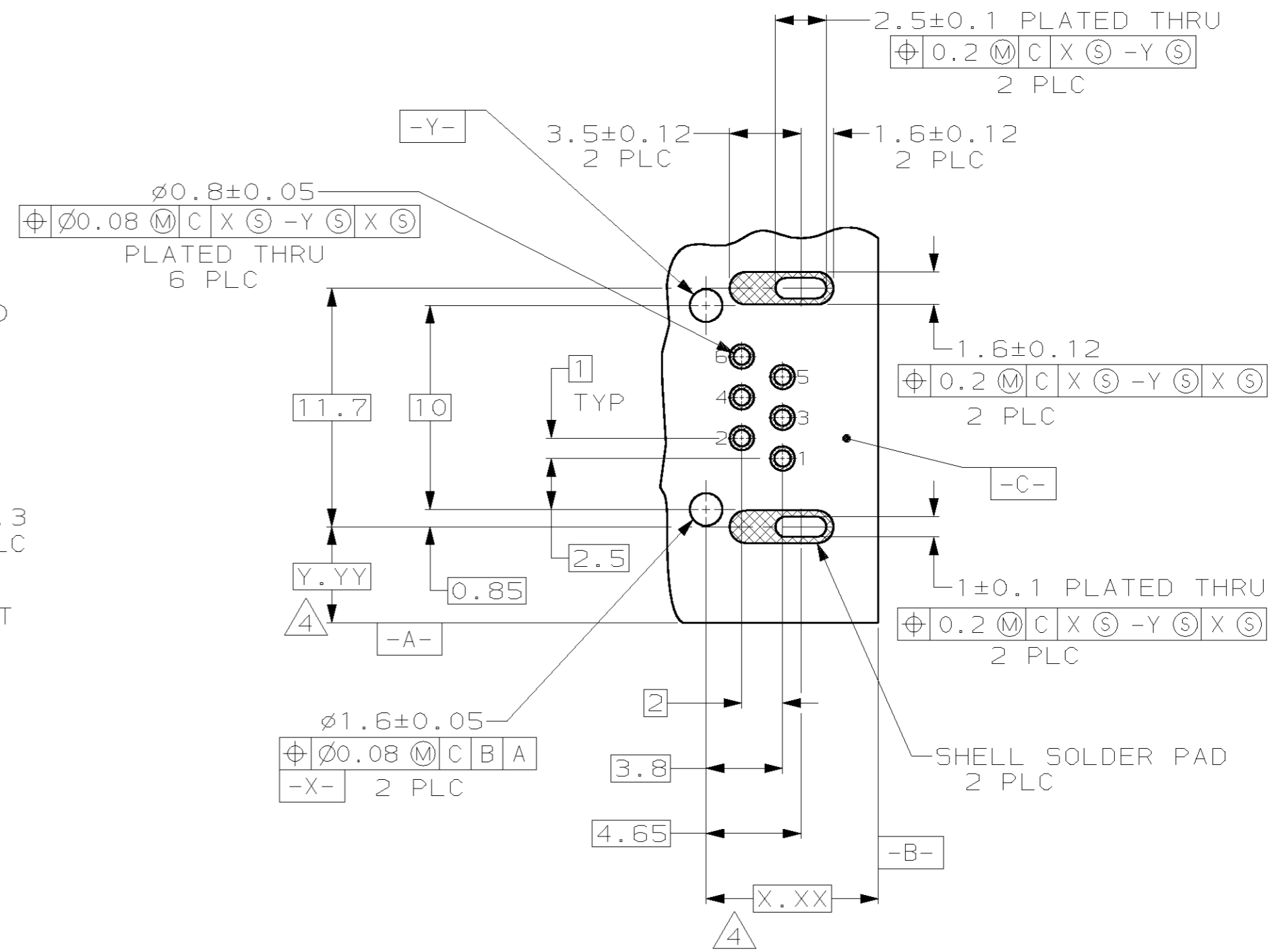
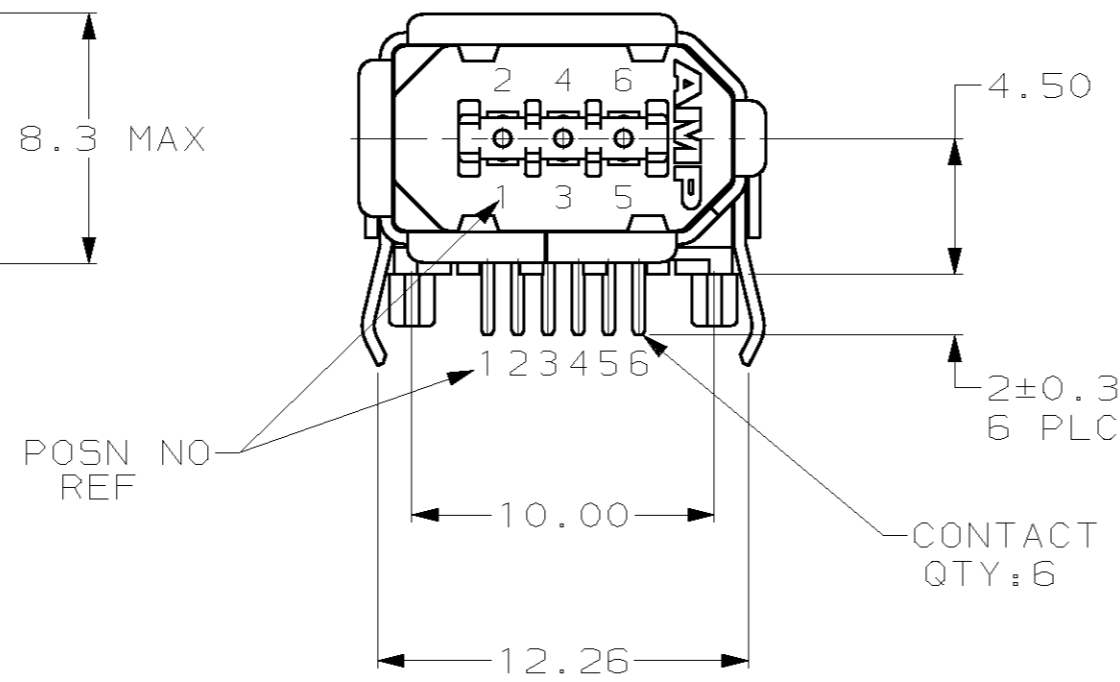
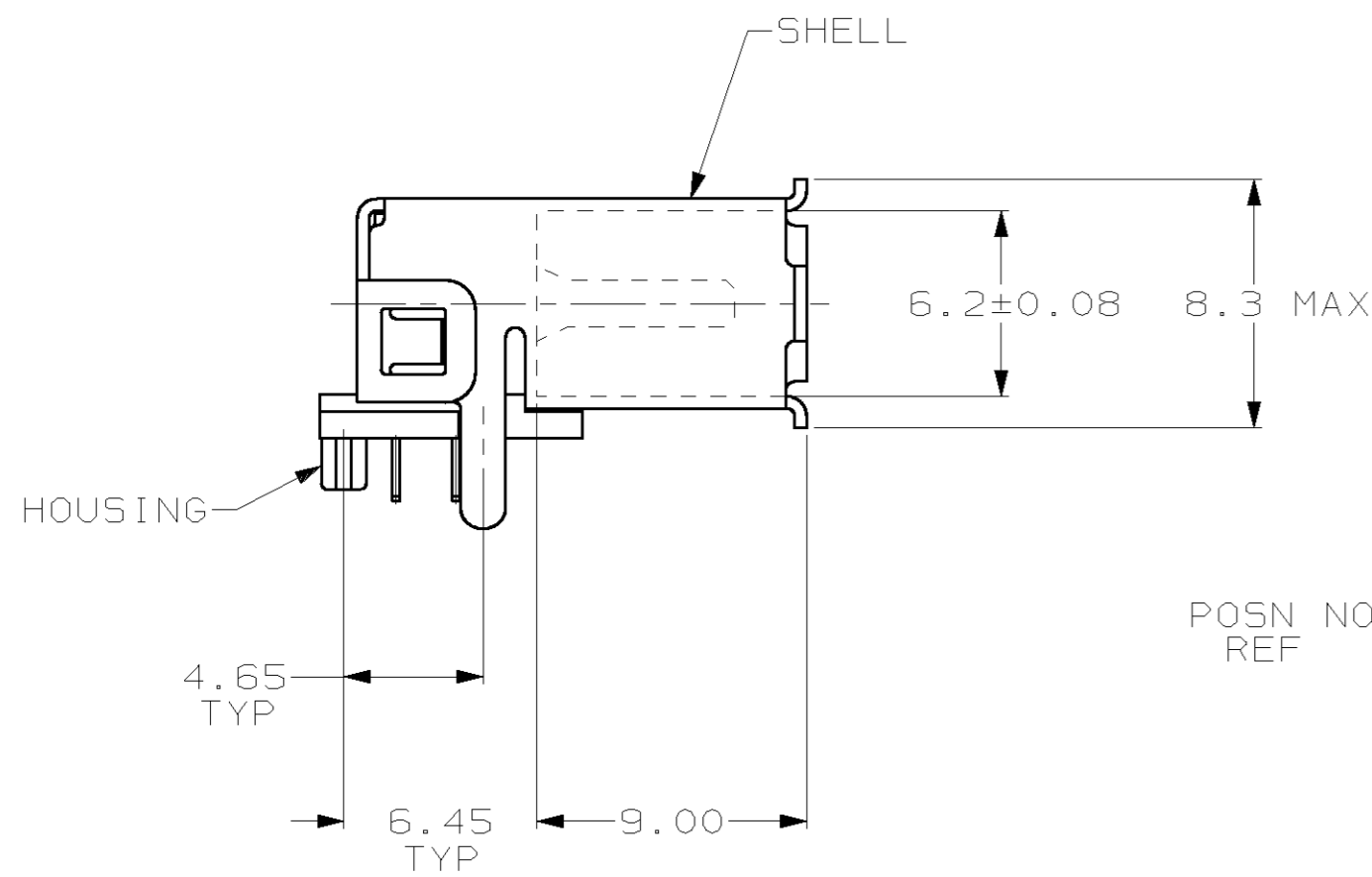
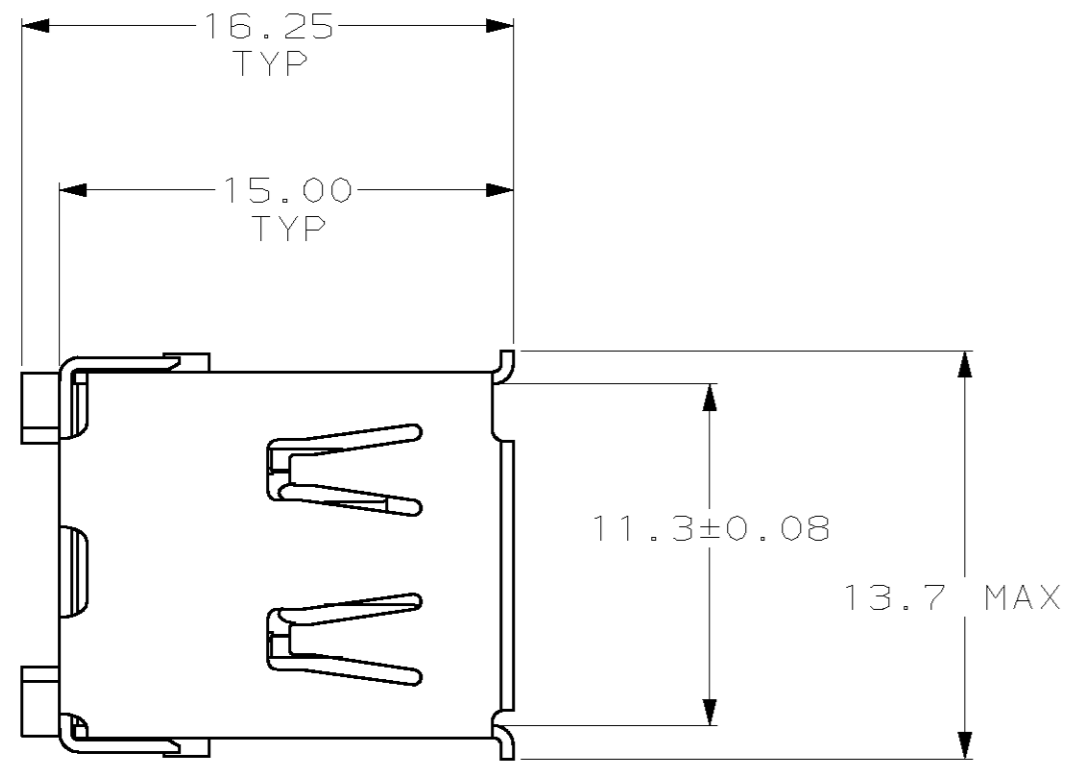

RECOMMENDED PWB LAYOUT
CONNECTOR SIDE

788516-1

PART NO

<small>THIS DRAWING IS A CONTROLLED DOCUMENT FOR AMP INCORPORATED. IT IS SUBJECT TO CHANGE AND THE CONTROLLING ENGINEERING ORGANIZATION SHOULD BE CONTACTED FOR THE LATEST REVISION.</small>		DWN M.E.SHIRK 09JUN99	AMP Incorporated Harrisburg, PA 17105-3608
DIMENSIONS: mm		CHK J.CONDRIGE 09JUN99	
<small>TOLERANCES UNLESS OTHERWISE SPECIFIED:</small> 0 PLC ±- 1 PLC ±- 2 PLC ±0.13 3 PLC ±- 4 PLC ±- ANGLES ±-		APVD -	NAME SOCKET ASSEMBLY, RIGHT ANGLE FLAT, THRU HOLE, IEEE P1394
MATERIAL: CONTACTS: BRASS SHELL: PHOS BRONZE HOUSING: ③		PRODUCT SPEC -	SIZE A2
<small>FINISH CONTACTS: ① SHELL: ②</small>		APPLICATION SPEC -	CAGE CODE 00779
CUSTOMER DRAWING		WEIGHT -	DRAWING NO C=788516
		SCALE 4:1	SHEET 1 OF 1
			REV 0