

THIS DRAWING IS UNPUBLISHED. RELEASED FOR PUBLICATION AUG , 2006.
 COPYRIGHT BY TYCO ELECTRONICS CORPORATION. ALL RIGHTS RESERVED.

LOC		DIST		REVISIONS			
P	LTR	DESCRIPTION	DATE	DWN	APVD		
	B2	REVISED (ECR-14-013708)	22SEP14	SW	SC		

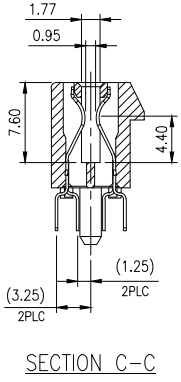

- NOTES:
- MATERIAL:
 - HOUSING: THERMOPLASTIC, HIGH TEMP., UL94V-0; COLOR: SEE TABLE.
 - CONTACTS: PHOSPHOR BRONZE.
 - FINISH:
 - CONTACT: GOLD PLATING (SEE TABLE) ON CONTACT AREA. 100u" MIN. MATTE-TIN PLATING ON SOLDER TAILS, 50u" MIN. NICKEL UNDERPLATING OVERALL.
 - WAVE SOLDER CAPABLE TO 265°C PER TE SPEC. 109-202, CONDITION B.

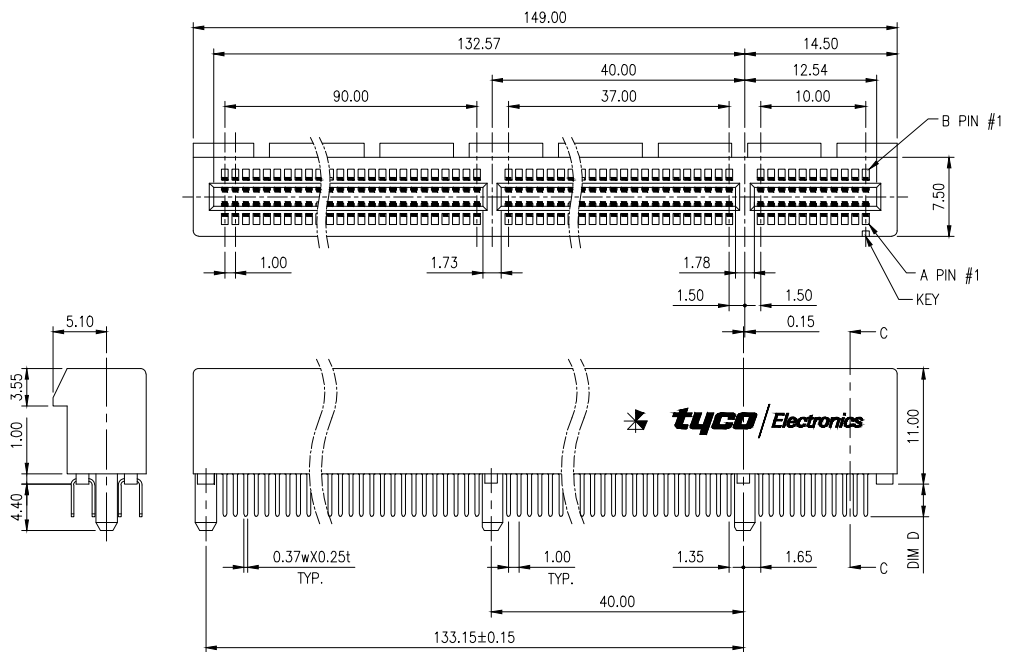
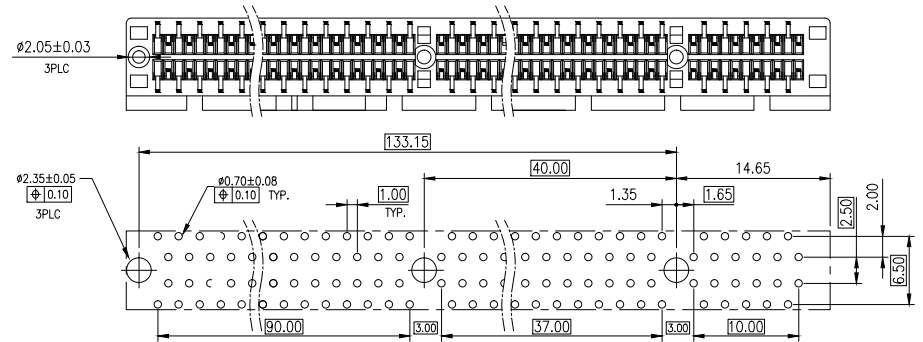

RECOMMENDED PCB LAYOUT(TOP VIEW)
 PCB TOLERANCE: ±0.05

EOL	WHITE 7527U	2.36	3.10	30 u"	1-1775276-4
				15 u"	1-1775276-3
		1.56	2.54	30 u"	1-1775276-2
				15 u"	1-1775276-1
	BLACK	2.36	3.10	30 u"	1775276-4
				15 u"	1775276-3
		1.56	2.54	30 u"	1775276-2
				15 u"	1775276-1
	HG COLOUR	PCB THICKNESS	D ±0.20	GOLD PLATING	PART NUMBER

THIS DRAWING IS A CONTROLLED DOCUMENT.		DWN S. CHIEN 24DEC2008	TE Connectivity				
DIMENSIONS: MM		CHK S. CHIEN 24DEC2008					
TOLERANCES UNLESS OTHERWISE SPECIFIED:		APVD W. KODAMA 24DEC2008	NAME				
0 PLC ± - 1 PLC ± 0.3 2 PLC ± 0.2 3 PLC ± - 4 PLC ± - ANGLES ± 3'		PRODUCT SPEC	1.0MM PCI EXPRESS, 280 POS				
MATERIAL SEE NOTE		FINISH SEE NOTE	QUALIFICATION TEST REPORT	SIZE	CAGE CODE	DRAWING NO	RESTRICTED
			501-57593	A3	00779	C=1775276	
			WEIGHT 14.5 GRAMS	SCALE		SHEET 1 OF 3	REV B2
			CUSTOMER DRAWING				

4

3

2

1

THIS DRAWING IS UNPUBLISHED. RELEASED FOR PUBLICATION AUG , 2006.
 © COPYRIGHT BY TYCO ELECTRONICS CORPORATION. ALL RIGHTS RESERVED.

LOC		DIST		REVISIONS			
P	LTR	DESCRIPTION		DATE	DWN	APVD	
		SEE SHEET 1.					

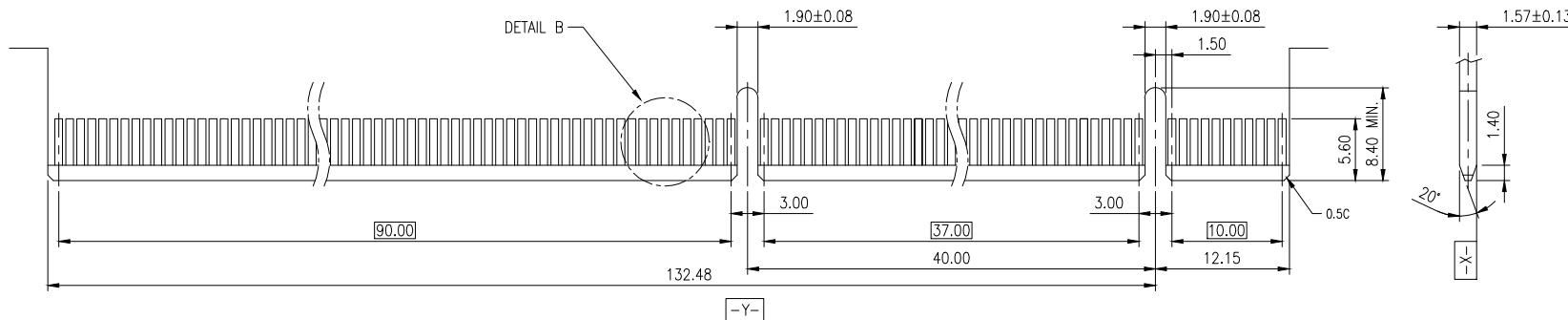
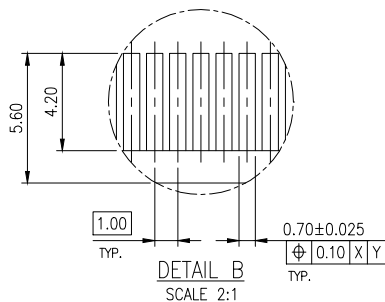

RECOMMENDED MATING COMPONENT BOARD

THIS DRAWING IS A CONTROLLED DOCUMENT.		DWN	STE TE Connectivity	
DIMENSIONS: MM		CHK		
TOLERANCES UNLESS OTHERWISE SPECIFIED:		APVD	NAME	
0 PLC ± -		PRODUCT SPEC	1.0MM PCI EXPRESS, 280 POS	
1 PLC ± -		APPLICATION SPEC	SIZE	CAGE CODE
2 PLC ± -		WEIGHT	A3	00779
3 PLC ± -		DRAWING NO		RESTRICTED TO
4 PLC ± -		C=1775276		
ANGLES ± -		SCALE		SHEET
MATERIAL		CUSTOMER DRAWING		2 OF 3
FINISH		REV		B2

4

3

2

1

THIS DRAWING IS UNPUBLISHED. RELEASED FOR PUBLICATION AUG , 2006.
 © COPYRIGHT BY TYCO ELECTRONICS CORPORATION. ALL RIGHTS RESERVED.

LOC	DIST	REVISIONS			
P	LTR	DESCRIPTION	DATE	DWN	APVD
		SEE SHEET 1.			

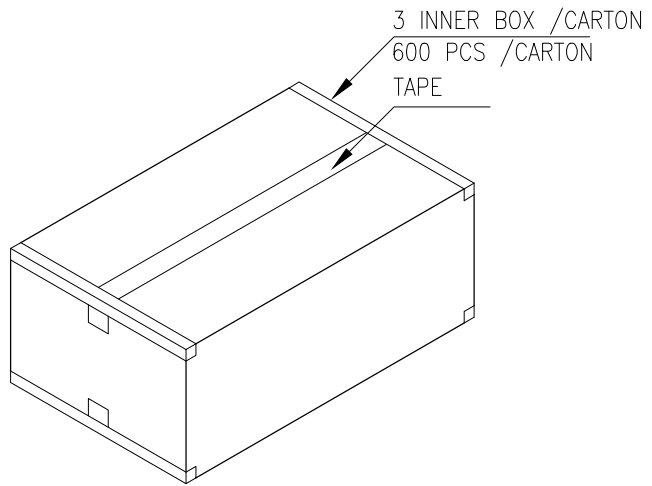
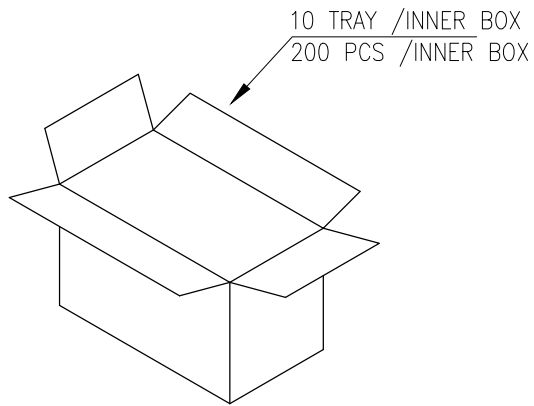
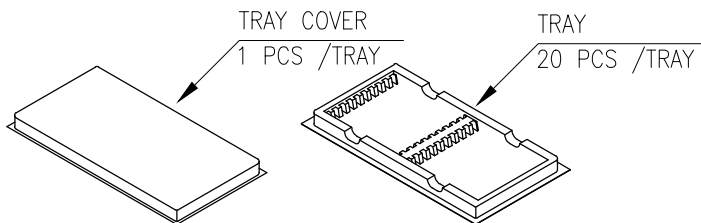

SHIPPING CARTON

NOTES:

1. TRAY COVER SIZE: 329.5mm(L)X 170mm(W)X 20mm(H).
2. TRAY SIZE: 328.5mm(L)X 170mm(W)X 20mm(H).
3. BOX SIZE: 340mm(L)X 187mm(W)X 210mm(H).
4. CARTON SIZE: 576mm(L)X 350mm(W)X 232mm(H).
5. CARTON NET WEIGHT: 8.7 Kg.
6. CARTON GROSS WEIGHT: 10.4 Kg.

THIS DRAWING IS A CONTROLLED DOCUMENT.		DWN	STE TE Connectivity	
DIMENSIONS: MM		CHK		
TOLERANCES UNLESS OTHERWISE SPECIFIED:		APVD	NAME	
0 PLC ± -		PRODUCT SPEC	1.0MM PCI EXPRESS, 280 POS	
1 PLC ± -		APPLICATION SPEC	SIZE	CAGE CODE
2 PLC ± -		WEIGHT	A3	00779
3 PLC ± -		CUSTOMER DRAWING	DRAWING NO	
4 PLC ± -		SCALE	C=1775276	
ANGLES ± -		SHEET	RESTRICTED TO	
MATERIAL	FINISH	3 of 3	REV B2	