

- 1
- 2
- 3
- 4
- 5
- 6
- 7
- 8
- 9
- 10
- 11
- 12
- 13
- 14
- 15
- 16
- 17
- 18

**STANDARD EXECUTIONS**

- **RHR1**: back mounting, threaded blind holes.
- **RHR3**: front mounting, pass-through holes for stainless steel cylindrical-head screws with hexagon socket and zinc-plated self-locking nuts, included in the supply.

Colour index:

- **01**: anodised aluminium, natural colour, matte finish.
- **04**: anodised aluminium, black colour, matte finish.

**FEATURES AND APPLICATIONS**

Careful machining of the surface of the handle using special machines eliminates all sharp edges.

RH-R series handles adapt well to use on a 19" rack and instruments in general.

HE = height unit of the front panel: 1 HE = 44.45 mm = 1 6/8".

**SPECIAL EXECUTIONS ON REQUEST**

- RHR2: thickness L = 8 mm, back mounting, threaded blind holes for M4 screws.
- Different colours.

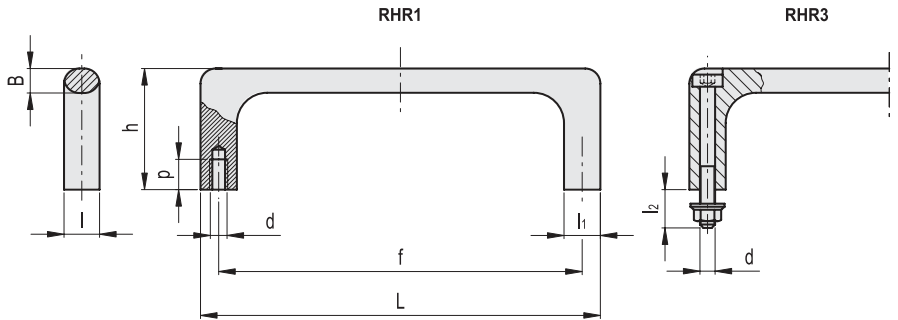
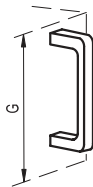

Conversion Table			
1 mm = 0.039 inch			
f		L	
mm	inch	mm	inch
55	2.16	67	2.64
88	3.46	100	3.94
120	4.72	132	5.20
180	7.09	192	7.56
235	9.25	247	9.63

**RHR1**

Code	Code	f	L	d	p	B	h	l	li	G	HE*	⚖
RHR1-12.055.01	RHR1-12.055.04	55	67	M5	10	8	40	12	12	88.1	2	40
RHR1-12.088.01	RHR1-12.088.04	88	100	M5	10	8	40	12	12	132.5	3	48
RHR1-12.120.01	RHR1-12.120.04	120	132	M5	10	8	40	12	12	177	4	56
RHR1-12.180.01	RHR1-12.180.04	180	192	M5	10	8	40	12	12	221.5	5	70
RHR1-12.235.01	RHR1-12.235.04	235	247	M5	10	8	40	12	12	266	6	85

**RHR3**

Code	Code	f	L	d	li	B	h	l	li	G	HE*	⚖
RHR3-12.055.01	RHR3-12.055.04	55	67	M5	9	8	40	12	12	88.1	2	35
RHR3-12.088.01	RHR3-12.088.04	88	100	M5	9	8	40	12	12	132.5	3	46
RHR3-12.120.01	RHR3-12.120.04	120	132	M5	9	8	40	12	12	177	4	70
RHR3-12.180.01	RHR3-12.180.04	180	192	M5	9	8	40	12	12	221.5	5	85
RHR3-12.235.01	RHR3-12.235.04	235	247	M5	9	8	40	12	12	266	6	85

HE\* = height unit of the front panel: 1 HE = 44.45 mm = 1 6/8".