



LC Bandpass Filter

Part Number: AE160B5108

Center Frequency: 160MHz

Insertion Loss: <2dB

Passband: 152-168MHz

Return Loss @ Passband: >14dB

Rejection: >50dB @ 0-112MHz

>50dB @ 208-1000MHz

Power Handling: 5 Watts

Outline Drawing:

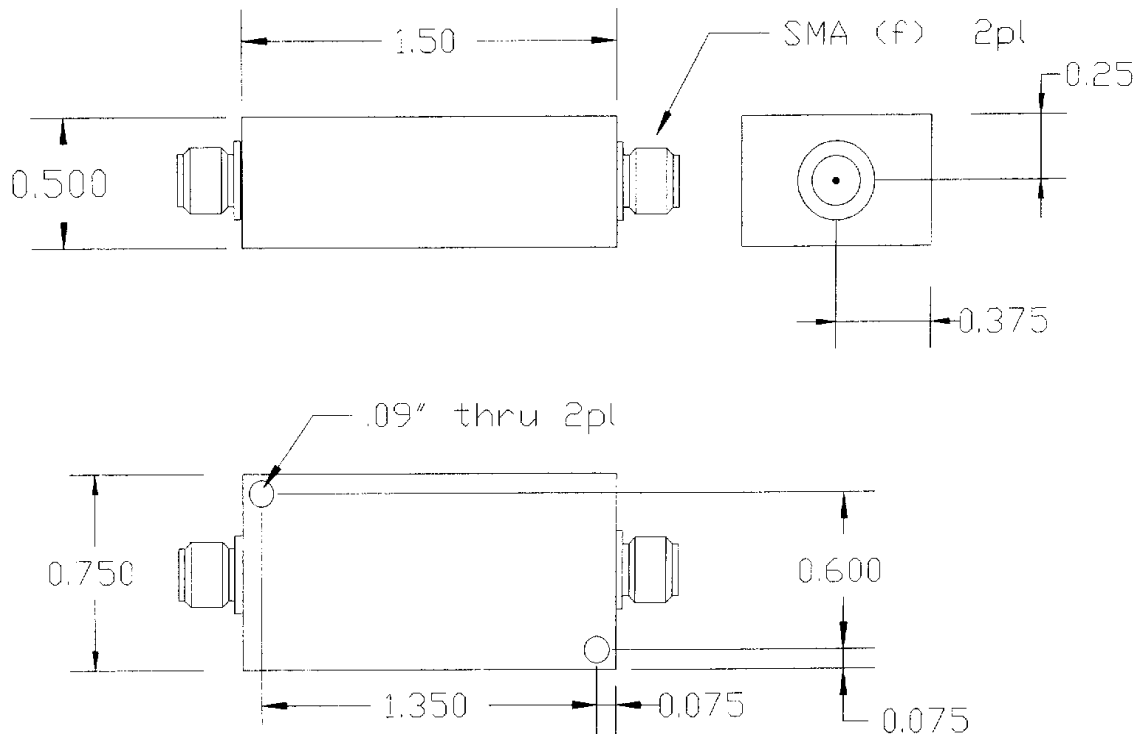



LC Bandpass Filter
 Part Number: AE160B5108

Response Plot:

