

MATERIALS AND FINISHES

BODY: BRASS
PLATED: NICKEL (70u-in MIN)

CENTER CONTACT: PHOSPOR BRONZE
PLATED: SELECTIVE GOLD (1u-in MIN AT TIP)
PLATED: TIN (50u-in MIN REST OF PART)

CRIMP TUBE: COPPER
PLATED: NICKEL (70u-in MIN)

OUTER CASING: NYLON 66 OR EQUIVALENT
KEYING: SEE TABLE
COLOR: SEE TABLE

INSULATOR: POLYPROPYLENE

PACKAGING BY BAG

NOTE:
1. 250 PCS (89618-37XX) PER ZIPLOCK BAG.
NOTICE: THE BAG MUST BE COMPLETELY SEALED.
TEMPERATURE -10° TO 40° HUMIDITY <75%

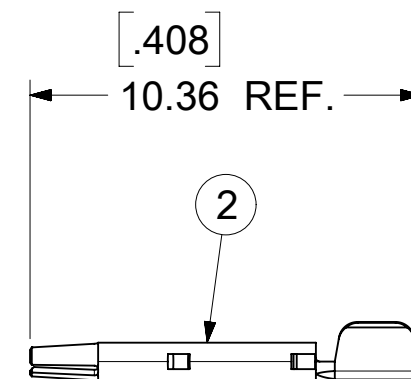
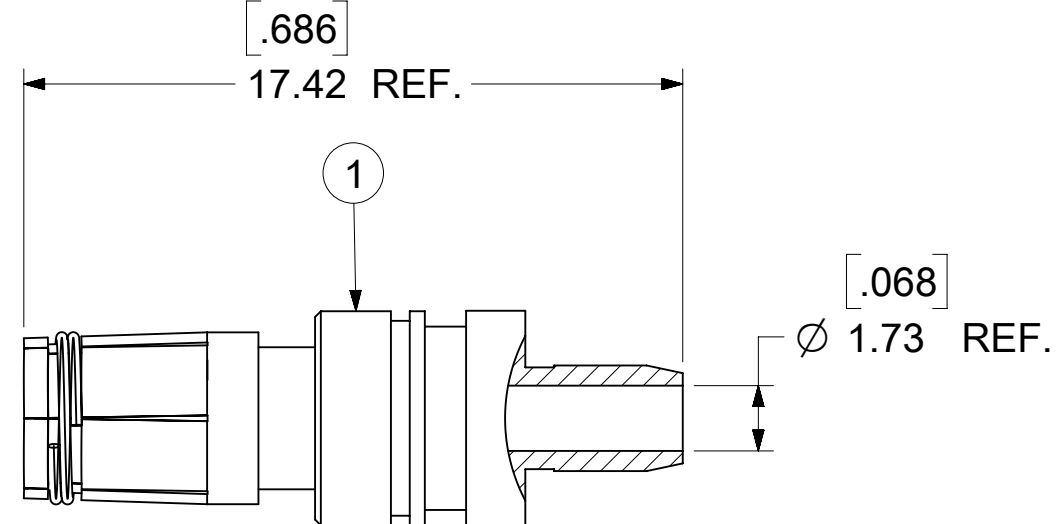
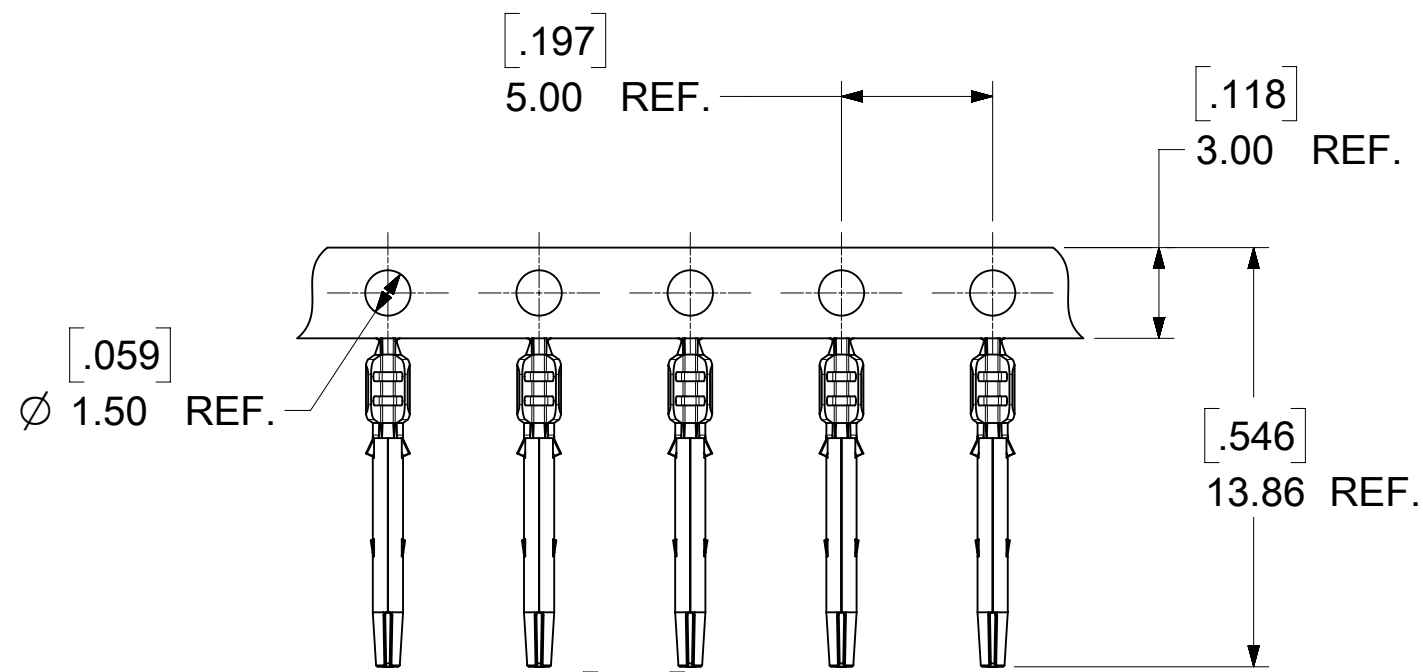

CINTACT

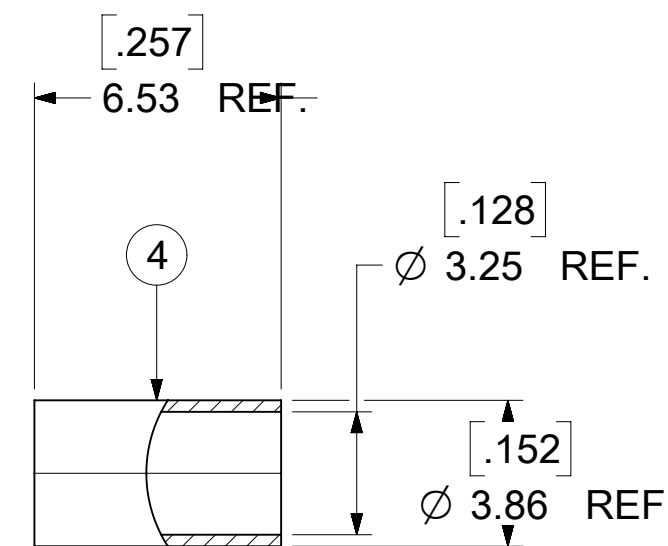
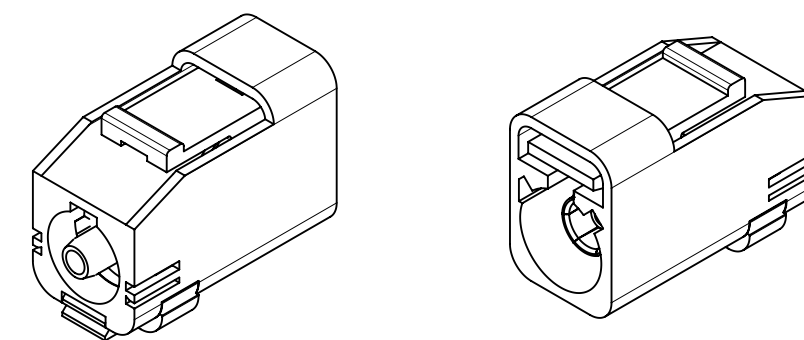

CRIMP TUBE

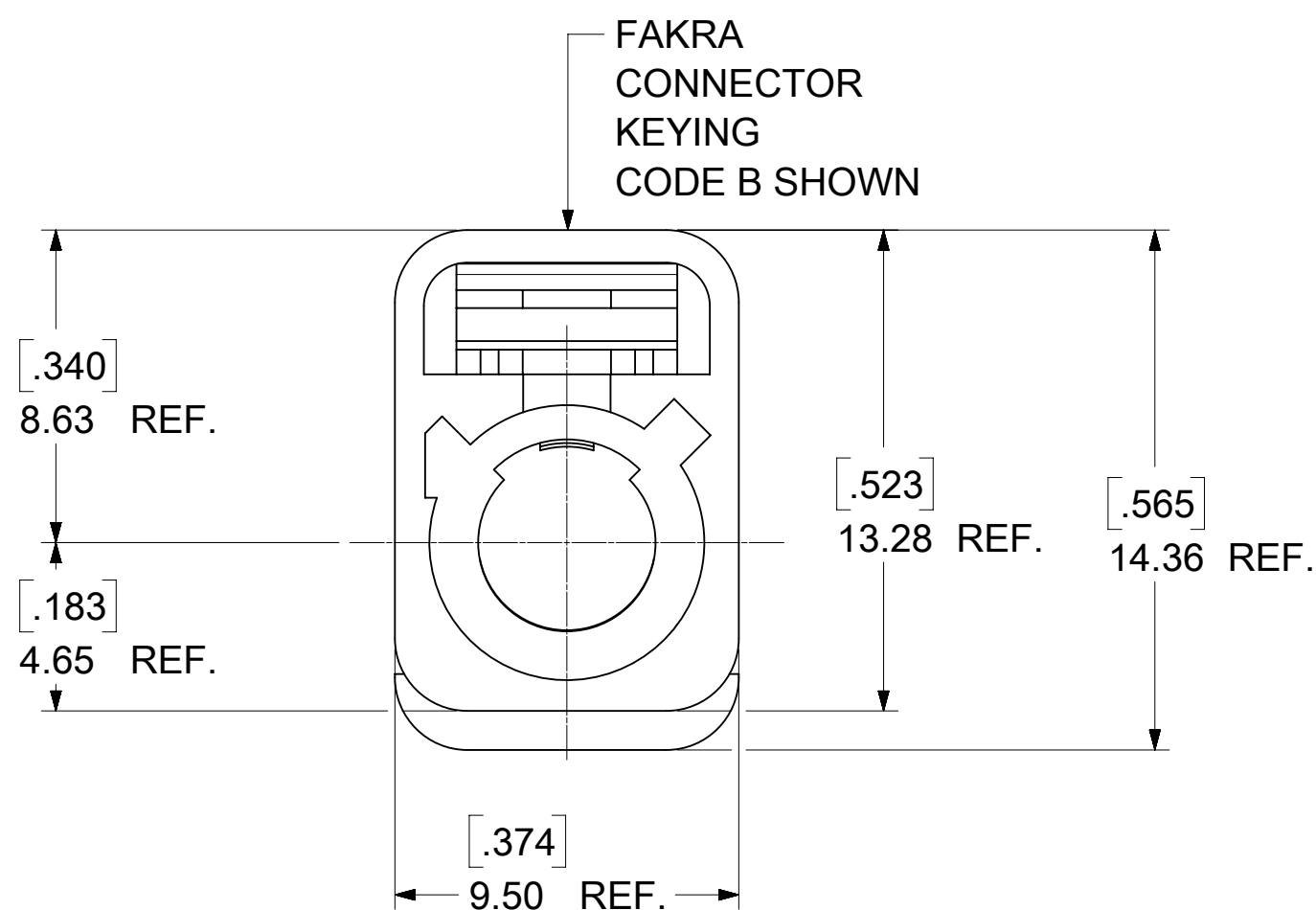

FAKRA
CONNECTOR
KEYING
CODE B SHOWN

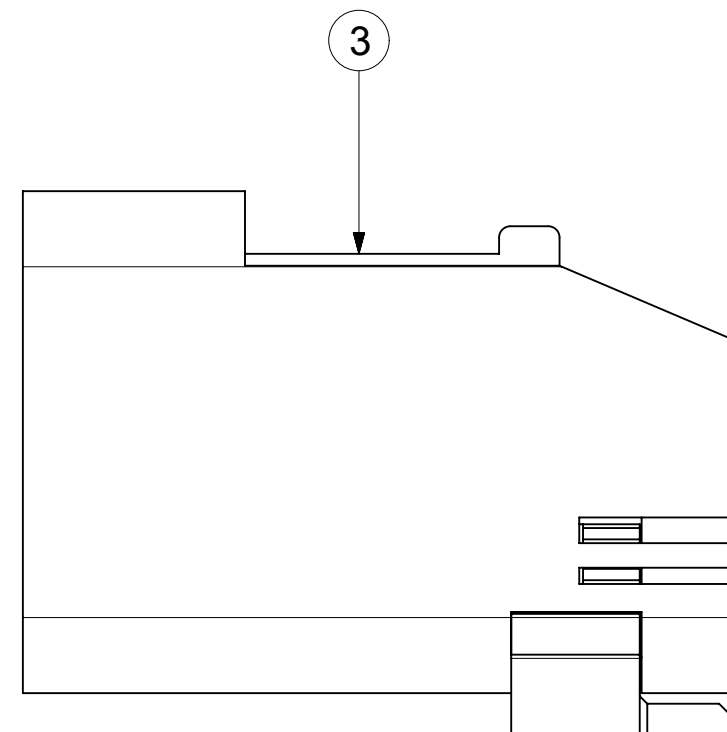

SECONDARY LOCK
(TPA)

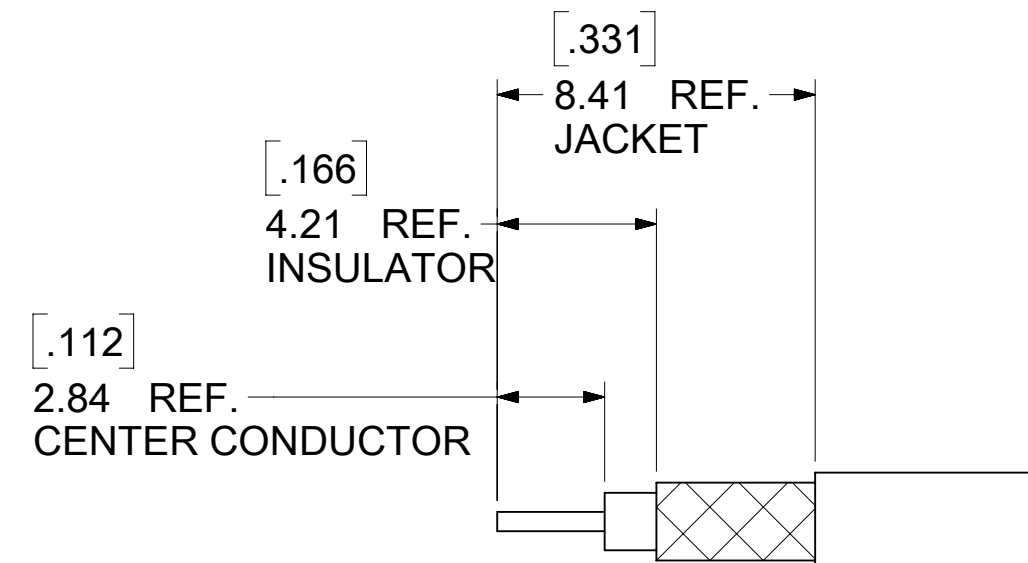

RECOMMENDED CABLE STRIP

PART # SEE SHEET 2

PS-89675-331	PRODUCT SPECIFICATION
DIN 72594-1	INTERFACE SPECIFICATION
SPECIFICATION	DESCRIPTION

DATE	REV.	DESCRIPTION
2019/04/08	C8	UPDATED "E" CODE PER EWR # 11896-D
2018/04/02	C7	REMOVED II FROM TITLE PER 11896
2016/05/26	C6	ADDED PACKAGE DRAWING PER RF16-E082

4	89506-0226	CRIMP TUBE	1
3	SEE SHEET 2	SHROUD WITH TPA	1
2	89538-0251	CENTER CONTACT	1
1	89618-3500	SMB PLUG STR. FOR RG316	1
	PART NO.	DESCRIPTION	QTY

SYMBOLS		THIS DRAWING CONTAINS INFORMATION THAT IS PROPRIETARY TO MOLEX ELECTRONIC TECHNOLOGIES, LLC AND SHOULD NOT BE USED WITHOUT WRITTEN PERMISSION	
▽ = 0	HYBRID	SCALE	CURRENT REV DESC:
▽ = 0	NTS		
▽ = 0	GENERAL TOLERANCES (UNLESS SPECIFIED)		
▽ = 0	ANGULAR TOL ± 2.0°	EC NO: 615362	
▽ = 0	4 PLACES ±	DRWN: ELIN	2019/04/08
▽ = 0	3 PLACES ±	CHK'D: YCHENG	2019/04/16
▽ = 0	2 PLACES ±	APPR: YCHENG	2019/04/16
▽ = 0	1 PLACE ±	INITIAL REVISION:	
▽ = 0	0 PLACES ±	DRWN: ELIN	2011/02/15
▽ = 0	DRAFT WHERE APPLICABLE MUST REMAIN WITHIN DIMENSIONS	APPR: MHUANG	2011/05/27
▽ = 0	THIRD ANGLE PROJECTION	DRAWING	SERIES
		C-SIZE	73403

FAKRA PLUG STR. FOR RG316,174 CABLE FAKRA -PC

PRODUCT CUSTOMER DRAWING

DOCUMENT NUMBER: SD-73403-574 DOC TYPE: PSD DOC PART: 001 REVISION: C8

MATERIAL NUMBER: SEE TABLE CUSTOMER: GENERAL MARKET SHEET NUMBER: 1 OF 3

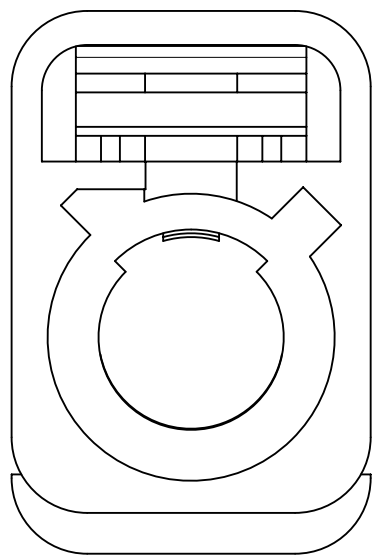

CODE A

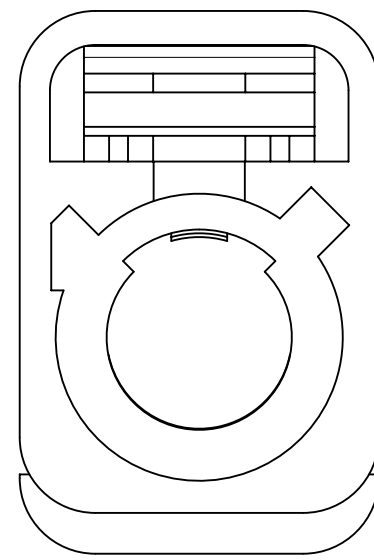

CODE B

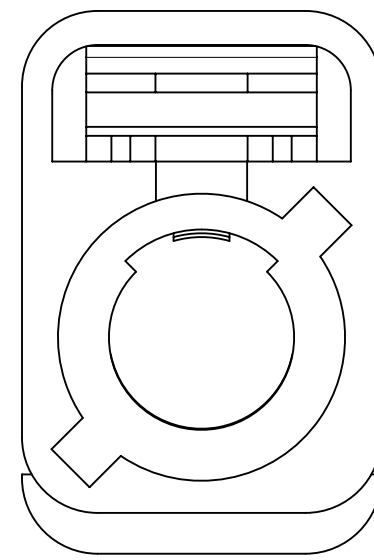

CODE C

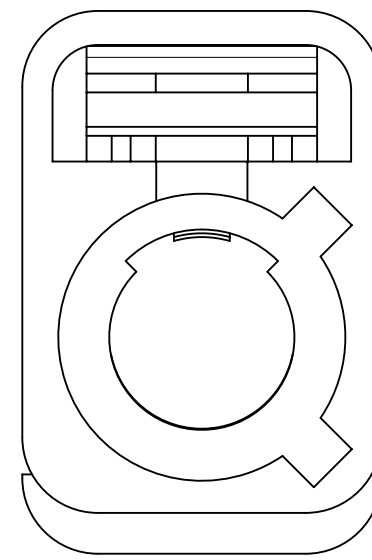

CODE D

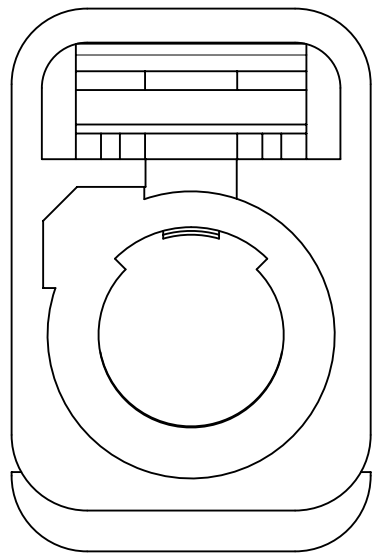

CODE E

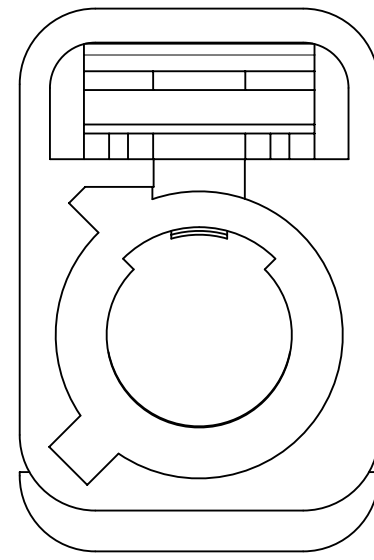

CODE F

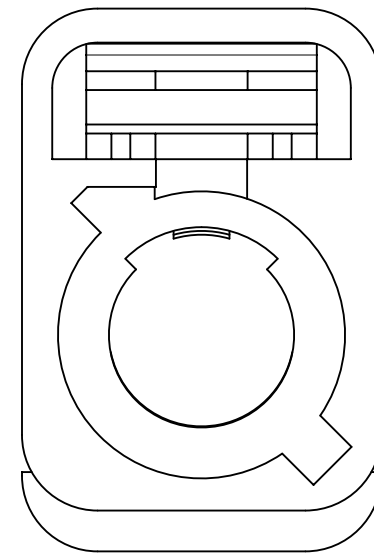

CODE G

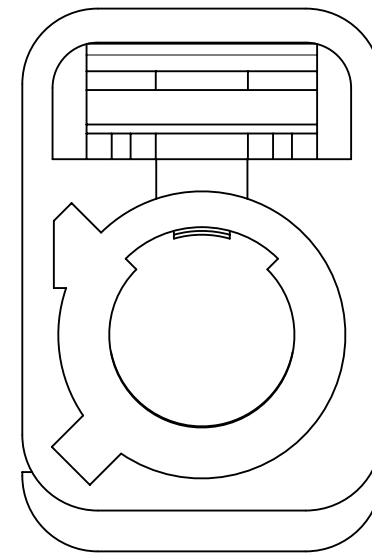

CODE H

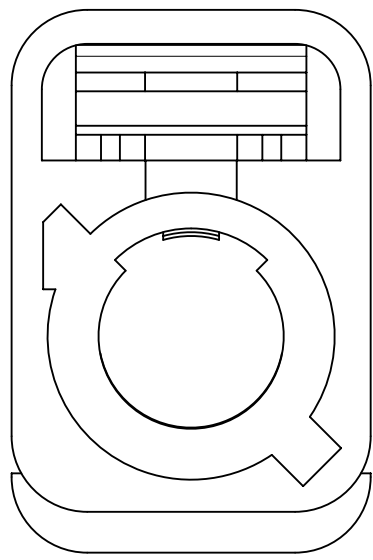

CODE I

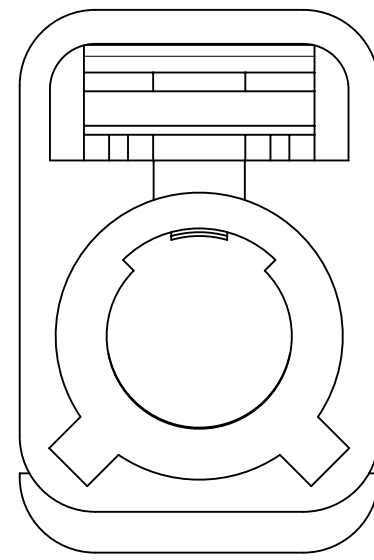

CODE K

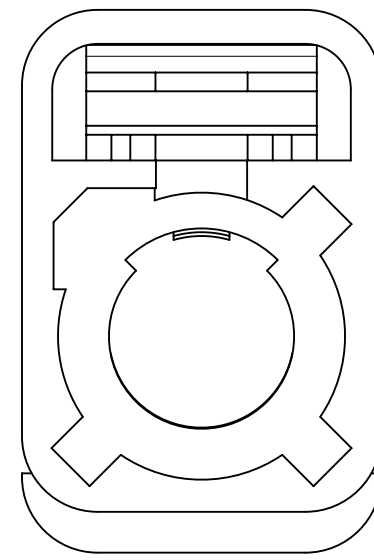

CODE Z

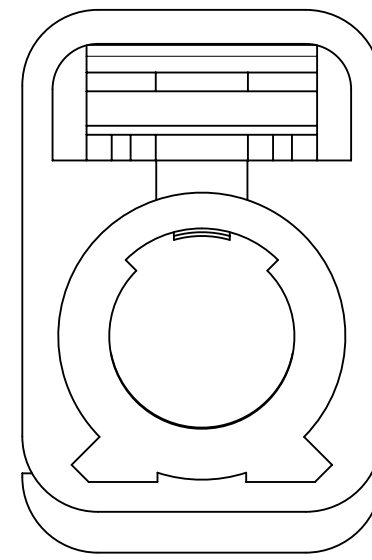

CODE L

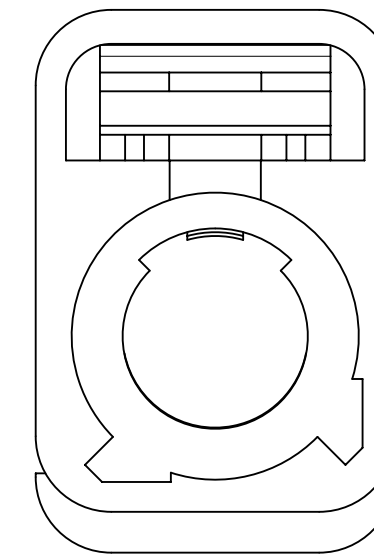

CODE M

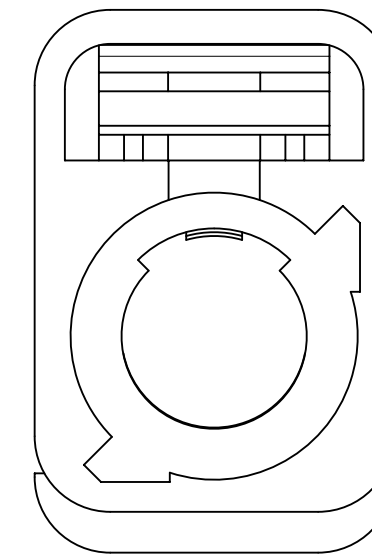

CODE N

N	PASTEL GREEN	73403-5753	89618-3743
M	PASTEL ORANGE	73403-5752	89618-3742
L	CARMINE RED	73403-5751	89618-3741
Z	WATER BLUE	73403-5750	89618-3740
K	CURRY YELLOW	73403-5749	89618-3739
I	BEIGN	73403-5748	89618-3738
H	VIOLET	73403-5747	89618-3737
G	GRAY	73403-5746	89618-3736
F	BROWN	73403-5745	89618-3735
E	GREEN	73403-5744	89618-3734
D	BORDEAUXVILOET	73403-5743	89618-3733
C	BLUE	73403-5742	89618-3732
B	SINGLE WHITE	73403-5741	89618-3731
A	BLACK	73403-5740	89618-3730
KEYING CODE	COLOR	PART NO.	ITEM 3 PART NO.

SYMBOLS ▽ = 0 ▽ = 0 ▽ = 0 ▽ = 0 ▽ = 0 ▽ = 0 ▽ = 0 ▽ = 0 ▽ = 0	THIS DRAWING CONTAINS INFORMATION THAT IS PROPRIETARY TO MOLEX ELECTRONIC TECHNOLOGIES, LLC AND SHOULD NOT BE USED WITHOUT WRITTEN PERMISSION		
	DIMENSION UNITS	SCALE	CURRENT REV DESC:
	HYBRID	NTS	
	GENERAL TOLERANCES (UNLESS SPECIFIED)		EC NO: 615362
	ANGULAR TOL	± 2.0°	DRWN: ELIN 2019/04/08
	4 PLACES	±	CHK'D: YCHENG 2019/04/16
3 PLACES	±	APPR: YCHENG 2019/04/16	
2 PLACES	±	INITIAL REVISION:	
1 PLACE	±	DRWN: ELIN 2011/02/15	
0 PLACES	±	APPR: MHUANG 2011/05/27	
DRAFT WHERE APPLICABLE MUST REMAIN WITHIN DIMENSIONS	THIRD ANGLE PROJECTION	DRAWING	SERIES
		C-SIZE	73403

molex			
FAKRA PLUG STR. FOR RG316,174 CABLE FAKRA -PC			
PRODUCT CUSTOMER DRAWING			
DOCUMENT NUMBER	DOC TYPE	DOC PART	REVISION
SD-73403-574	PSD	001	C8
MATERIAL NUMBER	CUSTOMER	SHEET NUMBER	
SEE TABLE	GENERAL MARKET	2 OF 3	

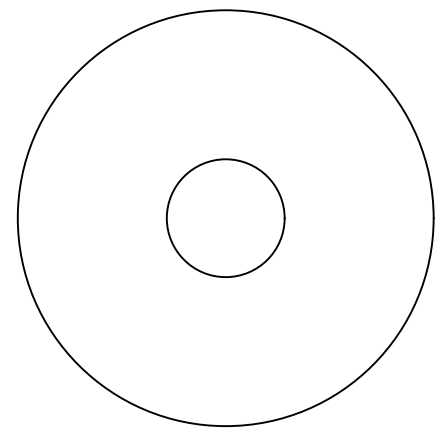

P/N: 89538-0251
1000 PCS PER REEL

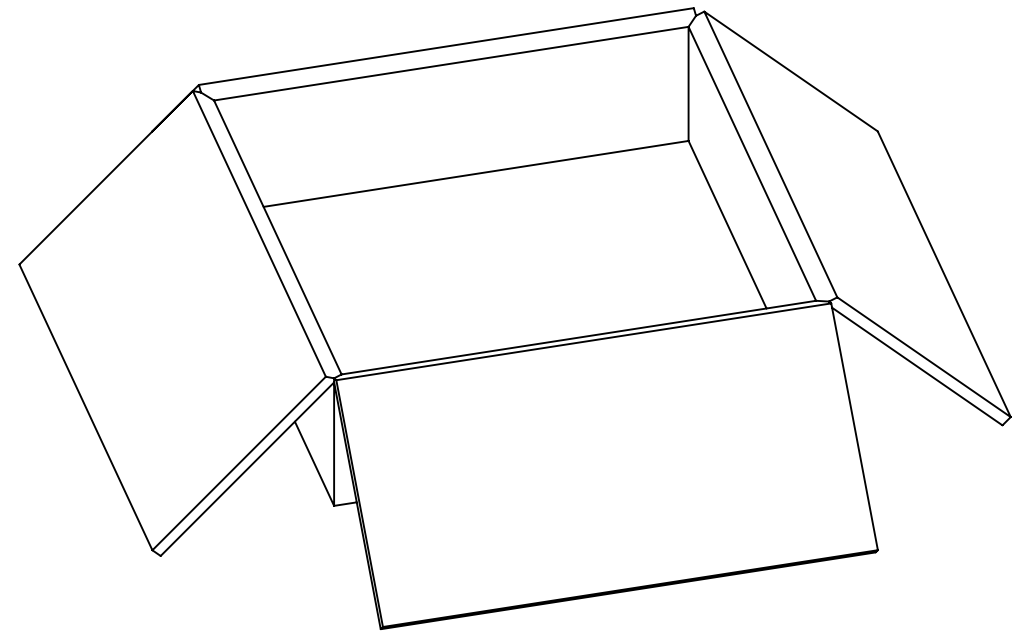

1000 PCS PER INNER
CARTON BOX
325 X 325 X 85 REF.

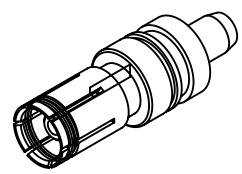

P/N: 89618-3500

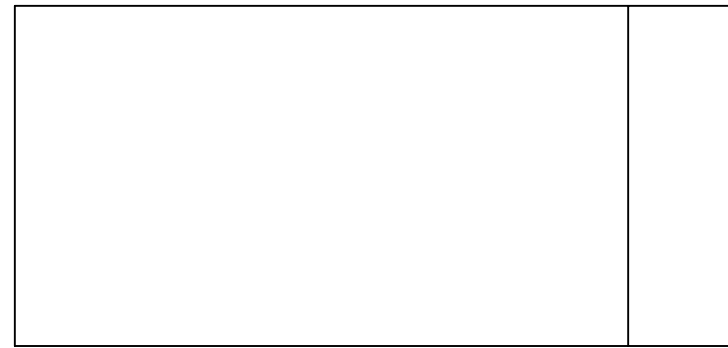

250 PCS PER PE BAG

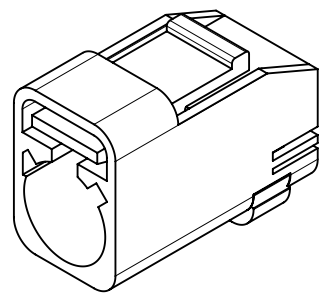

P/N: 89618-373X



250 PCS PER PE BAG

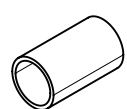

P/N: 89506-0226



250 PCS PER PE BAG

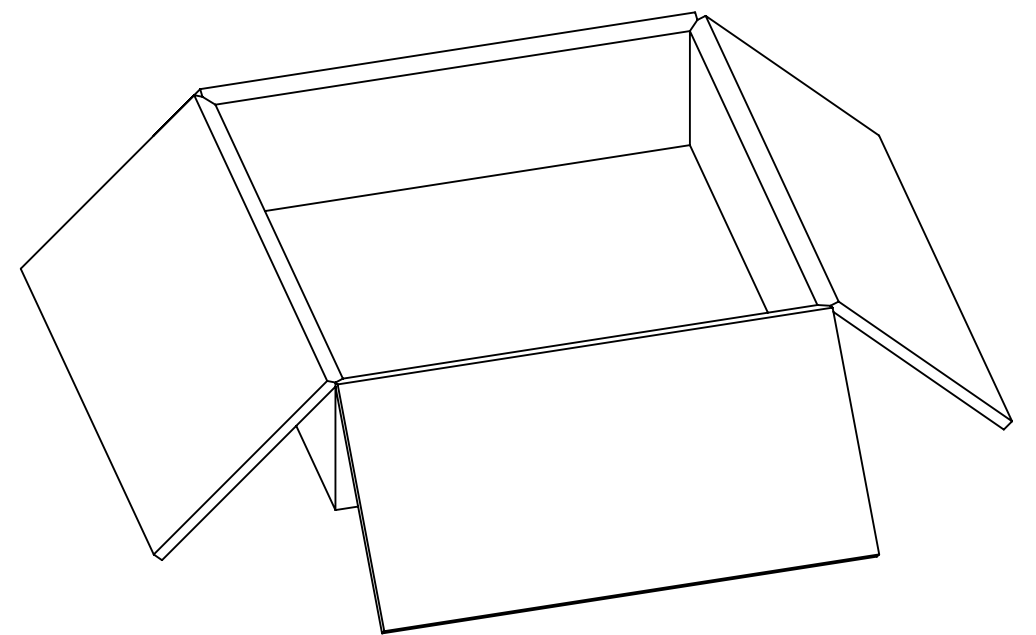

1000 SETS PER OUTER CARTON BOX
385 X 367 X 206 REF.

SYMBOLS	THIS DRAWING CONTAINS INFORMATION THAT IS PROPRIETARY TO MOLEX ELECTRONIC TECHNOLOGIES, LLC AND SHOULD NOT BE USED WITHOUT WRITTEN PERMISSION										
	DIMENSION UNITS	SCALE	CURRENT REV DESC:								
= 0	HYBRID	NTS	EC NO: 615362 DRWN: ELIN 2019/04/08 CHK'D: YCHENG 2019/04/16 APPR: YCHENG 2019/04/16								
= 0	GENERAL TOLERANCES (UNLESS SPECIFIED)									INITIAL REVISION: DRWN: ELIN 2011/02/15 APPR: MHUANG 2011/05/27	
= 0	ANGULAR TOL ± 2.0°		DOCUMENT NUMBER: SD-73403-574 DOC TYPE: PSD DOC PART: 001 REVISION: C8								
= 0	4 PLACES	±								MATERIAL NUMBER: SEE TABLE CUSTOMER: GENERAL MARKET SHEET NUMBER: 3 OF 3	
= 0	3 PLACES	±	DRAFT WHERE APPLICABLE MUST REMAIN WITHIN DIMENSIONS		THIRD ANGLE PROJECTION	DRAWING	SERIES				
= 0	2 PLACES	±				C-SIZE	73403				
= 0	1 PLACE	±									
= 0	0 PLACES	±									

NOTES:

1. MATERIAL: SKD11
2. THE PART NO. 73575-0020/-0021/-0022/-0023 FOR SPECIFIC APPLICATORS.
(SPECIFIC APPLICATORS MODEL: CLM-4S)
3. THE SPECIFIC APPLICATORS CRIMP DIE CAN BE APPLIED TO 89538-025* AND 89601-896*.
4. AS-73597-042 AND AS-73597-043.

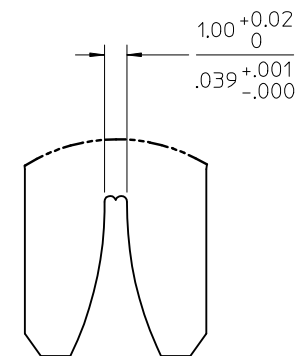
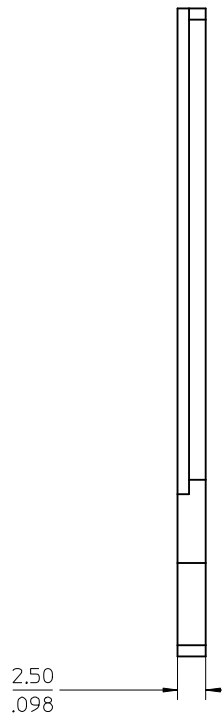
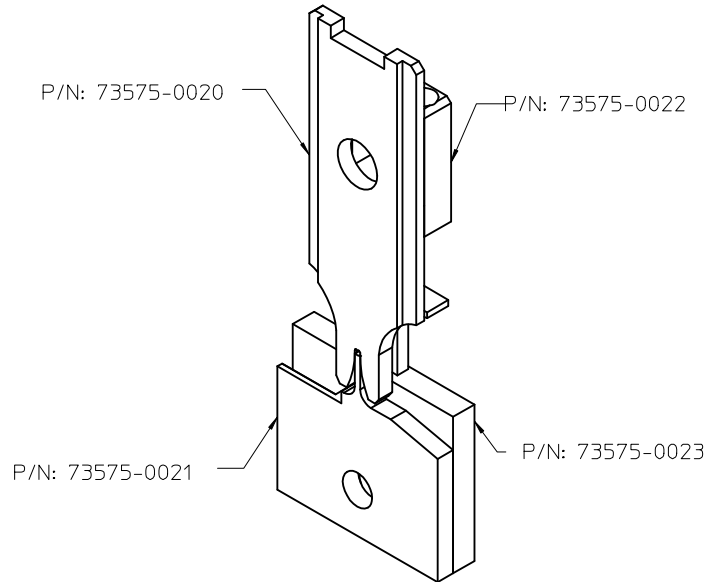
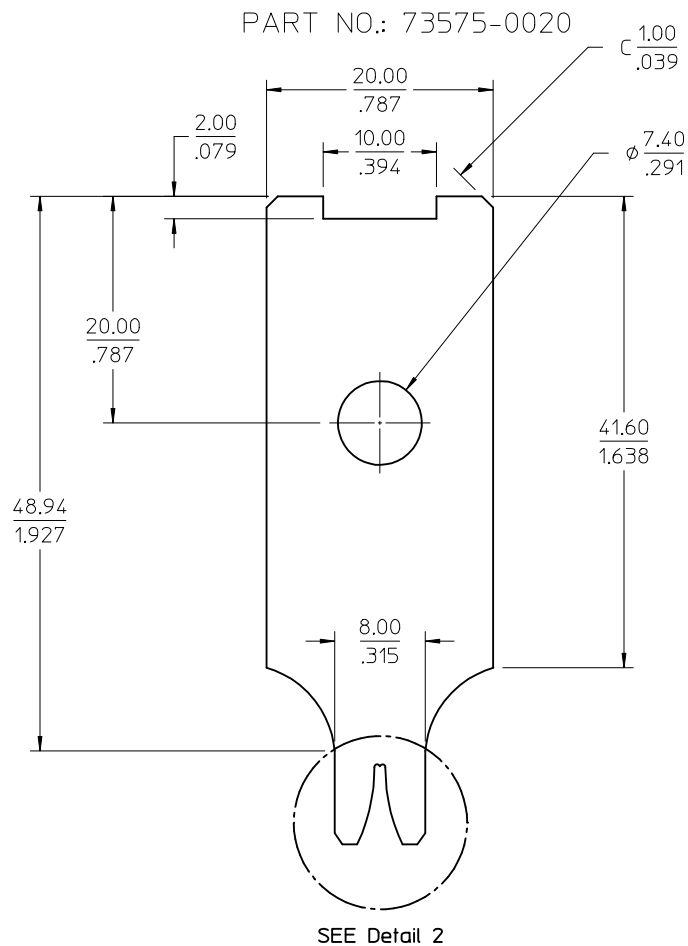

Detail 2
Scale 6:1

DESIGN CHANGE PER RF15-E097 EC NO: URF2015-0345 DRWNLIN 2015/01/05 CHKD: DRWNLIN APPR: YCHENG 2015/04/16 DESCRIPTION	QUALITY SYMBOLS	GENERAL TOLERANCES (UNLESS SPECIFIED)	DIMENSION STYLE	SCALE	DESIGN UNITS	THIRD ANGLE PROJECTION
	▽=0	mm INCH	MM/IN	4:1	METRIC	☉
	▽=0	4 PLACES ± --- ± ---	DRAWN BY DATE	TITLE	FAKRA CRIMPING DIE FOR SPECIFIC APPLICATORS	
	▽=0	3 PLACES ± --- ± ---	CHECKED BY DATE	molex DOCUMENT NO. SD-73575-002 SHEET NO. 1 OF 4		
	▽=0	2 PLACES ± --- ± ---	KERRIE/PAT 2014/11/21			
REV	1 PLACE ± --- ± ---	APPROVED BY DATE	THIS DRAWING CONTAINS INFORMATION THAT IS PROPRIETARY TO MOLEX INCORPORATED AND SHOULD NOT BE USED WITHOUT WRITTEN PERMISSION			
	0 PLACE ± --- ± ---	YCHENG 2014/12/01				

1.000⁰
-0.020
0.039^{+0.000}
-0.001

PART NO.: 73575-0021

Detail 1
Scale 20:1

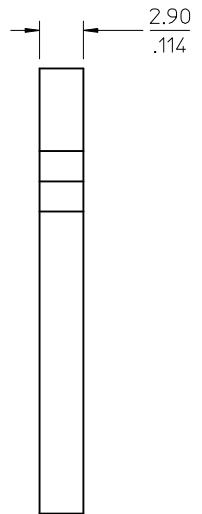
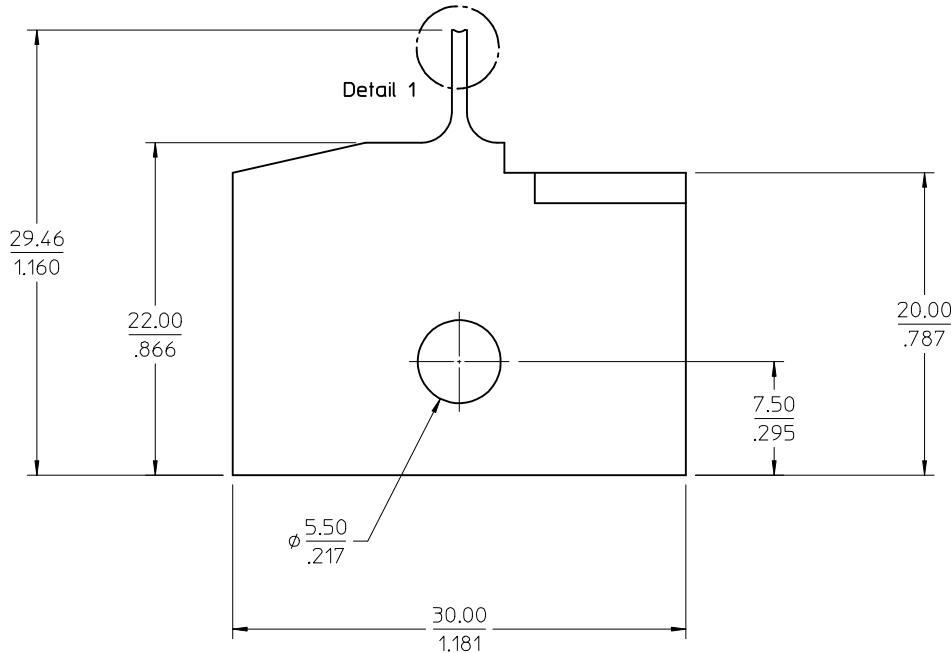

SEE SHEET 1 EC NO: URF2015-0345 DRWN: ELIN 2015/01/05 CHKD: JAPPR: YCHENG 2015/04/16 APPR: YCHENG	QUALITY SYMBOLS	GENERAL TOLERANCES (UNLESS SPECIFIED)		DIMENSION STYLE		SCALE	DESIGN UNITS	THIRD ANGLE PROJECTION	
	▽=0	mm	INCH	MM/IN		1:1	METRIC		
	▽=0	4 PLACES ± --- ± ---	EL IN	DATE	TITLE				
	▽=0	3 PLACES ± --- ± ---	2014/11/21	FAKRA CRIMPING DIE FOR SPECIFIC APPLICATORS					
		2 PLACES ± --- ± ---	CHECKED BY	DATE					
		1 PLACE ± --- ± ---	KERRIE/PAT	2014/11/21					
		0 PLACE ± --- ± ---	APPROVED BY	DATE	MATERIAL NO. DOCUMENT NO. SHEET NO. SEE SHEET 1 SD-73575-002 2 OF 4				
		ANGULAR ± 2 °	YCHENG	2014/12/01					
		DRAFT WHERE APPLICABLE MUST REMAIN WITHIN DIMENSIONS		SIZE		THIS DRAWING CONTAINS INFORMATION THAT IS PROPRIETARY TO MOLEX INCORPORATED AND SHOULD NOT BE USED WITHOUT WRITTEN PERMISSION			

PART NO.: 73575-0022

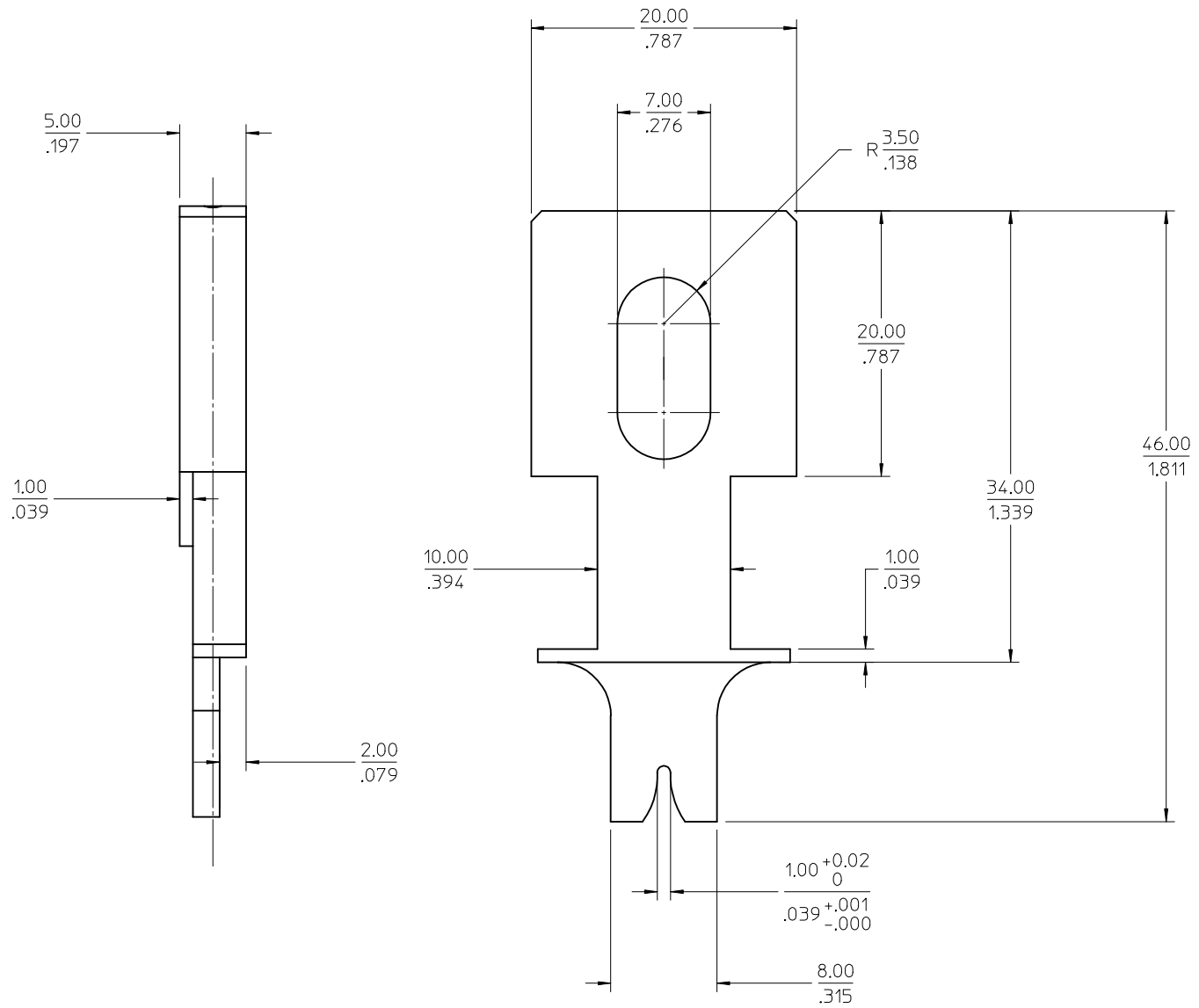

SEE SHEET 1 EC NO: URF2015-0345 DRAWN BY: DRWNLIN 2015/01/05 CHKD: APPR: YCHENG 2015/04/16 DESCRIPTION:	QUALITY SYMBOLS	GENERAL TOLERANCES (UNLESS SPECIFIED)	DIMENSION STYLE	SCALE	DESIGN UNITS	THIRD ANGLE PROJECTION
	▽=0	mm INCH	MM/IN	4:1	METRIC	
	▽=0	4 PLACES ± --- ± ---	DRAWN BY DATE	TITLE		
	▽=0	3 PLACES ± --- ± ---	EL IN 2014/11/21	FAKRA CRIMPING DIE FOR SPECIFIC APPLICATORS		
	2 PLACES ± --- ± ---	1 PLACE ± --- ± ---	CHECKED BY DATE			
	0 PLACE ± --- ± ---	0 PLACE ± --- ± ---	KERRIE/PAT 2014/11/21			
			APPROVED BY DATE	DOCUMENT NO.		
			YCHENG 2014/12/01	SD-73575-002		
		ANGULAR ± 2°	MATERIAL NO.	SHEET NO.		
		DRAFT WHERE APPLICABLE MUST REMAIN WITHIN DIMENSIONS	SEE SHEET 1	3 OF 4		
			SIZE C	THIS DRAWING CONTAINS INFORMATION THAT IS PROPRIETARY TO MOLEX INCORPORATED AND SHOULD NOT BE USED WITHOUT WRITTEN PERMISSION		

PART NO.: 73575-0023

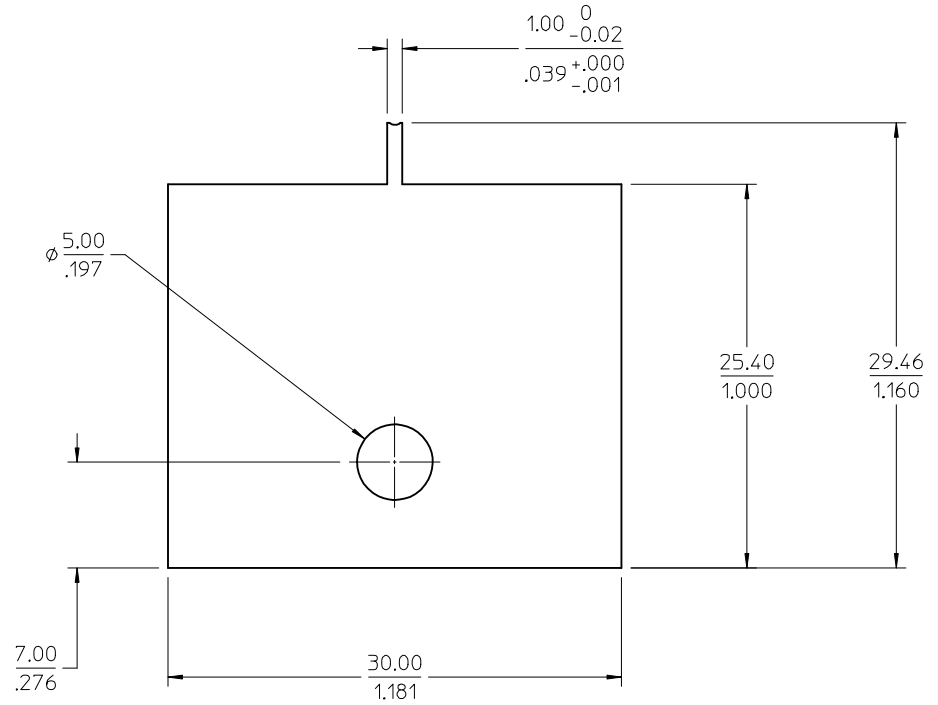
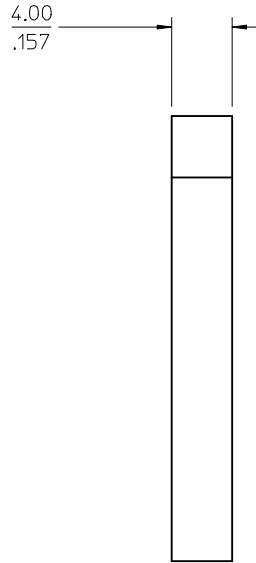

SEE SHEET 1 EC NO: URF2015-0345 DRAWN BY: DRWNLIN 2015/01/05 CHKD: APPR: YCHENG 2015/04/16	QUALITY SYMBOLS	GENERAL TOLERANCES (UNLESS SPECIFIED)		DIMENSION STYLE	SCALE	DESIGN UNITS	THIRD ANGLE PROJECTION	
	▽=0	mm	INCH	MM/IN	4:1	METRIC		
	▽=0	4 PLACES ± ---	± ---	DRAWN BY	DATE	TITLE		
	▽=0	3 PLACES ± ---	± ---	EL IN	2014/11/21	FAKRA CRIMPING DIE FOR SPECIFIC APPLICATORS		
		2 PLACES ± ---	± ---	CHECKED BY	DATE			
		1 PLACE ± ---	± ---	KERRIE/PAT	2014/11/21			
		0 PLACE ± ---	± ---	APPROVED BY	DATE			
				YCHENG	2014/12/01			
		ANGULAR ± 2°		MATERIAL NO.	DOCUMENT NO.	SHEET NO.		
		DRAFT WHERE APPLICABLE MUST REMAIN WITHIN DIMENSIONS		SEE SHEET 1	SD-73575-002	4 OF 4		
		THIS DRAWING CONTAINS INFORMATION THAT IS PROPRIETARY TO MOLEX INCORPORATED AND SHOULD NOT BE USED WITHOUT WRITTEN PERMISSION						

MATERIALS AND FINISHS

BODY BRASS
PLATED NICKEL

INSULATOR PP

RETAINING RING STEEL (SUS304)

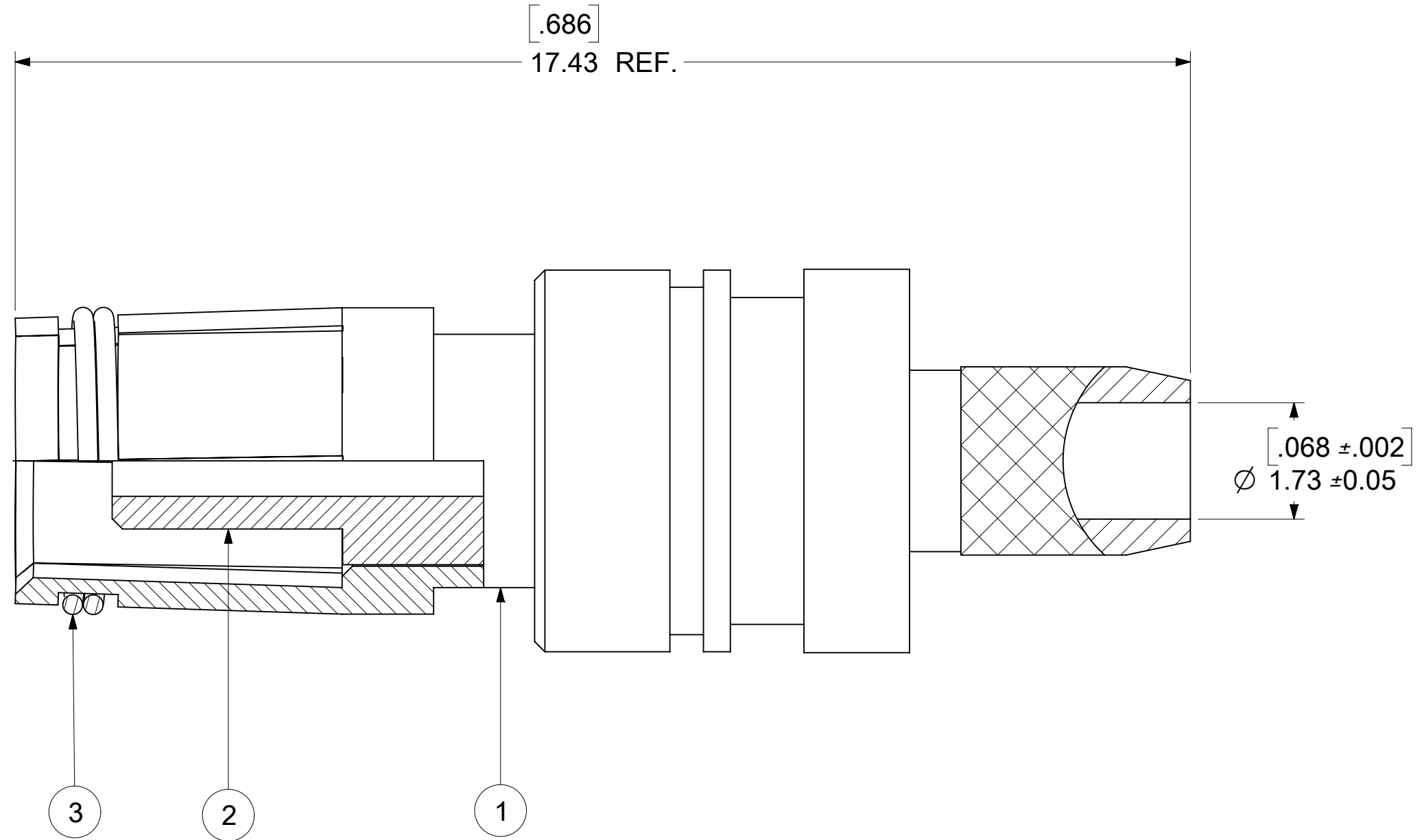
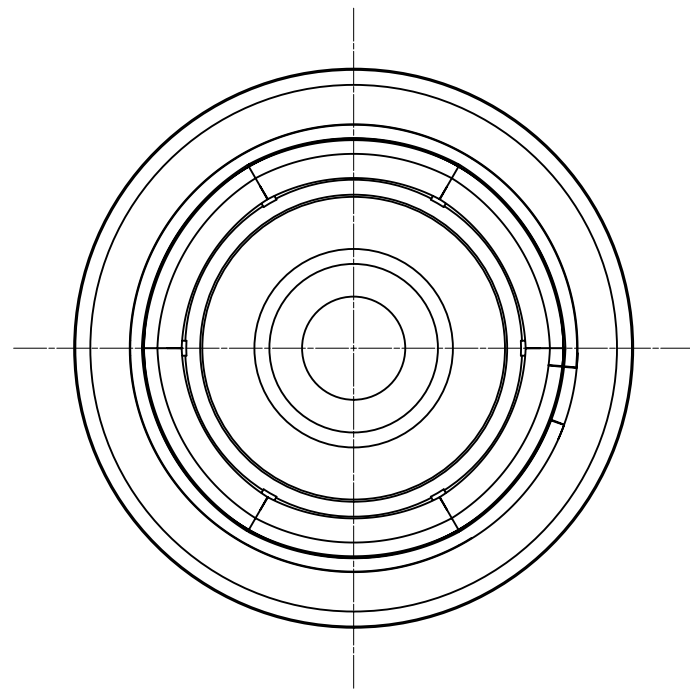
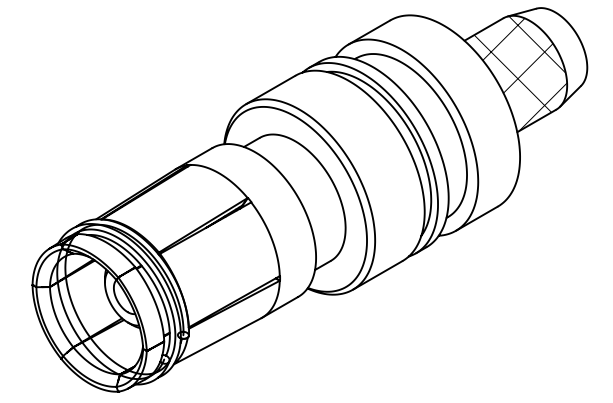

PART # 89618-3500

3	89615-2060	RETAINING RING	1
2	89621-4400	INSULATOR	1
1	89696-7891	BODY	1
	PART NO.	DESCRIPTION	QTY

2018/10/17	C5	REMOVE II PER EWR # 11896-B
2015/04/27	C4	TYP0
DATE	REV.	DESCRIPTION

DOCUMENT STATUS	P1	RELEASE DATE	2018/10/23	08:38:35
-----------------	----	--------------	------------	----------

SYMBOLS	THIS DRAWING CONTAINS INFORMATION THAT IS PROPRIETARY TO MOLEX ELECTRONIC TECHNOLOGIES, LLC AND SHOULD NOT BE USED WITHOUT WRITTEN PERMISSION			
	DIMENSION UNITS	SCALE	CURRENT REV DESC:	
▽ = 0	HYBRID	NTS	EC NO: 606239 DRWN: ELIN 2018/10/17 CHK'D: YCHENG 2018/10/23 APPR: YCHENG 2018/10/23 INITIAL REVISION: DRWN: ELIN 2013/11/07 APPR: MHUANG 2014/04/16	
▽ = 0	GENERAL TOLERANCES (UNLESS SPECIFIED)			
▽ = 0	ANGULAR TOL ± 2.0°			
▽ = 0	4 PLACES	±		
▽ = 0	3 PLACES	±	DOCUMENT NUMBER: SD-89618-350 DOC TYPE: PSD DOC PART: 001 REVISION: A1	
▽ = 0	2 PLACES	±		
▽ = 0	1 PLACE	±	MATERIAL NUMBER: SEE TABLE CUSTOMER: GENERAL MARKET SHEET NUMBER: 1 OF 1	
▽ = 0	0 PLACES	±		
▽ = 0	DRAFT WHERE APPLICABLE MUST REMAIN WITHIN DIMENSIONS	THIRD ANGLE PROJECTION	DRAWING	SERIES
▽ = 0			C-SIZE	89618

molex

FAKRA SUB ASSY FOR
RG316,174 CABLE SA-SMB-P

PRODUCT CUSTOMER DRAWING

SD-89618-350

PSD 001 A1

SEE TABLE GENERAL MARKET 1 OF 1

MATERIALS AND FINISHES

OUTER CASING: NYLON 66 OR EQUIVALENT

KEYING: SEE TABLE

COLOR: SEE TABLE

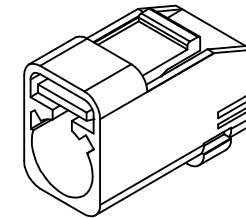

NOTES:

- 250 PCS (89618-37XX) PER ZIPLOCK BAG.
NOTICE: THE BAG MUST BE COMPLETELY SEALED.
- STORAGE CONDITIONS:
TEMPERATURE -10° TO 40°C HUMIDITY <75%

FAKRA
CONNECTOR
KEYING
CODE B SHOWN

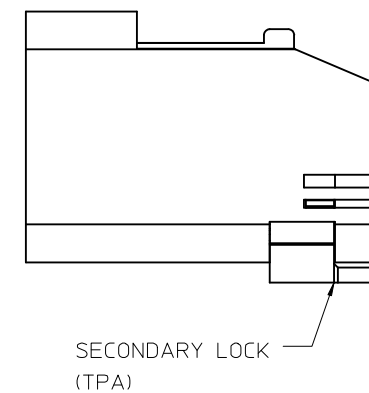
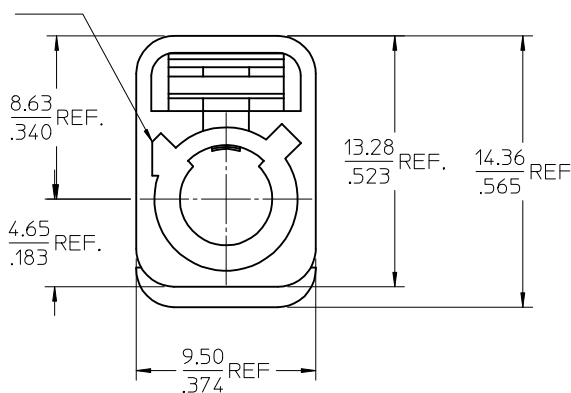

ADDED NOTES PER RFR15-E102 EC NO: URF2015-0316 DRWNLIN 2015/01/26 CHKD: APPR: YCHENG 2015/02/03	QUALITY SYMBOLS	GENERAL TOLERANCES (UNLESS SPECIFIED)	DIMENSION STYLE	SCALE	DESIGN UNITS	THIRD ANGLE PROJECTION
	▽=0	mm INCH	MM/IN	5:1	METRIC	
	▽=0	4 PLACES ± --- ± ---	DRAWN BY DATE	TITLE		
	▽=0	3 PLACES ± --- ± ---	EL IN 2013/11/07	SUB ASSY SHROUD WITH SECONDARY LOCKING		
		2 PLACES ± --- ± ---	CHECKED BY DATE	molex SD-89618-373		
		1 PLACE ± --- ± ---	JUDY 2013/11/07			
		0 PLACE ± --- ± ---	APPROVED BY DATE	DOCUMENT NO.		
		ANGULAR ± 2 °	MHUANG 2014/04/16	1 OF 2		
		DRAFT WHERE APPLICABLE MUST REMAIN WITHIN DIMENSIONS	MATERIAL NO.	SHEET NO.		
			SEE SHEET 2	1 OF 2		
			SIZE C	THIS DRAWING CONTAINS INFORMATION THAT IS PROPRIETARY TO MOLEX INCORPORATED AND SHOULD NOT BE USED WITHOUT WRITTEN PERMISSION		

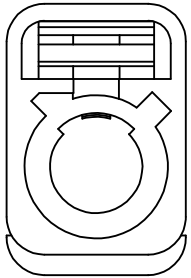

CODE A

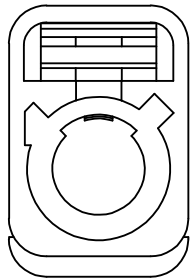

CODE B

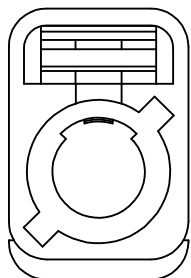

CODE C

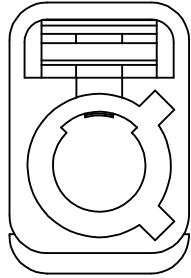

CODE D

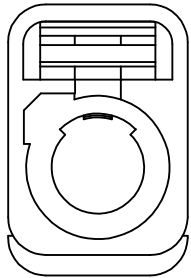

CODE E

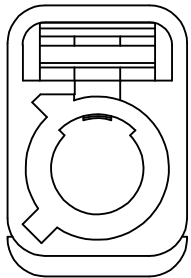

CODE F

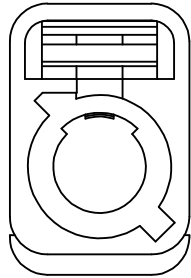

CODE G

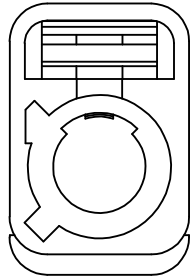

CODE H

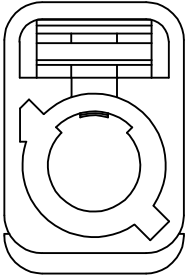

CODE I

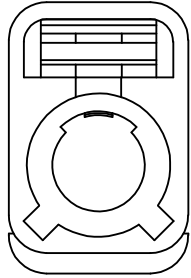

CODE K

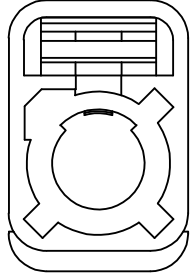

CODE Z

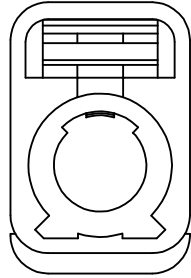

CODE L

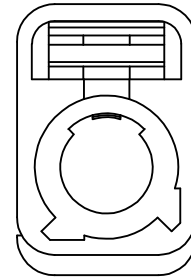

CODE M

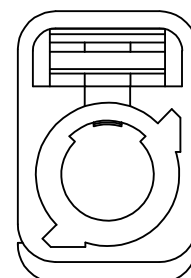

CODE N

N	PASTEL GREEN	89618-3743
M	PASTEL ORANGE	89618-3742
L	CARMINE RED	89618-3741
Z	WATER BLUE	89618-3740
K	CURRY YELLOW	89618-3739
I	BEIGE	89618-3738
H	VIOLET	89618-3737
G	GRAY	89618-3736
F	BROWN	89618-3735
E	GREEN	89618-3734
D	BORDEAUXVIOLET	89618-3733
C	BLUE	89618-3732
B	CREAM WHITE	89618-3731
A	BLACK	89618-3730
KEYING CODE	COLOR	PART NO.

SEE SHEET 1
 EC NO: URF2015-0316
 DRWNLIN 2015/01/26
 CHKD:
 APPR: YCHENG 2015/02/03

REV	DESCRIPTION
A1	

QUALITY SYMBOLS	
	=0
	=0
	=0
	=0
	=0

GENERAL TOLERANCES (UNLESS SPECIFIED)	
	mm
4 PLACES	± ---
3 PLACES	± ---
2 PLACES	± ---
1 PLACE	± ---
0 PLACE	± ---
DIMENSION STYLE	
MM/IN	
DRAWN BY	DATE
EL IN	2013/11/07
CHECKED BY	DATE
JUDY	2013/11/07
APPROVED BY	DATE
MHUANG	2014/04/16

SCALE	DESIGN UNITS	THIRD ANGLE PROJECTION
5:1	METRIC	
TITLE		
SUB ASSY SHROUD WITH SECONDARY LOCKING		
MATERIAL NO.	DOCUMENT NO.	SHEET NO.
SEE TABLE	SD-89618-373	2 OF 2
DRAFT WHERE APPLICABLE MUST REMAIN WITHIN DIMENSIONS		
THIS DRAWING CONTAINS INFORMATION THAT IS PROPRIETARY TO MOLEX INCORPORATED AND SHOULD NOT BE USED WITHOUT WRITTEN PERMISSION		