

PART NUMBER	REV	TERMINATOR	FEED TYPE	DESCRIPTION
1528603-1	A	LEADMAKER	MECH POST FEED	CUTS CARRIER
1528603-2	A	BENCH	MECH PRE FEED	CUTS CARRIER
1528603-6	A	LEADMAKER	MECH POST FEED	CONTINUOUS CARRIER
7-1528603-1	A	LEADMAKER	MECH POST FEED	-1 AND SPARE PARTS
7-1528603-2	A	BENCH	MECH PRE FEED	-2 AND SPARE PARTS
7-1528603-6	A	LEADMAKER	MECH POST FEED	-6 AND SPARE PARTS
7-1528603-7	A	-	-	SPARE PARTS KIT

CRIMP DATA	GHW TERMINAL	GHW CRIMP SPEC
TERMINAL NAME: DFK 4 RECEPTACLE (TIMER TYPE)		
CRIMP	SIZE	TYPE
WIRE	3.56 [1.140 IN]	F
INSUL	4.57 [1.180 IN]	F
RANGE 4.00mm ²		
WIRE STRIP LENGTH 4.70-5.50 [1.185-.217]		
APPL INSTRUCTIONS 408-8322 & 408-8490		
TERMINAL APPL SPEC	GHW DATA SHT 26527	FEED 16.00 [1.630 IN]
TERMINALS APPLIED		
TYCO TERM PN	MANUF TERM PN	
1572916-1	26527.330.186	
WIRE SIZE	CRIMP HEIGHT	REF SETTING
4.00 mm ²	2.10 $\begin{matrix} +0.10 \\ -0.05 \end{matrix}$ [1.083 $\begin{matrix} +.004 \\ -.002 \end{matrix}$ IN]	D3

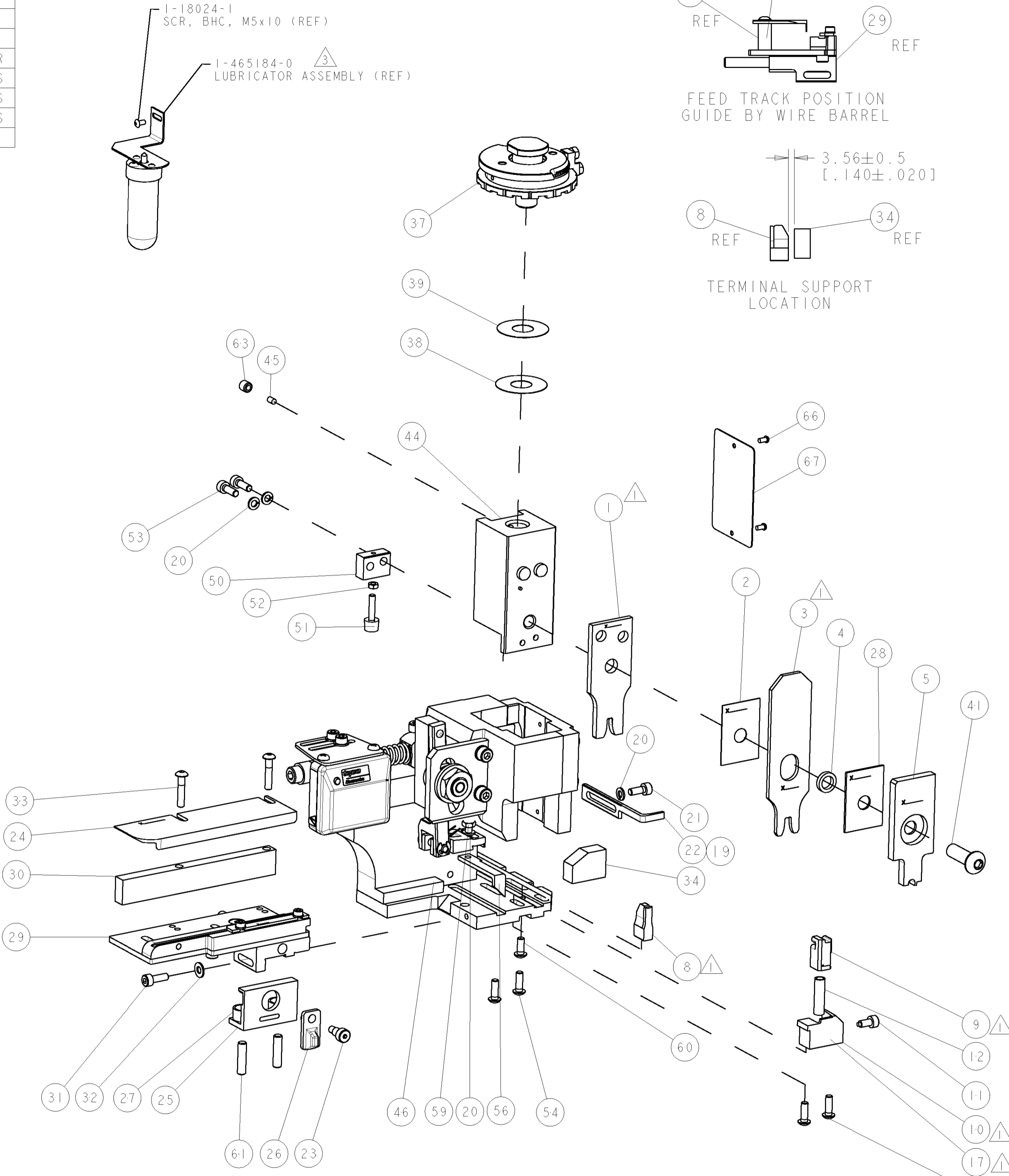

* WARNING
ON INSTALLATION, SET WIRE DISC TO LARGEST WIRE SIZE SETTING. USE OF SETTINGS BELOW MIN. REQUIRED CRIMP HEIGHT SETTING WILL CAUSE DAMAGE TO CRIMP TOOLING.

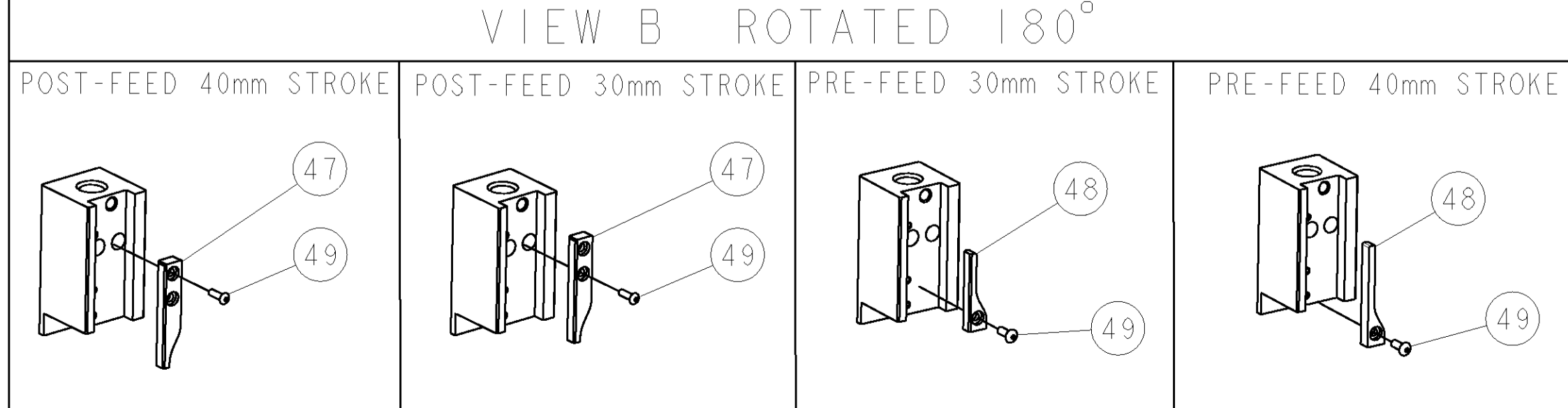

-77	-76	-72	-71	-6	-2	-1	PART NO	DESCRIPTION	ITEM NO
-	-	-	-	-	-	-			84
-	-	-	-	-	-	-			83
-	-	-	-	-	-	-			82
-	-	-	-	-	-	-			81
-	-	-	-	-	-	-			80
-	-	-	-	-	-	-			79
-	-	-	-	-	-	-			78
-	-	-	-	-	-	-			77
-	-	-	-	-	-	-			76
-	-	-	-	-	-	-			75
-	-	-	-	-	-	-			74

SET UP GAGE
458637-3

LOC	DIST	REV	DESCRIPTION	DATE	BY	APPV
A	66		SEE ECO-06-005213	02MAR2006	DP	MC

-	-	-	-	-	-	-	-	-	73
-	-	-	-	-	-	-	-	-	72
-	-	-	-	-	-	-	-	-	71
-	-	-	-	-	-	-	-	-	70
-	-	-	-	-	-	-	-	-	69
-	-	-	-	-	-	-	-	-	68
-	-	-	-	-	-	-	-	-	67
-	-	-	-	-	-	-	-	-	66
-	-	-	-	-	-	-	-	-	65
-	-	-	-	-	-	-	-	-	64
-	-	-	-	-	-	-	-	-	63
-	-	-	-	-	-	-	-	-	62
-	-	-	-	-	-	-	-	-	61
-	-	-	-	-	-	-	-	-	60
-	-	-	-	-	-	-	-	-	59
-	-	-	-	-	-	-	-	-	58
-	-	-	-	-	-	-	-	-	57
-	-	-	-	-	-	-	-	-	56
-	-	-	-	-	-	-	-	-	55
-	-	-	-	-	-	-	-	-	54
-	-	-	-	-	-	-	-	-	53
-	-	-	-	-	-	-	-	-	52
-	-	-	-	-	-	-	-	-	51
-	-	-	-	-	-	-	-	-	50
-	-	-	-	-	-	-	-	-	49
-	-	-	-	-	-	-	-	-	48
-	-	-	-	-	-	-	-	-	47
-	-	-	-	-	-	-	-	-	46
-	-	-	-	-	-	-	-	-	45
-	-	-	-	-	-	-	-	-	44
-	-	-	-	-	-	-	-	-	43
-	-	-	-	-	-	-	-	-	42
-	-	-	-	-	-	-	-	-	41
-	-	-	-	-	-	-	-	-	40
-	-	-	-	-	-	-	-	-	39
-	-	-	-	-	-	-	-	-	38
-	-	-	-	-	-	-	-	-	37
-	-	-	-	-	-	-	-	-	36
-	-	-	-	-	-	-	-	-	35
-	-	-	-	-	-	-	-	-	34
-	-	-	-	-	-	-	-	-	33
-	-	-	-	-	-	-	-	-	32
-	-	-	-	-	-	-	-	-	31
-	-	-	-	-	-	-	-	-	30
-	-	-	-	-	-	-	-	-	29
-	-	-	-	-	-	-	-	-	28
-	-	-	-	-	-	-	-	-	27
-	-	-	-	-	-	-	-	-	26
-	-	-	-	-	-	-	-	-	25
-	-	-	-	-	-	-	-	-	24
-	-	-	-	-	-	-	-	-	23
-	-	-	-	-	-	-	-	-	22
-	-	-	-	-	-	-	-	-	21
-	-	-	-	-	-	-	-	-	20
-	-	-	-	-	-	-	-	-	19
-	-	-	-	-	-	-	-	-	18
-	-	-	-	-	-	-	-	-	17
-	-	-	-	-	-	-	-	-	16
-	-	-	-	-	-	-	-	-	15
-	-	-	-	-	-	-	-	-	14
-	-	-	-	-	-	-	-	-	13
-	-	-	-	-	-	-	-	-	12
-	-	-	-	-	-	-	-	-	11
-	-	-	-	-	-	-	-	-	10
-	-	-	-	-	-	-	-	-	9
-	-	-	-	-	-	-	-	-	8
-	-	-	-	-	-	-	-	-	7
-	-	-	-	-	-	-	-	-	6
-	-	-	-	-	-	-	-	-	5
-	-	-	-	-	-	-	-	-	4
-	-	-	-	-	-	-	-	-	3
-	-	-	-	-	-	-	-	-	2
-	-	-	-	-	-	-	-	-	1
-77	-76	-72	-71	-6	-2	-1	PART NO	DESCRIPTION	ITEM NO

TYCO ELECTRONICS CORPORATION

LOC: A DIST: 66

DATE: 08-Mar-06

BY: M. CLIFFORD

APPV: M. CLIFFORD

PRODUCT SPEC: FINE ADJUST SIDE FEED HDI APPLICATOR

SIZE: A1

CAGE CODE: 00779

DRAWING NO: 1528603

SCALE: 3:5

SHEET: 1 OF 1

REV: A