

REV.	DATE	ECR NO.	DESCRIPTION
A	01/03/04	XXXXXX	UPDATE DRAWING FORMAT
B	10/20/11	2244	CHANGE THE TOTAL LENGTH TO 22.13MM FROM 21.13MM

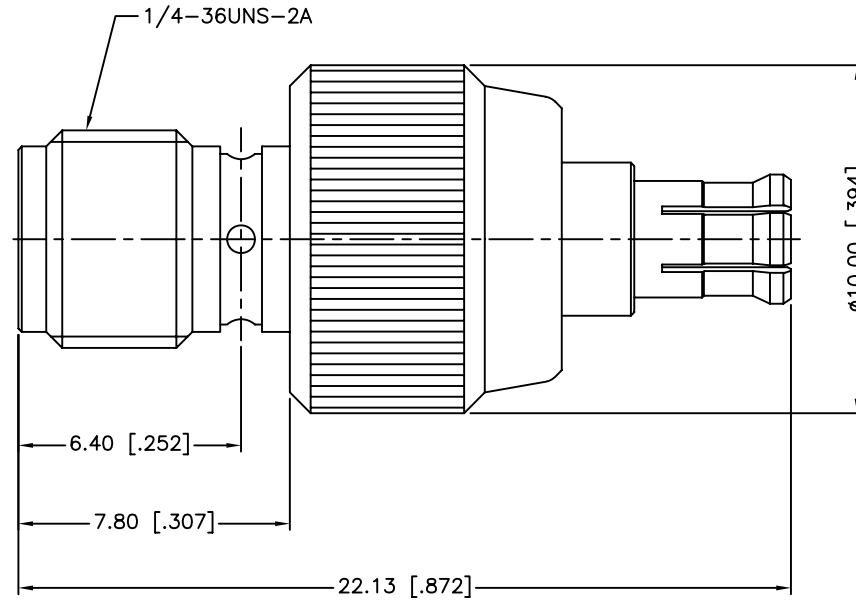

1. SEALING REQUIREMENT: IP-68 MUST WITHSTAND 3' DEPTH OF WATER FOR ONE HOUR WITHOUT ANY SIGNS OF LEAKAGE
2. MAX. PANEL THICKNESS= 6.8mm

QTY	DESCRIPTION	MATERIAL	FINISH
1	CONTACT PIN	BER. COPPER	GOLD
1	INSULATOR	PTFE	NATURAL
1	BODY	BER. COPPER	GOLD
1	HOUSING	BRASS	GOLD

UNLESS OTHERWISE SPECIFIED DIMENSIONS ARE IN MILLIMETERS. DIMENSIONS IN [] ARE IN INCHES AND FOR CUSTOMER REFERENCE ONLY.		APPROVALS	DATE
UNLESS OTHERWISE SPECIFIED TOLERANCES FOR MILLIMETERS ARE: 0.5 - 8mm ± 0.20mm 8 - 30mm ± 0.40mm 30 - 120mm ± 0.50mm		DRAWN M.ZHANG	10/20/11
UNLESS OTHERWISE SPECIFIED TOLERANCES FOR INCHES ARE: .020 - .315 = ± 0.007" .315 - 1.180 = ± 0.015" 1.180 - 4.724 = ± 0.020"		CHECKED	
DO NOT SCALE DRAWING		ISSUED	
		SHEET 1 OF 1	
		CAD FILE C:/CONNEX/242127.DWG	

Amphenol Connex

PART DESCRIPTION			
SMA FEMALE TO MCX MALE ADAPTER BULKHEAD ADAPTOR (IP 68)			
PART NO.			
242127			
DWG. NO.	REV.	SIZE	SCALE
242127.DWG	B	A	NA