

- 1
- 2
- 3
- 4
- 5
- 6
- 7
- 8
- 9
- 10
- 11
- 12
- 13
- 14
- 15
- 16
- 17
- 18

MATERIAL

Glass-fibre reinforced polyamide based (PA) technopolymer, RAL 5005 blue colour, matte finish.

Produced from FDA compliant raw material (FDA CFR.21 and EU 10/2011).

ROTATING PIN

AISI 303 stainless steel.

STANDARD EXECUTION

Pass-through holes for countersunk head screws.

FEATURES AND APPLICATIONS

The RAL 5005 blue colour is easily visible in case of accidental food contamination.

Particularly suitable for applications in the food and pharmaceutical industries.

ROTATION ANGLE (APPROXIMATE VALUE)

Max 270° (-90° and +180° being 0° the condition where the two interconnected surfaces are on the same plane).

Do not exceed the rotation angle limit so as not to prejudice the hinge mechanical performance.

To choose the convenient type and the right number of hinges for your application, see the Guidelines (see page 1448).

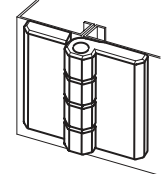
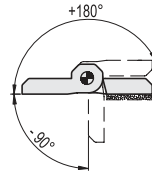

Resistance tests	Axial Stress		Radial Stress		90° Angled Stress	
	Maximum working load Ea [N]	Load at breakage Ra [N]	Maximum working load Er [N]	Load at breakage Rr [N]	Maximum working load E90 [N]	Load at breakage R90 [N]
CFM.40 SH-5-VD	100	1600	200	1900	200	1200
CFM.50 SH-6-VD	100	2100	200	3100	200	2000

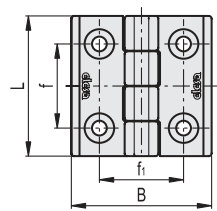
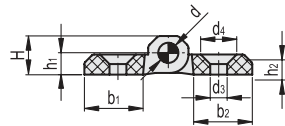

Conversion Table
1 mm = 0.039 inch

mm	inch
40	1.57
50	1.97

INOX STAINLESS STEEL METRIC

Code	Description	L	B	f±0.25	f1 ±0.25	H	h1	h2	b1	b2	d	d3	d4	C# [Nm]	⚖
199511	CFM.40-SH-5-VD	40	40	25	25	9	5.5	5	14	14	4	5.5	10.5	3	14
199611	CFM.50-SH-6-VD	50	50	30	30	11.5	6.5	6	18	18	6	6.5	12.5	5	30