



ANATECH ELECTRONICS INC
RF & Microwave Filters & Products

1802 MHz Ceramic Bandpass Filter

Part Number: AM1802B1175



Electrical specifications

Center Frequency: 1802.5 MHz

Bandwidth: 95 MHz min

VSWR: 1.7 : 1

Input / Output Impedance: 50 Ohms

Passband: 1755-1850 MHz

Passband Insertion Loss: 1.5 dB max

Passband Ripple: 0.5 dB max

Rejection: 45 dB min at 1450 MHz

Rejection 2: 40 dB min at 2150 MHz

Power Handling: 3 watt

Mechanical

Mounting Method: SMT

Dimensions: 13 x 12 x 3.8 mm

Environmental

Operating Temperature: -40°C to +85°C

Storage Temperature: -50°C to +90°C

This product is RoHs compliant.

Outline Drawing:

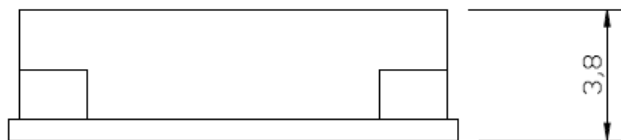
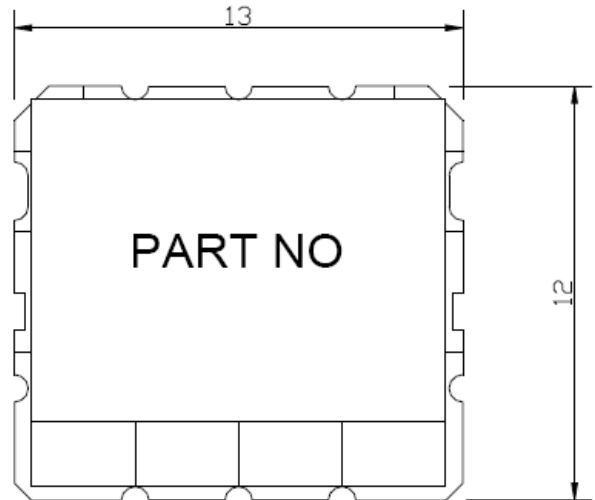
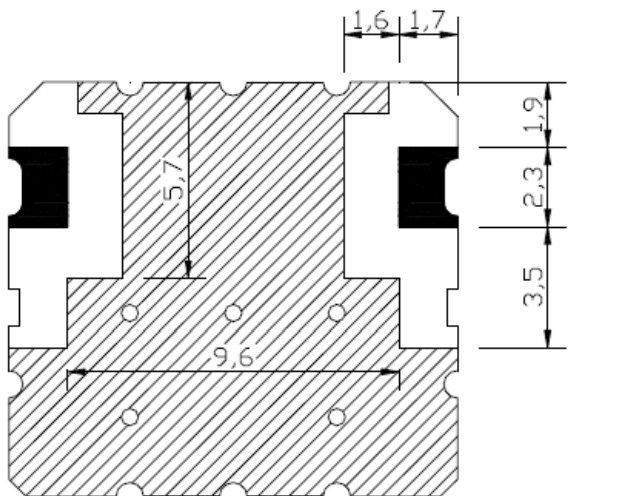

 IN/OTU PORT

 GROUND

tolerance : +/- 0.3

unit : mm



ANATECH ELECTRONICS INC
RF & Microwave Filters & Products

1802 MHz Ceramic Bandpass Filter

Part Number: AM1802B1175



Response Plot:

