

This document is the property of Amphenol Corporation and is delivered on the express condition that it is not to be disclosed, reproduced or used, in whole or in part, for manufacture or sale by anyone other than Amphenol Corporation without its prior consent, & that no right is granted to disclose or to use any information in this document.

# Customer drawing

REVISIONS				
SYM	ECN	DESCRIPTION	DATE	APPROVED
1	HK--	First Release Drawing	08/27/13	IP

## D-SUB TECHNICAL DATA

SHELL : SPCC, 100u" Tin Over 50u" min nickel over 50u" min Copper  
 BODY : PBT, UL 94V-0, Color:Black.  
 CONTACTS : Copper Alloy.  
 Gold flash over 50u" min nickel on mating area.  
 100u" min tin over 50u" min nickel on solder area  
 BOARDLOCK : Copper Alloy, Tin Plated.  
 RIVET : Copper Alloy. Nickel Plated.  
 ELECTRICAL : Voltage rating :250 VAC(RMS) Max  
 Current rating :3A  
 Withstanding Voltage >1000 VAC(RMS)  
 Insulation resistance >1000 M Ohms  
 Contact resistance 25 mOhms max.  
 MARKING : Amphenol...(Series No.)  
 Commercial reference  
 Manufacturing date

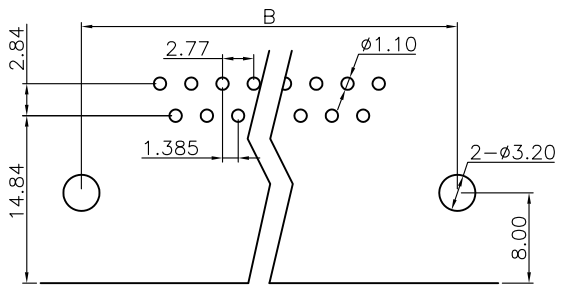
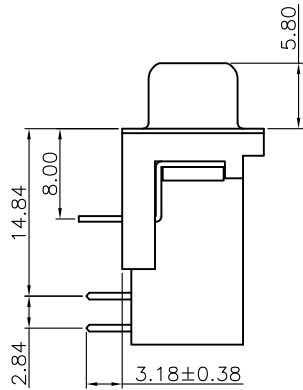
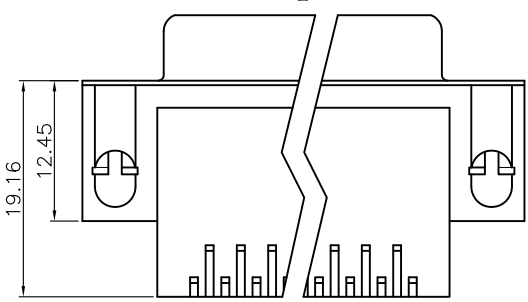
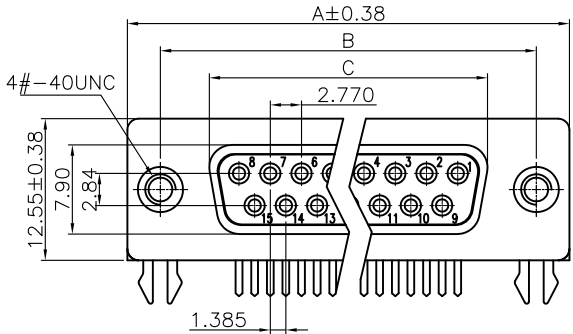

### PRODUCT CODE

L 77 SD X XX S AB CH 4R

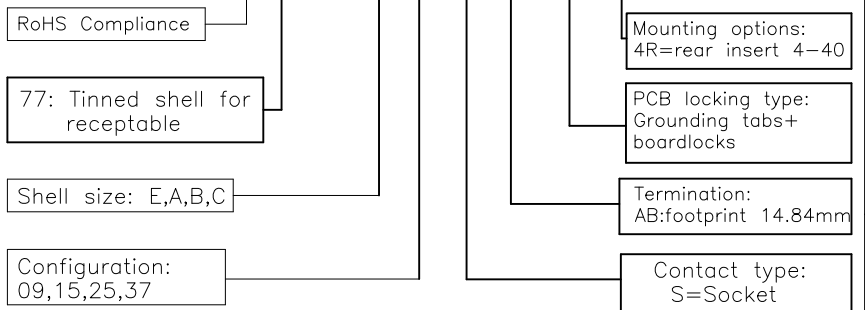

RECOMMENDED P.C.B LAYOUT  
(TOLERANCE +/-0.05)

### Dimensions

Positions	A	B	C
9	30.81	24.99	16.33
15	39.19	33.32	24.66
25	53.04	47.04	38.38
37	69.32	63.50	54.84

UNLESS OTHERWISE SPECIFIED TOLERANCES		APPROVAL		DATE
U.S.	METRIC	DRAWN	FILED	8/27/13
.X +/-	0.50			
.XX +/-	0.30			
.XXX +/-	0.20			
FRACTIONS +/-	5'			
ANGLES +/-				
FOR MATERIALS AND FINISHES SEE NOTES		DRAWING FILE :		
REMOVE SHARP EDGES		ANGLE OF PROJECTION		
DIMENSIONS				
U.S.	INCHES			
METRIC	MM			

Amphenol		TITLE
Amphenol East Asia Limited		
DIP,R/A		SIZE DRAWING NO.
SCALE NONE		
SHEET 1 OF 1		REV. 1