

LOC		DIST		P		ZONE		LTR		REVISIONS			
BD	77									DESCRIPTION	DATE	APPD	
										D	REDRAWN/REV PER EC 0020-1353-93	01/31/94	MP

- 1 RECOMMENDATIONS FOR 2.36 [.093] MIN THICK PC BOARD:
 A. HOLE DIAMETER AFTER DRILLING = 1.15±0.03 [.045±.001].
 B. HOLE DIAMETER AFTER TIN-LEAD PLATING = 0.94[.037]-1.09[.043].
 C. HOLE DIAMETER AFTER REFLOW = 0.91[.036]-1.09[.043].
 D. PC BOARD PLATING TO BE 0.76µm [.000300] MIN TIN-LEAD OVER 0.05±0.03[.002±.001] COPPER.
- 2 NYLON OR POLYESTER, UL 94V-0 RATED, BLACK.
- 3 COPPER ALLOY PER ASTM B 122.
- 4 CARBON STEEL PER ASTM A 109.
- 5 ZINC.
- 6. GOLD PLATING PER MIL-G-45204, NICKEL PLATING PER QQ-N-290, TIN PLATING PER MIL-T-10727, COPPER PLATING PER MIL-C-14550.
- 7 1.27µm [.000050] MIN TIN OVER 0.13µm [.000005] MIN NICKEL STRIKE.
- 8 .508µm [.000200] MIN TIN-LEAD OVER 0.13µm [.000005] MIN NICKEL STRIKE.
- 9 0.76µm [.000030] MIN GOLD FOR A LENGTH OF 1.02[.040] MIN FROM MATING END 2.54µm [.000100] MIN TIN OR TIN-LEAD FOR A LENGTH OF 5.61[.221] MIN FROM OPPOSITE END, BOTH OVER 1.27µm [.000050] MIN NICKEL.
- 10 STAINLESS STEEL PER QQ-S-766.
- 11 DATUMS AND BASIC DIMENSIONS ESTABLISHED BY CUSTOMERS.

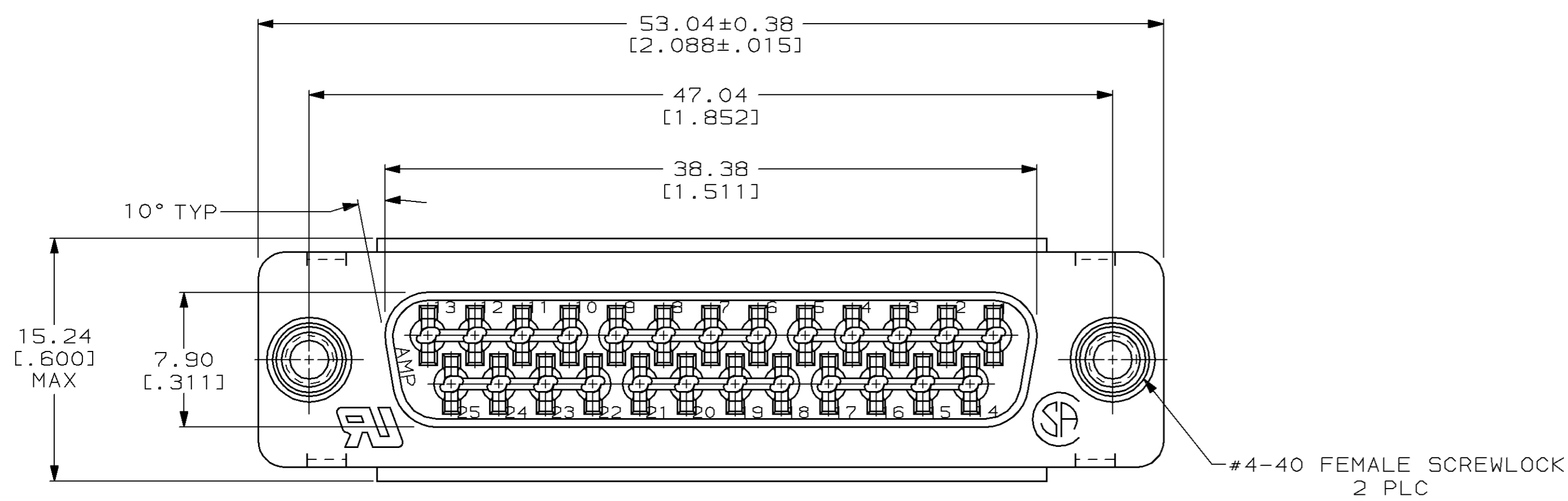

RECOMMENDED PC BOARD MOUNTING DIMENSIONS 1
 CONNECTOR SIDE OF BOARD

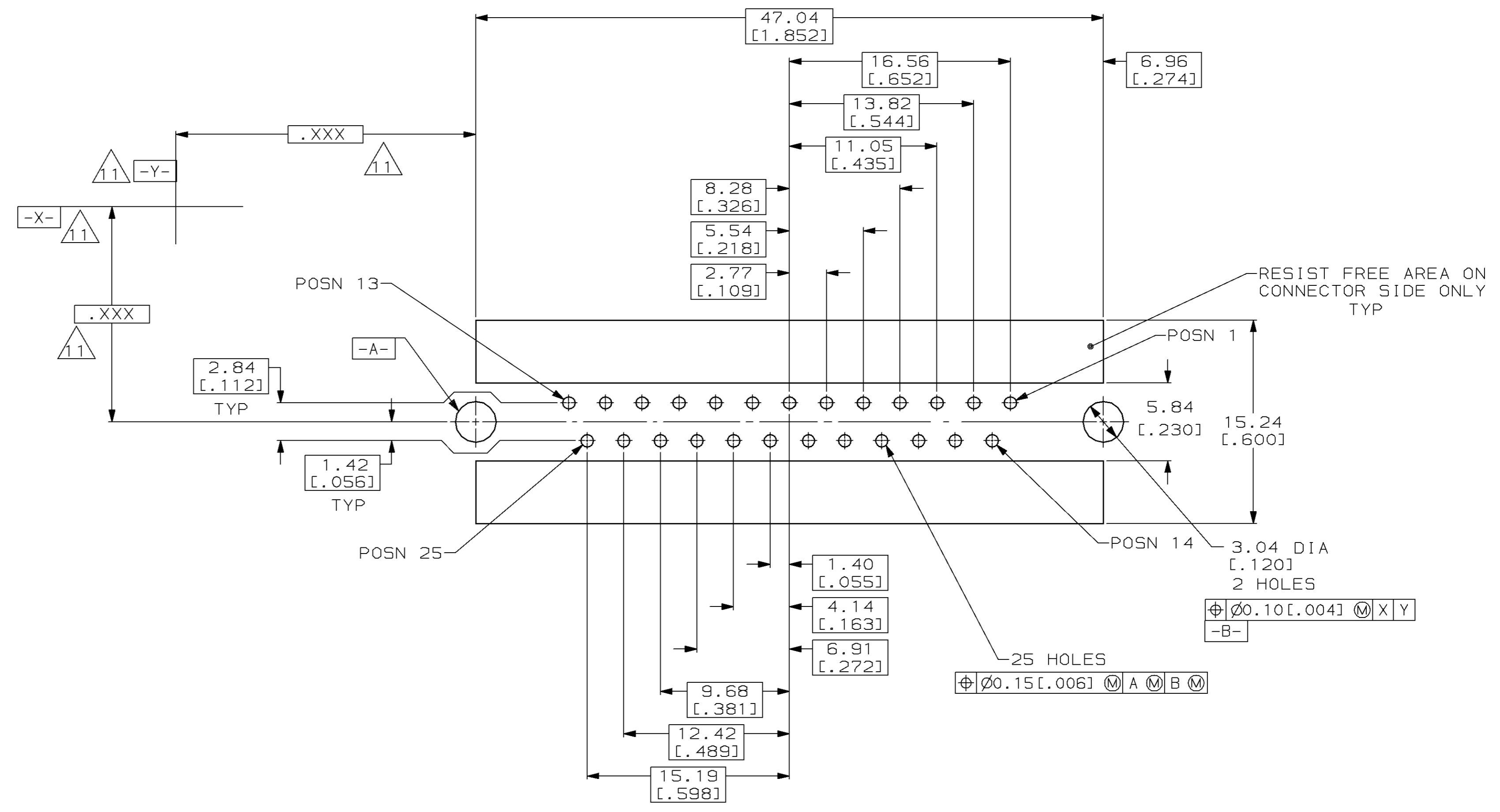
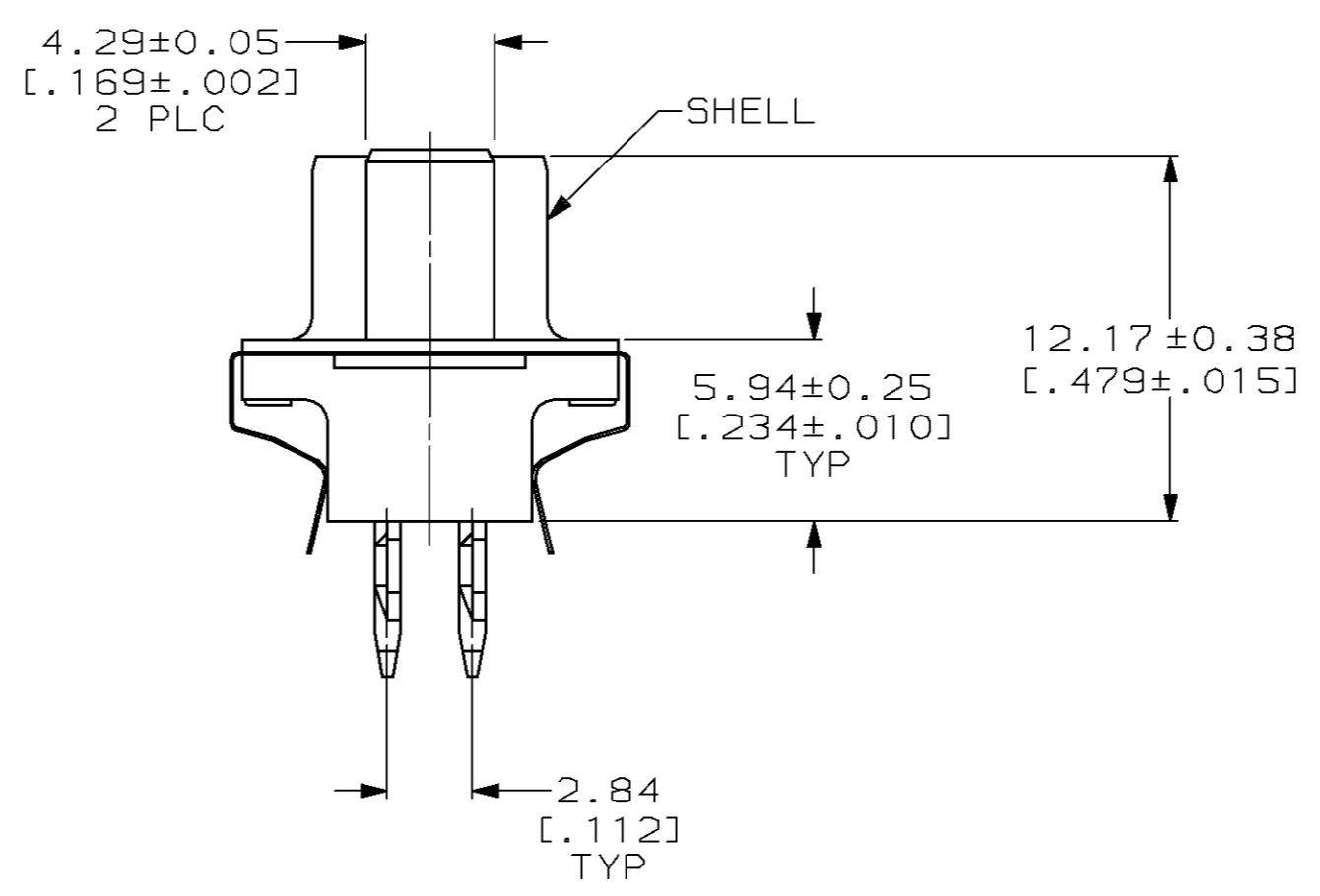
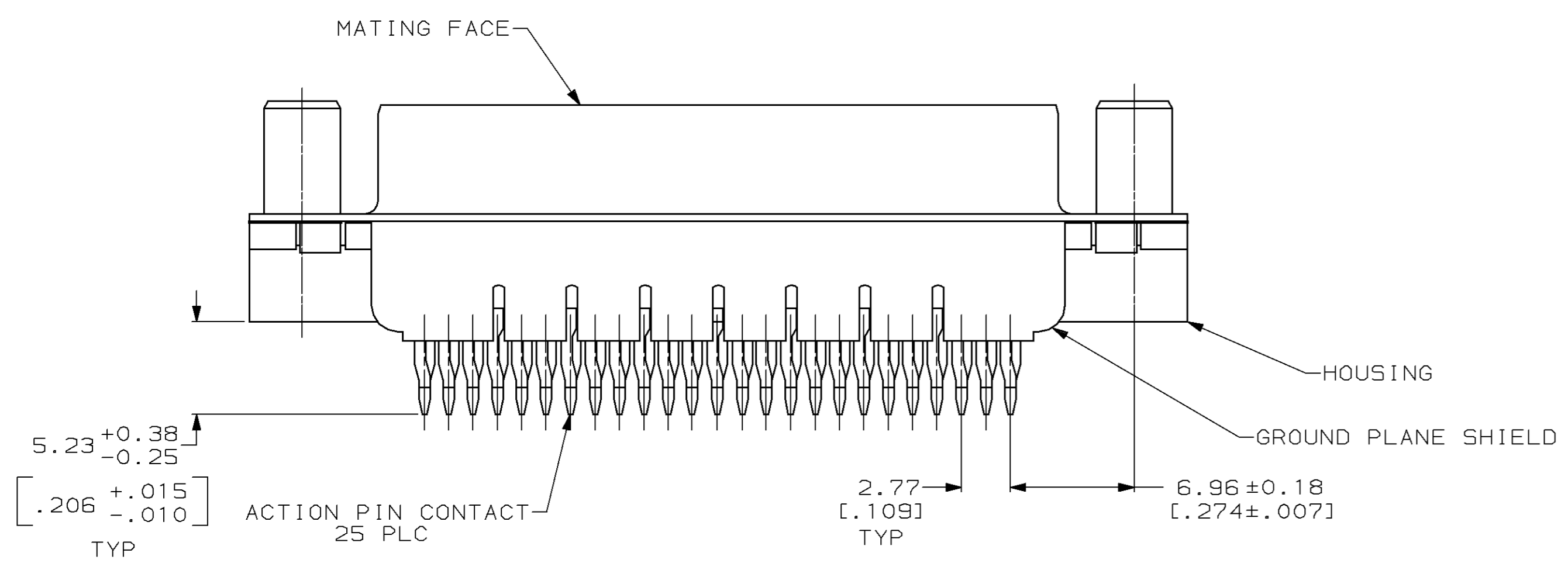

DO NOT SCALE PRINT. UNLESS SPECIFIED DIMENSIONS IN mm [INCHES]		DR 01/31/94 K.FOLTZ	748441-2 PART NO	
TOLERANCES ON: 2 PLC DEC ±0.13 [.005] 3 PLC DEC ± - ANGLES ± 2°		CHK 2/3/94 R.STONE	AMP AMP Incorporated Harrisburg, PA 17105-3608	
MATERIAL		APPD 2/4/94 M.PERCHERKE	NAME RECEPTACLE ASSEMBLY, SIZE 3, 25 POSITION, ACTION PIN™, FRONT METAL SHELL AMPLIMITE™ HDP	
HOUSING: 1 SCREWLOCKS: 1		APPD 2/4/94 M.PERCHERKE	PRODUCT SPEC 108-40014	
CONTACTS: 1 SHIELD: 1		FINISH	APPLICATION SPEC 114-40026	
CONTACTS: 1 SHIELD: 1		SCALE	SIZE CAGE CODE DRAWING NO D 00779 C-748441	
SHELL: 1		WEIGHT	SCALE 4:1 SHEET 1 OF 1	

THIS DRAWING IS A CONTROLLED DOCUMENT FOR AMP INCORPORATED. IT IS SUBJECT TO CHANGE AND THE CONTROLLING ENGINEERING ORGANIZATION SHOULD BE CONTACTED FOR THE LATEST REVISION.