

| PART NUMBER | REV | FIRST USED | POWER UNIT | FEED TYPE | DESCRIPTION |
|-------------|-----|------------|---------------|-----------|--------------------|
| 1852566-1 | B | 122500-1 | LEADMAKER | POST FEED | CUTS CARRIER |
| 1852566-2 | B | 565435-5 | BENCH MODEL K | PRE FEED | CUTS CARRIER |
| 1852566-3 | B | 354500-1 | BENCH MODEL G | PRE FEED | CUTS CARRIER |
| 1852566-6 | B | 122500-1 | LEADMAKER | POST FEED | CONTINUOUS CARRIER |
| 7-1852566-7 | A | - | - | - | SPARE PARTS |

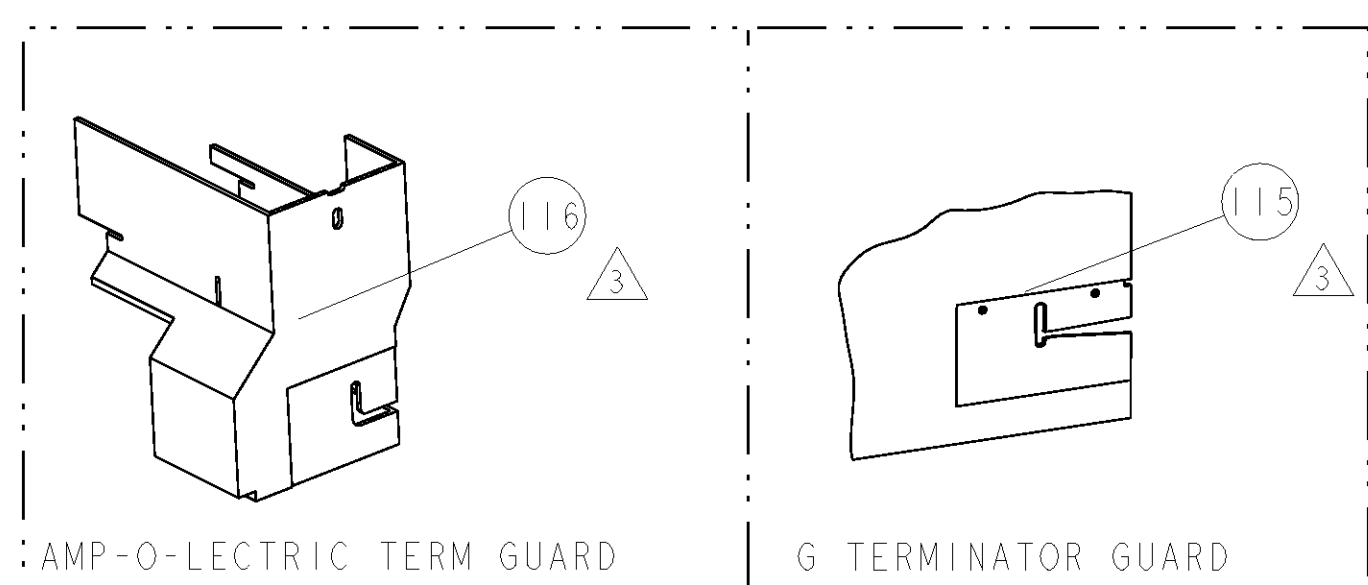

| TE PN | | MANF PN | | HARTING TERMINAL - TE CRIMP SPECS | |
|-------------------|----------------|---------|-------------------------|-----------------------------------|-------------|
| 1949517 | 0906000-6422 | | | | |
| 1949555 | 0906000-6472 | PAD LTR | | CRIMP HEIGHT | WIRE SIZE |
| - | - | A | | 1.435±0.065mm (.0565±.002) | 16AWG |
| - | - | B | | 1.425±0.075mm (.0561±.003) | 18AWG |
| - | - | C | | 1.275±0.075mm (.0502±.003) | 20AWG |
| - | - | D | | - | - |
| - | - | CRIMP | SIZE | TYPE | RANGE |
| - | - | WIRE | 2.29mm [.090] | F | 16-20 AWG |
| - | - | INSUL | 3.18mm [.125] | O | 1.6-2.8mm |
| WIRE STRIP LENGTH | TERM APPL SPEC | FEED | APPLICATOR INSTRUCTIONS | | SET UP GAGE |
| 3.55-3.94mm | NONE | 12.45mm | 408-8040 | | 458637-1 |

- ▲ RECOMMENDED SPARE PARTS
- ▲ GREASE LIGHTLY
- ▲ GUARD MUST BE IN PLACE WHEN OPERATING APPLICATOR IN A BENCH MACHINE

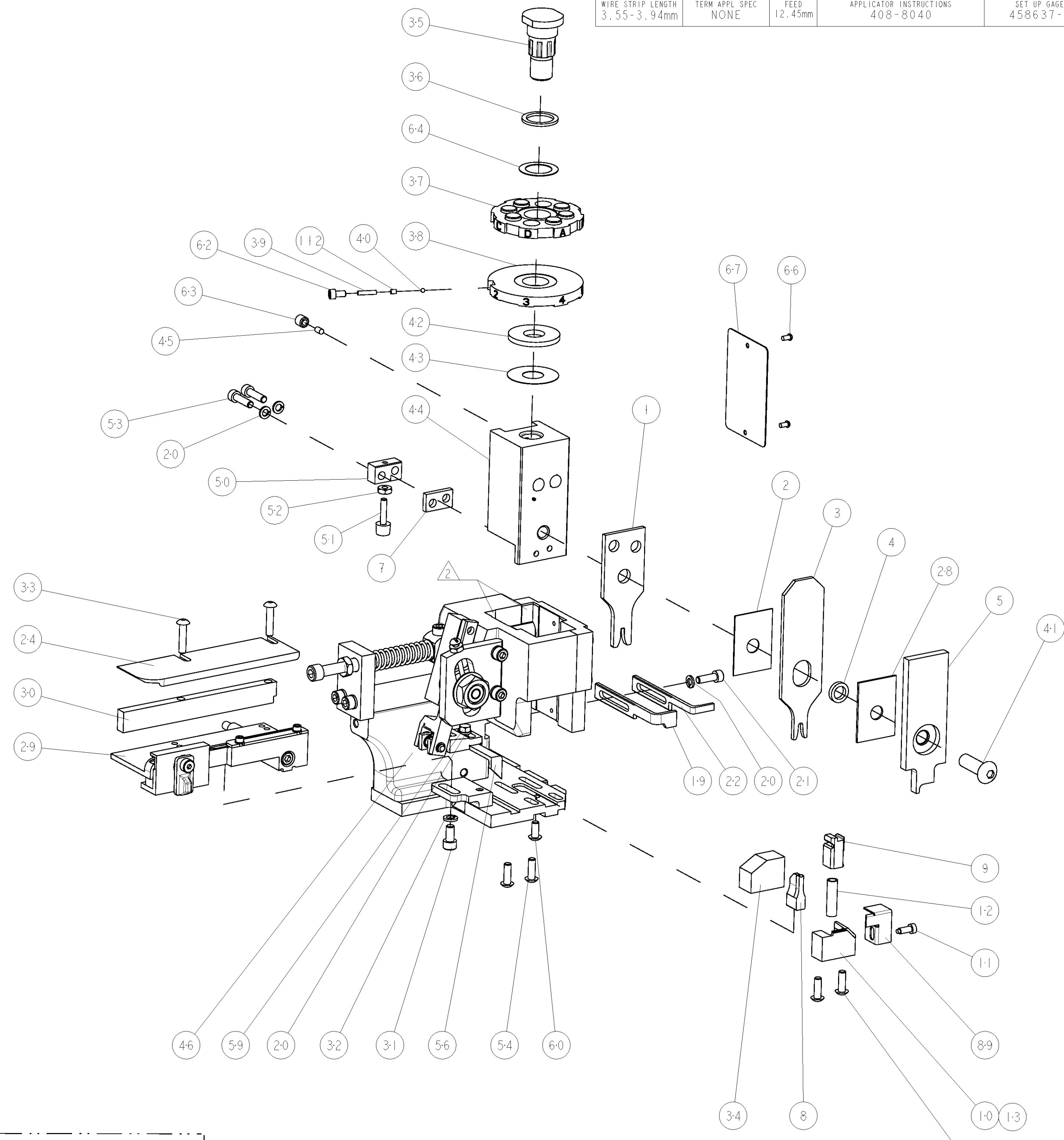
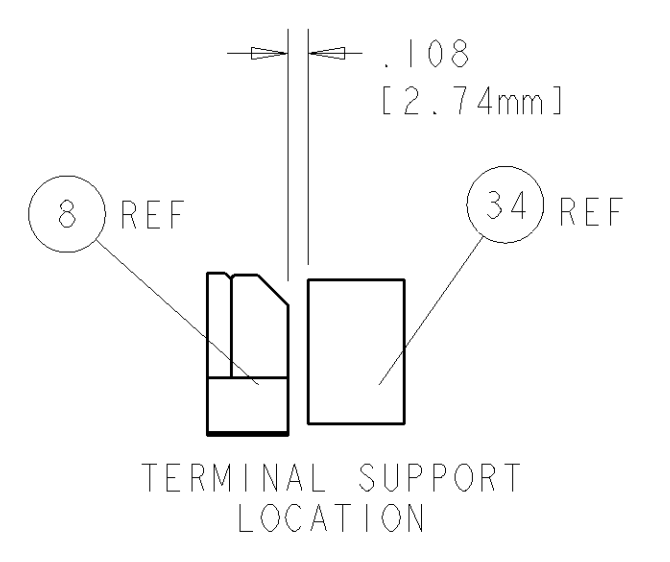
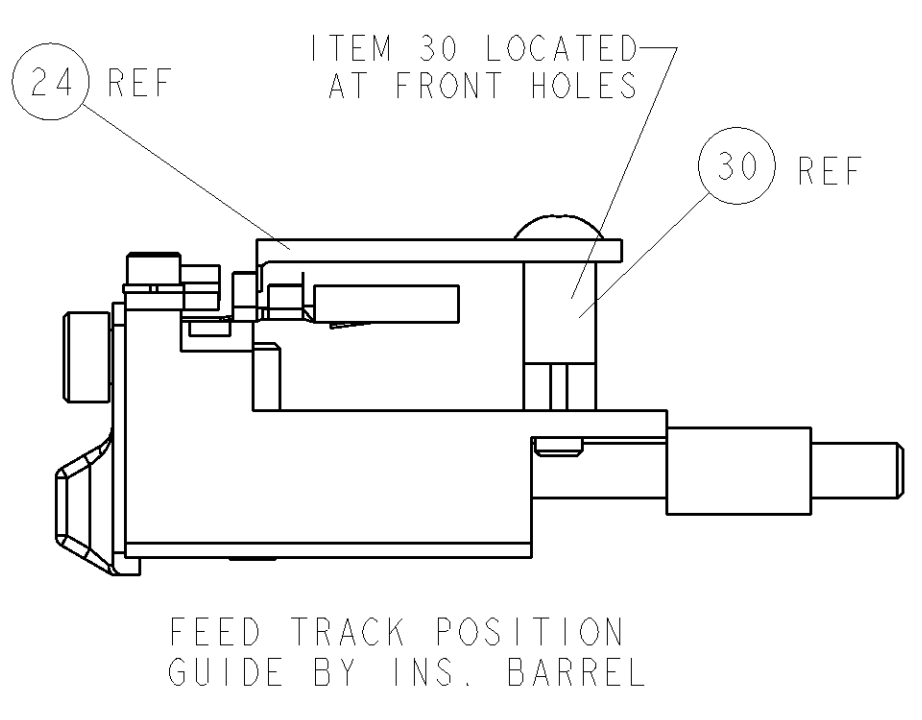
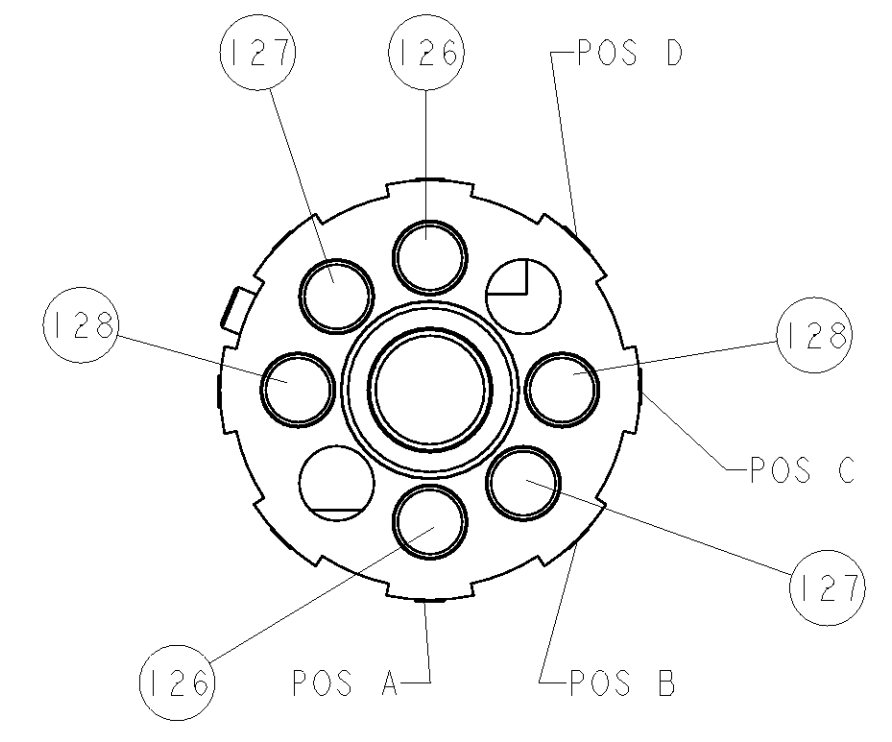

| QTY | LOC | DIST | REV | DESCRIPTION | DATE | DWN | APVD | ITEM NO |
|-----|-----|------|-----|-------------|------|-------------|---------------------------------------|---------|
| - | 2 | 2 | 2 | 2 | - | 3-354779-0 | PIN, WIRE DISC, .3140 | 128 |
| - | 2 | 2 | 2 | 2 | - | 1-354779-6 | PIN, WIRE DISC, .3070 | 127 |
| - | 2 | 2 | 2 | 2 | - | 2-354779-1 | PIN, WIRE DISC, .3095 | 126 |
| - | - | - | REF | - | .. | 455749-1 | GUARD WINDOW | 116 |
| - | - | - | REF | - | .. | 679532-1 | INSERT, GUARD | 115 |
| - | 1 | 1 | 1 | 1 | - | 690603-1 | SPRING ASSIST AMP-O-MATOR APPLICATOR | 112 |
| - | 1 | 1 | 1 | 1 | - | 1-21002-7 | SCR, BTN SKT HD CAP 6-32 X .375 | 91 |
| - | 1 | 1 | 1 | 1 | - | 318563-1 | GUARD, FRONT CHIP | 89 |
| - | 1 | 1 | 1 | 1 | - | 4088040 | SF APPL INST 408-8040 | 72 |
| - | 1 | 1 | 1 | 1 | - | 217238-1 | GENERAL INSTRUCTION PKG | 71 |
| - | 1 | 1 | 1 | 1 | - | 461264-1 | PLATE, IDENTIFICATION | 67 |
| - | 2 | 2 | 2 | 2 | - | 21017-2 | SCREW, DRIVE | 66 |
| - | 1 | 1 | 1 | 1 | - | 986950-1 | WASHER, FLAT PRECISION | 64 |
| - | 1 | 1 | 1 | 1 | - | 21009-2 | SCR, SET, SELF LOCKING 1/4-20 X .250 | 63 |
| - | 1 | 1 | 1 | 1 | - | 23030-1 | SCR, SKT HD CAP 6-32 X .25 | 62 |
| - | 1 | 1 | 1 | 1 | - | 22733-8 | SCR, BHSC, SELF-LOCKING, 8-32 X .375 | 60 |
| - | 1 | 1 | 1 | 1 | - | 2-22603-0 | SCR, HEX HD CAP 8-32 X .312 | 59 |
| - | 1 | 1 | 1 | 1 | - | 458537-2 | PAWL, FEED | 56 |
| - | 4 | 4 | 4 | 4 | - | 2-21002-2 | SCR, BTN SKT HD CAP 8-32 X .500 | 54 |
| - | 2 | 2 | 2 | 2 | - | 2-21000-8 | SCR, SKT HD CAP 8-32 X .625 | 53 |
| - | 1 | 1 | 1 | 1 | - | 21018-5 | NUT, HEX, REG 6-32 | 52 |
| - | 1 | 1 | 1 | 1 | - | 811242-2 | BUMPER, HOLD DOWN | 51 |
| - | 1 | 1 | 1 | 1 | - | 690753-1 | SPACER, TONKER | 50 |
| - | - | - | - | - | .. | 690602-6 | CAM, PRE FEED, 1 5/8 | 49 |
| - | - | - | - | - | .. | 690602-5 | CAM, PRE FEED, 1 1/8 | 48 |
| - | 1 | - | - | - | - | 690501-4 | CAM, POST-FEED 1 5/8 | 47 |
| - | 1 | 1 | 1 | 1 | - | 459456-1 | APPL. BASIC SUB ASSY (SIDE WISE MOCA) | 46 |
| - | 1 | 1 | 1 | 1 | - | 690191-1 | PLUG, NYLON | 45 |
| - | 1 | 1 | 1 | 1 | - | 455673-1 | RAM, SIDE FEED | 44 |
| - | 1 | 1 | 1 | 1 | - | 690125-1 | SHIM SUB-ASSY | 43 |
| - | 1 | 1 | 1 | 1 | - | 690124-1 | WASHER, RAM (.115) | 42 |
| - | 1 | 1 | 1 | 1 | - | 7-21002-9 | SCR, BTN SKT HD CAP 5/16-24 X 1.00 | 41 |
| - | 1 | 1 | 1 | 1 | - | 23241-6 | BALL, STEEL | 40 |
| - | 1 | 1 | 1 | 1 | - | 690170-1 | SPRING, COMPRESSION | 39 |
| - | 1 | 1 | 1 | 1 | - | 690142-1 | DISC, INSULATION | 38 |
| - | 1 | 1 | 1 | 1 | - | 354777-1 | WIRE DISC, ASSEMBLY | 37 |
| - | 1 | 1 | 1 | 1 | - | 22480-5 | SPRING, COMPRESSION | 36 |
| - | 1 | 1 | 1 | 1 | - | 690212-1 | POST, RAM | 35 |
| - | 1 | 1 | 1 | 1 | - | 690786-6 | TERMINAL SUPPORT | 34 |
| - | 2 | 2 | 2 | 2 | - | 2-21002-4 | SCR, BTN SKT HD CAP 8-32 X .750 | 33 |
| - | 1 | 1 | 1 | 1 | - | 21024-5 | WASHER, SPRG LOCK, REG NO 10 | 32 |
| - | 1 | 1 | 1 | 1 | - | 3-21000-4 | SCR, SKT HD CAP 10-32 X .375 | 31 |
| - | 1 | 1 | 1 | 1 | - | 1320908-8 | SPACER, STRIP GUIDE | 30 |
| - | 1 | 1 | 1 | 1 | - | 1633091-1 | ASSEMBLY, STRIP GUIDE | 29 |
| - | 1 | 1 | 1 | 1 | - | 1-455888-0 | SPACER, CRIMPER | 28 |
| - | 1 | 1 | 1 | 1 | - | 1320928-1 | PLATE, STRIP GUIDE | 24 |
| - | 1 | 1 | 1 | 1 | - | 690472-2 | STRIPPER | 22 |
| - | 1 | 1 | 1 | 1 | - | 2-21000-7 | SCR, SKT HD CAP 8-32 X .500 | 21 |
| - | 4 | 4 | 4 | 4 | - | 21024-4 | WASHER, SPRG LOCK, REG NO 8 | 20 |
| - | - | - | - | - | - | 691353-1 | STRIPPER | 19 |
| - | 1 | 1 | 1 | 1 | - | 679625-1 | SHEAR HOLDER, FRONT (NO CUT) | 13 |
| - | 1 | 1 | 1 | 1 | - | 3-22280-3 | SPRING, COMPRESSION | 12 |
| - | 1 | 1 | 1 | 1 | - | 690461-1 | STOP, SHEAR | 11 |
| - | - | - | - | - | - | 690459-1 | SHEAR HOLDER, FRONT | 10 |
| - | 1 | 1 | 1 | 1 | - | 454276-1 | FLOATING SHEAR, FRONT | 9 |
| - | 1 | 1 | 1 | 1 | - | 2-1633110-2 | ANVIL, COMBINATION .090 | 8 |
| - | 1 | 1 | 1 | 1 | - | 240641-5 | SPACER | 7 |
| - | - | - | - | - | .. | - | - | 6 |
| - | 1 | 1 | 1 | 1 | - | 1-455889-4 | DEPRESSOR, SHEAR | 5 |
| - | 1 | 1 | 1 | 1 | - | 238011-4 | BLOCK, CRIMPER SPACER | 4 |
| - | 1 | 1 | 1 | 1 | - | 1583690-5 | CRIMPER, INSUL O | 3 |
| - | 1 | 1 | 1 | 1 | - | 455888-5 | SPACER, CRIMPER | 2 |
| - | 1 | 1 | 1 | 1 | - | 2-456406-3 | CRIMPER, WIRE PREMIUM | 1 |

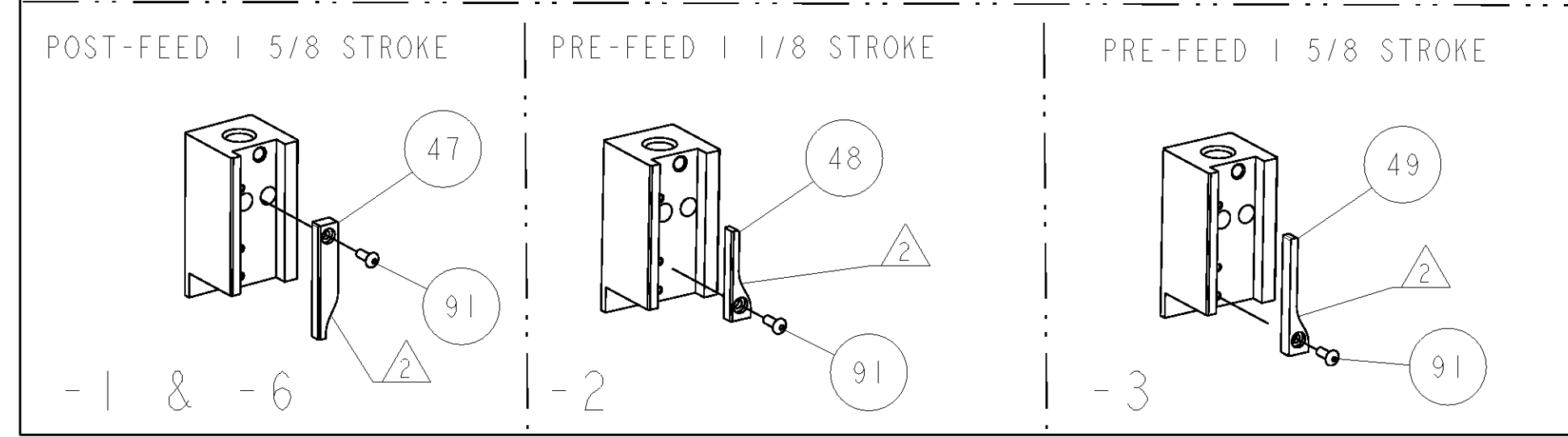

| DIMENSIONS: | | TOLERANCES UNLESS OTHERWISE SPECIFIED: | | MATERIAL: | | FINISH: | | WEIGHT: | | CUSTOMER ACCESSIBLE PRODUCTION DRAWING | |
|-------------|--|--|--------|-----------|--|---------|--|---------|--|--|--|
| INCHES | | 1 PLC | ±.01 | | | | | | | | |
| | | 2 PLC | ±.005 | | | | | | | | |
| | | 3 PLC | ±.001 | | | | | | | | |
| | | 4 PLC | ±.0001 | | | | | | | | |
| | | ANGLES | ±.0001 | | | | | | | | |