

APPROVED: \_\_\_\_\_  
 DATE: \_\_\_\_\_ TITLE: \_\_\_\_\_

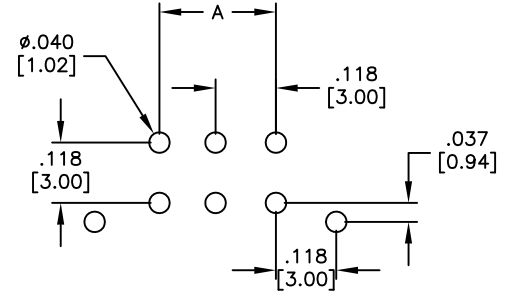
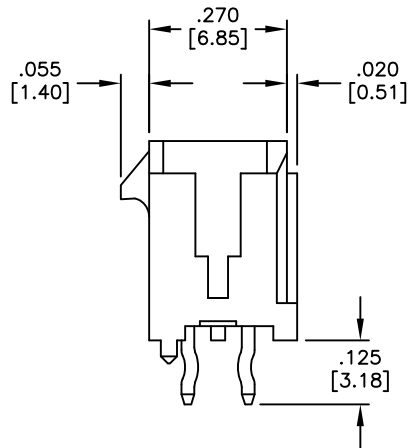
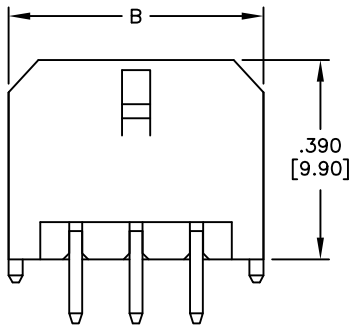
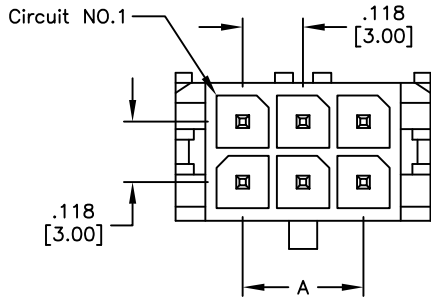

PCB LAYOUT: COMPONENT SIDE  
 RECOMMENDED PCB THICKNESS: .062" [1.57]

POSITIONS	Dimension	
	A	B
2	NA	.262 [6.65]
4	.118 [3.00]	.380 [9.65]
6	.236 [6.00]	.498 [12.65]
8	.354 [9.00]	.616 [15.65]
10	.472 [12.00]	.734 [18.65]
12	.591 [15.00]	.852 [21.65]
14	.709 [18.00]	.970 [24.65]
16	.827 [21.00]	1.088 [27.65]
18	.945 [24.00]	1.206 [30.65]
20	1.063 [27.00]	1.325 [33.65]
22	1.181 [30.00]	1.443 [36.65]
24	1.299 [33.00]	1.561 [39.65]

**SPECIFICATIONS:**  
 Material:  
 Insulator: Hi-Temp Thermoplastic, rated UL 94V-0  
 Insulator color: Black  
 Contacts: Brass  
 Plating:  
 Tin over Nickel underplate overall  
 Electrical:  
 Operating voltage: 250 V  
 Current rating: 20 & 22 Awg: 5 Amps max  
                   24 Awg: 4 Amps max  
                   26 Awg: 3 Amps max  
                   28 Awg: 2 Amps max  
                   30 Awg: 1 Amp max  
 Contact resistance: 10 mohms max  
 Dielectric strength: 1,500 VAC for 1 minute  
 Temperature Rating:  
 -45°C to +125°C  
 Environmental:  
 Lead free, RoHS compliant.



Rev	AWO #	Description	Date	Appr
-	9648	RELEASED	2/15/07	
A		UPDATED	11/23/07	
B		UPDATED	1/07/08	
C		REDRAWN	7/16/09	
D		REVISED SOLDERIND TEMP	2/16/12	
E		REVISED DIMENSION C	3/12/12	
F		REVISED TOP VIEW	10/6/14	
G		UPDATED	5/19/16	AY/LL

UNLESS OTHERWISE SPECIFIED  
 ALL DIMENSIONS ARE INCHES [MM]  
 TOLERANCES: EXCEPT AS NOTED  
 INCHES HOLES  
 .X ± .10 Ø.X ± .10  
 .XX ± .020 Ø.XX ± .015  
 .XXX ± .015 Ø.XXX ± .010

APPROVALS		DATE
DRAWN	BW	2/15/07
CHECKED		
APPROVED		

**ADAM TECH**

909 Rahway Avenue, Union, NJ 07083  
 Phone: 908-687-5000 Fax: 908-687-5710

TITLE: .118 [3.00] DUAL ROW THRU HOLE HEADER  
 VERTICAL TYPE

SIZE	PART NO.	REV.
X	DML-XX-A-V-T-A	G
REF: S00123T	SCALE: NTS	SHEET 1 OF 1