

LOC		DIST		REVISIONS				
AD	00	REV	DATE	BY	CHK	APPV		
B1		REVISED PER ECO-11-002078	11MAR11	DH	MH			

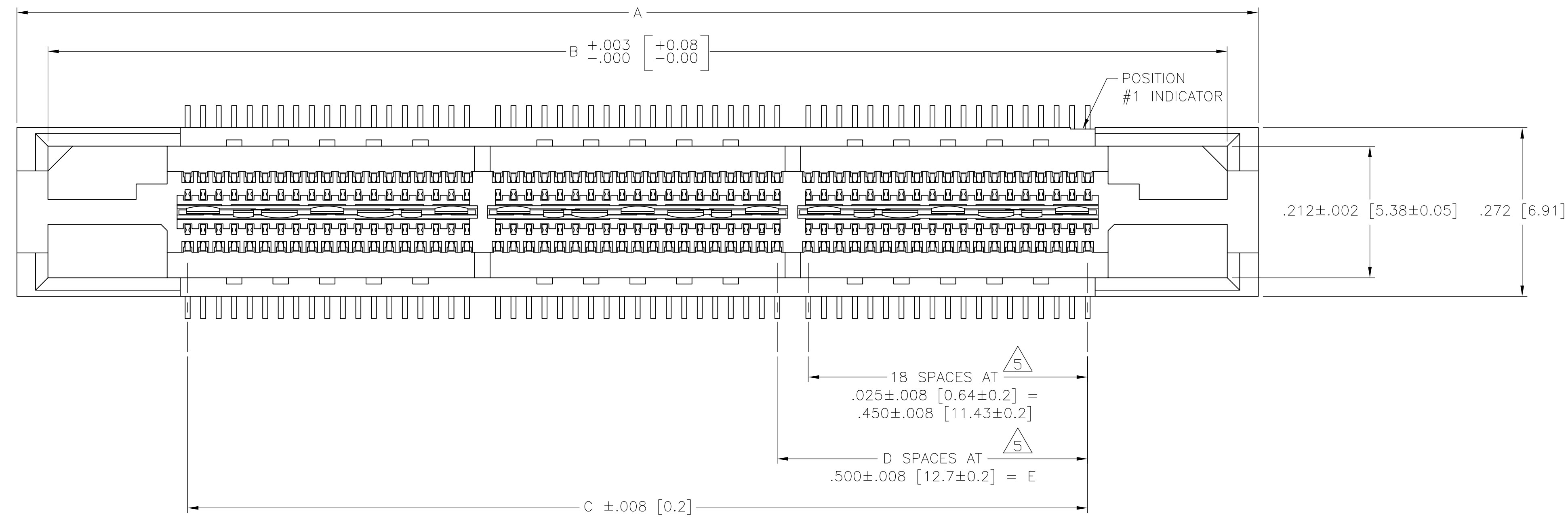

- 1 HOUSING: LIQUID CRYSTAL POLYMER, BLACK.
CONTACTS: HIGH RELIABILITY COPPER ALLOY.
GROUND BUSES: PHOSPHOR BRONZE ALLOY, UNS C51100.
- 2 CONTACTS & GROUND BUSES: NICKEL UNDERPLATE ALL OVER, MATING SURFACE PLATED TO MEET LEVEL 2 PERFORMANCE REQUIREMENTS OF TE PRODUCT SPECIFICATION 108-1422, SOLDER TAILS PLATED TIN-LEAD.
- 3 DATE CODE MARKED IN AREA INDICATED ON SIDE OPPOSITE POSITION #1.
- 4 ONE GROUND BUS WITH 5 TAILS PER EACH MODULE.
- 5 TOLERANCE NON-ACCUMULATIVE.
- 6 FOR STANDARD APPLICATIONS, ORIENTATION HOLE TO BE $\phi .094 \pm .002$ [2.39 \pm 0.05].
FOR SLIP-FIT APPLICATIONS, ORIENTATION HOLE TO BE $\phi .079 \pm .001$ [2.00 \pm 0.03].

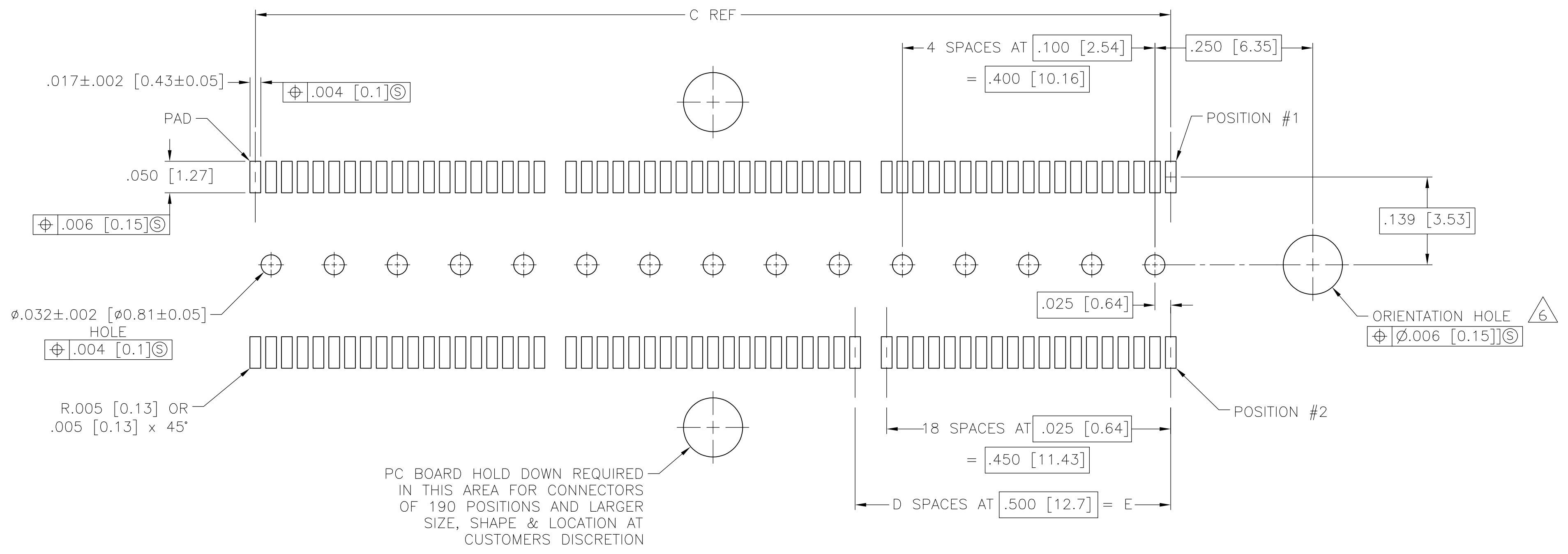
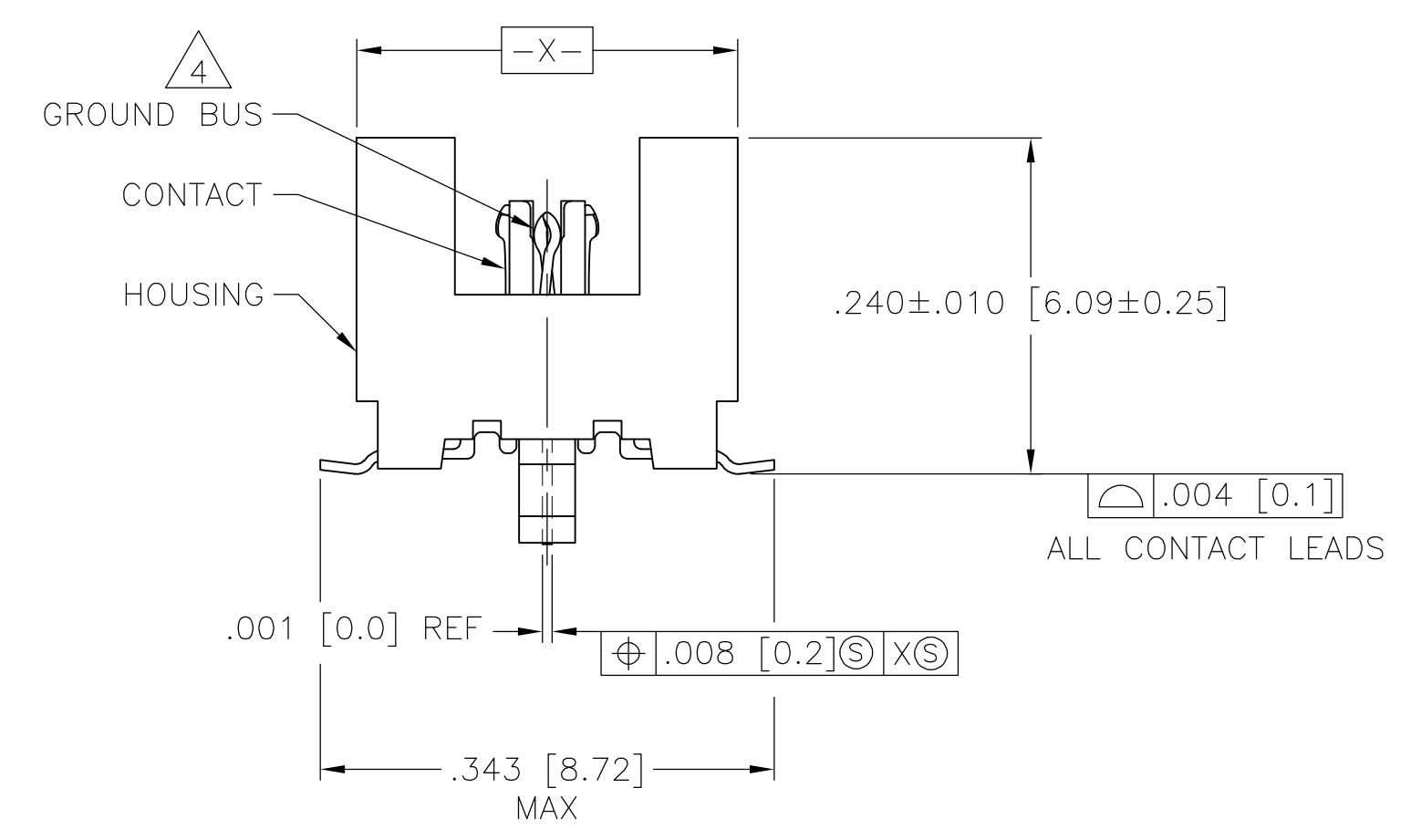
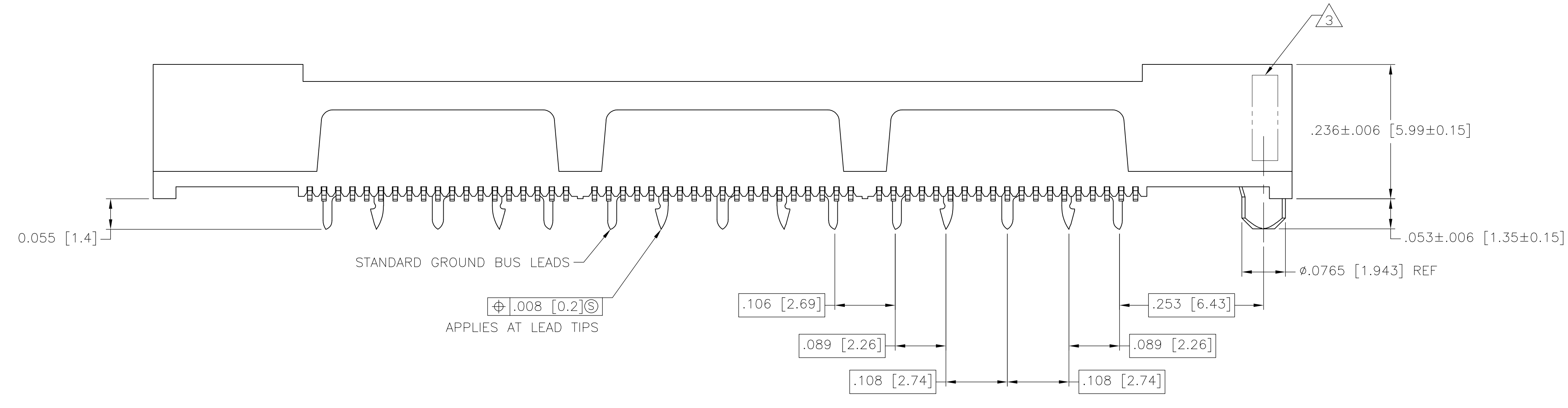

PC BOARD HOLD DOWN REQUIRED IN THIS AREA FOR CONNECTORS OF 190 POSITIONS AND LARGER SIZE, SHAPE & LOCATION AT CUSTOMERS DISCRETION

RECOMMENDED PC BOARD LAYOUT
(VIEWED FROM CONNECTOR SIDE)

POSN	NO OF POSN	PART NUMBER
3.000 [76.2]	6	767181-7
2.500 [63.5]	5	767181-6
2.000 [50.8]	4	767181-5
1.500 [38.1]	3	767181-4
1.000 [25.4]	2	767181-3
.500 [12.7]	1	767181-2
.000 [0]	0	767181-1
E	D	C
3.450 [87.63]	3.900 [99.06]	4.000 [101.6]
2.950 [74.93]	3.400 [86.36]	3.500 [88.9]
2.450 [62.23]	2.900 [73.66]	3.000 [76.2]
1.950 [49.53]	2.400 [60.96]	2.500 [63.5]
1.450 [36.83]	1.900 [48.26]	2.000 [50.8]
.950 [24.13]	1.400 [35.56]	1.500 [38.1]
.450 [11.43]	.900 [22.86]	1.00 [25.4]
		38
		76
		114
		152
		190
		228
		266

THIS DRAWING IS A CONTROLLED DOCUMENT. DIMENSIONS: INCHES[mm]. TOLERANCES UNLESS OTHERWISE SPECIFIED: 0 PLC ± -, 1 PLC ± -, 2 PLC ± -, 3 PLC ± .005 [0.13], 4 PLC ± -. ANGLES ± -.

DIN B CARBO 06AUG02
 CHK D DIXON 06AUG02
 APPV D DIXON 06AUG02
 NAME RECEPTACLE ASSEMBLY, VERTICAL, .025 [0.64] CL, GULL WING LEADS, MICTOR
 PRODUCT SPEC 108-1422
 APPLICATION SPEC 114-11004
 SIZE A1
 WEIGHT -
 CUSTOMER DRAWING

Tyco Electronics Corporation
 Harrisburg, PA 17105-3608

SCALE 8:1 SHEET 1 OF 1 REV B1