

THIS COPY IS PROVIDED ON A RESTRICTED BASIS AND IS NOT TO BE USED IN ANY WAY DETRIMENTAL TO THE INTERESTS OF PANDUIT CORP.

| PANDUIT PART # | STUD SIZE | | DIMENSIONS in. [mm] | | | | |
|----------------|-----------|--------|---------------------|-------------------|--------------------|-------------------|-------------------|
| | ENGLISH | METRIC | L ± .03 [0,76] | W ± .01 [0,25] | C ± .015 [0,38] | M ± .02 [0,51] | H ± .02 [0,51] |
| PMN2-3F | -- | M3 | .78 [19,8] | .23 [5,9] | .19 [4,8] | .64 [16,3] | .15 [3,8] |
| PN14-6FN | #6 | M3, 5 | .78 [19,8] | .24 [6,2] | .19 [4,8] | .64 [16,3] | .15 [3,8] |
| PN14-6F | #6 | M3, 5 | .78 [19,8] | .28 [7,1] | .19 [4,8] | .64 [16,3] | .15 [3,8] |
| PN14-8F | #8 | M4 | .84 [21,3] | .31 [7,9] | .23 [5,9] | .68 [17,3] | .17 [4,3] |
| PN14-10F | #10 | -- | .86 [21,8] | .34 [8,6] | .24 [6,2] | .70 [17,8] | .20 [5,0] |
| PN14-10FN | #10 | -- | .86 [21,8] | .31 [7,9] | .24 [6,2] | .70 [17,8] | .20 [5,0] |
| PMN2-5F | -- | M5 | .86 [21,8] | .34 [8,6] | .25 [6,4] | .70 [17,8] | .21 [5,3] |
| PN14-14F | 1/4" | M6 | 1.03 [26.2] | .44 [11,2] | .32 [8,1] | .78 [19,8] | .27 [6,9] |

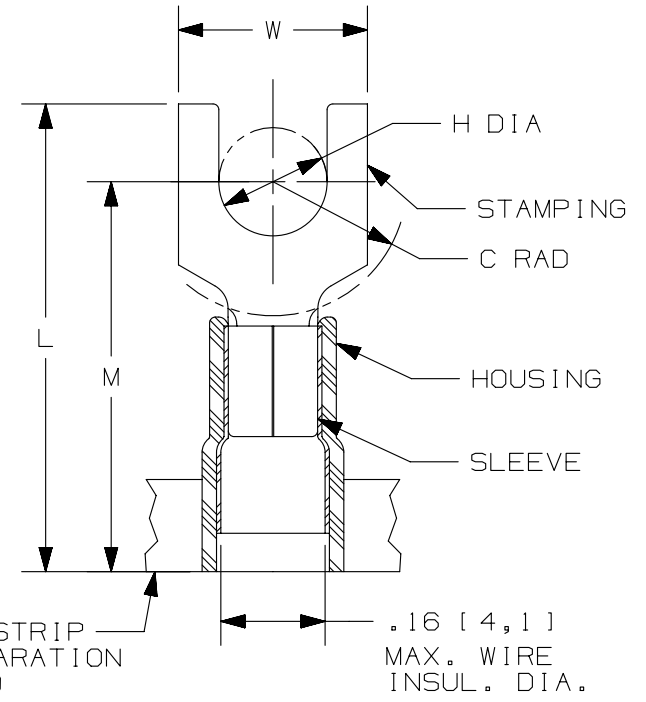

NOTES:

- USED FOR:
 - A. #16-14 AWG [1,5-2,5 mm²] SOLID OR STRANDED COPPER WIRE
 - B. 221°F [105°C] MAX. OPERATING TEMPERATURE
 - C. 600 V. MAX. VOLTAGE RATING
- INSTALLATION TOOLS:
 - A. PRESSES: CP-871
 - B. APPLICATOR: CD-800EZ, CA9
 - C. DIE INSERTS: CD-800-2, CD9-2A
- WIRE STRIP LENGTH: 7/32" ^{+1/32} [5,6 ^{+0,8}]
- MATERIAL:
 - A. STAMPING: .03" [0,76] THK COPPER, TIN PLATED
 - B. HOUSING: NYLON, BLUE
 - C. SLEEVE: BRASS, TIN PLATED
- SEE www.panduit.com FOR PACKAGE QUANTITIES INDICATED BY PART NUMBER SUFFIX
- DIMENSIONS IN BRACKETS ARE METRIC EQUIVALENT



LISTED
587H
E52164



CERTIFIED
LR31212

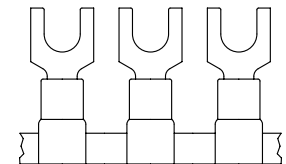

| REV | DATE | BY | CHK | APR | DESCRIPTION | ECN |
|-----|----------|-----|-----|-----|-------------------------------------------------------------------------------|--------|
| 05 | 09.07.12 | JBN | LCA | VMB | ADDED METRIC EQUIVALENT. REVISED NOTES. UPDATED DRAWING TO CURRENT STANDARDS. | A41095 |

| | |
|----------------------------------------------------------------------------------------------------------------------------------------------|-----------------|
| TITLE FORK TERMINALS, 3 PC. NYLON INSULATED, #16-14 CUSTOMER DRAWING | |
| ITEM REVISION NAME N41095BA/05 | PANDUIT |
| DATASET FILE NAME N41095BA_DC/05A | |
| UNLESS OTHERWISE SPECIFIED, DIMENSIONAL TOLERANCES ARE: IN [mm] .x ± .1 [2.54] .xxx ± .005 [.13] .xx ± .01 [.25] ANGLES ± 5° | |
| MATERIAL: SEE NOTES | |
| DRAWING NUMBER: A41095 | |
| DRAWN BY JMV | DATE - |
| CHK FS | SCALE N.T.S. |
| SHT 1 OF 1 | |
| SIZE A | |

D10100DA/15