

THIS DRAWING IS UNPUBLISHED. RELEASED FOR PUBLICATION, 19 .
 © COPYRIGHT 19 BY AMP INCORPORATED. ALL INTERNATIONAL RIGHTS RESERVED.

LOC	DIST	P	F	ZONE	LTR	REVISIONS	DATE	APPD
AG	1				V	REACT-9; PER 0650-0052-98	5-6-98	LM

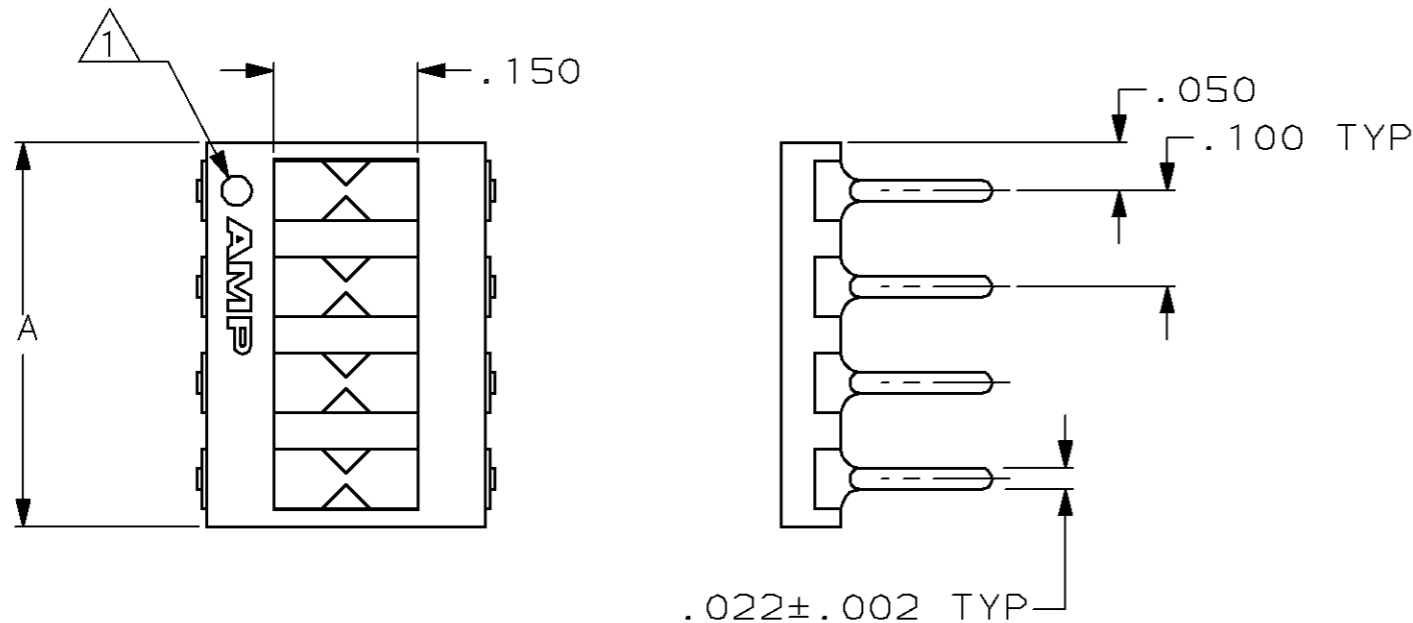

① PIN NUMBER ONE IDENTIFICATION.
 ② MOUNTING SURFACE WHEN INSERTED IN .040 DIA MOUNTING HOLES.

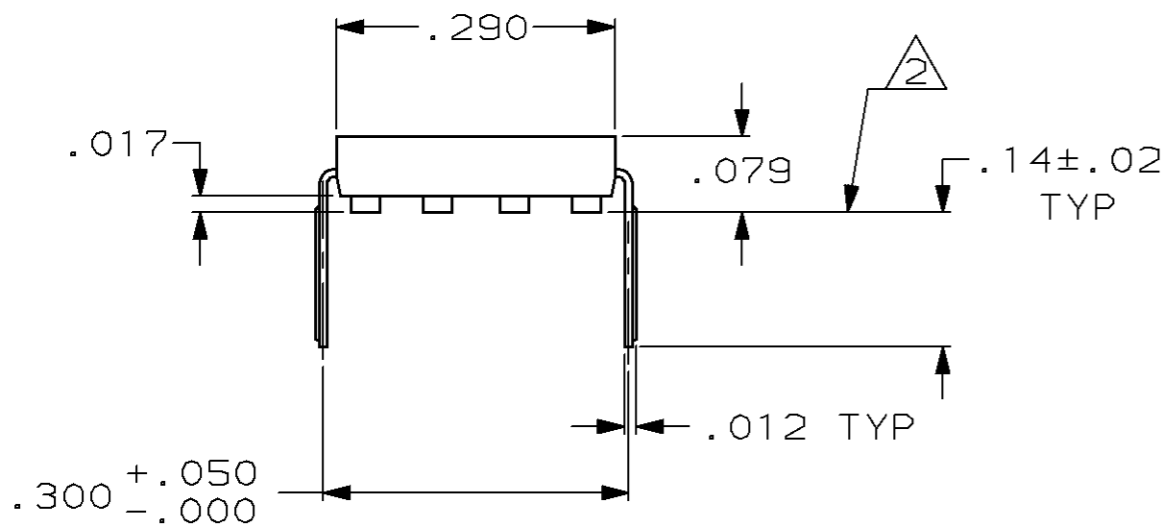

	PLATING	A	NO. OF POSN	PART NO
OBSOLETE	.000015 MIN GOLD ON CONTACT LEADS, OVER NICKEL.	.400	4	1-435704-6
OBSOLETE		.800	8	1-435704-4
		1.200	12	1-435704-2
		1.000	10	1-435704-0
		.900	9	435704-9
		.800	8	435704-8
		.700	7	435704-7
		.600	6	435704-6
OBSOLETE		.500	5	435704-5
OBSOLETE		.400	4	435704-4
OBSOLETE	.300	3	435704-3	
OBSOLETE	.200	2	435704-2	

DO NOT SCALE PRINT. UNLESS SPECIFIED DIMENSIONS TOLERANCES ON: 2 PLC DEC ± - 3 PLC DEC ± .005 ANGLES ± -	DR 12 OCT 1989 M.CYRUS	AMP INCORPORATED Harrisburg, Pa. 17105		
MATERIAL HOUSING: BLACK POLYESTER CONTACT: COPPER ALLOY	CHK -			NAME SHUNT, DIP, PROGRAMMABLE 7600 SERIES
FINISH SEE TABLE	APPD -	SIZE B	CAGE CODE 00779	DRAWING NO 435704
	APPD -	SCALE 5:1	SHEET 1 OF 1	
	PRODUCT SPEC -			
	APPLICATION SPEC -			
	WEIGHT -			