

- NOTES:
 1. ALL PARTS TO BE BULK PACKED.
 2. CONTACTS SHIPPED ASSEMBLED IN CONNECTOR WITH SOLDER CUPS FACING THE KEY
 3. ALL DIMENSIONS ARE REFERENCE EXCEPT THOSE WITH A TOLERANCE

ASS'Y P/N	CABLE O.D.
W8882-XPG-P-513	.130-.150 [3.3-3.8]
W8882-XPG-P-516	.160-.180 [4.1-4.6]
W8882-XPG-P-519	.190-.210 [4.8-5.3]
W8882-XPG-P-522	.220-.250 [5.6-6.3]
W8882-XPG-P-526	.250-.270 [6.3-6.9]
W8882-XPG-P-528	.265-.285 [6.7-7.2]

ASSEMBLY P/N	CONTACT QTY
W8882-8PG-P-5XX	8
W8882-9PG-P-5XX	9
W8882-10PG-P-5XX	10
W8882-XPG-P-5XX	

GROMMET SIZE
 NUMBER OF CONTACTS

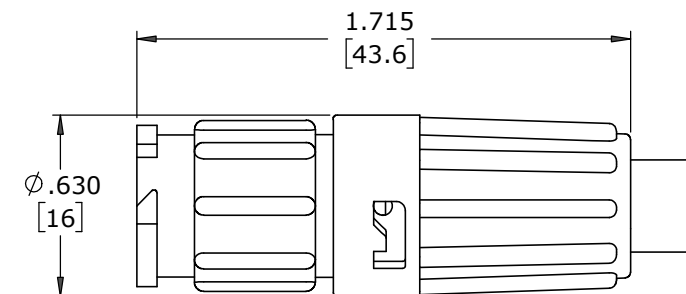

SHOWN ASSEMBLED
 FOR CUSTOMER REFERENCE ONLY

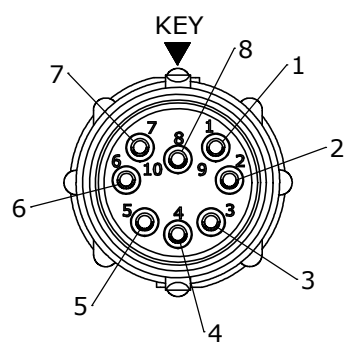
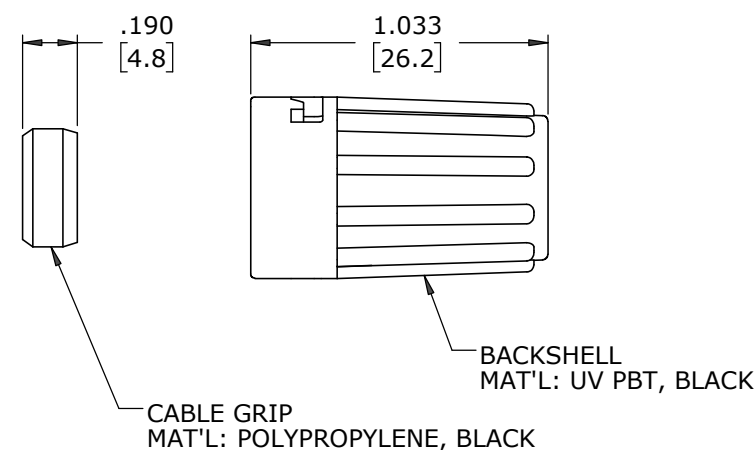
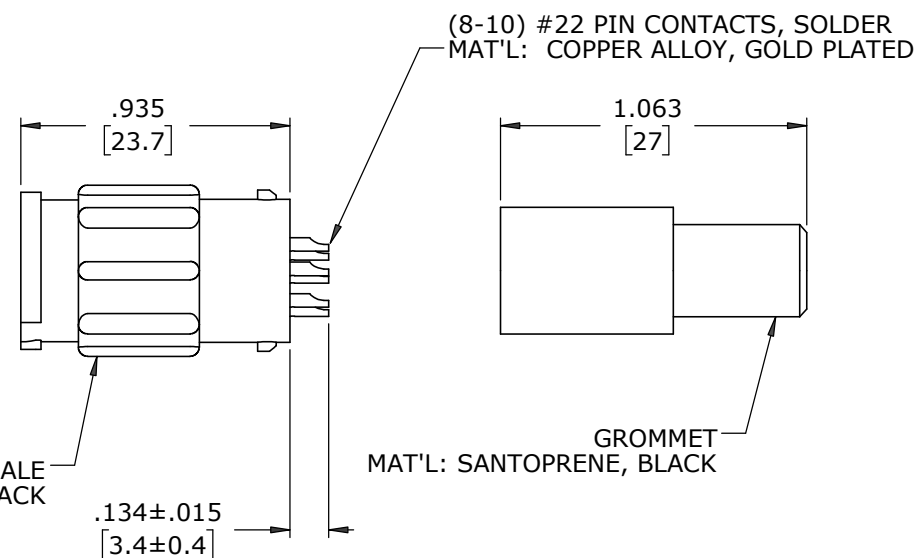
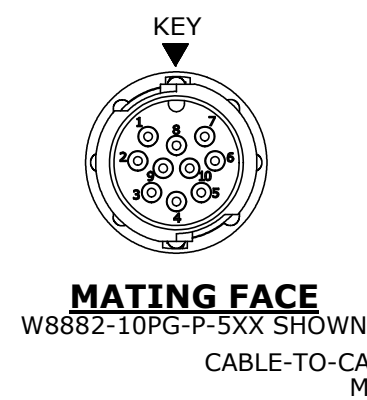

WIRING END
 W8882-8PG-P-5XX

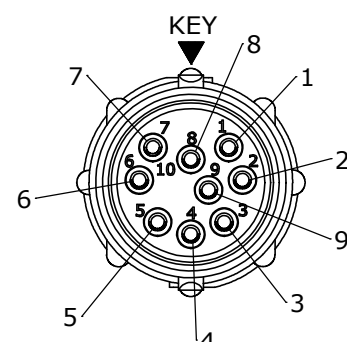

WIRING END
 W8882-9PG-P-5XX

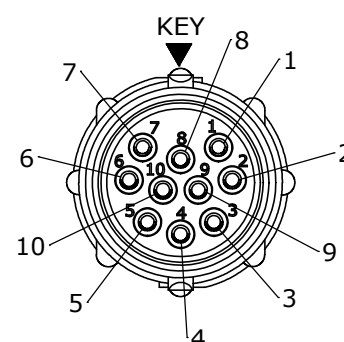

WIRING END
 W8882-10PG-P-5XX

DIMENSIONS IN BRACKETS [] ARE IN MILLIMETERS

CUSTOMER APPROVAL

THIS DOCUMENT CONTAINS CONFIDENTIAL INFORMATION PROPRIETARY TO CONXALL CORPORATION. ANY REPRODUCTION, DISCLOSURE, OR USE OF THIS DOCUMENT /INFORMATION IS EXPRESSLY PROHIBITED UNLESS AUTHORIZED IN WRITING BY CONXALL CORPORATION.

APPROVED BY: _____
 DATE: _____

RoHS COMPLIANT

MA	07-14-20	RELEASED PER PDR 16014-10
PNK	03-20-18	PDR 16014
REV.	INIT.	DATE
ALL INFORMATION ILLUSTRATED IS THE PROPERTY OF "CONXALL CORPORATION". UNAUTHORIZED DUPLICATION OR DISTRIBUTION OF THIS DOCUMENT IS PROHIBITED.		ORIG. DRAWN BY: PNK DATE: 03-20-18 CHECKED BY:
ALL UNITS ARE IN FEET, INCHES, FRACTION OF INCHES AND DECIMALS. UNLESS OTHERWISE SPECIFIED TOLERANCES: 3 PLACE DECIMALS ±.010 ANGLES ±1° FRACTIONS ±1/16 - CRITICAL CHARACTERISTIC FLAG PER SPEC. XXXX		APPROVED BY: SCALE: NTS SIZE: B SHEET: 1 OF 1 FILE: W8882-XPG-P-5XX DIRECTORY: SLW
TITLE: CABLE-TO-CABLE ASSEMBLY (8-10) #22 PIN CONTACTS, SOLDER INSTA-CLICK™ MINI-CON-X CUSTOMER: STANDARD PRODUCT		PART NUMBER: W8882-XPG-P-5XX REV: A



601 E. WILDWOOD VILLA PARK, IL 60181