

(E)

NOTES:

1. MATERIAL:
  - (A). SCREW: SEE LEGEND
  - (B). INSULATOR: PBT, UL94V-0
  - (C). TERMINAL: BRASS, TIN PLATED
2. NUMBER OF CIRCUIT POSITIONS AVAILABLE: 2 THROUGH 15
3. ELECTRICAL RATINGS:
  - (A). MAXIMUM VOLTAGE: 600V
  - (B). MAXIMUM CURRENT: 50A
  - (C). INSULATION RESISTANCE: 500MΩ PER MINUTE
  - (D). DIELECTRIC WITHSTAND VOLTAGE: 2200V AC
4. WIRE RANGE: 8 TO 20 AWG (SOLID OR STRANDED COPPER)
5. RECOMMENDED WIRE STRIP LENGTH: 0.32 IN. (8mm)
6. SCREW TORQUE: 16 LBF. IN. (1.8Nm)
7. OPERATING TEMPERATURE: -40°C TO +120°C

**MATERIAL NUMBER LEGEND**

389 XX X X XX

INSULATOR STYLE ——— NO. OF CIRCUITS  
 69- NO MOUNTING ENDS (02 - 15)

TERMINAL STYLE ——— SCREW STYLE  
 0 - PC TAILS 0 - M4 WITH SQUARE WASHER, STEEL, NICKEL PLATED

TERM. STYLE 0 - PC TAILS

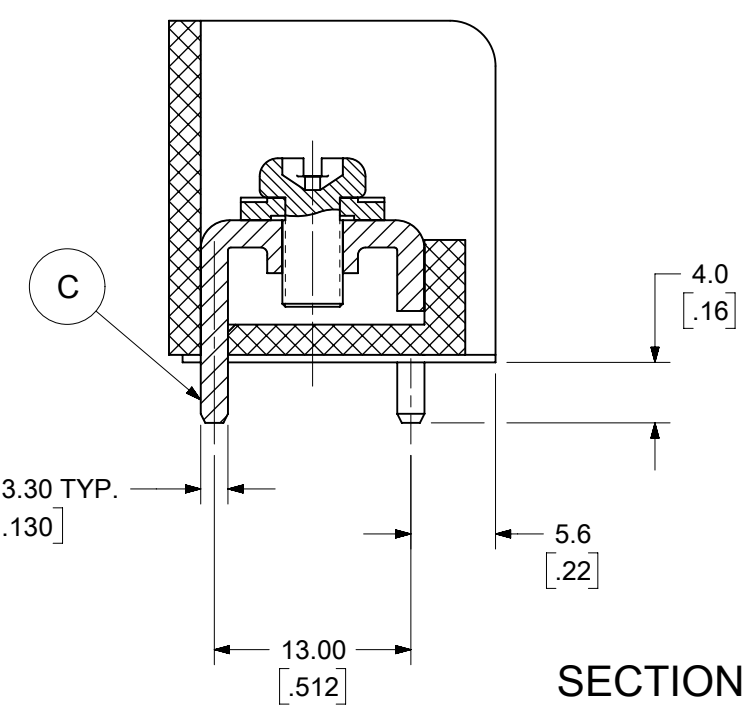

SECTION A-A

|                                                                                                                                               |  |                                                      |  |                        |  |                                         |  |                             |  |
|-----------------------------------------------------------------------------------------------------------------------------------------------|--|------------------------------------------------------|--|------------------------|--|-----------------------------------------|--|-----------------------------|--|
| THIS DRAWING CONTAINS INFORMATION THAT IS PROPRIETARY TO MOLEX ELECTRONIC TECHNOLOGIES, LLC AND SHOULD NOT BE USED WITHOUT WRITTEN PERMISSION |  |                                                      |  |                        |  |                                         |  |                             |  |
| SYMBOLS                                                                                                                                       |  | DIMENSION UNITS                                      |  | SCALE                  |  | CURRENT REV DESC: UPDATED NOTES SECTION |  |                             |  |
| ▽ = 0                                                                                                                                         |  | MM/INCH                                              |  | 2:1                    |  | EC NO: 632901                           |  |                             |  |
| ▽ = 0                                                                                                                                         |  | GENERAL TOLERANCES (UNLESS SPECIFIED)                |  |                        |  | DRWN: ABENJAMINLW 2020/01/14            |  |                             |  |
| ▽ = 0                                                                                                                                         |  | 4 PLACES ± .01                                       |  | MM                     |  | INCH                                    |  | CHK'D: DACHAMMER 2020/02/25 |  |
| ▽ = 0                                                                                                                                         |  | 3 PLACES ± .02                                       |  | ± .005                 |  | APPR: JFMURPHY 2020/03/09               |  |                             |  |
| ▽ = 0                                                                                                                                         |  | 2 PLACES ± 0.13                                      |  | ± .01                  |  | INITIAL REVISION:                       |  |                             |  |
| ▽ = 0                                                                                                                                         |  | 1 PLACE ± 0.3                                        |  | ± .01                  |  | DRWN: CLYORK 2006/11/22                 |  | DOCUMENT NUMBER             |  |
| ▽ = 0                                                                                                                                         |  | 0 PLACES ± .01                                       |  | ± .01                  |  | APPR: JMACNEIL 2006/12/01               |  | SD-38969-001                |  |
| ▽ = 0                                                                                                                                         |  | ANGULAR TOL ± 2°                                     |  | ± 2°                   |  | MATERIAL NUMBER                         |  | CUSTOMER                    |  |
| ▽ = 0                                                                                                                                         |  | DRAFT WHERE APPLICABLE MUST REMAIN WITHIN DIMENSIONS |  | THIRD ANGLE PROJECTION |  | DRAWING                                 |  | SHEET NUMBER                |  |
| ▽ = 0                                                                                                                                         |  |                                                      |  | B-SIZE                 |  | 38969                                   |  | 1 OF 2                      |  |

**molex**

12.70MM [.500] SINGLE ROW TRI-BARRIER TERMINAL STRIP

PRODUCT CUSTOMER DRAWING

DOCUMENT NUMBER: SD-38969-001 | DOC TYPE: PSD | DOC PART: 001 | REVISION: E

MATERIAL NUMBER: SEE LEGEND | CUSTOMER: GENERAL MARKET | SHEET NUMBER: 1 OF 2

| QUANTITY OF CIRCUITS | DIM. "A" |      | DIM. "B" |       |
|----------------------|----------|------|----------|-------|
|                      | mm       | IN   | mm       | IN    |
| 02                   | 27.9     | 1.10 | 12.70    | .500  |
| 03                   | 40.6     | 1.60 | 25.40    | 1.000 |
| 04                   | 53.3     | 2.10 | 38.10    | 1.500 |
| 05                   | 66.0     | 2.60 | 50.80    | 2.000 |
| 06                   | 78.7     | 3.10 | 63.50    | 2.500 |
| 07                   | 91.4     | 3.60 | 76.20    | 3.000 |
| 08                   | 104.1    | 4.10 | 88.90    | 3.500 |
| 09                   | 116.8    | 4.60 | 101.60   | 4.000 |
| 10                   | 129.5    | 5.10 | 114.30   | 4.500 |
| 11                   | 142.2    | 5.60 | 127.00   | 5.000 |
| 12                   | 154.9    | 6.10 | 139.70   | 5.500 |
| 13                   | 167.6    | 6.60 | 152.40   | 6.000 |
| 14                   | 180.3    | 7.10 | 165.10   | 6.500 |
| 15                   | 193.0    | 7.60 | 177.80   | 7.000 |

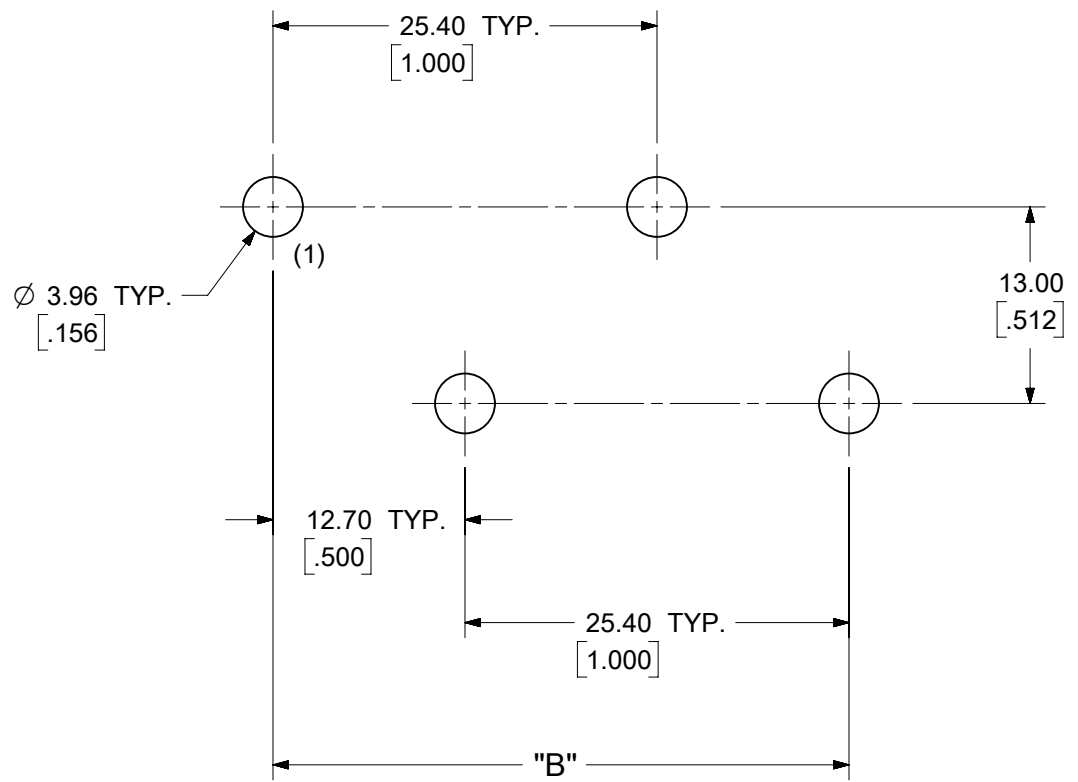

RECOMMENDED PCB LAYOUT

|                                       |                                                                                                                                               |       |      |                                         |      |                              |               |        |                 |                                                                                  |                |  |              |  |
|---------------------------------------|-----------------------------------------------------------------------------------------------------------------------------------------------|-------|------|-----------------------------------------|------|------------------------------|---------------|--------|-----------------|----------------------------------------------------------------------------------|----------------|--|--------------|--|
| SYMBOLS                               | THIS DRAWING CONTAINS INFORMATION THAT IS PROPRIETARY TO MOLEX ELECTRONIC TECHNOLOGIES, LLC AND SHOULD NOT BE USED WITHOUT WRITTEN PERMISSION |       |      |                                         |      |                              |               |        |                 |                                                                                  |                |  |              |  |
|                                       | DIMENSION UNITS                                                                                                                               | SCALE |      | CURRENT REV DESC: UPDATED NOTES SECTION |      |                              |               |        |                 |                                                                                  |                |  |              |  |
| MM/INCH                               | 2:1                                                                                                                                           |       |      |                                         |      |                              |               |        |                 |                                                                                  |                |  |              |  |
| GENERAL TOLERANCES (UNLESS SPECIFIED) |                                                                                                                                               |       | MM   |                                         | INCH |                              | EC NO: 632901 |        |                 | 12.70MM [.500] SINGLE ROW TRI-BARRIER TERMINAL STRIP<br>PRODUCT CUSTOMER DRAWING |                |  |              |  |
| ▽ = 0                                 | 4 PLACES                                                                                                                                      | ±     | ---  | ±                                       | ---  | DRWN: ABENJAMINLW 2020/01/14 |               |        |                 |                                                                                  |                |  |              |  |
| ▽ = 0                                 | 3 PLACES                                                                                                                                      | ±     | ---  | ±                                       | .005 | CHK'D: DACHAMMER 2020/02/25  |               |        |                 |                                                                                  |                |  |              |  |
| ▽ = 0                                 | 2 PLACES                                                                                                                                      | ±     | 0.13 | ±                                       | .01  | APPR: JFMURPHY 2020/03/09    |               |        |                 |                                                                                  |                |  |              |  |
| ▽ = 0                                 | 1 PLACE                                                                                                                                       | ±     | 0.3  | ±                                       | ---  | INITIAL REVISION:            |               |        |                 |                                                                                  |                |  |              |  |
| ▽ = 0                                 | 0 PLACES                                                                                                                                      | ±     | ---  | ±                                       | ---  | DRWN: CLYORK 2006/11/22      |               |        |                 |                                                                                  |                |  |              |  |
| □ = 0                                 | ANGULAR TOL                                                                                                                                   |       | ±    |                                         | 2°   | APPR: JMACNEIL 2006/12/01    |               |        |                 |                                                                                  |                |  |              |  |
| ■ = 0                                 | DRAFT WHERE APPLICABLE MUST REMAIN WITHIN DIMENSIONS                                                                                          |       |      | THIRD ANGLE PROJECTION                  |      | DRAWING                      |               | SERIES |                 | DOCUMENT NUMBER                                                                  |                |  |              |  |
| ▽ = 0                                 |                                                                                                                                               |       |      |                                         |      | B-SIZE                       |               | 38969  |                 | SD-38969-001                                                                     |                |  |              |  |
|                                       |                                                                                                                                               |       |      |                                         |      |                              |               |        | DOC TYPE        |                                                                                  | DOC PART       |  | REVISION     |  |
|                                       |                                                                                                                                               |       |      |                                         |      |                              |               |        | PSD             |                                                                                  | 001            |  | E            |  |
|                                       |                                                                                                                                               |       |      |                                         |      |                              |               |        | MATERIAL NUMBER |                                                                                  | CUSTOMER       |  | SHEET NUMBER |  |
|                                       |                                                                                                                                               |       |      |                                         |      |                              |               |        | SEE LEGEND      |                                                                                  | GENERAL MARKET |  | 2 OF 2       |  |