

THIS DRAWING IS UNPUBLISHED.
 © COPYRIGHT BY TYCO ELECTRONICS CORPORATION. ALL RIGHTS RESERVED.

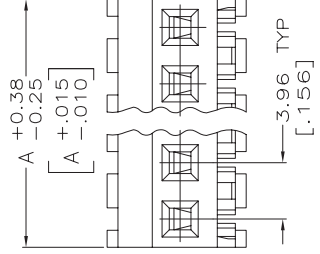
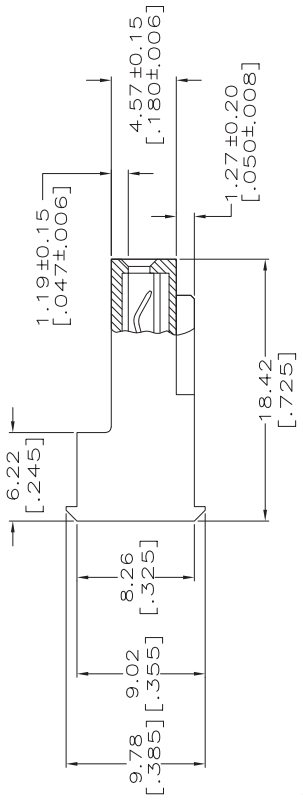
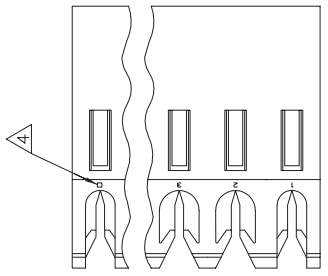

1. MATERIAL: NYLON UL94V-2 (BLUE).
 CONTACTS - 0.30[.012] THICK COPPER ALLOY.
 PLATING - 0.00038[.000015] GOLD IN CONTACT AREA.
 0.00203[.000080] MIN THICKNESS BRIGHT
 TIN-LEAD IN SLOT AREA FOR 641177-2
 THRU 2-641177-4 OR MATTE WHISKER
 MITIGATED TIN IN SLOT AREA FOR
 3-641177-2 THRU 5-641177-4 OVER
 NICKEL UNDERPLATE.

- CONTACTS ACCEPT 26 AWG WIRE WITH 2.41[.095] MAX INSULATION DIAMETER.
- CONTACTS MUST ACCEPT 1.14±0.03[.045±.001] SQUARE POST AND REMAIN LOCKED IN POSITION.
- IDENTIFICATION NUMBER FOR LAST CIRCUIT MAY NOT APPEAR ON ALL ASSEMBLIES.
- DIMENSIONS IN BRACKETS ARE IN INCHES.
- HOUSING FEATURES ARE: FEED-THRU WITHOUT LOCKING RAMP.

NOTE DELETED.
 NOTE DELETED.



LOC CM O
 P LTR H
 ECO-07-012887

REVISIONS
 DESCRIPTION DATE
 H 22JUN07 KW DB

NO.	REV.	DESCRIPTION	DATE	BY	APP'D
1					
2					
3					
4					
5					
6					
7					
8					
9					
10					
11					
12					
13					
14					
15					
16					
17					
18					
19					
20					
21					
22					
23					
24					

THIS DRAWING IS A CONTROLLED DOCUMENT.

DATE: 3-11-98
 BY: B. LEWIS
 CHK: SWING

PRODUCT SPEC: 108-1051
 APPLICATION SPEC: 114-1020
 WEIGHT: -

CONTRACT FINISH: DIM A
 NO. OF CIRCUITS: 2

TYCO ELECTRONICS
 Tyco Electronics Corporation
 Harrisburg, Pa 17105-3608

MTA-156 CONNECTOR ASSEMBLY,
 26 AWG, STANDARD

SIZE: A2 00779
 DRAWING NO: 641177

CUSTOMER DRAWING
 SCALE: 4:1
 SHEET: 1 OF 1