

### ASSEMBLY INSTRUCTIONS:

- A) Apply gasket on either side .250 in from edge run gasket along entire edge from front to rear.
- B) Apply gasket along front and rear edges keep as close to radius of edge as possible.
- C) Cut and glue ends to the two side gasket strips.

### TYPICAL GASKET APPLICATION

Caution: Do not disturb gasket after applying adhesive. Do not handle while packing units or bump into other objects

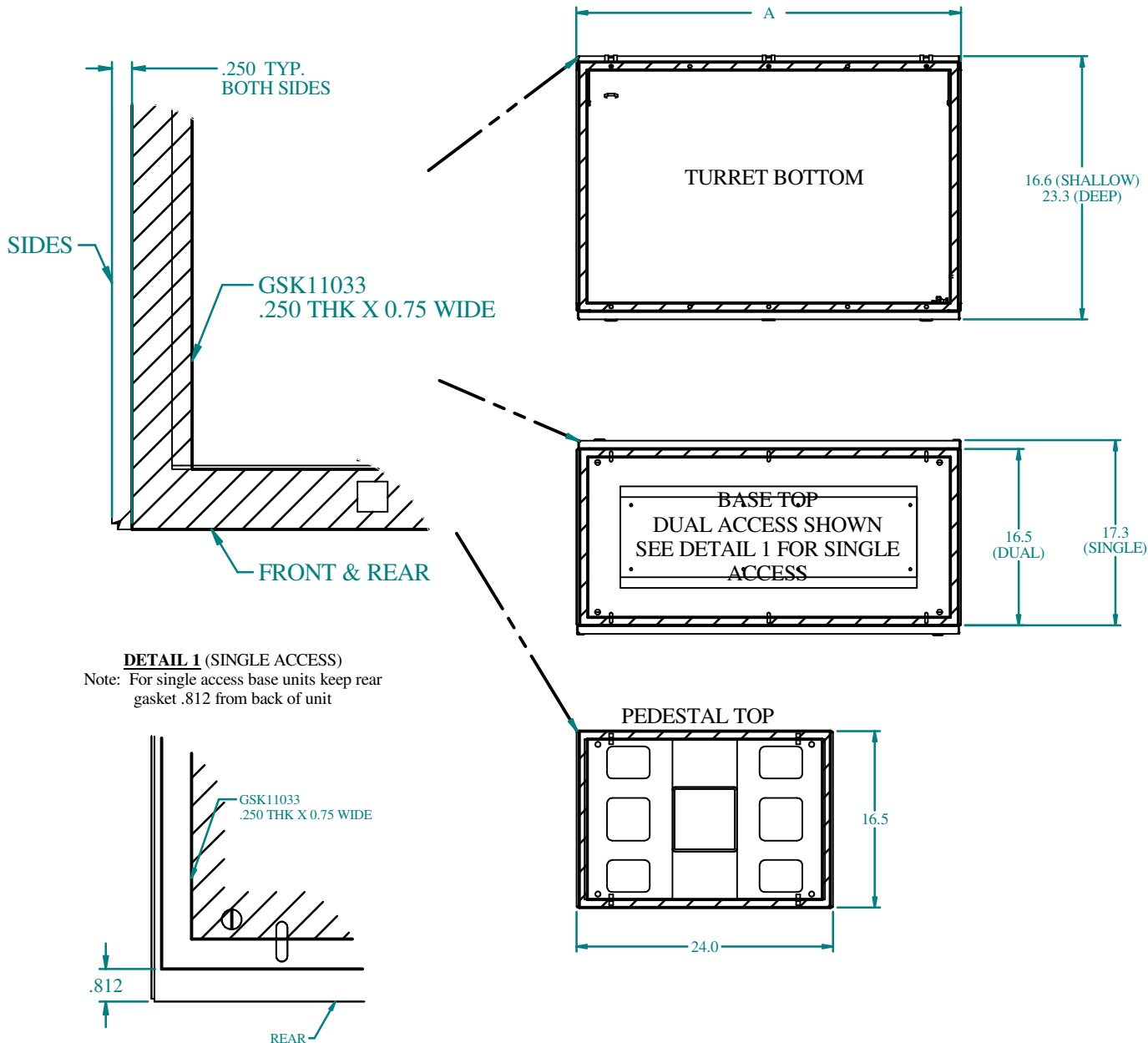

TOOL BOX



Utility Knife



Tape Measure



Glue TG5 Adhesive

