

Base strip - PCV 6-16/ 9-G1F-10,16 - 1996414

Please be informed that the data shown in this PDF Document is generated from our Online Catalog. Please find the complete data in the user's documentation. Our General Terms of Use for Downloads are valid (<http://phoenixcontact.com/download>)



Header, Nominal current: 76 A, Rated voltage (III/2): 1000 V, Number of positions: 9, Pitch: 10.16 mm, Color: green, Contact surface: Silver, Assembly: Soldering

The figure shows a 5-pos. version of the product

Product Features

- PCB/PCB connections by using IPC 16 headers
- CS-IPC 16/6 for anti-rotation protection during assembly
- Vertical PCV 6-16 headers for use in combination with all PC 6 and PC 16 plugs



Key commercial data

| | |
|--------------------------------------|-----------|
| Packing unit | 1 pc |
| Minimum order quantity | 50 pc |
| Weight per Piece (excluding packing) | 43.05 GRM |
| Custom tariff number | 85366990 |
| Country of origin | Poland |

Technical data

Dimensions

| | |
|----------------|------------|
| Length | 13.4 mm |
| Height | 34 mm |
| Pitch | 10.16 mm |
| Dimension a | 81.28 mm |
| Pin dimensions | 1 x 1.2 mm |
| Pin spacing | 10.16 mm |
| Hole diameter | 1.7 mm |

General

| | |
|-------------------|-----------------|
| Range of articles | PCV 6-16/..-G1F |
|-------------------|-----------------|

Base strip - PCV 6-16/ 9-G1F-10,16 - 1996414

Technical data

General

| | |
|---|---|
| Insulating material group | I |
| Rated surge voltage (III/3) | 6 kV |
| Rated surge voltage (III/2) | 8 kV |
| Rated surge voltage (II/2) | 8 kV |
| Rated voltage (III/3) | 1000 V |
| Rated voltage (III/2) | 1000 V |
| Rated voltage (II/2) | 1000 V |
| Connection in acc. with standard | EN-VDE |
| Nominal current I _N | 76 A (41 A in combination with PC 6 plug) |
| Maximum load current | 76 A (41 A in combination with PC 6 plug) |
| Insulating material | PA |
| Inflammability class according to UL 94 | V0 |
| Color | green |
| Number of positions | 9 |

Classifications

eCl@ss

| | |
|------------|----------|
| eCl@ss 4.0 | 272607xx |
| eCl@ss 4.1 | 27260701 |
| eCl@ss 5.0 | 27260701 |
| eCl@ss 5.1 | 27260701 |
| eCl@ss 6.0 | 27260704 |
| eCl@ss 7.0 | 27440402 |
| eCl@ss 8.0 | 27440402 |

ETIM

| | |
|----------|----------|
| ETIM 3.0 | EC001121 |
| ETIM 4.0 | EC002637 |
| ETIM 5.0 | EC002637 |

UNSPSC

| | |
|---------------|----------|
| UNSPSC 6.01 | 30211810 |
| UNSPSC 7.0901 | 39121409 |
| UNSPSC 11 | 39121409 |
| UNSPSC 12.01 | 39121409 |
| UNSPSC 13.2 | 39121409 |

Base strip - PCV 6-16/ 9-G1F-10,16 - 1996414

Approvals

Approvals

Approvals

UL Recognized / SEV / cUL Recognized / CCA / GOST / GOST / cULus Recognized

Ex Approvals

Approvals submitted

Approval details

| | | | |
|--|-------|-------|-------|
| UL Recognized  | | | |
| | B | C | D |
| Nominal current IN | 66 A | 66 A | 5 A |
| Nominal voltage UN | 300 V | 300 V | 600 V |

| | |
|--------------------|--------|
| SEV | |
| | |
| Nominal current IN | 76 A |
| Nominal voltage UN | 1000 V |

| | | | |
|--|-------|-------|-------|
| cUL Recognized  | | | |
| | B | C | D |
| Nominal current IN | 66 A | 66 A | 5 A |
| Nominal voltage UN | 300 V | 300 V | 600 V |

| | |
|--------------------|--------|
| CCA | |
| | |
| Nominal current IN | 76 A |
| Nominal voltage UN | 1000 V |

Base strip - PCV 6-16/ 9-G1F-10,16 - 1996414

Approvals

GOST

GOST

cULus Recognized

Drawings

Drilling diagram

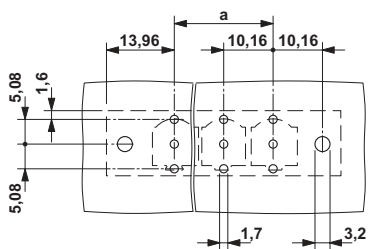

Dimensioned drawing

