

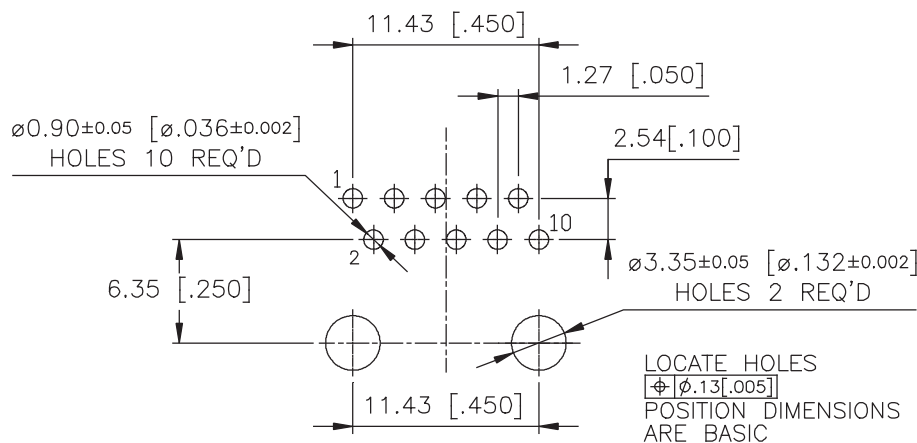

REVISIONS			
REV	DESCRIPTION, EGN, EAR NO.	DATE	APP'D
A	PROPOSAL DRAWING	JAN02/14	L.CHAN
B	PROPOSAL DRAWING	FEB12/14	L.CHAN
C	ADD CONTACT PLATING OPTION	APR10/14	L.CHAN

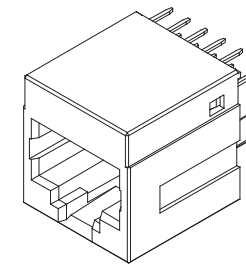
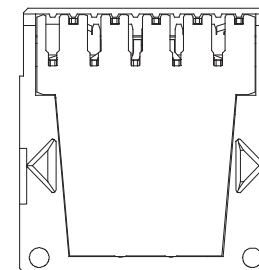
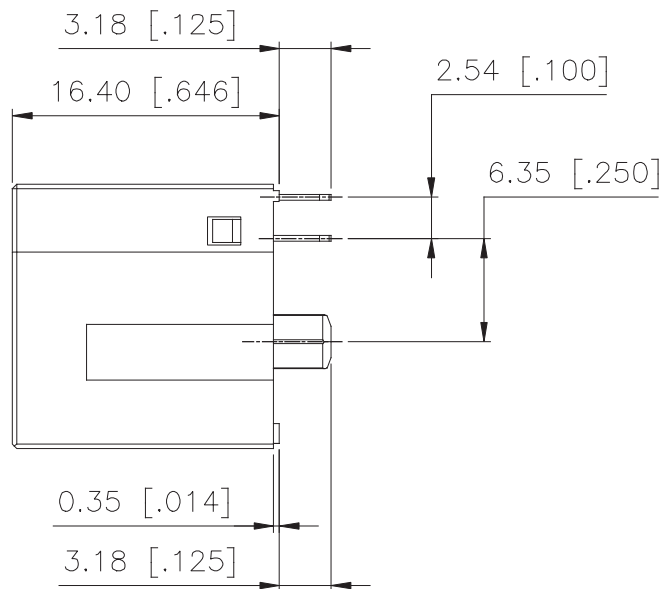
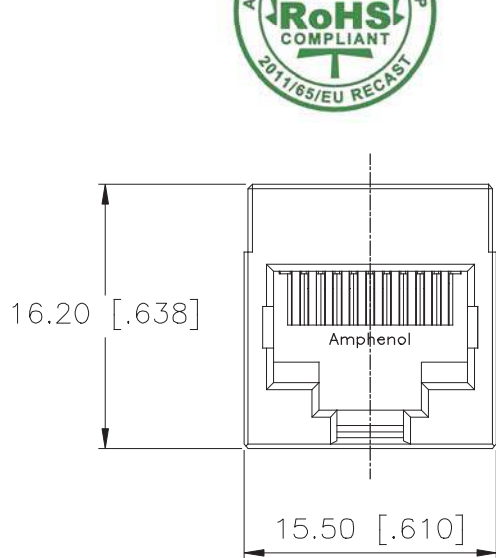

RECOMMENDED P.C.B LAYOUT  
(COMPONENT SIDE OF BOARD  
TOLERANCES:  $\pm 0.05$  [.002],  
BASED ON PRODUCT WITH  
SHIELD)

**1. MATERIALS:**

PLASTIC HOUSING: ENGINEERING THERMOPLASTIC  
FLAMMABILITY RATING UL 94V-0  
COLOUR: BLACK

CONTACTS: PHOSPHOR BRONZE  
PLATING: REFER PART NUMBER FOR GOLD THICKNESS  
ON MATING SURFACES.  
50 $\mu$ " [1.27 MICRONS]  
MIN. NICKEL UNDERPLATE  
100 $\mu$ " [2.54 MICRONS]  
MIN. MATTE TIN ON CONTACT TAILS.

OPERATING TEMPERATURE: -55°C TO +105°C  
AMPHENOL PART NUMBER: RJE74-1AA-0X10

- 1 = 6u INCH
- 2 = 15u INCH
- 3 = 30u INCH
- 4 = 50u INCH

UNLESS SPECIFIED OTHERWISE	DRAWN	J.FENG	JAN02/14
PRIMARY UNITS MILLIMETERS	CHECKED	L.CHAN	JAN02/14
SECONDARY	M.E. APP'D		
REFERENCE IN PARENTHESES	Q.A. APP'D		
GENERAL TOLERANCES	DWG APP'D	L.CHAN	JAN02/14
1 DECIMAL PLACE $\pm 0.38$	ENG. REL. NO.		
2 DECIMAL PLACES $\pm 0.25$	REF.		
3 DECIMAL PLACES			
ANGULAR DEGREES $\pm 1.5^\circ$	THIRD ANGLE PROJECTION		
	DO NOT SCALE DRAWING		

Amphenol Canada Corp.

TITLE  
MODULAR JACK, 10 POSITION & 10 CONTACT,  
UNSHIELDED, WITHOUT KEY, PBT MATERIAL,  
TRAY PACKAGING, - RoHS COMPLIANT

DWG NO.	P-RJE74-1AA-0X10	REV	C
CODE ID NO.	03554	DWG SIZE	C
SCALE	N/A	SHEET	1 OF 1