

| REVISIONS | | | |
|-----------------|--|-----------------|--------------------------|
| REV | DESCRIPTION | DATE | APPROVED |
| 01 ₀ | RELEASED | | |
| 02 ₀ | MAJOR REDESIGN PER ECN 89-1221-6 REDRAWN ON CAD PER ECN 88-0678 | LROSS 2-6-90 | <i>P.J.H.</i> 2-12-90 |

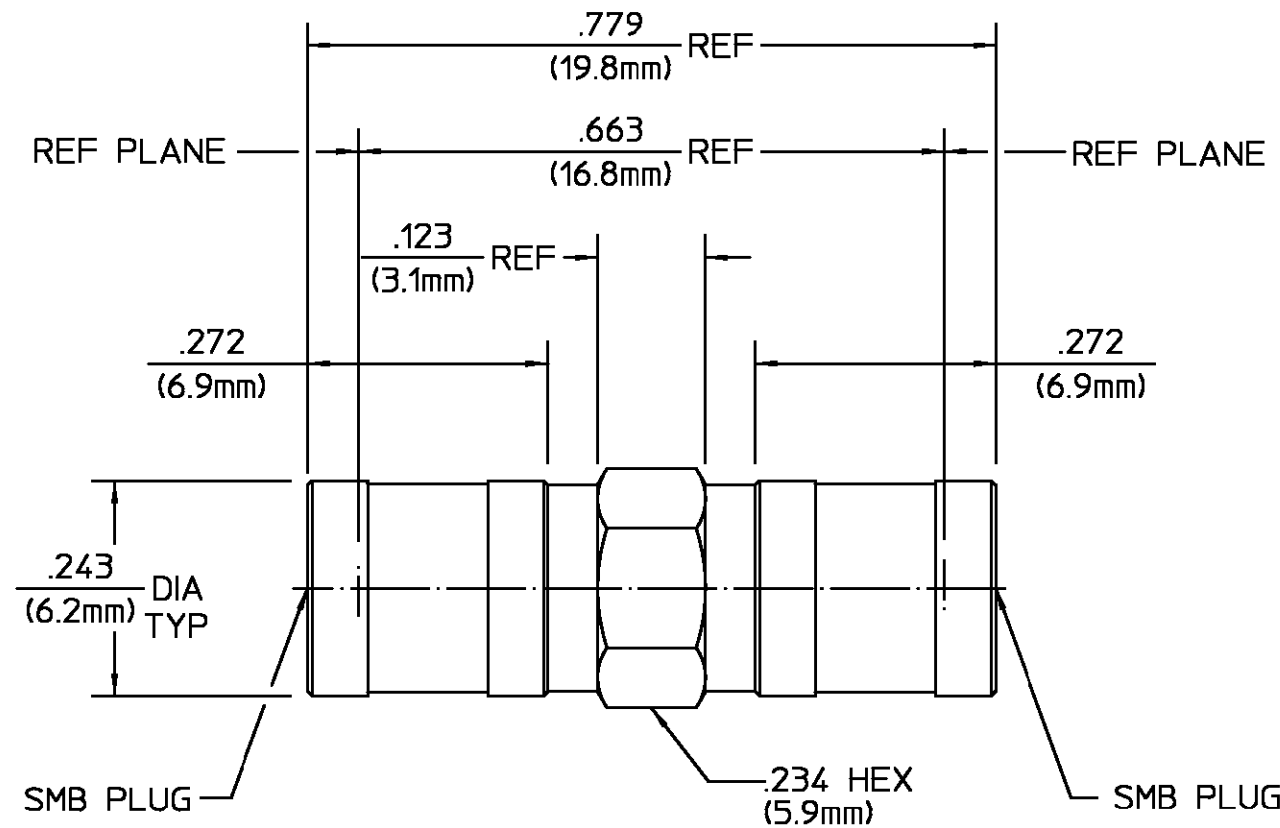

| | | |
|----------------|---|---|
| HOUSING SLEEVE | BRASS PER QQ-B-626 COMP. 360 | GOLD PLATE PER MIL-G-45204 OVER COPPER PLATE PER MIL-C-14550 |
| DIELECTRIC | TFE FLUOROCARBON PER ASTM-D-1457, MIL-P-19468, AND FED. SPEC L-P-403 | N/A |
| CENTER CONTACT | BERYLLIUM COPPER PER ASTM B196, ALLOY 173 | GOLD PLATE PER MIL-G-45204 OVER COPPER PLATE PER MIL-C-14550 |
| RETAINING RING | BERYLLIUM COPPER PER QQ-C-530 | GOLD PLATE PER MIL-G-45204 OVER COPPER PLATE PER MIL-C-14550 |

| COMPONENT | MATERIAL | FINISH |
|--|----------|---|
| UNLESS OTHERWISE SPECIFIED DIMENSIONS ARE IN INCHES TOLERANCE ON | | |
| FRAC. | DEC. | ANGLES |
| ± 1/64 | ± .005 | ± 1° |
| DRAWN BY E.J.C. DATE 5-26-71 | | AMP Incorporated 140 Fourth Avenue Waltham, MA 02451-7599 |
| CHECKED BY P.R.B. 6-1-71 | | |
| APP'D BY B.K.W. 6-1-71 | | |
| USE ASSY PROCEDURE | | TITLE SMB PLUG TO PLUG ADAPTER |
| NO. AP. N/A | | SIZE B CODE IDENT NO. 26805 5181-0000-09 REV 02 ₀ |
| SCALE 5:1 | | SHEET 1 OF 1 |

NOTES:
1. CAPTURED CENTER CONTACT

These drawings and specifications are the property of Omni Spectra Incorporated and shall not be reproduced or copied or used in whole or in part as the basis for the manufacture or sale of item(s) without written permission.

CUSTOMER DRAWING

AMP PART # 1060492-1
SHEET 1 OF 1 REV A