

| Rev | AWO # | Description | Date | Appr |
|-----|-------|---------------|---------|------|
| - | | RELEASED | 4/22/05 | |
| A | | REDRAWN | 7/14/11 | |
| B | | REVISED SPEC. | 7/10/12 | |

APPROVED: _____
 DATE: _____ TITLE: _____

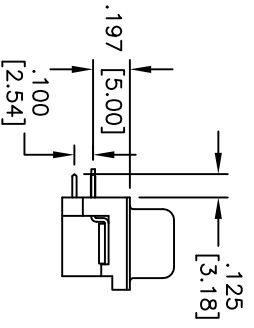
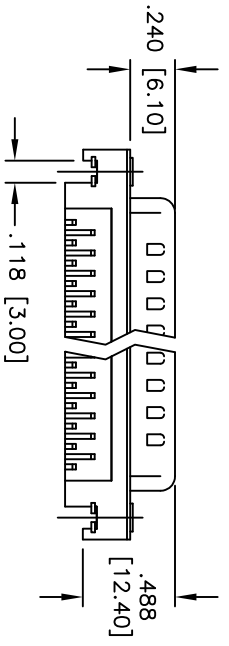
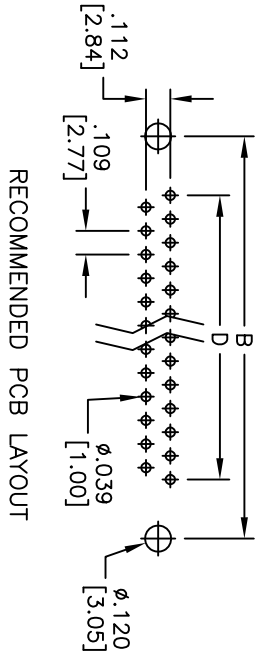
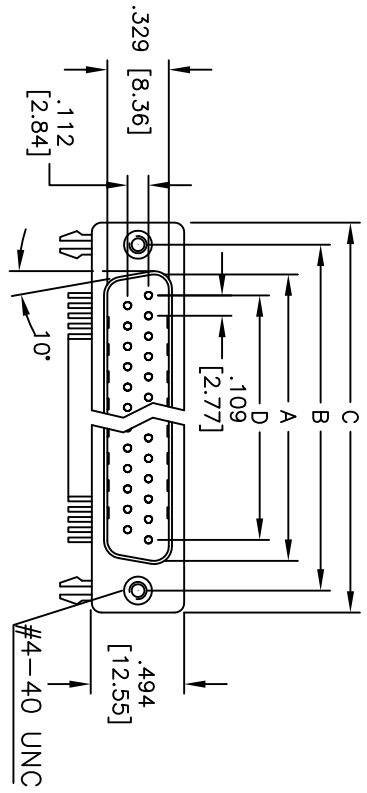

| DXXX | NO. OF CONTACTS | DIMENSIONS | | | |
|------|-----------------|---------------|---------------|---------------|---------------|
| | | A | B | C | D |
| DE09 | 9 | .666 [16.92] | .984 [24.99] | 1.213 [30.81] | .436 [11.08] |
| DA15 | 15 | .994 [25.25] | 1.311 [33.30] | 1.543 [39.20] | .763 [19.39] |
| DB25 | 25 | 1.573 [39.96] | 1.852 [47.04] | 2.089 [53.05] | 1.309 [33.24] |
| DC37 | 37 | 2.182 [55.42] | 2.500 [63.50] | 2.732 [69.40] | 1.963 [49.86] |

ADAM TECH

909 Railway Avenue, Union, NJ 07083
 Phone: 908-687-5000 Fax: 908-687-5710

TITLE: .197 [5.00] SLIMLINE D-SUB PLUG
 FORKED BOARDLOCKS, #4-40 INSERTS

SPECIFICATIONS:
 Material: Insulator: PBT, glass reinforced, rated UL 94V-0
 Insulator color: Black
 Contacts: Copper Alloy
 Shell: Steel, Nickel plated.
 Clinch Nut: Copper Alloy, Nickel plated
 Boardlock: Brass, Tin plated
 Plating:
 Gold flash over Nickel underplate overall
 Electrical:
 Operating voltage: 250 VAC max
 Current rating: 3 Amps max
 Contact resistance: 20 mohms max
 Insulation resistance: 1,000 Mohms max
 Dielectric withstanding voltage: 1,000 VAC for 1 minute
 Temperature Rating:
 Operating temperature: -55°C to +105°C
 Environmental:
 Lead free, RoHS compliant



| | | | |
|--|------------|-----------------------------|--------|
| UNLESS OTHERWISE SPECIFIED ALL DIMENSIONS ARE INCHES [MM] | | TOLERANCES: EXCEPT AS NOTED | |
| INCHES | | HOLDS | |
| .X | ±.10 | ØXX | ±.10 |
| .XX | ±.020 | ØXXX | ±.015 |
| .XXX | ±.015 | ØXXXX | ±.010 |
| APPROVALS | | DATE | |
| DRAWN | SS | 4/22/05 | |
| CHECKED | | | |
| APPROVED | | | |
| SIZE | PART NO. | REF. | SCALE |
| X | DXXX-PN-24 | S00087T | NIS |
| REV. | | SHEET | 1 OF 1 |
| B | | | |