

# 0040 AC Inlet with 5 x 20mm Fuseholder



**Note:** Not recommended for new designs. Refer to KEA (pg. 36), GSF (pg. 13/14) or 6220 (pg. 35)



Standards: UL 498; CSA C22.2/182.3; DIN/VDE 0625; SEMKO 9320; IEC 320/C14/C18; EN 60320

- Power entry module with 1-pole or 2-pole fuseholder
- For "cold" connections 70° C, Protection Class I or II
- Screw mount from front
- Single or double pole shocksafe fuseholder according to IEC 65/VDE 0860 for 5 x 20mm fuses
- Quick-connect terminals .187" x .032" (4.8 x 0.8mm)
- 0.5 Nm torque required for M3 screws
- Max. power dissipation 2.4 watts (2-pole fusing) according to IEC 127-6. For additional values  $P_v$  in function of  $T_{amb}$ , see page 5
- For materials, options and accessories please see page 30
- For inlet with piggy-back fuse clips see GSF, page 13-14

UL recognition	10A/250V	File #E93617
CSA certification	10A/250V	File #LR38456
VDE approval	6A/250V	File #19397
SEMKO approval	10A/250V	} File numbers on request
SEV approval	10A/250V	

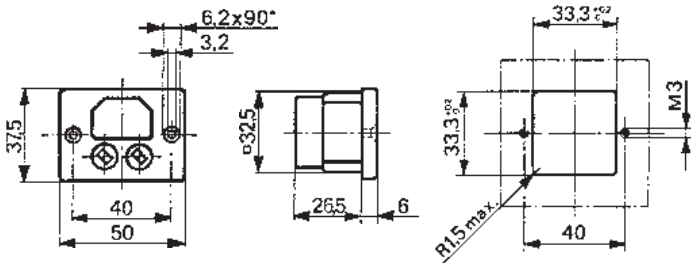

page 102.

Series 0040			
Class I	Class II	Color/Fusing	Terminal Type
0040.5000.2	0040.5015	black/2-pole	solder
8843-2.SP.FL.4/3.60	8842-2.SP.FL.4/3.60		.138" x .032" (3.5 x 0.8mm)
0040.5001.2		grey/2-pole	quick-connect
8843-2.SP.FL.4/3.64			.187" x .032" (4.8 x 0.8mm)
0040.5012		black/1-pole	quick-connect
8843-2.SP.U.FL.4/3.60			.250" x .032" (6.3 x 0.8mm)

# 8843 AC Inlet • Interchangeable Fuseholders for 1/4 x 1 1/4" or 5 x 20mm Fuses



Standards: UL 498; CSA C22.2/182.3; DIN/VDE 0625; SEMKO 9320; IEC 320/C14; EN 60320. U.S. Patented.

- Power entry module with 1-pole or 2-pole fuseholder
- For "cold" connections 70° C, Protection Class I.
- Screw mount from front or rear, or snap-in mount from front (0.8-3.0mm panel thickness)
- Single or double pole shocksafe fuseholder according to IEC 65/VDE 0860 for 1/4 x 1 1/4" or 5 x 20mm fuses
- Quick-connect terminals .187" x .032" (4.8 x 0.8mm) or solder .138 x .032" (3.0 x 0.8mm).
- 0.5 Nm torque required for M3 screws for screw-on type
- Max. power dissipation 5.5 watts (2 pole fusing, unfiltered) according to IEC 127-6. For additional values  $P_v$  in function of  $T_{amb}$ , see page 6
- For materials, options and accessories please see page 30
- For 8843 with line filter, please see 8843 on page 59
- For inlet with piggy-back fuse clips see GSF, page 13-14

UL recognition	10A/250V	File #E96317
CSA certification	10A/250V	File #LR38456
VDE approval	10A/250V	File #3157, expert report
SEMKO approval	10A/250V	} File numbers on request
SEV approval	10A/250V	

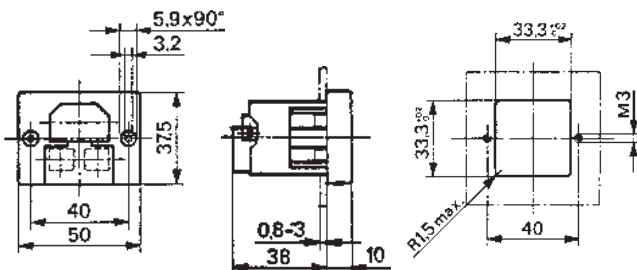

**Order Numbers (type) Note: Casing and fuseholders must be ordered separately. To order fuses, please see page 102.**

Casing			
1-pole fusing	2-pole fusing	Terminals	Mounting
8843.0351 (8843-351.60)	8843.0361 (8843-361.60)	Solder .138" X .032" (3.0 x 0.8mm)	Screw-on
8843.0353 (8843-353.60)	8843.0363 (8843-363.60)	Quick-connect .187" x .032" (4.8 x 0.8mm)	Screw-on
8843.0451 (8843-451.60)	8843.0461 (8843-461.60)	Solder .138" X .032" (3.0 x 0.8mm)	Snap-in, 0.8-3.0mm panel thickness
8843.0453 (8843-453.60)	8843.0463 (8843-463.60)	Quick-connect .187" x .032" (4.8 x 0.8mm)	Snap-in, 0.8-3.0mm panel thickness

Fuseholder inserts* (2 inserts must be ordered for 2-pole fusing)	
8843.0901	1/4 x 1 1/4" (6.3x32mm)
8843.0902	for 5 x 20mm
8843.902.60	