

4 POS

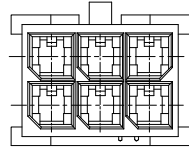

6 POS

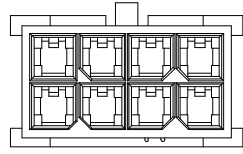

8 POS

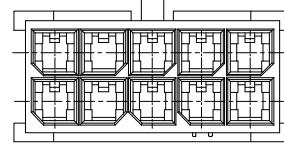

10 POS

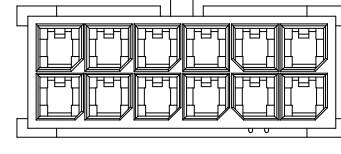

12 POS

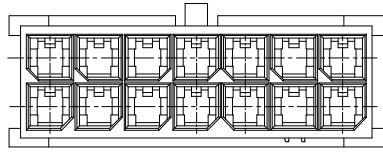

14 POS

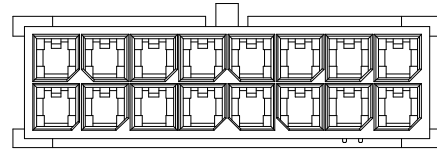

16 POS

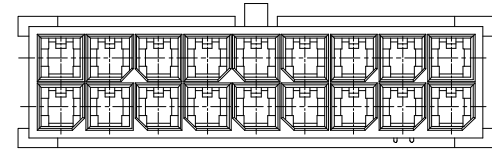

18 POS

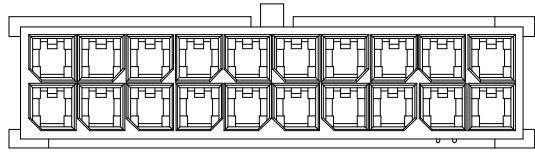

20 POS

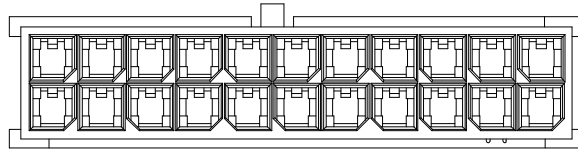

22 POS

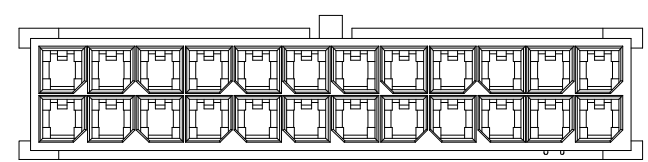

24 POS

mat'l. code		surface <input checked="" type="checkbox"/> tolerance		projection		product family	
ltr		ecn no dr date		tolerances unless otherwise specified		title	
				angles $\begin{matrix} \text{in} \\ \text{mm} \end{matrix}$ $\begin{matrix} X.X \pm 0.3 \\ X.XX \pm 0.2 \end{matrix}$		PLUG HSG, DUAL ROW, FOR 3mm PITCH WIRE CONNECTOR	
				X [*] ±2°		scale	
				dr KENNY TAI 2013-10-21		dwg no sheet 2 of 2 size	
				enr KENNY TAI 2013-10-21		10127717 A4	
				chr KENNY TAI 2013-10-21		type CUSTOMER Drawing	
				appd PM ZHENG 2013-11-06			
sheet index		revision sheet		A A			
		1 2					

