

Series 37000/38000 .375" (3/8") 9.52mm Center-to-Center Spacing

Single Row

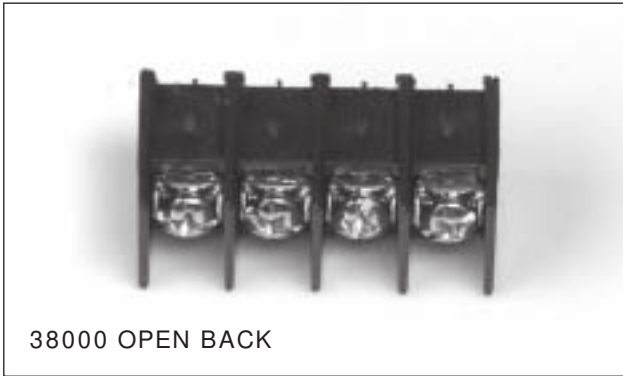

37000 TRI BARRIER



38000 OPEN BACK

Features:

- Complete line of .375" centerline terminal block styles. Terminal blocks come in surface mount, PC mount, panel mount, and feed-thru styles with a wide variety of top and bottom terminations available
- Compliant contact design virtually eliminates solder joint fractures due to pin twist
- Standoffs are molded into blocks to prevent trapping solder flux and to aid in the board cleaning process
- Broad wire range. The 37000/38000 Series terminal blocks will accommodate wire sizes up to 12AWG
- Full line of accessories complements the 37000/38000 Series terminal blocks, offering greater design flexibility
- All Curtis terminal blocks for electronic applications are made from self-extinguishing material rated 94V-0 by Underwriters Laboratories, Inc.
- Customized terminal blocks are available for special application by consulting any authorized Curtis distributor, Curtis representative, or by contacting the Curtis factory direct



Recognized under the Components Program of Underwriters Laboratories, Inc. Standard 1059, Guide No. XCFR2, File No. E62557.



Guide No. 22.2 No. 158, Report No. LR39186-1.

BARRIER STYLE

SERIES 38000 VARIATIONS

1 - Printed Circuit Pin

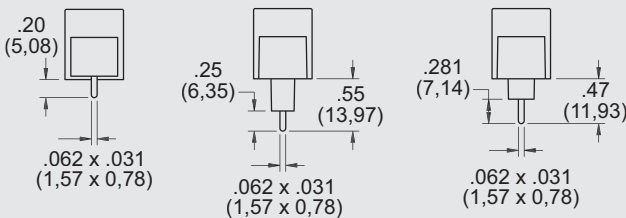

2 - Turret Type Solder Terminal

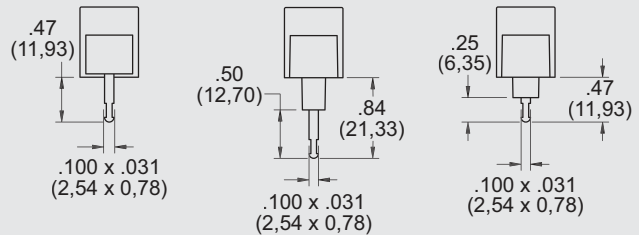

3 - .110" Quick Connect

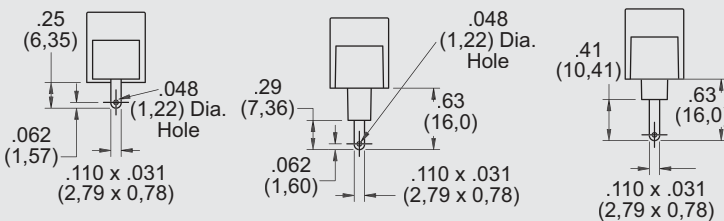

4 - .187" Quick Connect

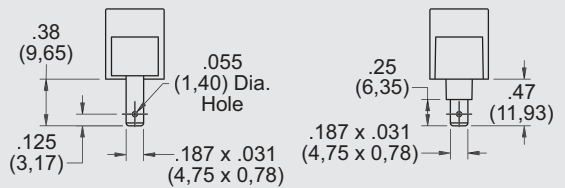

5 - .250" Quick Connect

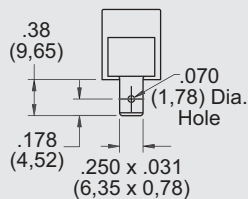

6 - Wire Wrap/Printed Circuit Pin

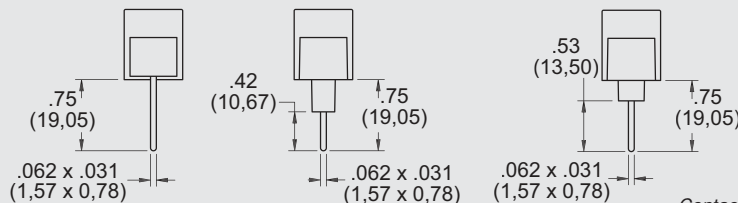

7 - Wire Wrap/Right Angle Printed Circuit Pin

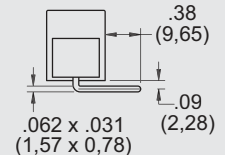

NOTE: Standard bend shown. Contact factory for other bend dimensions.

Specifications:

Center-to-Center Spacing: .375"
(9.52mm)

Wire Range: No. 22AWG to No. 12AWG

No. of Terminals: 1 thru 26 (28 positions on surface mount without mounting ends)

Voltage Rating: 300V

Tightening Torque:

Wire Binding Screw 9 in.-lb.
Wire Clamp 9 in.-lb.

Current Rating: 20 amps

Housing:

Material Polypropylene
Continuous Use
Temp. (UL Index) 105°C
Flammability Rating 94V-0
Water Absorption
(24 hrs. % wt. gain) .03%
Chemical Resistance Excellent

Breakdown Voltage:

Terminal - Ground 3,000V Typ.
4,700 Typ.

Terminals: Brass, Tin-plated

| Series 37000 and 38000 With Mounting Ends | | | | | | | Without Mounting Ends | |
|--|------------------------------------|-------------|-------------------------------------|-------------|-----------------------------|-------------|-----------------------------|-------------|
| Number of Terminals | Dimensions | | | | | | | |
| | A ± .031 Overall Dimensions (O.D.) | | B ± .031 Mounting Dimensions (M.D.) | | C ± .031 Less Mounting Ends | | A ± .031 Less Mounting Ends | |
| | Inches | Metric (mm) | Inches | Metric (mm) | Inches | Metric (mm) | Inches | Metric (mm) |
| 1 | 1.200 | 30.48 | .750 | 19.05 | .450 | 11.43 | — | — |
| 2 | 1.575 | 40.01 | 1.125 | 28.58 | .825 | 20.96 | .825 | 20.96 |
| 3 | 1.950 | 49.53 | 1.500 | 38.1 | 1.200 | 30.48 | 1.200 | 30.48 |
| 4 | 2.325 | 59.06 | 1.875 | 47.63 | 1.575 | 40.01 | 1.575 | 40.01 |
| 5 | 2.700 | 68.58 | 2.250 | 57.15 | 1.950 | 49.53 | 1.950 | 49.53 |
| 6 | 3.075 | 78.11 | 2.625 | 66.68 | 2.325 | 59.06 | 2.325 | 59.06 |
| 7 | 3.450 | 87.63 | 3.000 | 76.2 | 2.700 | 68.58 | 2.700 | 68.58 |
| 8 | 3.825 | 97.16 | 3.375 | 85.73 | 3.075 | 78.11 | 3.075 | 78.11 |
| 9 | 4.200 | 106.68 | 3.750 | 95.25 | 3.450 | 87.63 | 3.450 | 87.63 |
| 10 | 4.575 | 116.21 | 4.125 | 104.78 | 3.825 | 97.16 | 3.825 | 97.16 |
| 11 | 4.950 | 125.73 | 4.500 | 114.3 | 4.200 | 106.68 | 4.200 | 106.68 |
| 12 | 5.325 | 135.26 | 4.875 | 123.83 | 4.575 | 116.21 | 4.575 | 116.21 |
| 13 | 5.700 | 144.78 | 5.250 | 133.35 | 4.950 | 125.73 | 4.950 | 125.73 |
| 14 | 6.075 | 154.31 | 5.625 | 142.88 | 5.325 | 135.26 | 5.325 | 135.26 |
| 15 | 6.450 | 163.83 | 6.000 | 152.4 | 5.700 | 144.78 | 5.700 | 144.78 |
| 16 | 6.825 | 173.36 | 6.375 | 161.93 | 6.075 | 154.30 | 6.075 | 154.31 |
| 17 | 7.200 | 182.88 | 6.750 | 171.45 | 6.450 | 163.83 | 6.450 | 163.83 |
| 18 | 7.575 | 192.41 | 7.125 | 180.98 | 6.825 | 173.36 | 6.825 | 173.36 |
| 19 | 7.950 | 201.93 | 7.500 | 190.5 | 7.200 | 182.88 | 7.200 | 182.88 |
| 20 | 8.325 | 211.48 | 7.875 | 200.03 | 7.575 | 192.40 | 7.575 | 192.41 |
| 21 | 8.700 | 220.98 | 8.250 | 209.55 | 7.950 | 201.93 | 7.950 | 201.93 |
| 22 | 9.075 | 230.51 | 8.625 | 219.08 | 8.325 | 211.46 | 8.325 | 211.46 |
| 23 | 9.450 | 240.03 | 9.000 | 228.6 | 8.700 | 220.98 | 8.700 | 220.98 |
| 24 | 9.825 | 249.56 | 9.375 | 238.13 | 9.075 | 230.50 | 9.075 | 230.51 |
| 25 | 10.200 | 259.08 | 9.750 | 247.65 | 9.450 | 240.03 | 9.450 | 240.03 |
| 26 | 10.575 | 268.61 | 10.125 | 257.18 | 9.825 | 249.56 | 9.825 | 249.56 |

Dimensions shown are ± 0.030"

SERIES 37000 VARIATIONS

1 – Printed Circuit Pin

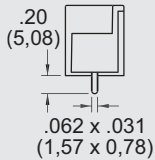

2 – Turret Type Solder Terminal

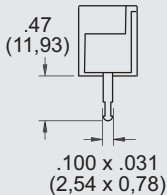

3 – .110" Quick Connect

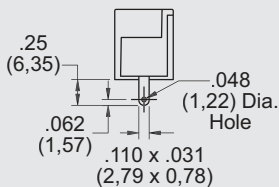

4 – .187" Quick Connect

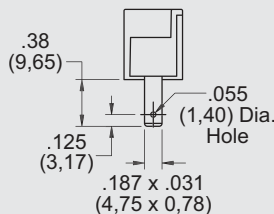

5 – .250" Quick Connect

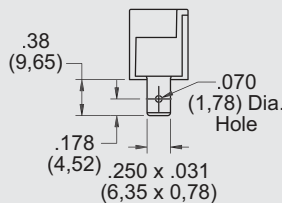

6 – Wire Wrap/Printed Circuit Pin

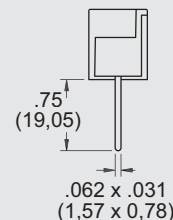

7 – Wire Wrap/Right Angle Printed Circuit Pin

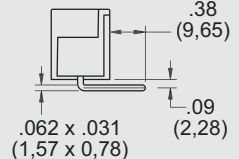

Dimensions are in inches and millimeters unless otherwise specified. Values in parentheses are metric equivalents.

Series 37000/38000

Series 37000 Surface Mount with Mounting Ends

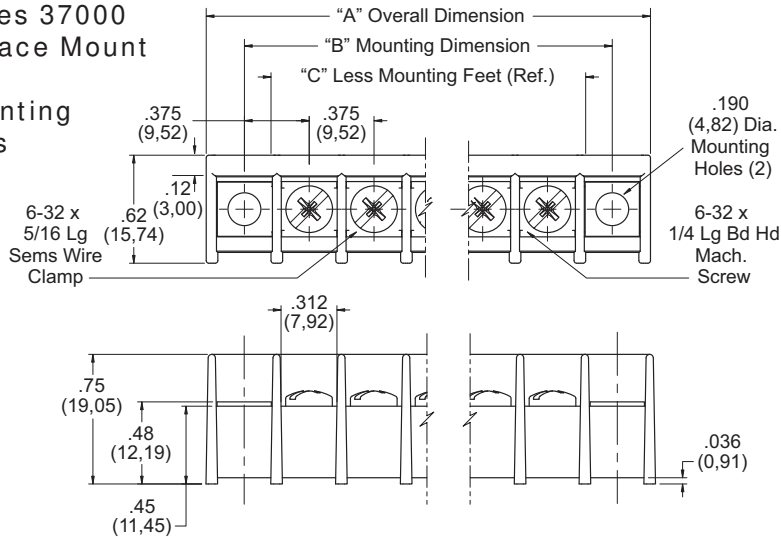

Series 37000 Surface Mount without Mounting Ends

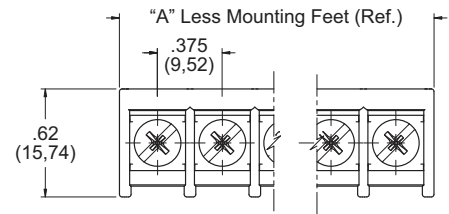

How to Order T37 X X X XX X

MOLDING DESIGN]

- 0 = Surface Mount w/ Mounting Ends
- 1 = Surface Mount w/o Mounting Ends

INSERT OR BOTTOM

TERMINATION DESIGN]

- 0 = Surface Mount, No Bottom Termination
- 1 = Printed Circuit Pin
- 2 = Turret Type Solder Terminal
- 3 = Quick Connect .110"
- 4 = Quick Connect .187"
- 5 = Quick Connect .250"
- 6 = Wire Wrap Pin
- 7 = Right Angle Printed Circuit

[SPECIALS OR OPTIONAL DESIGNS

- 0 = None
- A-Z = Custom Configuration

[NUMBER OF POSITIONS

- 1 thru 26, Available in One to Twenty-Six Positions (28 Surface Mounts without Mounting Ends)

[HARDWARE OR TOP TERMINATION DESIGN

- 0 = Nickel Plated Steel Screw, Standard
- 1 = Wire Clamp Screws
- 2 = Nickel Plated Brass Screws
- 3 = Stainless Steel Screws
- 5 = Without Screws
- 6 = Quick Connects, Screw Type*
- 8 = Captivated Screw

PC BOARD DRILLING DIMENSIONS

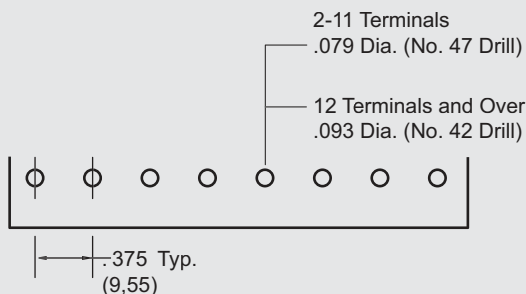

RECOMMENDED PANEL CUTOUT DIMENSIONS

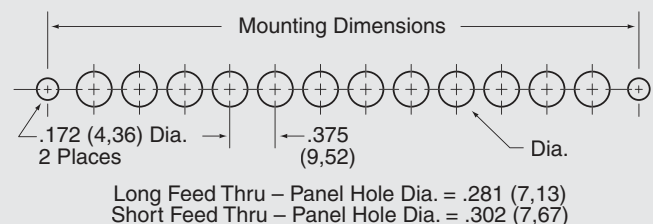

Single Row

BARRIER STYLE

Series 38000 Surface Mount without Mounting Ends

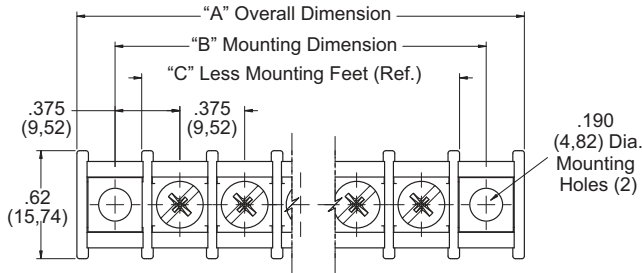

Series 38000 Short Feed-Thru

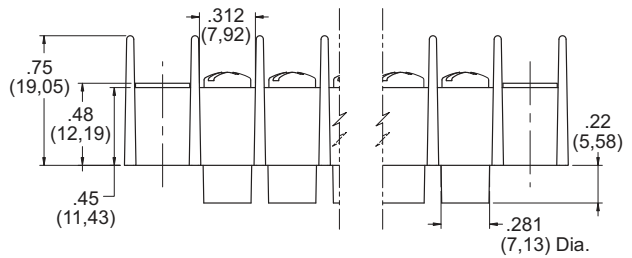

Series 38000 Base Mount

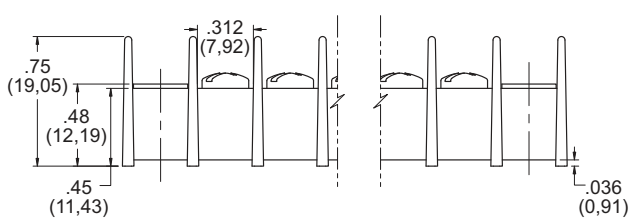

Series 38000 Long Feed-Thru

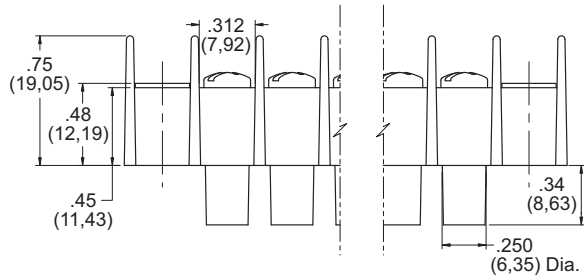

How to Order T38 X X X XX X

MOLDING DESIGN

- 0 = Surface Mount w/ Mounting Ends
- 1 = Surface Mount w/o Mounting Ends
- 2 = Insulated Feed Thru .250 Diameter w/ Mounting Ends
- 3 = Insulated Feed Thru .250 Diameter w/o Mounting Ends
- 4 = Insulated Feed Thru .281 Diameter w/ Mounting Ends
- 5 = Insulated Feed Thru .281 Diameter w/o Mounting Ends

INSERT OR BOTTOM TERMINATION DESIGN

- 0 = Surface Mount, No Bottom Termination
- 1 = Printed Circuit Pin
- 2 = Turret Type Solder Terminal
- 3 = Quick Connect .110"
- 4 = Quick Connect .187"
- 5 = Quick Connect .250"
- 6 = Wire Wrap Pin
- 7 = Right Angle Printed Circuit

SPECIALS OR OPTIONAL DESIGNS

- 0 = None
- A-Z = Custom Configuration

NUMBER OF POSITIONS

1 thru 26, Available in One to Twenty-Six Positions (28 Surface Mounts without Mounting Ends)

HARDWARE OR TOP TERMINATION DESIGN

- 0 = Nickel Plated Steel Screw, Standard
- 1 = Wire Clamp Screws
- 2 = Nickel Plated Brass Screws
- 3 = Stainless Steel Screws
- 5 = Without Screws
- 6 = Quick Connects, Screw Type*
- 8 = Captivated Screw

RECOMMENDED PANEL CUTOUT DIMENSIONS

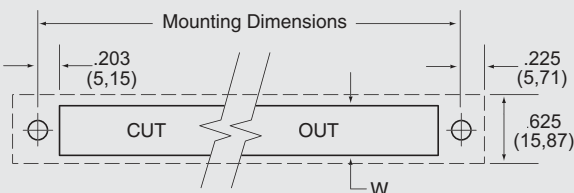

SURFACE MOUNT STYLES

- .187 (4,75) Tab W = .45 (11,34)
- .250 (6,35) Tab
- .110 (2,79) QC Wire Wrap Solder Tab W = .38 (9,65)

Series 37000/38000

Series 37000 Accessories

QUICK-CONNECT TERMINALS .020 X .187

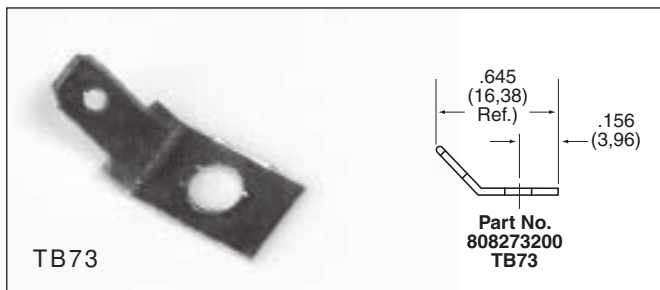
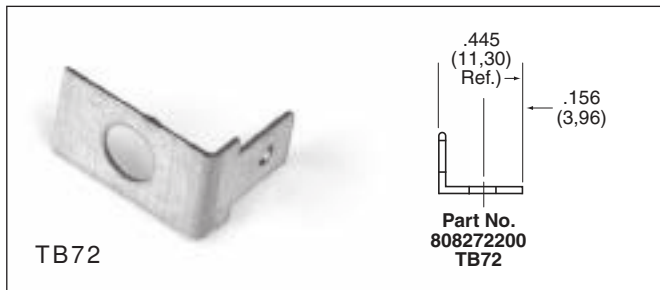
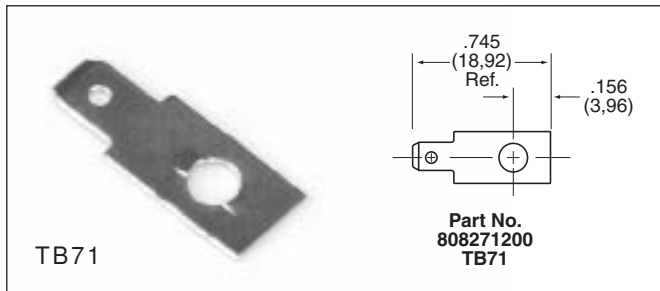

Single Row

BARRIER STYLE

Series 37000/38000 Accessories

TERMINAL BLOCK JUMPERS

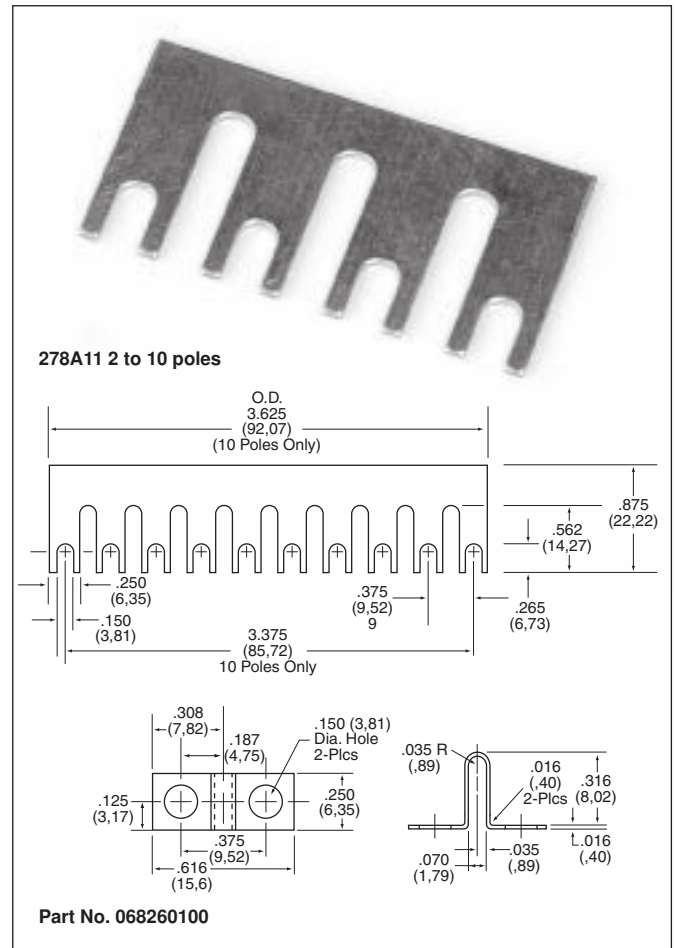

MARKING STRIPS

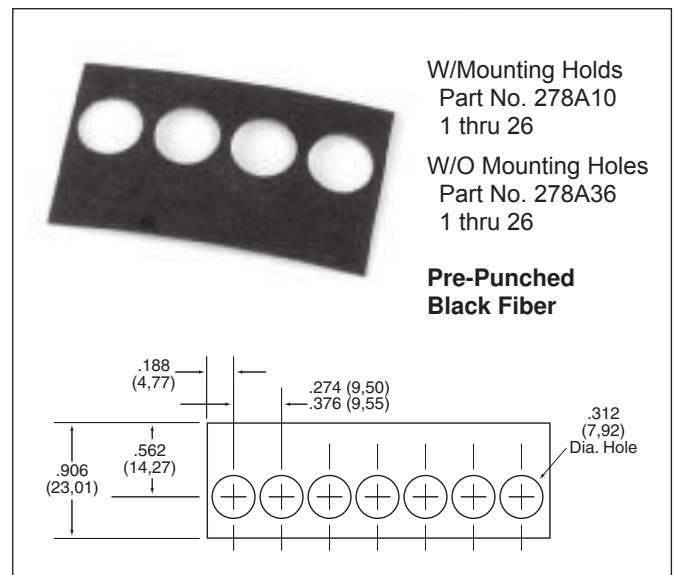

Series 38000 Accessories

QUICK-CONNECT TERMINALS .020 x .187"

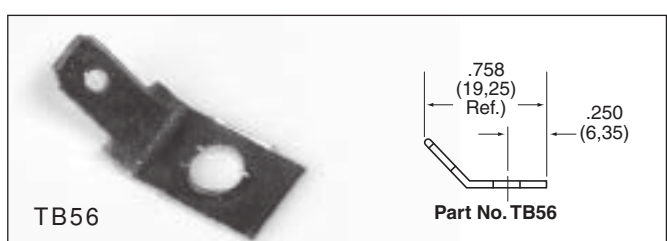
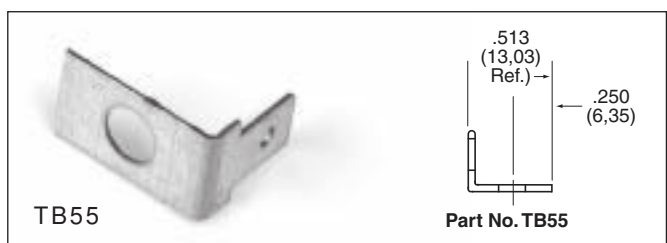
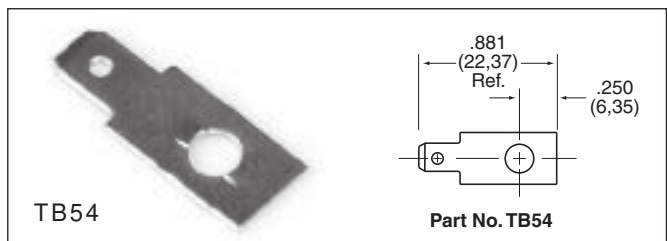
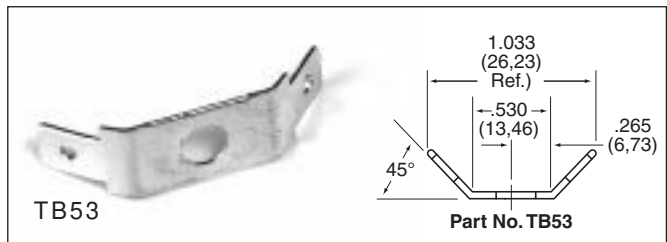
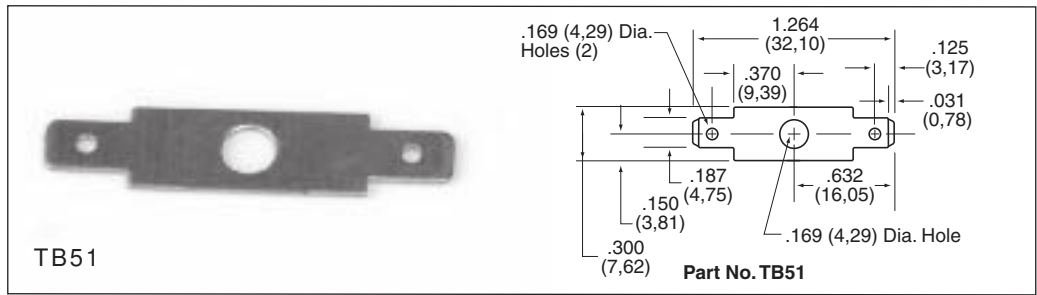

TINNERMAN NUTS

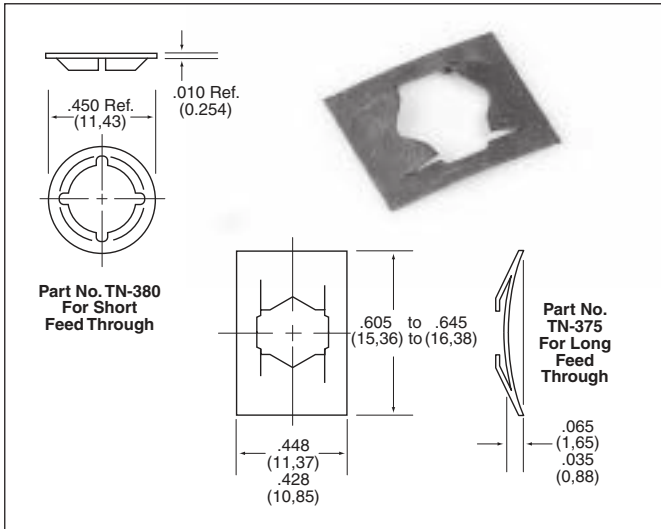

COVERS

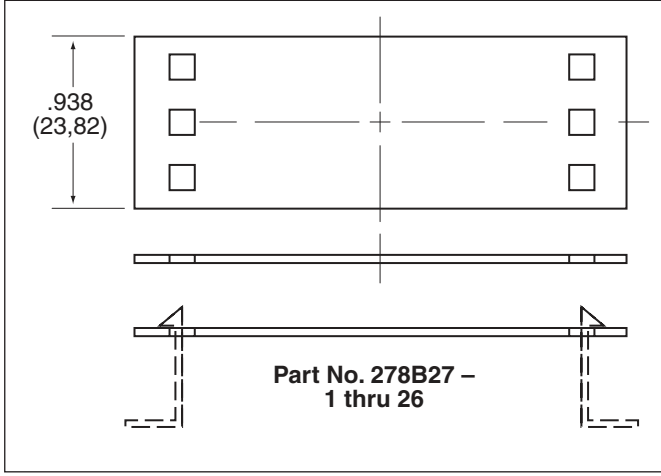

Single Row
BARRIER STYLE

Dimensions are in inches and millimeters unless otherwise specified. Values in parentheses are metric equivalents.