

L2.5 x W2.5 x H0.9 mm



RoHS compliant



Pb-free soldering compatible

Features

- ▣ Middle Power type 0.5 watt
- ▣ Special color LED in which object is shown to more attractive
- ▣ Double potting lens structure.
- ▣ Low thermal resistance

Dimension

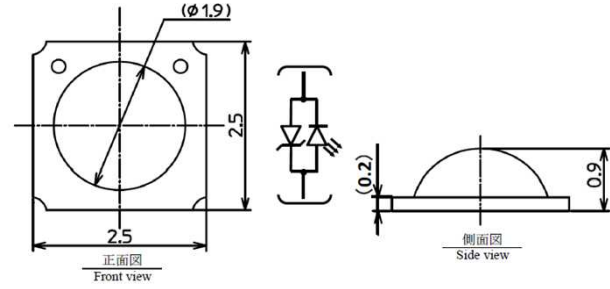

Basic Specifications (Ta=25deg)

Part Name	Color	CT	Luminous Flux		VF	Forward Current Max
			IF			
VTEW 1151ASE-57Y-TR	White	5700K	85	150mA	3.3V	170mA
VTEW 1151ASE-50Y-TR	White	5000K	85	150mA	3.3V	170mA
VTEW 1151ASE-30Y-TR	White	3000K	85	150mA	3.3V	170mA
GTEW 1151ASE-27Y-TR	Light bulb color	2700K	85	80mA	3.1V	170mA
GTEW 1151ASE-20Y-TR	Candle color	2000K	85	80mA	3.1V	170mA
GTEW 1151ASE-16-TR	Special color (fresh meat)	4600K	-	80mA	3.1V	170mA

Spatial Distribution

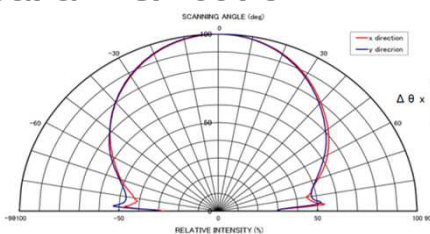

Wide Angle
x = 145deg,
x = 155deg.

Recommended Soldering Pattern

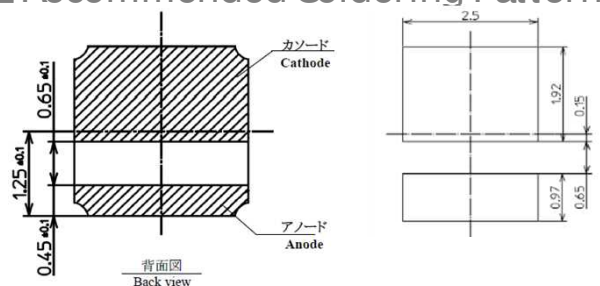

Double potting lens structure

- ▣ It has heat stress resisting and sulfide gas resisting from outside.
- ▣ Color shift does not happen by silicon filing.

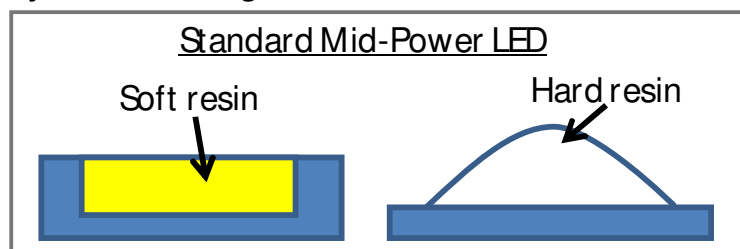
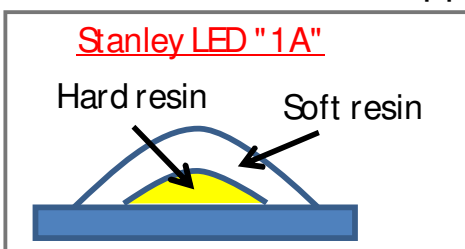

*Performance and specification may revised without prior notice, in accordance to meet the engineering development. It is recommended to confirm the most updated specification before designing. Updated Feb 2016



Ultra low Color temperature (2000K)

0.5 watt Class LED

TEW1151ASE-□□□-□□-TR

Low Color Temp. LED

Part Name	Color	CT	Luminous Flux		VF	Forward Current Max
			lm	IF		
GTEW1151ASE-20Y-TR	Candle color	2000K	85	80mA	3.1V	170mA

➤ Application

- Street lamp like Sodium-vapor lamp,
- Chandelier lamp
- Traditional or majestic festival illuminations
- Lighting in casino, hotel, and restaurant etc.

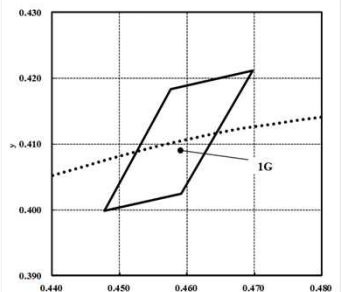
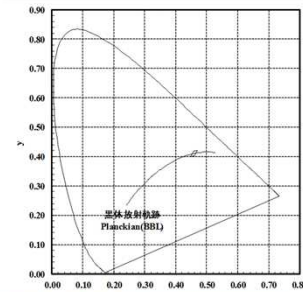

Chichibu Saitama Japan

Special Color LED

Part Name	Color	VF	Luminous Flux		Forward Current Max	Usage
			lm	IF		
GTEW1151ASE-16-TR	Special color (White)	3.1V	85	80mA	170mA	Fresh Meat

Special spectral characteristic which is enhanced freshness of objects. Decrease a yellow color element and increase a red color element.

➤ Application

- Lighting for Fresh meat and Fresh fish (Frozen refrigeration showcase)
- Lighting for 'Sushi neta case'. (Material case)

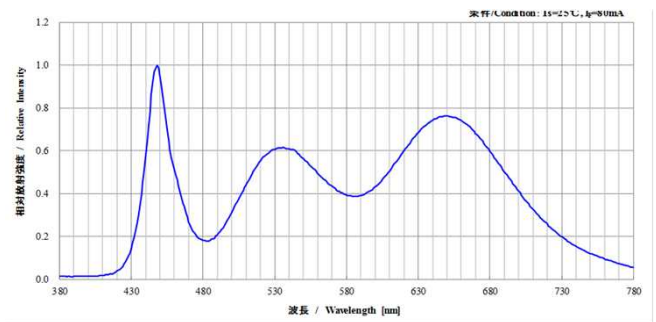

Fresh!



Fresh!

*Performance and specification may revised without prior notice, in accordance to meet the engineering development. It is recommended to confirm the most updated specification before designing.

Updated Feb 2016



URL <http://stanley-components.com/en>

U.S.A. :+1-949-222-0777
 Thailand :+66-2-599-1260 EXT187
 China Shanghai :+86-21-5298-9431

UK :+44-1344-393-536
 Singapore :+65-6734-2683
 Shenzhen :+86-755-8606-9122

Germany :+49-6105-930530
 Hong Kong :+852-2730-1738
 Taiwan :+886-2-2567-7886

France :+33-1-47-81-85-85
 Japan :+81-45-910-2848