

THIS DRAWING IS UNPUBLISHED. RELEASED FOR PUBLICATION
 © COPYRIGHT - By - ALL RIGHTS RESERVED.

LOC		DIST		REVISIONS			
P	LTR	DESCRIPTION		DATE	DWN	APVD	
AA	22	A1	REVISED PER ECO-11-005033		29MAR11	RK	HMR

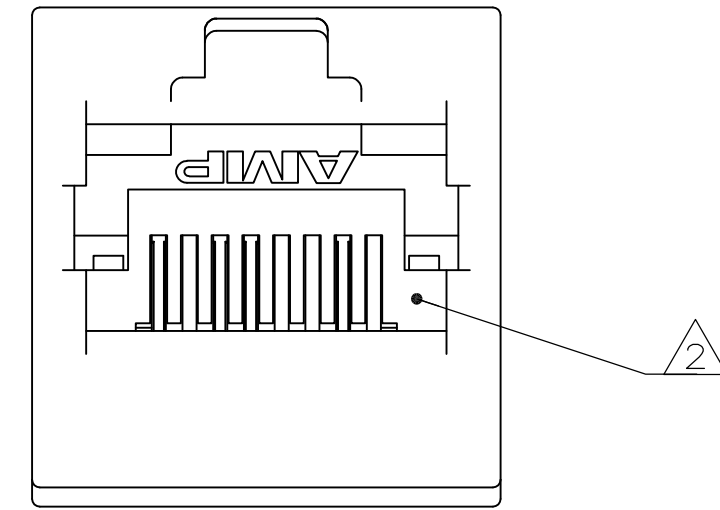

- 1 MATERIAL: HOUSING - POLYESTER MOLDING COMPOUND, BLACK, UL 94V-0.
TERMINALS - 0.33[.013] THICK PHOS BRONZE PLATED WITH 1.27µm[.000050] MINIMUM THICK HARD GOLD IN LOCALIZED AREA AND 3.81µm[.000150] MINIMUM THICK MATTE TIN IN SOLDER AREA OVER 1.27µm[.000050] MINIMUM THICK NICKEL UNDERPLATE.
TERMINAL INSERT PLASTIC: POLYESTER MOLDING COMPOUND, GRAY, UL 94V-0.
- 2 JACK CAVITY CONFORMS TO FCC RULES AND REGULATIONS, PART 68 SUBPART F.
- 3. ALL DIMENSIONS SHOWN ARE NOMINAL UNLESS OTHERWISE SPECIFIED.
- 4 CAUTION: CATEGORY 5 JACK SOLDER TAIL POSITIONS DO NOT FOLLOW SAME NUMBER SEQUENCE AS THAT OF TRADITIONAL JACKS.

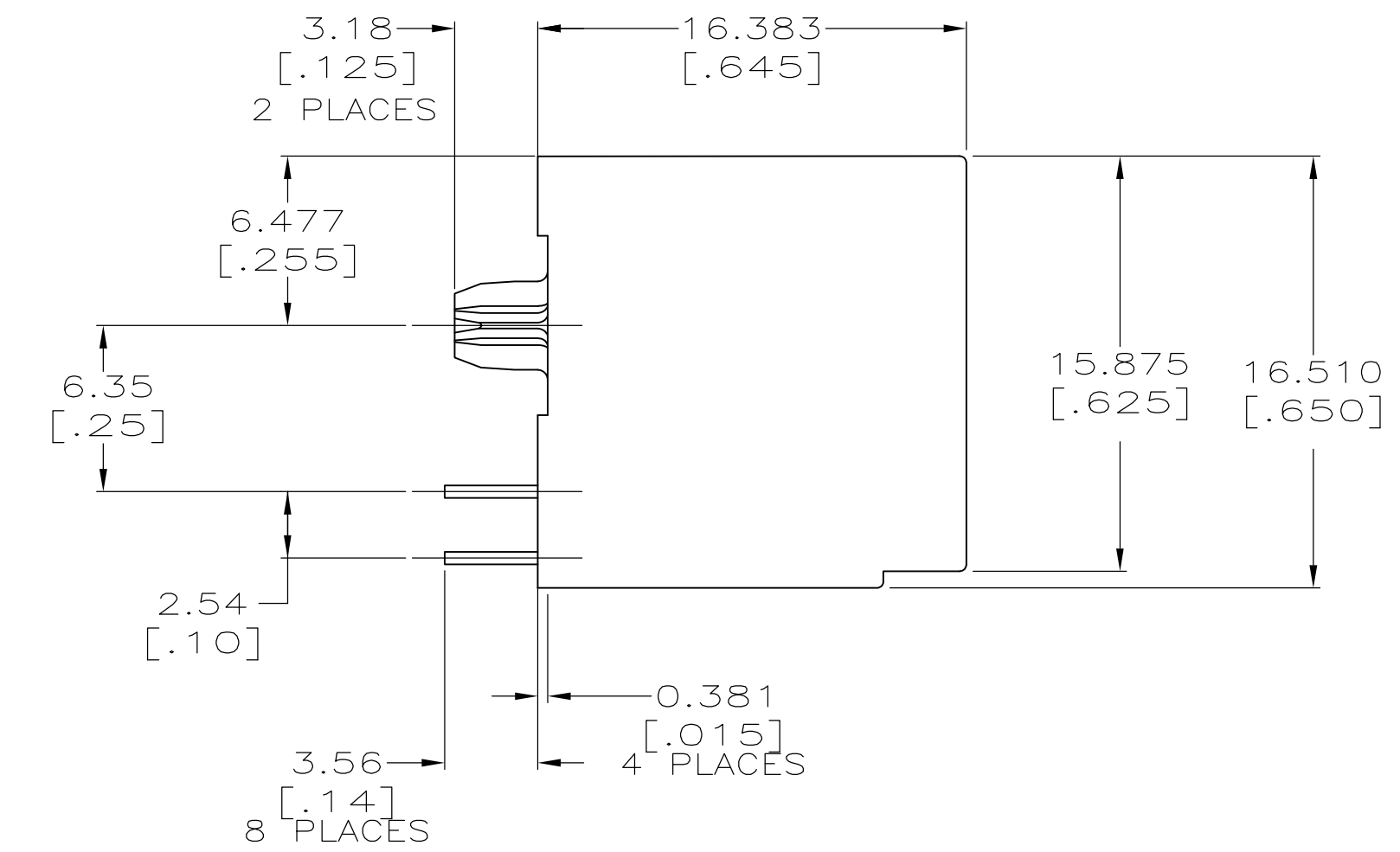
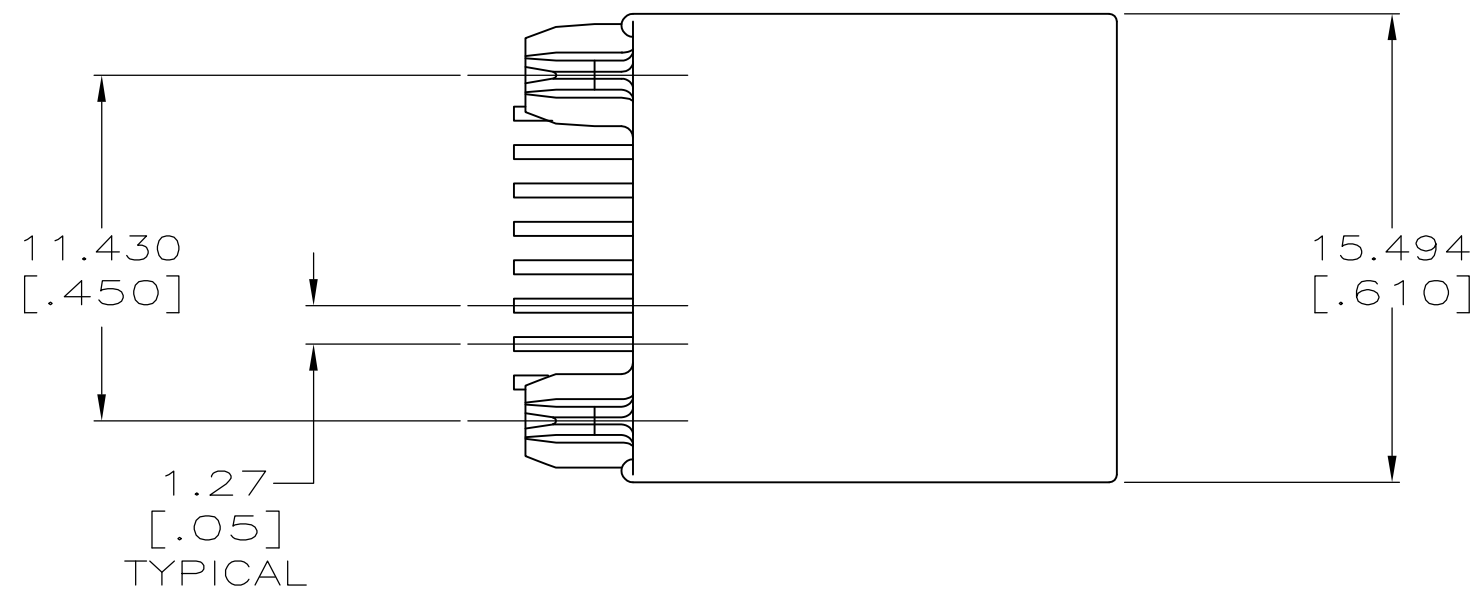
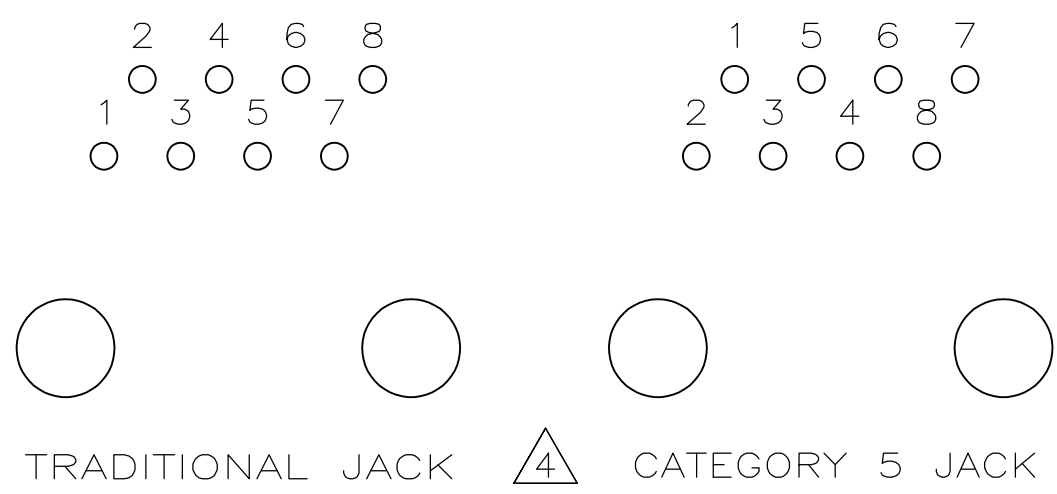
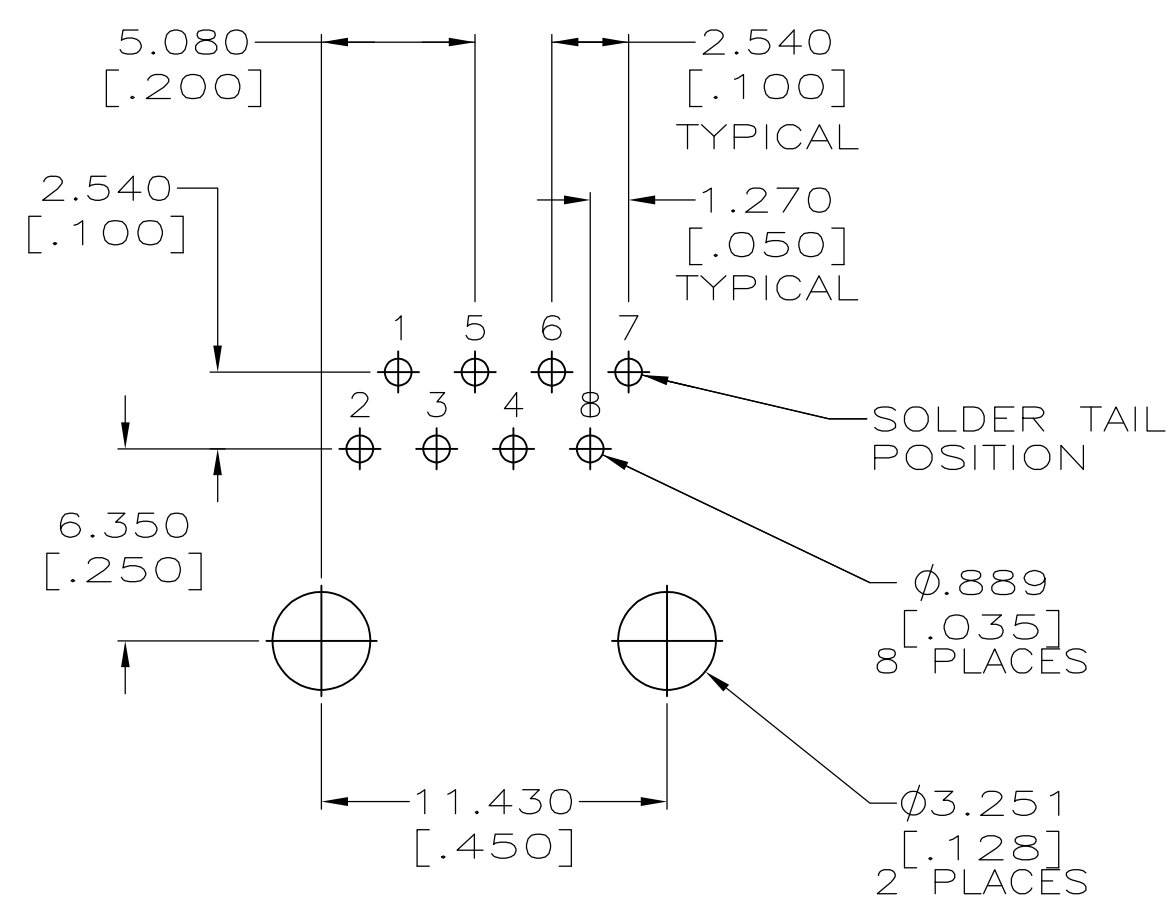

5558397-1
PART NO.

THIS DRAWING IS A CONTROLLED DOCUMENT.		DWN	R.GRZYBOWSKI	09NOV05	STE TE Connectivity		
DIMENSIONS: mm		CHK	J.WESTMAN	09NOV05			
TOLERANCES UNLESS OTHERWISE SPECIFIED:		APVD	S.FLICKINGER	09NOV05	NAME		
0 PLC	± -	PRODUCT SPEC		108-1163			
1 PLC	± -	APPLICATION SPEC		114-2048			
2 PLC	± 0.25[.01]	WEIGHT		A2 00779 C=5558397			
3 PLC	± 0.127[.005]	CUSTOMER DRAWING		SCALE 4:1 SHEET 1 OF 1 REV A1			
4 PLC	± -	FINISH		1			
ANGLES	± -	MATERIAL		1			

SUGGESTED PC BOARD LAYOUT
COMPONENT SIDE