

4

3

2

1

THIS DRAWING IS UNPUBLISHED. RELEASED FOR PUBLICATION  
 © COPYRIGHT - TE Connectivity ALL RIGHTS RESERVED.

| P | LTR | DESCRIPTION                | DATE      | DWN | APVD |
|---|-----|----------------------------|-----------|-----|------|
|   | A   | RELEASED PER ECR 09-017675 | 11AUG09   | JR  | RL   |
|   | A1  | REVISED PER ECO-17-004099  | 24AUG2017 | BDA | DR   |

|                              |                           |
|------------------------------|---------------------------|
| <b>AMP</b><br>WIRE RANGE     | E13288<br>Listed          |
| 3/0 AWG<br>SOLID OR STRANDED | NOT<br>APPLICABLE         |
| LR7189<br>Certified          | MILITARY P/N<br>AND CLASS |
| NOT<br>APPLICABLE            | NOT<br>APPLICABLE         |

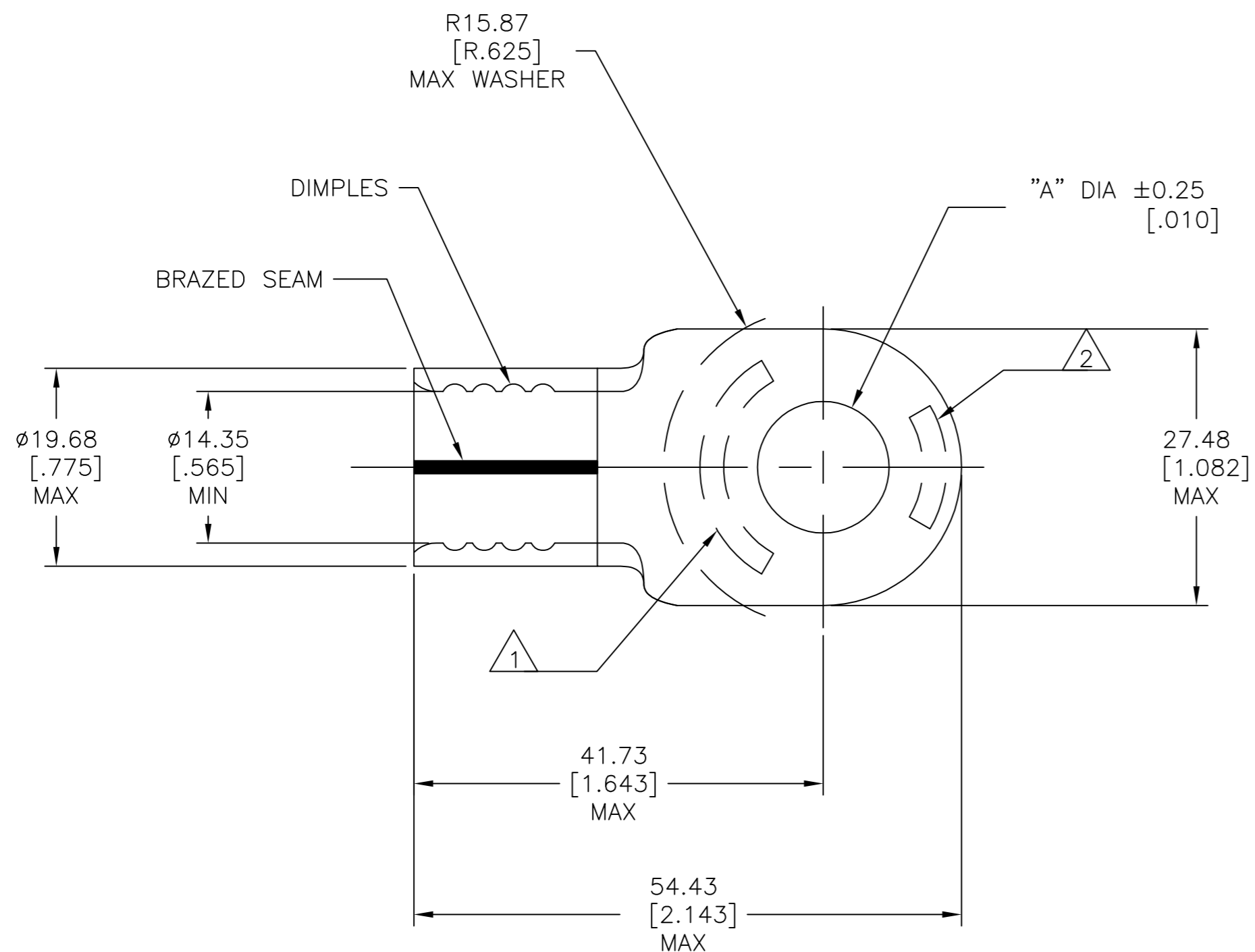

- STAMP AMP 3/0W\* APPROX AS SHOWN
- STAMP 150 APPROX AS SHOWN
- TONGUE MATERIAL THK: 2.31±0.08[.091±.003]
- PREPRODUCTION - FASR REQUIRED

|                                                                                  |                                              |                                                                                   |
|----------------------------------------------------------------------------------|----------------------------------------------|-----------------------------------------------------------------------------------|
| CUSTOMER SERVICE SYSTEMS                                                         |                                              | MAX RECOMMENDED OPERATING TEMPERATURE:<br>170°[338°F] C MAX                       |
| FOR ADDITIONAL PRODUCT INFORMATION OR COPIES OF DRAWINGS AND TECHNICAL DOCUMENTS | PRODUCT INFORMATION CENTER<br>1-800-522-6752 | VOLTAGE RATING:<br>NOT APPLICABLE                                                 |
| FOR APPLICATION TOOLING INFORMATION                                              | TOOLING ASSISTANCE CENTER<br>1-800-722-1111  | CIRCULAR MIL AREA:<br>76.3-96.3mm²[150,000-190,000] CIR MILS<br>SOLID OR STRANDED |
| FOR ORDER ENTRY                                                                  | 1-800-526-5142                               |                                                                                   |

|                                                                                                                                |  |                                                                 |                                                          |                    |                         |                    |
|--------------------------------------------------------------------------------------------------------------------------------|--|-----------------------------------------------------------------|----------------------------------------------------------|--------------------|-------------------------|--------------------|
| THIS DRAWING IS A CONTROLLED DOCUMENT.                                                                                         |  | DWN<br>RAGHAVENDRA 02JUL09                                      | 50                                                       | LOOSE PIECE        | 10.75 [.423]            | 1958311-1          |
| DIMENSIONS:<br>mm [INCHES]                                                                                                     |  | CHK<br>R LONDON 02JUL09                                         | QTY.                                                     | PACKAGE TYPE       | "A"                     | PART NUMBER        |
| TOLERANCES UNLESS OTHERWISE SPECIFIED:<br>0 PLC ± -<br>1 PLC ± -<br>2 PLC ± 0.20[.008]<br>3 PLC ± -<br>4 PLC ± -<br>ANGLES ± - |  | APVD<br>R LONDON 02JUL09                                        | TE Connectivity<br>TERMINAL, RING TONGUE,<br>SOLISTRAND™ |                    |                         |                    |
| MATERIAL<br>COPPER ASTM B-152<br>ANNEALED                                                                                      |  | FINISH<br>TIN PLATE<br>0.00254[.000100] MIN<br>THK PER ASTM-545 | SIZE<br>A2                                               | CAGE CODE<br>00779 | DRAWING NO<br>C=1958311 | RESTRICTED TO<br>- |
| CUSTOMER DRAWING                                                                                                               |  |                                                                 | SCALE<br>2:1                                             | SHEET<br>1 of 1    | REV<br>A1               |                    |