

| P | LTR | DESCRIPTION | DATE | DWN | APVD |
|-----|-----|---------------|------------|-----|------|
| BA3 | | ECR-19-001041 | 24 JAN2019 | SR | AP |
| BA4 | | ECR-19-006706 | 30 APR2019 | SR | AP |
| BA5 | | ECR-20-012788 | 14 SEP2020 | SB | AP |
| BA6 | | ECR-23-174135 | 04 MAY2023 | DM | AP |

FOR FURTHER INFORMATION SEE DATA SHEET FOR TLR SERIES-SMD HIGH POWER CURRENT SENSE RESISTORS

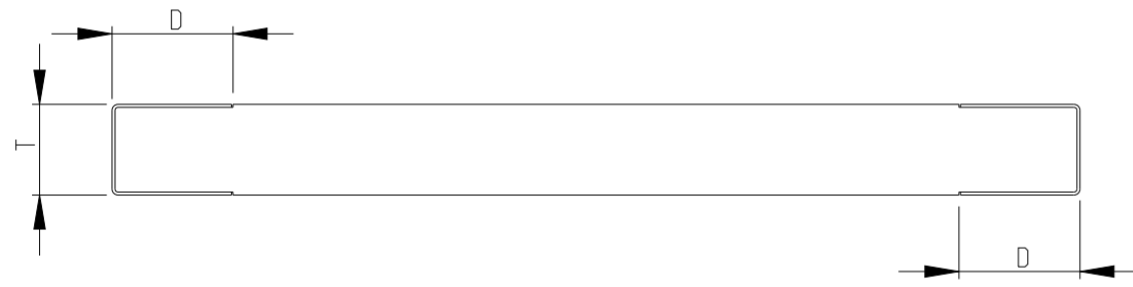
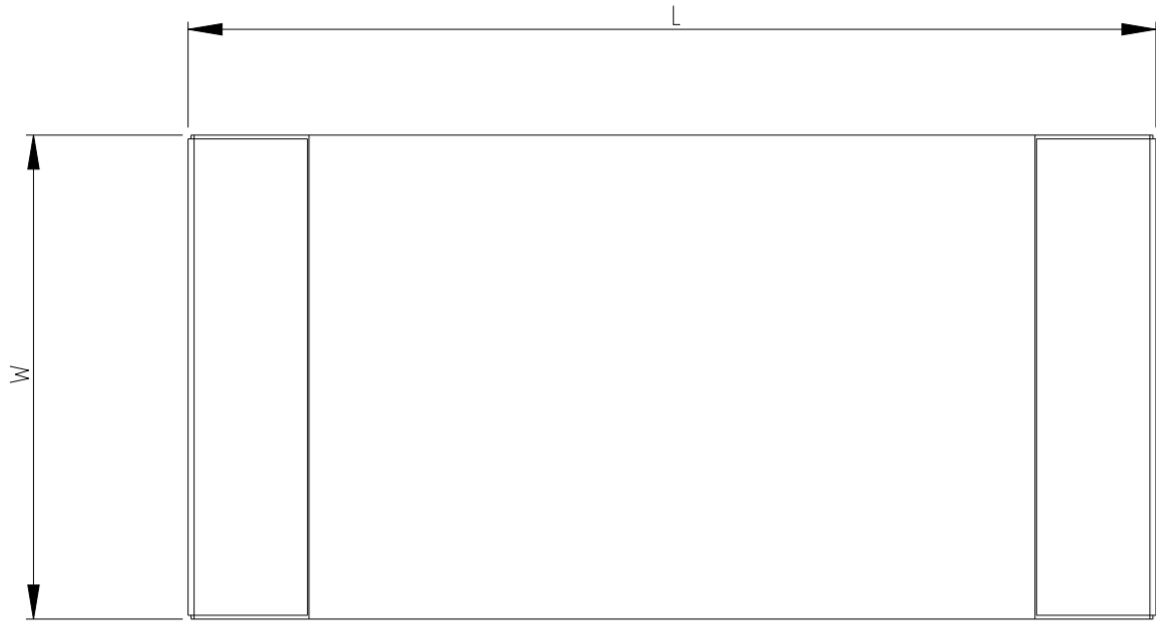

RoHS Compliant

| Complete TIN | Product Number | Part Description | Resistance mΩ | L | W | T | D | Weight / 1000pcs (g) |
|---------------------------|----------------|---------------------|--|------|-------------|-------------|------------|----------------------|
| SUPERSEDED BY 2176417-3 | 1879378-1 | TLR3A10DR01FTDG | TLR 2512 1.0W R01 1% 100PPM 2K RL | | | | | |
| | 1879378-2 | TLR3A30DR001FTDG | TLR 2512 3.0W R001 1% 50PPM 2K RL | 1 | 6.35 ±0.254 | 3.18 ±0.254 | 0.65 ±0.20 | 1.30 ±0.38 |
| | 1879378-3 | TLR3A30ER0005FTDG | TLR 2512 3.0W R0005 1% 50PPM 2K RL | 0.5 | 6.35 ±0.254 | 3.18 ±0.254 | 1.25 ±0.20 | 1.30 ±0.38 |
| OBSOLETE | 1879378-4 | TLR3A10DR022FTDG | TLR3A 1.0W R022 1% 2K RL | | | | | |
| OBSOLETE | 1879378-5 | TLR3A10DR008FTDG | TLR3A 1.0W R008 1% 2K RL | | | | | |
| OBSOLETE | 1879378-6 | TLR3A10DR018FTDG | TLR3A 1.0W R018 1% 2K RL | | | | | |
| | 1879378-7 | TLR3A20DR0005FTDG | TLR 2512 2.0W R0005 1% 50PPM 2K RL | 0.5 | 6.35 ±0.254 | 3.18 ±0.254 | 1.25 ±0.20 | 1.30 ±0.38 |
| | 1879378-8 | TLR3A20DR00075FTDG | TLR 2512 2.0W R00075 1% 50PPM 2K RL | 0.75 | 6.35 ±0.254 | 3.18 ±0.254 | 0.75 ±0.20 | 1.30 ±0.38 |
| | 1879378-9 | TLR3A20DR001FTDG | TLR 2512 2.0W R001 1% 50PPM 2K RL | 1 | 6.35 ±0.254 | 3.18 ±0.254 | 0.65 ±0.20 | 1.30 ±0.38 |
| | 1-1879378-0 | TLR3A20DR0015FTDG | TLR 2512 2.0W R0015 1% 50PPM 2K RL | 1.5 | 6.35 ±0.254 | 3.18 ±0.254 | 0.45 ±0.20 | 1.30 ±0.38 |
| | 1-1879378-1 | TLR3A20DR002FTDG | TLR 2512 2.0W R002 1% 50PPM 2K RL | 2 | 6.35 ±0.254 | 3.18 ±0.254 | 0.35 ±0.20 | 1.30 ±0.38 |
| | 1-1879378-2 | TLR3A20KR003FTDG | TLR 2512 2.0W R003 1% 150PPM 2K RL | 3 | 6.35 ±0.254 | 3.18 ±0.254 | 0.55 ±0.20 | 1.30 ±0.38 |
| SUPERSEDED BY 2176421-7 | 1-1879378-3 | TLR3A20ER004FTDG | TLR 2512 2.0W R004 1% 100PPM 2K RL | | | | | |
| OBSOLETE | 1-1879378-4 | TLR3A20DR0045FTDG | TLR3A 2.5W R0045 1% 2K RL | | | | | |
| SUPERSEDED BY 2176421-4 | 1-1879378-5 | TLR3A20DR005FTDG | TLR 2512 2.0W R005 1% 75PPM 4K RL | | | | | |
| SUPERSEDED BY 4-1879378-2 | 1-1879378-6 | TLR3A20DR006FTDG | TLR 2512 2.0W R006 1% 75PPM 4K RL | | | | | |
| SUPERSEDED BY 5-1879378-0 | 1-1879378-7 | TLR3A20DR0065FTDG | TLR 2512 2.0W R0065 1% 50PPM 2K RL | | | | | |
| SUPERSEDED BY 4-1879378-3 | 1-1879378-8 | TLR3A20DR007FTDG | TLR 2512 2.0W R007 1% 75PPM 4K RL | | | | | |
| SUPERSEDED BY 2176421-5 | 1-1879378-9 | TLR3A20DR008FTDG | TLR 2512 2.0W R008 1% 75PPM 4K RL | | | | | |
| SUPERSEDED BY 2176421-6 | 2-1879378-0 | TLR3A20DR009FTDG | TLR 2512 2.0W R009 1% 75PPM 4K RL | | | | | |
| SUPERSEDED BY 2176421-1 | 2-1879378-1 | TLR3A20DR01FTDG | TLR 2512 2.0W R01 1% 75PPM 4K RL | | | | | |
| | 2-1879378-2 | TLR3A30DR00075FTDG | TLR 2512 3.0W R00075 1% 50PPM 2K RL | 0.75 | 6.35 ±0.254 | 3.18 ±0.254 | 0.75 ±0.20 | 1.30 ±0.38 |
| | 2-1879378-3 | TLR3A30DR0015FTDG | TLR 2512 3.0W R0015 1% 50PPM 2K RL | 1.5 | 6.35 ±0.254 | 3.18 ±0.254 | 0.45 ±0.20 | 1.30 ±0.38 |
| | 2-1879378-4 | TLR3A30DR002FTDG | TLR 2512 3.0W R002 1% 50PPM 2K RL | 2 | 6.35 ±0.254 | 3.18 ±0.254 | 0.35 ±0.20 | 1.30 ±0.38 |
| SUPERSEDED BY 2176422-1 | 2-1879378-5 | TLR3A10DR003FTDG | TLR 2512 3.0W R003 1% 75PPM 2K RL | | | | | |
| | 2-1879378-6 | TLR3A10DR0005FTDG | TLR 2512 1.0W R0005 1% 50PPM 2K RL | 0.5 | 6.35 ±0.254 | 3.18 ±0.254 | 1.25 ±0.20 | 1.30 ±0.38 |
| | 2-1879378-7 | TLR3A10DR00075FTDG | TLR 2512 1.0W R00075 1% 50PPM 2K RL | 0.75 | 6.35 ±0.254 | 3.18 ±0.254 | 0.75 ±0.20 | 1.30 ±0.38 |
| | 2-1879378-8 | TLR3A10DR001FTDG | TLR 2512 1.0W R001 1% 50PPM 2K RL | 1 | 6.35 ±0.254 | 3.18 ±0.254 | 0.65 ±0.20 | 1.30 ±0.38 |
| | 2-1879378-9 | TLR3A10DR0015FTDG | TLR 2512 1.0W R0015 1% 50PPM 2K RL | 1.5 | 6.35 ±0.254 | 3.18 ±0.254 | 0.45 ±0.20 | 1.30 ±0.38 |
| | 3-1879378-0 | TLR3A10DR002FTDG | TLR 2512 1.0W R002 1% 50PPM 2K RL | 2 | 6.35 ±0.254 | 3.18 ±0.254 | 0.35 ±0.20 | 1.30 ±0.38 |
| | 3-1879378-1 | TLR3A10KR0025FTDG | TLR 2512 1.0W R0025 1% 150PPM 2K RL | 2.5 | 6.35 ±0.254 | 3.18 ±0.254 | 0.65 ±0.20 | 1.30 ±0.38 |
| | 3-1879378-2 | TLR3A10KR003FTDG | TLR 2512 1.0W R003 1% 150PPM 2K RL | 3 | 6.35 ±0.254 | 3.18 ±0.254 | 0.55 ±0.20 | 1.30 ±0.38 |
| | 3-1879378-3 | TLR3A10ER004FTDG | TLR 2512 1.0W R004 1% 100PPM 2K RL | 4 | 6.35 ±0.254 | 3.18 ±0.254 | 0.45 ±0.20 | 1.30 ±0.38 |
| | 3-1879378-4 | TLR3A10ER005FTDG | TLR 2512 1.0W R005 1% 100PPM 2K RL | 5 | 6.35 ±0.254 | 3.18 ±0.254 | 0.35 ±0.20 | 1.30 ±0.38 |
| | 3-1879378-5 | TLR3A10WR006FTDG | TLR 2512 1.0W R006 1% 75PPM 2K RL | 6 | 6.35 ±0.254 | 3.18 ±0.254 | 0.32 ±0.20 | 1.30 ±0.38 |
| | 3-1879378-6 | TLR3A10WR007FTDG | TLR 2512 1.0W R007 1% 75PPM 2K RL | 7 | 6.35 ±0.254 | 3.18 ±0.254 | 0.27 ±0.20 | 1.30 ±0.38 |
| SUPERSEDED BY 2176417-9 | 3-1879378-7 | TLR3A10DR011FTDG | TLR 2512 1.0W R011 1% 50PPM 2K RL | | | | | |
| SUPERSEDED BY 1-2176417-0 | 3-1879378-8 | TLR3A10DR012FTDG | TLR 2512 1.0W R012 1% 50PPM 2K RL | | | | | |
| SUPERSEDED BY 1-2176417-1 | 3-1879378-9 | TLR3A10DR013FTDG | TLR 2512 1.0W R013 1% 50PPM 2K RL | | | | | |
| SUPERSEDED BY 2176417-4 | 4-1879378-0 | TLR3A10DR015FTDG | TLR 2512 1.0W R015 1% 50PPM 2K RL | | | | | |
| | 4-1879378-1 | TLR3A20KR0025FTDG | TLR 2512 2.0W R0025 1% 150PPM 2K RL | 2.5 | 6.35 ±0.254 | 3.18 ±0.254 | 0.65 ±0.20 | 1.30 ±0.38 |
| | 4-1879378-2 | TLR3A20WR006FTDG | TLR 2512 2.0W R006 1% 75PPM 2K RL | 6 | 6.35 ±0.254 | 3.18 ±0.254 | 0.32 ±0.20 | 1.30 ±0.38 |
| | 4-1879378-3 | TLR3A20WR007FTDG | TLR 2512 2.0W R007 1% 75PPM 2K RL | 7 | 6.35 ±0.254 | 3.18 ±0.254 | 0.27 ±0.20 | 1.30 ±0.38 |
| | 4-1879378-4 | TLR3A20ER010FTDG | TLR 2512 2.0W R010 1% 100PPM 2K RL | 10 | 6.35 ±0.254 | 3.18 ±0.254 | 0.25 ±0.20 | 1.30 ±0.38 |
| OBSOLETE | 4-1879378-5 | TLR3A25DR004FTDG | TLR 2512 2.5W R004 1% 50PPM 2K RL | | | | | |
| OBSOLETE | 4-1879378-6 | TLR3A25DR005FTDG | TLR 2512 2.5W R005 1% 75PPM | | | | | |
| OBSOLETE | 4-1879378-7 | TLR3A25DR006FTDG | TLR 2512 2.5W R006 1% 50PPM 2K RL | | | | | |
| | 4-1879378-8 | TLR3A30DR002FTDG20K | TLR3A 3.0W R002 1% 2K RL 20K MOQ | 2 | 6.35 ±0.254 | 3.18 ±0.254 | 0.35 ±0.20 | 1.30 ±0.38 |
| | 4-1879378-9 | TLR3A30DR0005FTDGV | TLR3A 3.0W R0005 1% 50PPM 2K RL 500K MOQ | 0.5 | 6.35 ±0.254 | 3.18 ±0.254 | 1.25 ±0.20 | 1.30 ±0.38 |
| | 5-1879378-0 | TLR3A20WR0065FTDG | TLR 2512 2.0W R0065 1% 75PPM 2K RL | 6.5 | 6.35 ±0.254 | 3.18 ±0.254 | 0.30 ±0.20 | 1.30 ±0.38 |

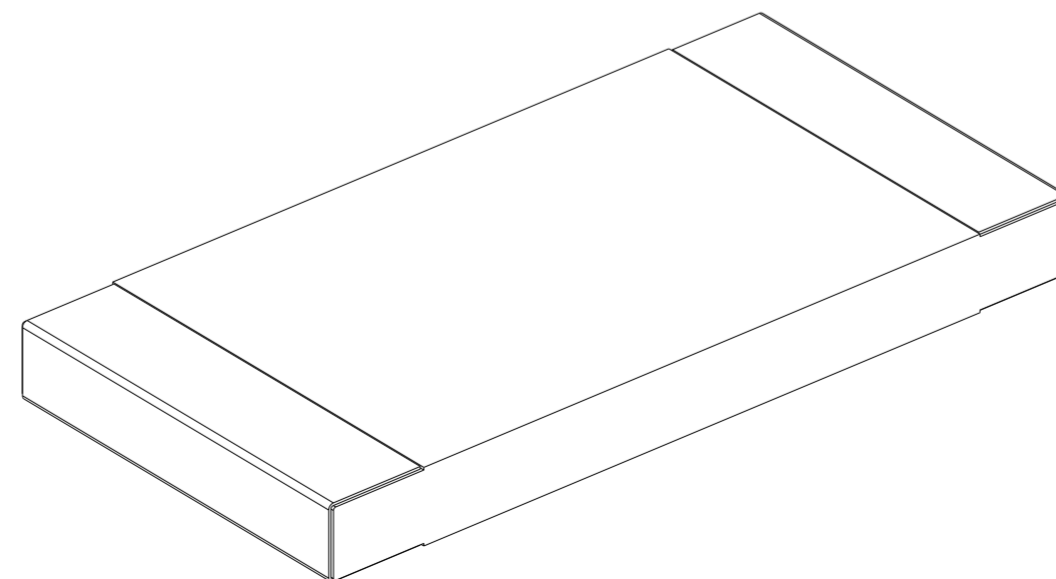

THIS DRAWING IS A CONTROLLED DOCUMENT.

DIMENSIONS: mm

TOLERANCES UNLESS OTHERWISE SPECIFIED:

| | |
|--------|------|
| 0 PLC | ±0.2 |
| 1 PLC | ±0.1 |
| 2 PLC | ± |
| 3 PLC | ± |
| 4 PLC | ± |
| ANGLES | ±5° |
| FINISH | - |

MATERIAL: -

APPROVALS:

| | | |
|------|--------------|-----------|
| DWN | PRASAD K | 14SEP2011 |
| CHK | A. PILE | 14SEP2011 |
| APVD | J. CATCHPOLE | 14SEP2011 |

PRODUCT SPEC: -

APPLICATION SPEC: -

WEIGHT: -

CUSTOMER DRAWING

SCALE: 10:1

SHEET: 1 OF 1

REV: BA6

TE Connectivity

SMD HIGH POWER - CURRENT SENSE RESISTORS, SERIES TLR - 3A

SIZE: A2

CAGE CODE: 00779

DRAWING NO: C-1879378

RESTRICTED TO: -