

159.01250MHz SAW Filter
Part No: MP01594

Model: TA0942A
REV NO.: 1

A. MAXIMUM RATING:

1. Input Power Level: 10 dBm
2. DC voltage: 5 V
3. Operating Temperature: -40°C to +70°C
4. Storage Temperature: -40°C to +85°C

B. ELECTRICAL CHARACTERISTICS:

Item		Specification				
		Unit	Min.	Typ.	Max.	
Center Frequency	F_c	MHz	-	159.0125	-	
Insertion Loss	IL_{min} (reference level)	dB	-	1.85	2.8	
Bandwidth	BW_{-3dB}	MHz	6.025	8.2	-	
Absolute Attenuation(reference to IL_{min} dB)						
	$F_c-50 \sim F_c-30$	MHz	dB	42	57	-
	$F_c-30 \sim F_c-15$	MHz	dB	36	43	-
	$F_c+30 \sim F_c+50$	MHz	dB	42	57	-
Source impedance	Z_s	Ω	-	50	-	
Load impedance	Z_L	Ω	-	50	-	

Note: IL_{min} is the minimum of the pass band attenuation. The center frequency F_c is the mean value of the upper and lower frequencies at the 3dB filter attenuation level relative to the IL_{min} .

MEASUREMENT CIRCUIT:

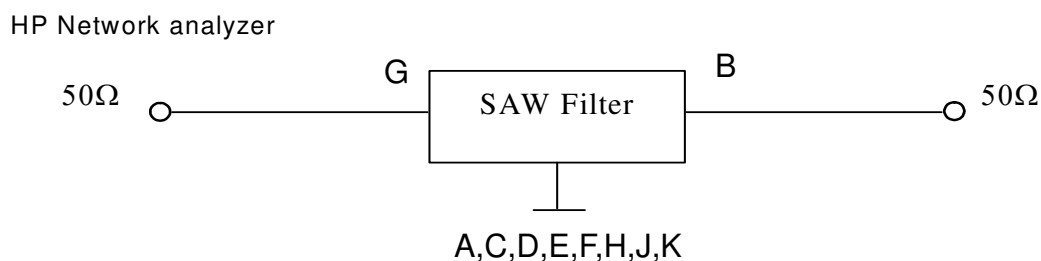

159.01250MHz SAW Filter
Part No: **MP01594**

Model: **TA0942A**
REV NO.: 1

C. FREQUENCY CHARACTERISTICS:

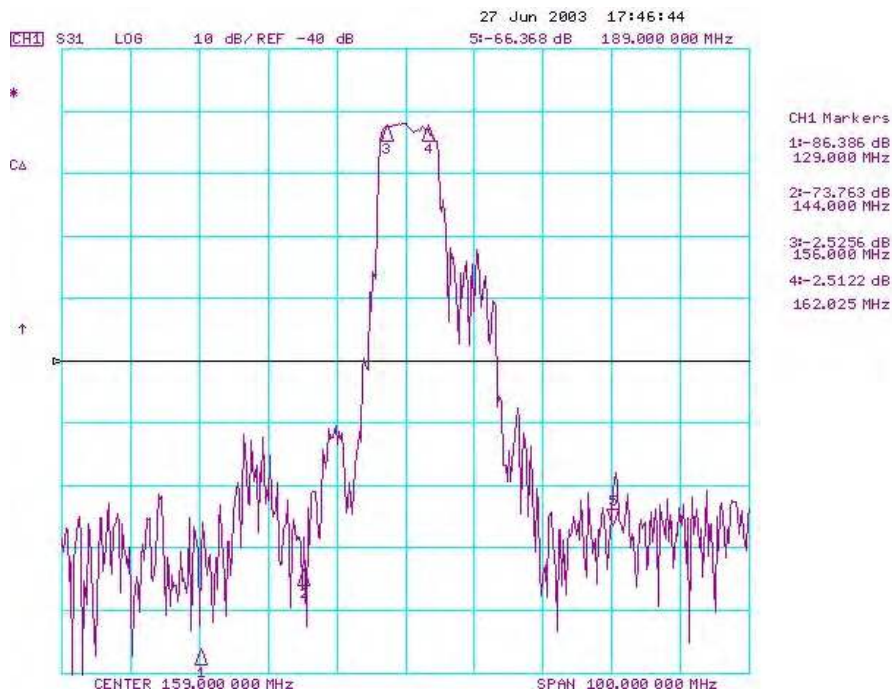

159.01250MHz SAW Filter
Part No: MP01594

Model: TA0942A
REV NO.: 1

D. OUTLINE DRAWING:

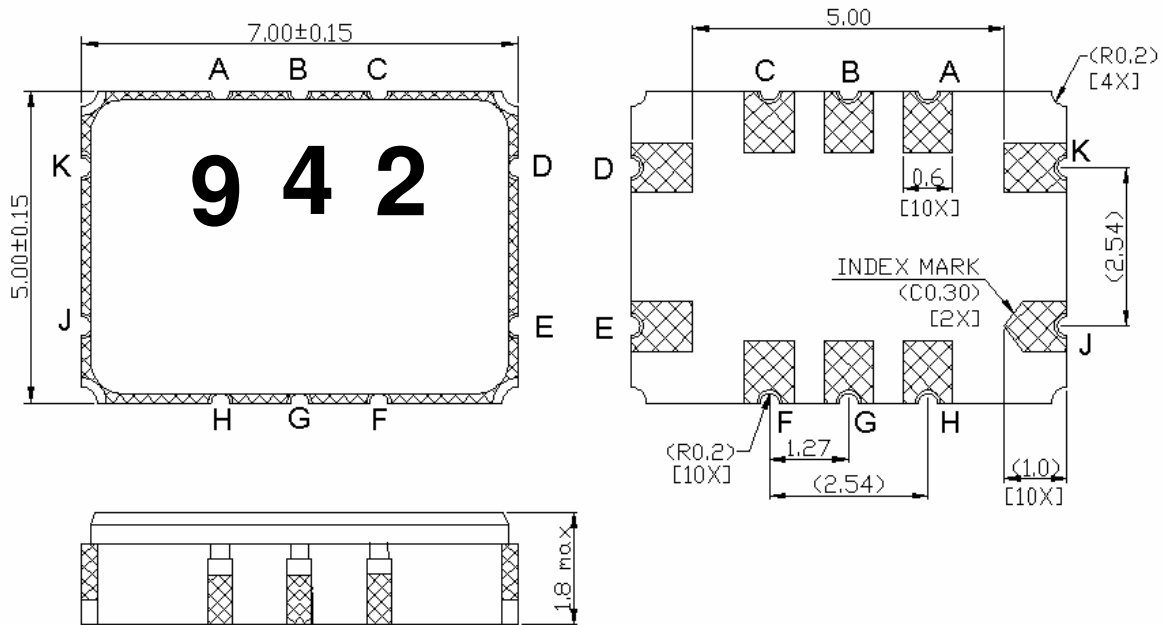

Pin configuration

- #G : Input
- #B : Output Unit : mm
- #A,C,D,E,F,H,J,K : grounded

F. PCB FOOTPRINT:

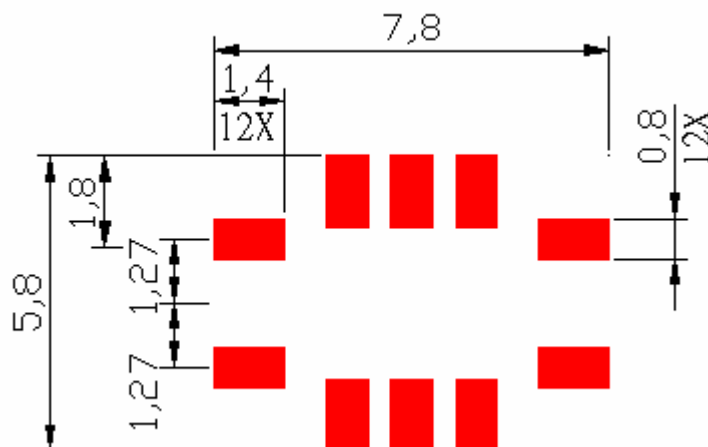

159.01250MHz SAW Filter
Part No: MP01594

Model: TA0942A
REV NO.: 1

G. PACKING:

1. REEL DIMENSION

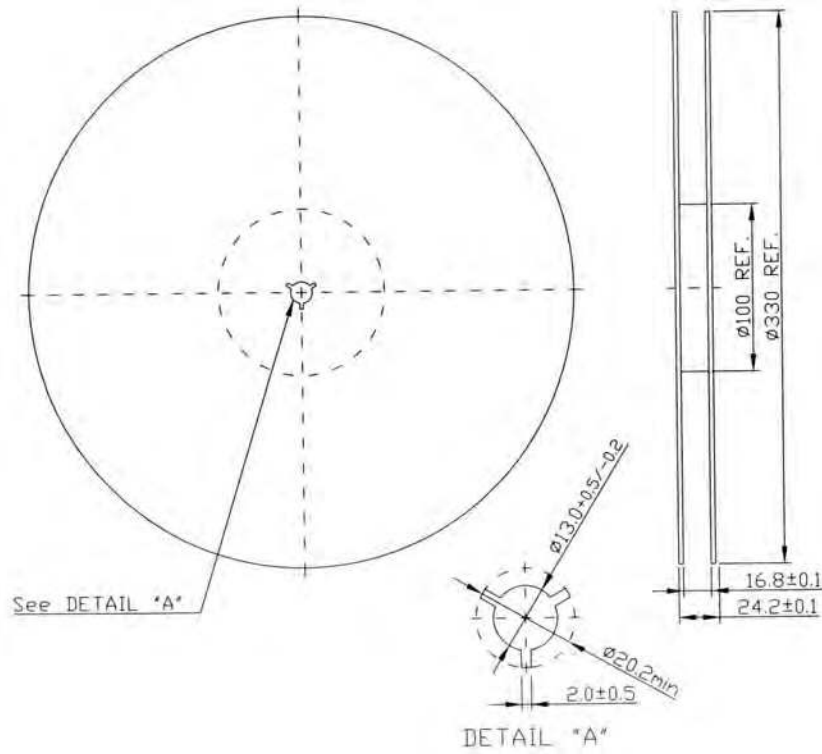

2. TAPE DIMENSION

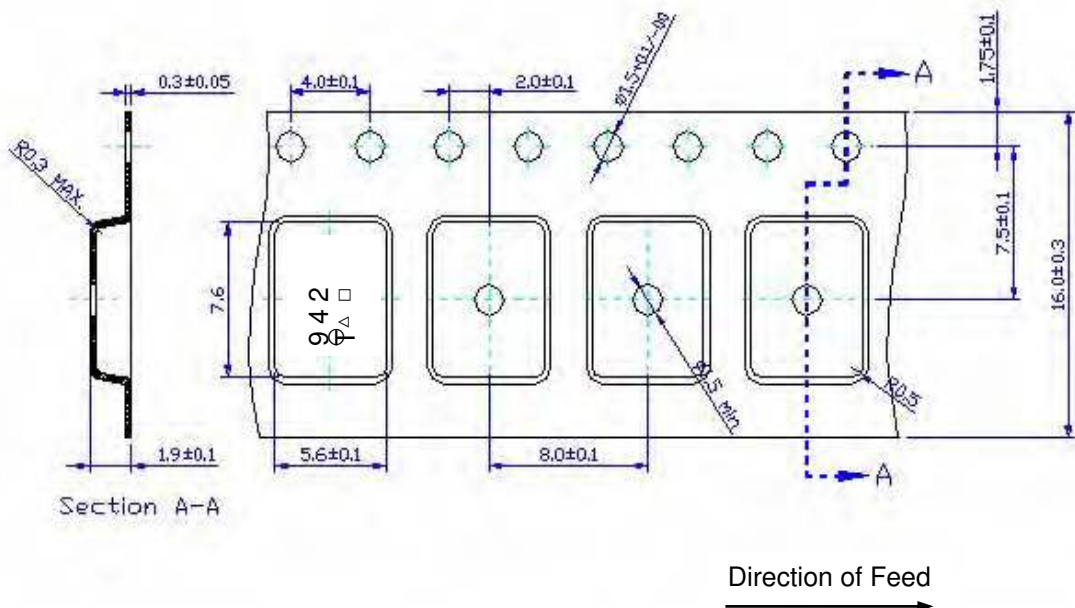

159.01250MHz SAW Filter
Part No: MP01594

Model: TA0942A
REV NO.: 1

H. RECOMMENDED REFLOW PROFILE :

