

1

Attach antenna.



2

Apply power.

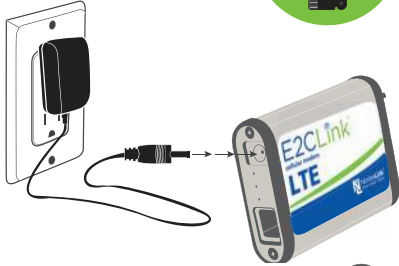

3

Plug in Ethernet cable.

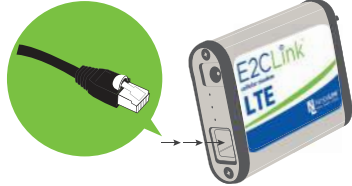

4

Plug Ethernet cable into PC or router WAN port.

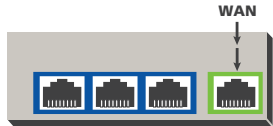

## Quick Start Guide

Operation: Device assigns IP to downstream equipment via DHCP by default. Management console available from web browser at url: 192.168.1.1

Username and password should be left blank.

## Mounting Options

Double sided tape or re-usable strap

1. Apply tape here.

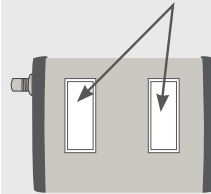

1. Screw strap to surface.



2. Tighten strap around device.

