

Copyright FCI. FCI

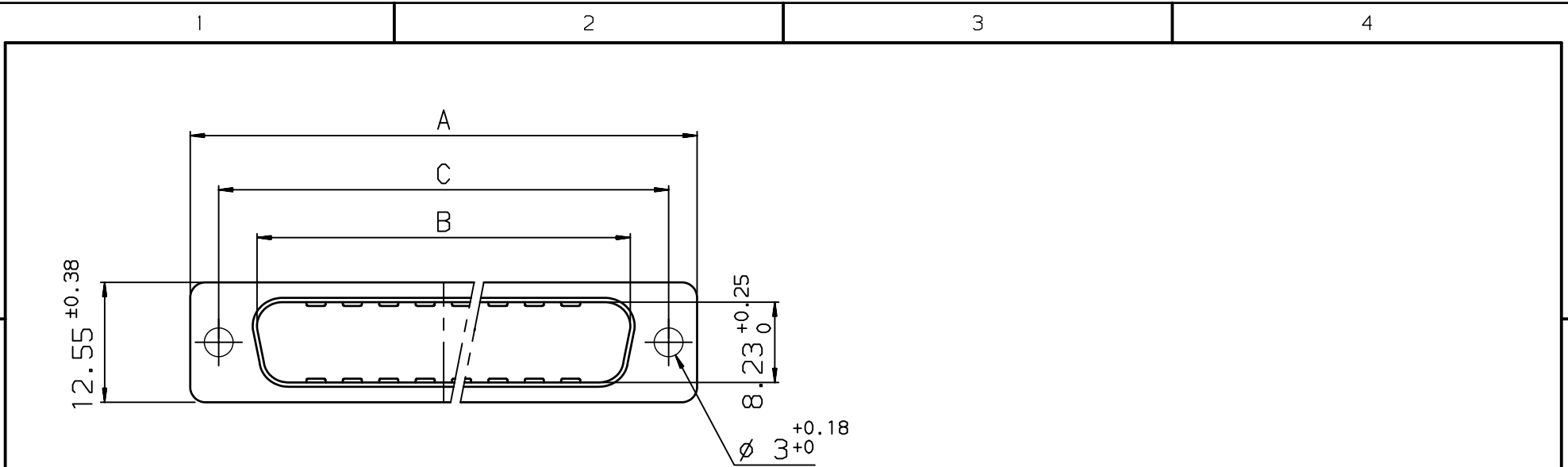

Shell size	Number of contacts	A <sup>+0.76</sup> / <sub>0</sub>	B <sup>+0.25</sup> / <sub>0</sub>	C ± 0.12	F <sup>+0.13</sup> / <sub>-0.03</sub>	G	K <sub>maxi</sub>	L <sup>+0.22</sup> / <sub>0</sub>	Part number
E	09	30.43	16.79	24.99	4.36	5.90 <sup>+0.15</sup> / <sub>0</sub>	1.50	0.80	86553113TLF
A	15	38.76	25.12	33.32	4.36	5.90 <sup>+0.15</sup> / <sub>0</sub>	1.50	0.80	86553114TLF
B	25	52.65	38.84	47.04	4.36	5.70 <sup>+0.25</sup> / <sub>0</sub>	1.50	0.80	86553115TLF
C	37	68.94	55.30	63.50	4.36	5.70 <sup>+0.25</sup> / <sub>0</sub>	1.50	1.00	86553116TLF

**NOTE: RoHS INFORMATIONS**

- The "LF" product meets European union Directives and other country regulations as described in 65-22-008.
- The product is not intended to be exposed to a manufacturing solder process.
- Plating: Sn pure bright over Copper.
- Packaging spec: see 65-14-920.

European Views

www.fciconnect.com		surface ISO 1302 ✓	tolerance std ISO 406 ISO 1101	projection ⊕	mm
TOLERANCES UNLESS OTHERWISE SPECIFIED					
Dr	GOISNARD	28/06/17	ANGULAR	0.X ± 0.1	size A3
Eng	PESSON	2006/01/12	LINEAR	0.XX ± 0.1	Scale 3
Chr	LEGARE	2006/01/12	0.XX ± 2°	0.XXX ± 0.1	ECN LS09-0006
Appr	LEGARE	2006/01/12	Product family	D-SUB	Spec ref -
				title METAL CAPS D SUB ACCESSORIES	Rev. D
catalog no				dwg no C01-8655-1656	CUSTOMER sheet 1 of 1

rev	ecn no	dr	date
A	LS05-0123	LGO	2006/01/12
B	LS06-0095	LGO	2006/06/24
C	LS07-0135	MPE	2007/05/11
D	LS09/0006	PCR	2009/01/08
-	-	-	-
-	-	-	-
-	-	-	-

REV F - 2006-04-17