

RECOMMENDED PCB LAY-OUT AND KEEP-OUT ZONE

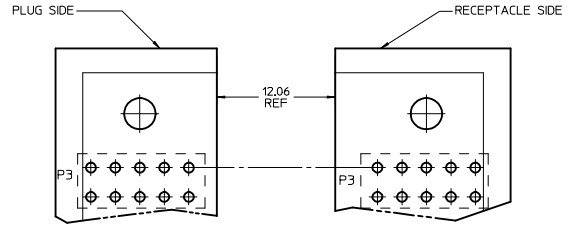
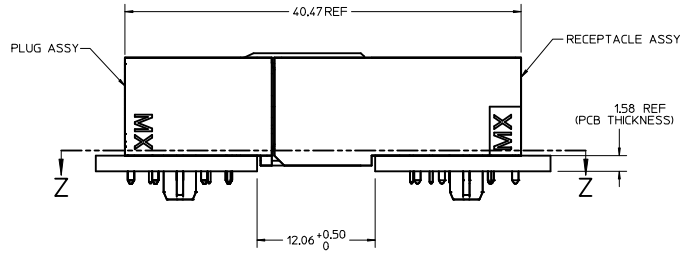
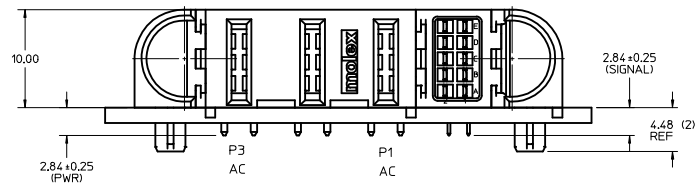

VIEW Z-Z  
(POWER CKTS ARE ALIGNED)

NOTES:

- MATERIAL:
  - HOUSINGS: LCP UL94 V-0, COLOR: BLACK
  - TERMINALS: COPPER ALLOY
  - PLATING: 0.00127 NICKEL OVERALL WITH 0.00254 SELECTIVE TIN ON COMPLIANT PINS AND 0.000762 SELECTIVE GOLD ON CONTACT AREA
- PACKAGING ASSEMBLIES TO BE TRAY PACKED PER PACKAGING SPEC PK-46562-XXX
- PRODUCT SPEC PS-46436-100
- APPLICATION SPEC: AS-46436-100
- PCB REQUIRES SOLDER THRU HOLES, REFER TO PS-46436-100 FOR DETAILS
- PRODUCT TO MEET RoHS REQUIREMENTS
- ASSEMBLY MATES WITH PLUG ASSEMBLY, P/N 46437-1281

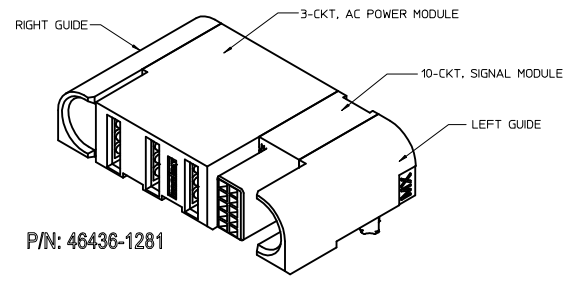

P/N: 46436-1281

RELEASED IEC NO: UCP2012-0275 DRAWN BY: TMPATIL CHECKED BY: CHYKOBPISZCZOR APPR: APATEL DATE: 2011/08/03 DATE: 2012/08/12 DATE: 2012/08/30	QUALITY SYMBOLS ∇=0 ∇=0 ∇=0	GENERAL TOLERANCES (UNLESS SPECIFIED)		DIMENSION STYLE <b>MM ONLY</b>	SCALE <b>4:1</b>	DESIGN UNITS <b>METRIC</b>	THIRD ANGLE PROJECTION	
		4 PLACES ±--- ±---	mm      INCH	DRAWN BY: TMPATIL DATE: 2011/08/03	TITLE <b>RA RECEPTACLE ASSY 10S-3AC TEN60 POWER FAMILY</b>			
		3 PLACES ±--- ±---		CHECKED BY: BPI SZCZOR DATE: 2012/08/22	MOLEX INCORPORATED			
		2 PLACES ±0.25 ±--- 1 PLACE ±0.25 ±---		APPROVED BY: APATEL DATE: 2012/08/30	MATERIAL NO: <b>46436-1281</b>	DOCUMENT NO: <b>SD-46436-1281</b>	SHEET NO. 1 OF 1	
DRAFT WHERE APPLICABLE MUST REMAIN WITHIN DIMENSIONS		SIZE <b>D</b>		THIS DRAWING CONTAINS INFORMATION THAT IS PROPRIETARY TO MOLEX INCORPORATED AND SHOULD NOT BE USED WITHOUT WRITTEN PERMISSION				

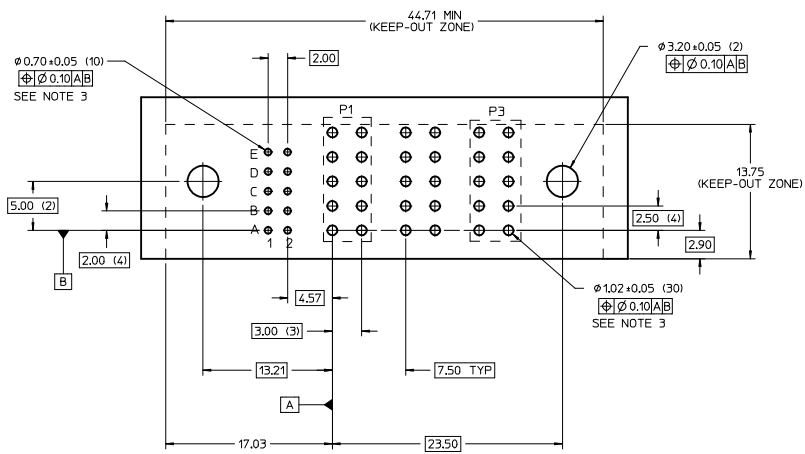
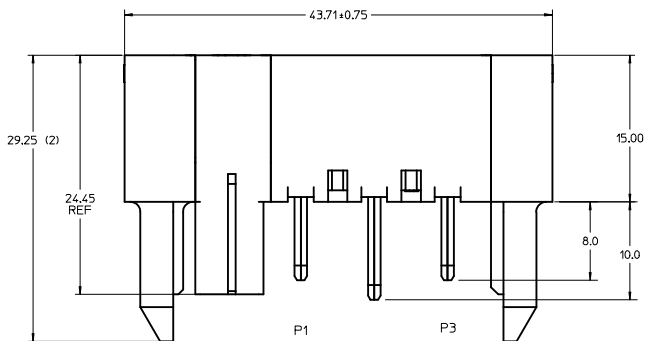

RECOMMENDED PCB LAYOUT AND KEEP-OUT ZONE

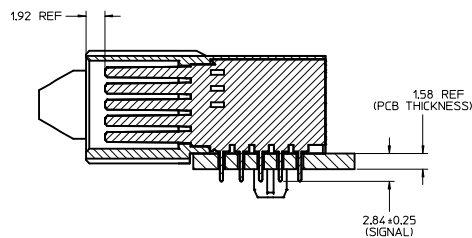
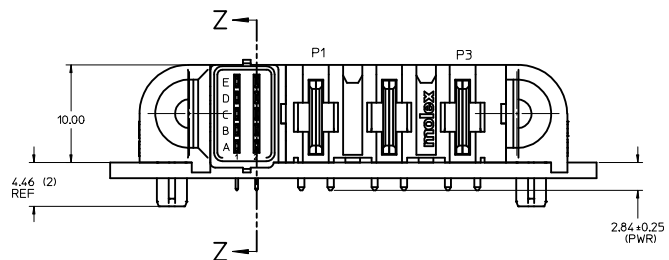

SECTION Z-Z

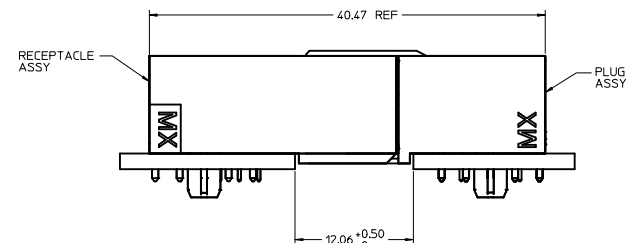

MATING PROFILE

NOTES:

- MATERIAL:  
-HOUSINGS: LCP UL-94, V-0, COLOR: BLACK  
-TERMINALS: COPPER ALLOY  
-PLATING: 0.00127 NICKEL OVERALL WITH 0.00254 SELECTIVE TIN ON SOLDER TAILS AND 0.000762 SELECTIVE GOLD ON CONTACT AREA.
- PACKAGING: ASSEMBLIES TO BE TRAY PACKED, QTY TBD.
- PC BOARD REQUIRES SOLDER THRU HOLES. REFER TO PS-46436-100 FOR DETAILS
- PRODUCT SPEC: PS-46436-100
- APPLICATION SPEC: AS-46436-100
- SEE PRODUCT SPEC FOR MEET ROHS REQUIREMENTS
- ASSEMBLY MATES WITH MOLEX RECEPTACLE ASSEMBLY P/N: 46562-1281 AND 46436-1281

P/N: 46437-1281

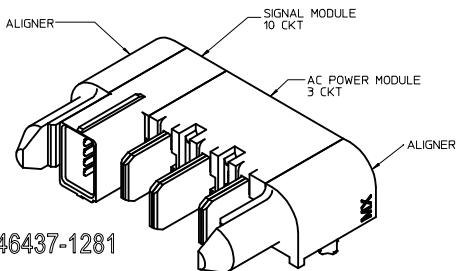

<b>RELEASED</b> IEC NO: UICP2012-0275 DRAWN BY: SZCZOR 2012/04/11 CHECKED BY: SZCZOR 2012/08/22 APPR: APATEL 2012/08/30	QUALITY SYMBOLS	GENERAL TOLERANCES (UNLESS SPECIFIED)	DIMENSION STYLE	SCALE	DESIGN UNITS	THIRD ANGLE PROJECTION
	▽=0	mm INCH	MM ONLY	4:1	METRIC	☉
	▽=0	4 PLACES ± --- ± ---	DRAWN BY: TMPATIL DATE: 2011/08/03	TITLE	R/A PLUG ASSY	
	▽=0	3 PLACES ± 0.25 ± ---	CHECKED BY: BPI SZCZOR DATE: 2012/08/22	G-10S-3AC-G		TEN60 POWER FAMILY
	ANGULAR ±1/2°	DRAFT WHERE APPLICABLE MUST REMAIN WITHIN DIMENSIONS	MATERIAL NO.	DOCUMENT NO.	SHEET NO.	
			46437-1281	SD-46437-1281	1 OF 1	
			THIS DRAWING CONTAINS INFORMATION THAT IS PROPRIETARY TO MOLEX INCORPORATED AND SHOULD NOT BE USED WITHOUT WRITTEN PERMISSION			