

© 1960 BY AMP INCORPORATED. ALL RIGHTS RESERVED. AMP PRODUCTS COVERED BY PATENTS AND/OR PATENTS PENDING. APPROVED PER GOVT CONTRACT NO.

NUMBER 42107

REVISIONS

SYM	ZONE	DESCRIPTION	DATE	APPROVAL
E		REVISED & REDRAWN	7-981	8-863
F		OBSOLETE 42107-1 & 42279-4	2102 DR	5-11-69 D.H.
G		PRINT DIST WAS "39" LOC WAS "AB"	3347	10-72 CO
H		REVISED WORDING IN TABLE & NAME	468	1-13-77 DSA
J		.0001 BRIGHT TIN WAS .0002 TIN ON 42107-2	EA 1049	1-3-79 DJH
K		REVISED PLATING	EA 1515	8-1-80 DS
L		BRIGHT TIN-LEAD WAS BRIGHT TIN	EA 1818	6-16-81 DS
M		REVISED GOLD PLATING	EA 2139	6-16-82 DS
N		.176 WAS .175, REVISED PICTURE	ECN S3056	4-29-85 JM
P		OBS 42279-3	ECN S3379	11-24-86 R & R
R		OBS 42107-4	ECN S3733	4-14-87 R & R
		OBS 42279-2	ECN S3940	4-28-87 R & R
S		REVISED PER OH14-0139-05		1-25-06 PY RJ

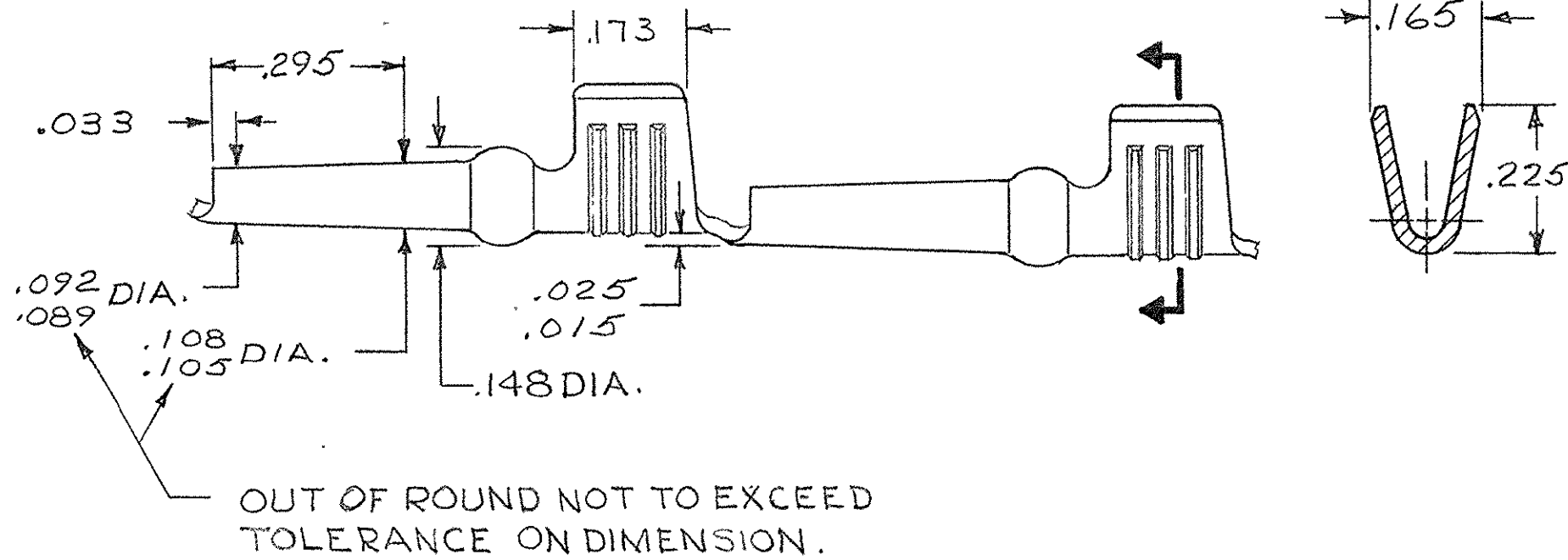
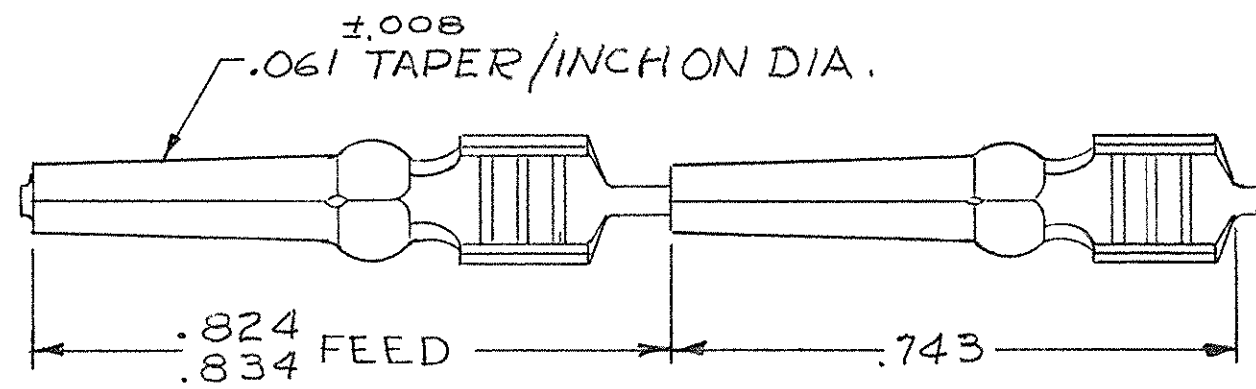

STRIP

⚠ OBSOLETE PART NO.

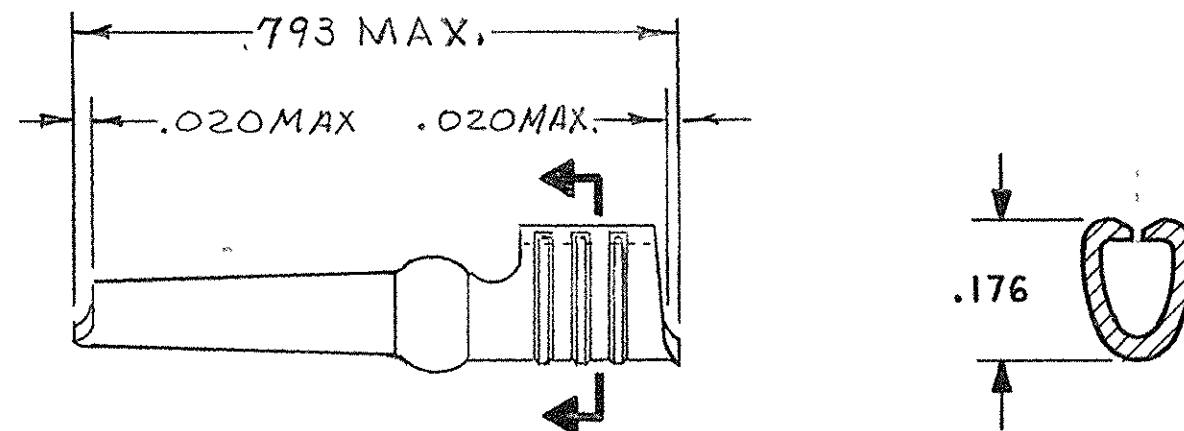

LOOSE PIECE

	5-42107-2	5-42279-1	12-14	.0000 MATTE TIN	380306-8	47689	#12-113 #14-102
OBSOLETE	42107-1	42279-4	12-14	PLAIN	380306-8	47689	#12-113 #14-102
OBSOLETE	42107-4	42279-3	12-14	.00003 GOLD OVER .00005 NICKEL	380306-8	47689	#12-113 #14-102
	42107-3	42279-2	12-14	.0002 SILVER	380306-8	47689	#12-113 #14-102
	42107-2	42279-1	12-14	.0001 BRIGHT TIN-LEAD	380306-8	47689	#12-113 #14-102
	STRIP PART NO.	LOOSE PIECE PART NO.	WIRE SIZE	FINISH	INSERT TOOL	HAND TOOL	CRIMP HEIGHT

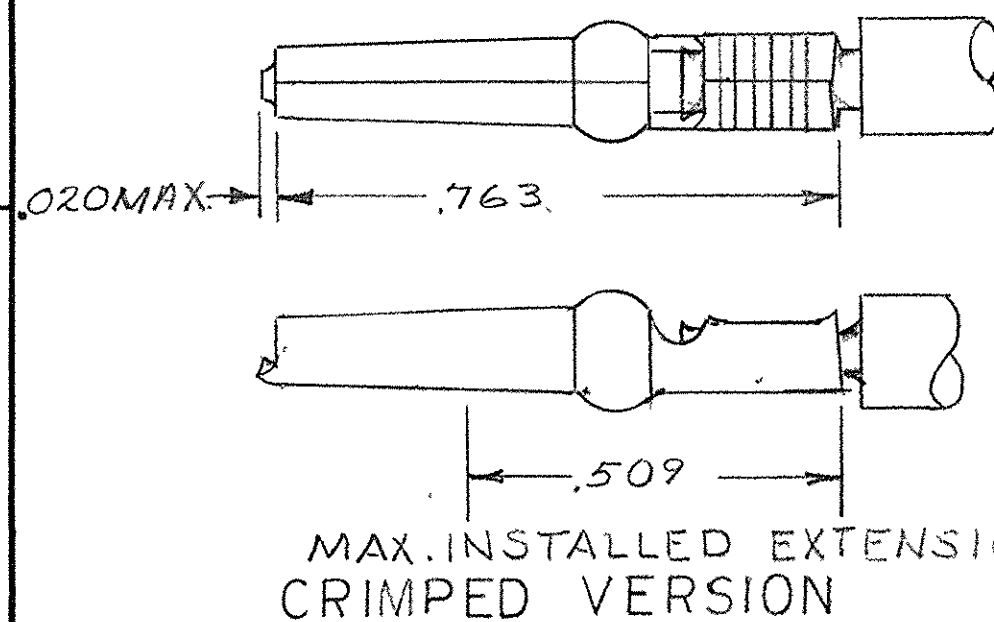

MAX. INSTALLED EXTENSION CRIMPED VERSION

M 3	INFO	QTY REQD	NOMENCLATURE OR DESCRIPTION	PART OR IDENTIFYING NO	
S	12				
LIST OF MATERIALS OR PARTS LIST					
UNLESS OTHERWISE SPECIFIED DIMENSIONS ARE IN INCHES TOLERANCES ON			SIGNATURE		DATE
FRACTIONS ±	DECIMALS ±	ANGLES ±	  		8-12-63 8-18-63 8-14-63
MATERIAL .025 COML. BRASS			AMP INCORPORATED HARRISBURG, PENNSYLVANIA		NAME
HEAT TREAT			PIN, TAPER, 88 SERIES, NON-INSULATION SUPPORT		
FINISH SEE TABLE			DSGN APPD	OTHER APPD	CODE IDENT NO
					00779
					SIZE C
					NUMBER 42107
			SCALE 4-1	WT	CALC
				ACTUAL	SHEET 1 OF 1