

THIS DRAWING IS UNPUBLISHED. RELEASED FOR PUBLICATION 20
 © COPYRIGHT 20 ALL RIGHTS RESERVED.

LOC		DIST		REVISIONS			
P	LTR	DESCRIPTION	DATE	DWN	APVD		
C		ECR-13-008068	03JUL2013	TB	DM		
D		ECR-17-014255	20SEP2017	GSK	WG		

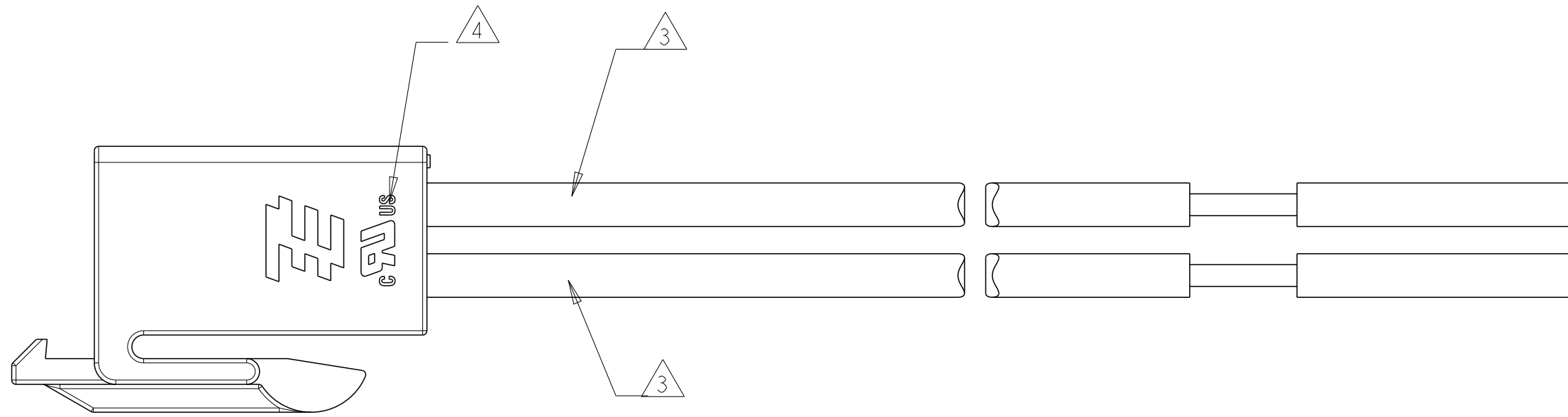

NOTES:

- 1 MATERIALS AND FINISH:
 -HOUSING: PBT, COLOR: SEE TABLE
 -CONTACTS: COPPER ALLOY, FINISH: PRE-TIN
 -WIRE: 18 AWG, STRANDED, UL 1007 STYLE
- 2. MUST COMPLY WITH DIRECTIVE 2002/95/EC (ROHS)
- 3 REFER TO TABLE FOR WIRE COLOR
- 4 PENDING APPROVAL

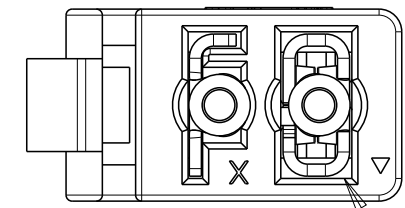
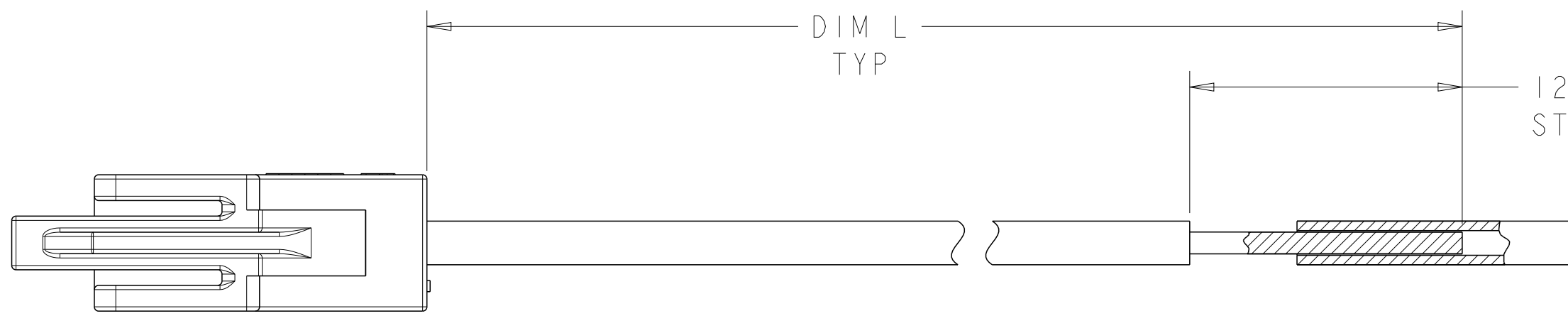

2058300-1 AND 2-2058300-0 SHOWN

101.6±3.0	NATURAL	6	2-2058300-2
101.6±3.0	NATURAL	4	2-2058300-1
101.6±3.0	NATURAL	2	2-2058300-0
150±5.0	NATURAL	6	1-2058300-4
101.6±3.0	BLACK	6	1-2058300-3
101.6±3.0	BLACK	4	1-2058300-2
101.6±3.0	BLACK	2	1-2058300-1
457.2±10.0	NATURAL	2	2058300-7
304.8±10.0	NATURAL	2	2058300-6
152.4±5.0	NATURAL	2	2058300-5
1000.0±15.0	NATURAL	2	2058300-4
101.6±3.0	NATURAL	6	2058300-3
101.6±3.0	NATURAL	4	2058300-2
101.6±3.0	NATURAL	2	2058300-1
DIM L	HOUSING COLOR	POSN	PART NO.

WIRE COLOR 3														
6	-	-	WHITE	-	-	-	-	-	-	WHITE	WHITE	-	-	WHITE
5	-	-	YELLOW	-	-	-	-	-	-	YELLOW	YELLOW	-	-	YELLOW
4	-	ORANGE	ORANGE	-	-	-	-	-	ORANGE	ORANGE	ORANGE	-	ORANGE	ORANGE
3	-	BLUE	BLUE	-	-	-	-	-	BLUE	BLUE	BLUE	-	BLUE	BLUE
2	RED	RED	RED	RED	WHITE WITH RED STRIPE	WHITE WITH RED STRIPE	WHITE WITH RED STRIPE	RED	RED	RED	RED	RED	RED	RED
1	BLACK	BLACK	BLACK	BLACK	WHITE	WHITE	WHITE	BLACK	BLACK	BLACK	BLACK	BLACK	BLACK	BLACK
CKT	-1	-2	-3	-4	-5	-6	-7	1-1	1-2	1-3	1-4	2-0	2-1	2-2
PART NUMBER														

THIS DRAWING IS A CONTROLLED DOCUMENT.

DWN R BROWN 02SPR2009
 CHK R NARANG 02APR2009

APVD -

PRODUCT SPEC -

APPLICATION SPEC -

WEIGHT -

CUSTOMER DRAWING

SCALE 4:1

SHEET 1 OF 1

REV D

NAME CABLE ASSEMBLY, WIRE TO BOARD CONNECTOR

SIZE A2

CAGE CODE 00779

DRAWING NO C-2058300

RESTRICTED TO -

STE TE Connectivity