

BTFE 6-3/14 4U - Test terminal strip

1029251

<https://www.phoenixcontact.com/us/products/1029251>

Please be informed that the data shown in this PDF document is generated from our online catalog. Please find the complete data in the user documentation. Our general terms of use for downloads are valid.



Test terminal strip, nom. voltage: 400 V, nominal current: 24 A, connection method: Ring cable lug, 1 level, Rated cross section: 6 mm², mounting type: Wall mounting, color: gray

Commercial data

| | |
|--------------------------------------|---------------------|
| Item number | 1029251 |
| Packing unit | 1 pc |
| Minimum order quantity | 1 pc |
| Sales key | BE06 |
| Product key | BE6113 |
| Catalog page | Page 650 (C-1-2019) |
| GTIN | 4055626531076 |
| Weight per piece (including packing) | 792.8 g |
| Weight per piece (excluding packing) | 792 g |
| Customs tariff number | 85369010 |
| Country of origin | PL |

BTFE 6-3/14 4U - Test terminal strip



1029251

<https://www.phoenixcontact.com/us/products/1029251>

Technical data

Product properties

| | |
|--------------|---------------------|
| Product type | Test terminal strip |
|--------------|---------------------|

Insulation characteristics

| | |
|----------------------|-----|
| Overvoltage category | III |
|----------------------|-----|

Electrical properties

| | |
|---|--------|
| Rated surge voltage | 4 kV |
| Maximum power dissipation for nominal condition | 1.02 W |
| Test surge voltage | 5 kV |

Connection data

| | |
|-----------------------|-------------------|
| Nominal cross section | 4 mm ² |
|-----------------------|-------------------|

1 level

| | |
|---|---|
| Tightening torque | 1 ... 1.3 Nm |
| Internal cylindrical gage | A5 |
| Connection in acc. with standard | IEC 60947-7-1 |
| Conductor cross section flexible | 0.5 mm ² ... 6 mm ² |
| Conductor cross section, flexible [AWG] | 24 ... 10 (converted acc. to IEC) |
| Nominal current | 24 A |
| Maximum load current | 24 A |
| Nominal voltage | 400 V |
| Nominal cross section | 6 mm ² |

Cable lug connection DIN 46237:1970-07

| | |
|--|---|
| Connection in acc. with standard | DIN 46237:1970-07 |
| Cross section | 0.5 mm ² ... 2.5 mm ² |
| Cross section range AWG | (converted acc. to IEC) |
| Hole diameter | 3.7 mm |
| Width | 6.8 mm |
| Bolt diameter | 3.5 mm |
| Identification color of ring cable lugs : red | 1 mm ² |
| Identification color of ring cable lugs : blue | 2.5 mm ² |
| Cross section | 4 mm ² ... 6 mm ² |
| Additional text | Type RS PRO Order No. 267-3919, vertical crimping |
| Cross section range AWG | (converted acc. to IEC) |
| Hole diameter | 3.7 mm |
| Width | 7.2 mm |
| Bolt diameter | 3.5 mm |

Material specifications

| | |
|-------|------|
| Color | gray |
|-------|------|

BTFE 6-3/14 4U - Test terminal strip



1029251

<https://www.phoenixcontact.com/us/products/1029251>

| | |
|--|--------|
| Flammability rating according to UL 94 | V0 |
| Insulating material group | I |
| Insulating material | PC |
| Relative insulation material temperature index (Elec., UL 746 B) | 130 °C |

Electrical tests

Surge voltage test

| | |
|--------|-------------|
| Result | Test passed |
| Result | Test passed |

Power-frequency withstand voltage

| | |
|-----------------------|-------------|
| Test voltage setpoint | 2 kV |
| Result | Test passed |

Mechanical properties

Mechanical data

| | |
|-----------------|----|
| Open side panel | No |
|-----------------|----|

Mechanical tests

Mechanical strength

| | |
|--------|-------------|
| Result | Test passed |
|--------|-------------|

Attachment on the carrier

| | |
|--------|-------------|
| Result | Test passed |
|--------|-------------|

Test for conductor damage and slackening

| | |
|--------------------------------|------------------------------|
| Conductor cross section/weight | 2.5 mm ² / 0.7 kg |
| | 2.0 mm ² / 0.7 kg |
| Result | Test passed |

Environmental and real-life conditions

Aging

| | |
|--------------------|-------------|
| Temperature cycles | 192 |
| Result | Test passed |

Needle-flame test

| | |
|--------|-------------|
| Result | Test passed |
|--------|-------------|

Ambient conditions

| | |
|---|---|
| Ambient temperature (operation) | -60 °C ... 85 °C (max. short-term operating temperature RTI Elec.) |
| Ambient temperature (storage/transport) | -25 °C ... 55 °C (for a short time, not exceeding 24 h, -60 °C to +70 °C) |
| Ambient temperature (assembly) | -5 °C ... 70 °C |
| Ambient temperature (actuation) | -5 °C ... 70 °C |

BTFE 6-3/14 4U - Test terminal strip



1029251

<https://www.phoenixcontact.com/us/products/1029251>

| | |
|--|---------------|
| Permissible humidity (storage/transport) | 30 % ... 70 % |
|--|---------------|

Standards and regulations

| | |
|----------------------------------|---------------|
| Connection in acc. with standard | IEC 60947-7-1 |
|----------------------------------|---------------|

Mounting

| | |
|---------------|---------------|
| Mounting type | Wall mounting |
|---------------|---------------|

BTFE 6-3/14 4U - Test terminal strip

1029251

<https://www.phoenixcontact.com/us/products/1029251>



Drawings

Dimensional drawing

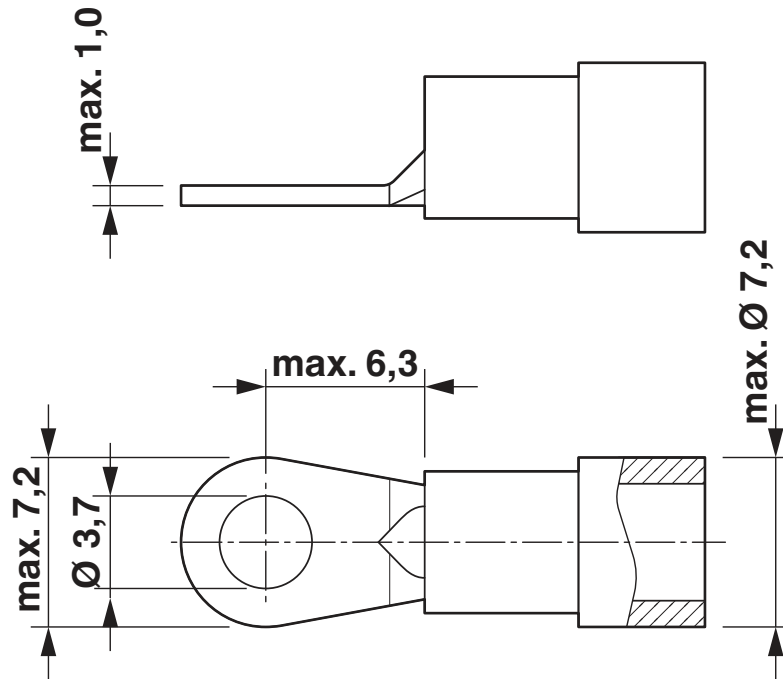

BTFE 6-3/14 4U - Test terminal strip

1029251

<https://www.phoenixcontact.com/us/products/1029251>

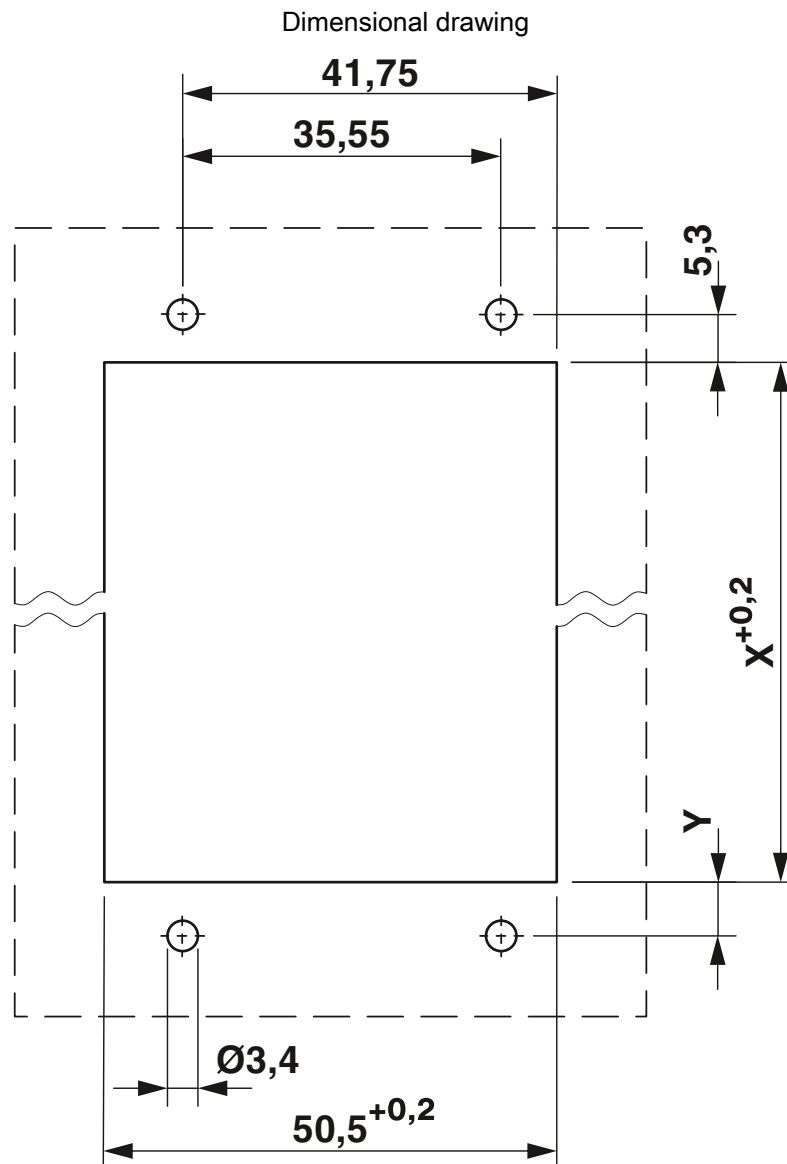

X = 156.6 mm

Y = 6.0 mm

BTFE 6-3/14 4U - Test terminal strip

1029251

<https://www.phoenixcontact.com/us/products/1029251>



Dimensional drawing

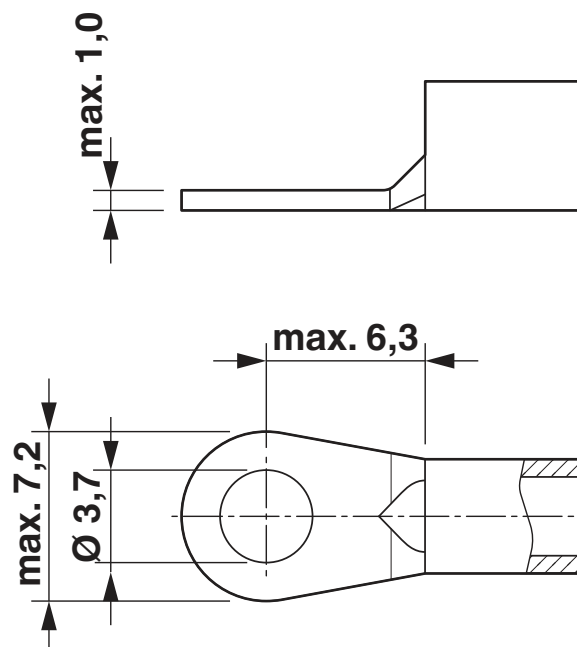

BTFE 6-3/14 4U - Test terminal strip

1029251

<https://www.phoenixcontact.com/us/products/1029251>



Circuit diagram

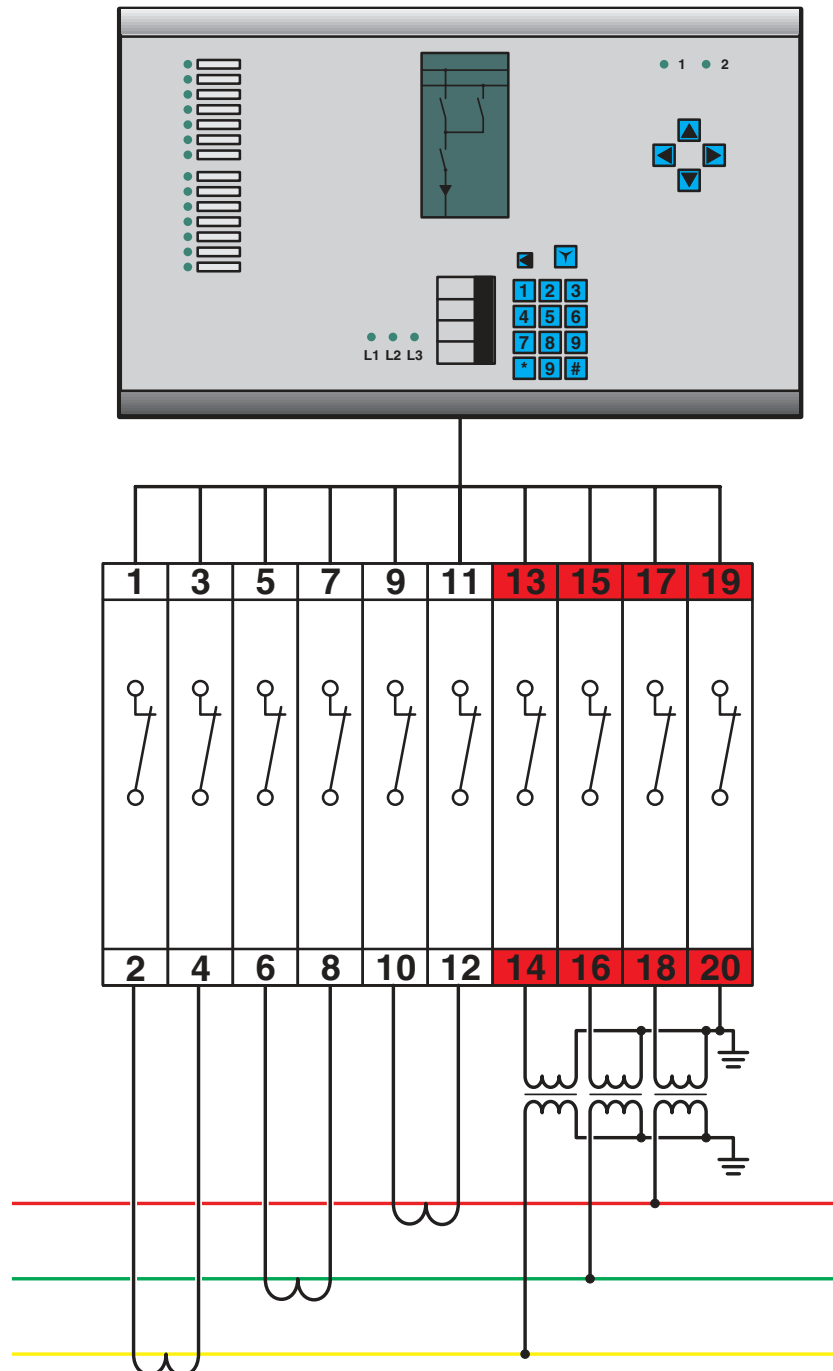

BTFE 6-3/14 4U - Test terminal strip



1029251

<https://www.phoenixcontact.com/us/products/1029251>

Circuit diagram

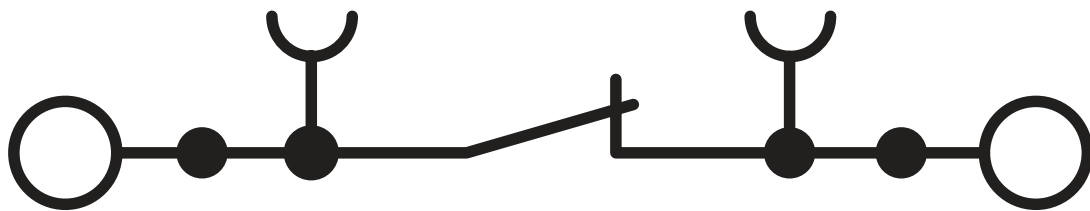

BTFE 6-3/14 4U - Test terminal strip





1029251

<https://www.phoenixcontact.com/us/products/1029251>

Approvals

To download certificates, visit the product detail page: <https://www.phoenixcontact.com/us/products/1029251>

|  CSA Approval ID: 13631 | | | | |
|--|-----------------------|-----------------------|-------------------|----------------------|
| | Nominal voltage U_N | Nominal current I_N | Cross section AWG | Cross section mm^2 |
| Use group B | 300 V | 30 A | 20 - 10 | - |
| Use group C | 300 V | 30 A | 20 - 10 | - |
| Use group D | 600 V | 5 A | 20 - 10 | - |

|  cUL Recognized Approval ID: FILE E 60425 | | | | |
|--|-----------------------|-----------------------|-------------------|----------------------|
| | Nominal voltage U_N | Nominal current I_N | Cross section AWG | Cross section mm^2 |
| Use group B | 300 V | 30 A | 20 - 10 | - |
| Use group C | 300 V | 30 A | 20 - 10 | - |
| Use group F | 400 V | 30 A | 20 - 10 | - |
| Use group D | 600 V | 5 A | 20 - 10 | - |

|  UL Recognized Approval ID: FILE E 60425 | | | | |
|---|-----------------------|-----------------------|-------------------|----------------------|
| | Nominal voltage U_N | Nominal current I_N | Cross section AWG | Cross section mm^2 |
| Use group B | 300 V | 30 A | 20 - 10 | - |
| Use group C | 300 V | 30 A | 20 - 10 | - |
| Use group F | 400 V | 30 A | 20 - 10 | - |
| Use group D | 600 V | 5 A | 20 - 10 | - |

cULus Recognized

BTFE 6-3/14 4U - Test terminal strip



1029251

<https://www.phoenixcontact.com/us/products/1029251>

Classifications

ECLASS

| | |
|-------------|----------|
| ECLASS-11.0 | 27141126 |
| ECLASS-12.0 | 27141126 |
| ECLASS-13.0 | 27250190 |

ETIM

| | |
|----------|----------|
| ETIM 8.0 | EC000902 |
|----------|----------|

UNSPSC

| | |
|-------------|----------|
| UNSPSC 21.0 | 39121400 |
|-------------|----------|

BTFE 6-3/14 4U - Test terminal strip



1029251

<https://www.phoenixcontact.com/us/products/1029251>

Environmental product compliance

| | |
|------------|--|
| REACH SVHC | Lead 7439-92-1 |
| China RoHS | Environmentally Friendly Use Period = 50 years |
| | For information on hazardous substances, refer to the manufacturer's declaration available under "Downloads" |

BTFE 6-3/14 4U - Test terminal strip

1029251

<https://www.phoenixcontact.com/us/products/1029251>

Accessories

 Note: Applying some accessories below might limit this product.

FBS 2-8 - Plug-in bridge

3030284

<https://www.phoenixcontact.com/us/products/3030284>



Plug-in bridge, pitch: 8.2 mm, number of positions: 2, color: red

 Max. current carrying capacity: 24 A

FBS 3-8 - Plug-in bridge

3030297

<https://www.phoenixcontact.com/us/products/3030297>



Plug-in bridge, pitch: 8.2 mm, number of positions: 3, color: red

 Max. current carrying capacity: 24 A

BTFE 6-3/14 4U - Test terminal strip

1029251

<https://www.phoenixcontact.com/us/products/1029251>



FBS 4-8 - Plug-in bridge

3030307

<https://www.phoenixcontact.com/us/products/3030307>



Plug-in bridge, pitch: 8.2 mm, number of positions: 4, color: red

 Max. current carrying capacity: 24 A

FBS 5-8 - Plug-in bridge

3030310

<https://www.phoenixcontact.com/us/products/3030310>



Plug-in bridge, pitch: 8.2 mm, number of positions: 5, color: red

 Max. current carrying capacity: 24 A

BTFE 6-3/14 4U - Test terminal strip

1029251

<https://www.phoenixcontact.com/us/products/1029251>



FBS 6-8 - Plug-in bridge

3032470

<https://www.phoenixcontact.com/us/products/3032470>



Plug-in bridge, pitch: 8.2 mm, number of positions: 6, color: red

 Max. current carrying capacity: 24 A

FBS 10-8 - Plug-in bridge

3030323

<https://www.phoenixcontact.com/us/products/3030323>



Plug-in bridge, pitch: 8.2 mm, number of positions: 10, color: red

 Max. current carrying capacity: 24 A

BTFE 6-3/14 4U - Test terminal strip

1029251

<https://www.phoenixcontact.com/us/products/1029251>

FBS 1/3-8 - Plug-in bridge

3032363

<https://www.phoenixcontact.com/us/products/3032363>



Plug-in bridge, pitch: 8.2 mm, number of positions: 3, pin assignment: 1,3, color: red

 Max. current carrying capacity: 24 A

FBS 1/4-8 - Plug-in bridge

3032376

<https://www.phoenixcontact.com/us/products/3032376>



Plug-in bridge, pitch: 8.2 mm, number of positions: 4, pin assignment: 1, 4, color: red

 Max. current carrying capacity: 24 A

BTFE 6-3/14 4U - Test terminal strip

1029251

<https://www.phoenixcontact.com/us/products/1029251>



FBS 1/3/5-8 - Plug-in bridge

3032389

<https://www.phoenixcontact.com/us/products/3032389>



Plug-in bridge, pitch: 8.2 mm, number of positions: 5, pin assignment: 1,3,5, color: red

 Max. current carrying capacity: 24 A

FBS 1/4/7/10-8 - Plug-in bridge

3032402

<https://www.phoenixcontact.com/us/products/3032402>



Plug-in bridge, pitch: 8.2 mm, number of positions: 10, pin assignment: 1,4,7,10, color: red

 Max. current carrying capacity: 24 A

BTFE 6-3/14 4U - Test terminal strip

1029251

<https://www.phoenixcontact.com/us/products/1029251>



FBSR 5-8 - Plug-in bridge

3033809

<https://www.phoenixcontact.com/us/products/3033809>



Plug-in bridge, pitch: 8.2 mm, number of positions: 5, color: red

 Max. current carrying capacity: 24 A

FBS 2-8 CT - Plug-in bridge

3033830

<https://www.phoenixcontact.com/us/products/3033830>



Plug-in bridge, pitch: 8.2 mm, number of positions: 2, color: orange

 Max. current carrying capacity: 24 A

BTFE 6-3/14 4U - Test terminal strip

1029251

<https://www.phoenixcontact.com/us/products/1029251>



FBS 3-8 CT - Plug-in bridge

3033831

<https://www.phoenixcontact.com/us/products/3033831>



Plug-in bridge, pitch: 8.2 mm, number of positions: 3, color: orange

 Max. current carrying capacity: 24 A

FBS 4-8 CT - Plug-in bridge

3033832

<https://www.phoenixcontact.com/us/products/3033832>



Plug-in bridge, pitch: 8.2 mm, number of positions: 4, color: orange

 Max. current carrying capacity: 24 A

BTFE 6-3/14 4U - Test terminal strip

1029251

<https://www.phoenixcontact.com/us/products/1029251>



FBS 10-8 CT - Plug-in bridge

3033833

<https://www.phoenixcontact.com/us/products/3033833>



Plug-in bridge, pitch: 8.2 mm, number of positions: 10, color: orange

 Max. current carrying capacity: 24 A

FBS 2-8 BU - Plug-in bridge

3032567

<https://www.phoenixcontact.com/us/products/3032567>



Plug-in bridge, pitch: 8.2 mm, number of positions: 2, color: blue

 Max. current carrying capacity: 24 A

BTFE 6-3/14 4U - Test terminal strip

1029251

<https://www.phoenixcontact.com/us/products/1029251>



FBS 3-8 BU - Plug-in bridge

3032570

<https://www.phoenixcontact.com/us/products/3032570>



Plug-in bridge, pitch: 8.2 mm, number of positions: 3, color: blue

 Max. current carrying capacity: 24 A

FBS 4-8 BU - Plug-in bridge

3032583

<https://www.phoenixcontact.com/us/products/3032583>



Plug-in bridge, pitch: 8.2 mm, number of positions: 4, color: blue

 Max. current carrying capacity: 24 A

BTFE 6-3/14 4U - Test terminal strip

1029251

<https://www.phoenixcontact.com/us/products/1029251>



FBS 5-8 BU - Plug-in bridge

3032596

<https://www.phoenixcontact.com/us/products/3032596>



Plug-in bridge, pitch: 8.2 mm, number of positions: 5, color: blue

 Max. current carrying capacity: 24 A

FBS 6-8 BU - Plug-in bridge

3032677

<https://www.phoenixcontact.com/us/products/3032677>



Plug-in bridge, pitch: 8.2 mm, number of positions: 6, color: blue

 Max. current carrying capacity: 24 A

BTFE 6-3/14 4U - Test terminal strip

1029251

<https://www.phoenixcontact.com/us/products/1029251>



FBS 10-8 BU - Plug-in bridge

3032606

<https://www.phoenixcontact.com/us/products/3032606>



Plug-in bridge, pitch: 8.2 mm, number of positions: 10, color: blue

 Max. current carrying capacity: 24 A

FTP-3F/14 4U - Test plug

1029268

<https://www.phoenixcontact.com/us/products/1029268>



Test plug, nom. voltage: 400 V, nominal current: 20 A, number of positions: 14, connection method: Cable lug connection, Rated cross section: 2.5 mm², color: gray

BTFE 6-3/14 4U - Test terminal strip

1029251

<https://www.phoenixcontact.com/us/products/1029251>



FBP-3F 4U - Blind plug

1029279

<https://www.phoenixcontact.com/us/products/1029279>



Blind plug, color: gray

TMT (EX6,2)R - Marker for terminal blocks

0803063

<https://www.phoenixcontact.com/us/products/0803063>



Marker for terminal blocks, Roll, white, unlabeled, can be labeled with: THERMOMARK E.300 (D)/600 (D), THERMOMARK ROLL 2.0, THERMOMARK ROLL, THERMOMARK ROLL X1, THERMOMARK ROLLMASTER 300/600, THERMOMARK X1.2, mounting type: snapped, snap into flat marker groove, lettering field size: 6.2 x 50000 mm, Number of individual labels: 1

BTFE 6-3/14 4U - Test terminal strip

1029251

<https://www.phoenixcontact.com/us/products/1029251>



US-TMF 100 - Marker for terminal blocks

0829260

<https://www.phoenixcontact.com/us/products/0829260>



Marker for terminal blocks, Card, white, unlabeled, can be labeled with: BLUEMARK ID COLOR, BLUEMARK ID, THERMOMARK PRIME, THERMOMARK CARD 2.0, THERMOMARK CARD, mounting type: snapped, snap into flat marker groove, lettering field size: 104 x 6.6 mm, Number of individual labels: 20

PAI-4-N GY - Test adapter

3032871

<https://www.phoenixcontact.com/us/products/3032871>



4 mm test adapter, for terminal blocks with 5.2 mm, 6.2 mm and 8.2 mm pitch

BTFE 6-3/14 4U - Test terminal strip

1029251

<https://www.phoenixcontact.com/us/products/1029251>

SF-PH 2-100 - Screwdriver

1212560

<https://www.phoenixcontact.com/us/products/1212560>



Screwdriver, PH crosshead (lasered), uninsulated, size: PH 2 x 100, 2-component grip, with non-slip grip

SF-PH 2-100 S-VDE - Screwdriver

1212694

<https://www.phoenixcontact.com/us/products/1212694>



Screwdriver, crosshead PH (lasered), insulated, size: PH 2 x 100, 2-component handle, with non-slip grip

BTFE 6-3/14 4U - Test terminal strip

1029251

<https://www.phoenixcontact.com/us/products/1029251>

C-RCI 1,5/M3,5 - Ring cable lug

3240017

<https://www.phoenixcontact.com/us/products/3240017>



Ring cable lug, red, 0.5 ... 1.5 mm², M3.5

C-RCI 2,5/M3,5 - Ring cable lug

3240022

<https://www.phoenixcontact.com/us/products/3240022>



Ring cable lug, blue, 1.5 ... 2.5 mm², M3.5

BTFE 6-3/14 4U - Test terminal strip



1029251

<https://www.phoenixcontact.com/us/products/1029251>

ZBF 8:UNBEDRUCKT - Zack Marker strip, flat

0808781

<https://www.phoenixcontact.com/us/products/0808781>



Zack Marker strip, flat, Strip, white, unlabeled, can be labeled with: PLOTMARK, CMS-P1-PLOTTER, mounting type: snapped, for terminal block width: 8 mm, lettering field size: 5.15 x 8.15 mm, Number of individual labels: 10

ZBF 8 CUS - Zack Marker strip, flat

0825030

<https://www.phoenixcontact.com/us/products/0825030>



Zack Marker strip, flat, can be ordered: Strip, white, labeled according to customer specifications, mounting type: snap into flat marker groove, for terminal block width: 8 mm, lettering field size: 5.15 x 8.15 mm, Number of individual labels: 10

BTFE 6-3/14 4U - Test terminal strip

1029251

<https://www.phoenixcontact.com/us/products/1029251>



ZBF 8,LGS:FORTL.ZAHLEN - Zack Marker strip, flat

0808804

<https://www.phoenixcontact.com/us/products/0808804>



Zack Marker strip, flat, Strip, white, labeled, printed horizontally: consecutive numbers 1 ... 10, 11 ... 20, etc. up to 101 ... 110, mounting type: snapped, for terminal block width: 8 mm, lettering field size: 5.15 x 8.15 mm, Number of individual labels: 10

UC-TMF 8 - Marker for terminal blocks

0818137

<https://www.phoenixcontact.com/us/products/0818137>



Marker for terminal blocks, Sheet, white, unlabeled, can be labeled with: BLUEMARK ID COLOR, BLUEMARK ID, BLUEMARK CLED, PLOTMARK, CMS-P1-PLOTTER, mounting type: snapped, for terminal block width: 8.2 mm, lettering field size: 7.6 x 5.1 mm, Number of individual labels: 56

BTFE 6-3/14 4U - Test terminal strip

1029251

<https://www.phoenixcontact.com/us/products/1029251>



UC-TMF 8 CUS - Marker for terminal blocks

0824654

<https://www.phoenixcontact.com/us/products/0824654>



Marker for terminal blocks, can be ordered: by sheet, white, labeled according to customer specifications, mounting type: snap into flat marker groove, for terminal block width: 8.2 mm, lettering field size: 7.6 x 5.1 mm, Number of individual labels: 56

UCT-TMF 8 - Marker for terminal blocks

0828748

<https://www.phoenixcontact.com/us/products/0828748>



Marker for terminal blocks, Sheet, white, unlabeled, can be labeled with: TOPMARK NEO, TOPMARK LASER, BLUEMARK ID COLOR, BLUEMARK ID, BLUEMARK CLED, THERMOMARK PRIME, THERMOMARK CARD 2.0, THERMOMARK CARD, mounting type: snapped, for terminal block width: 8.2 mm, lettering field size: 7.4 x 4.7 mm, Number of individual labels: 42

BTFE 6-3/14 4U - Test terminal strip

1029251

<https://www.phoenixcontact.com/us/products/1029251>



UCT-TMF 8 CUS - Marker for terminal blocks

0829672

<https://www.phoenixcontact.com/us/products/0829672>



Marker for terminal blocks, can be ordered: by sheet, white, labeled according to customer specifications, mounting type: snap into flat marker groove, for terminal block width: 8.2 mm, lettering field size: 7.4 x 4.7 mm, Number of individual labels: 42

Phoenix Contact 2023 © - all rights reserved

<https://www.phoenixcontact.com>

Phoenix Contact USA
586 Fulling Mill Road
Middletown, PA 17057, United States
(+717) 944-1300
info@phoenixcon.com