

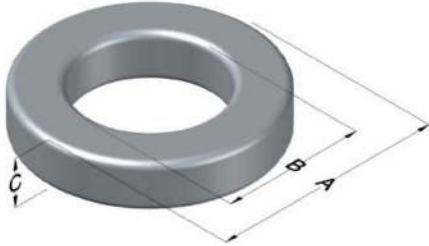

0077912A7

110 Delta Drive
 Pittsburgh, PA 15238
 NAFTA Sales: (1)800-245-3984
 HK Sales : (852)3102-9337
 magnetics@spang.com
 www.mag-inc.com



| Kool M μ Permeability (μ) | A _L (nH/T ²) | Core Marking | | | Coating Color |
|---|--|---------------|----------------|---------------------|------------------|
| | | Lot Number | Part Number | Inductance Grade | |
| 40 | 57 ± 8% | XXXXXX | 77912A7 | N/A | Black |

| Dimensions | Uncoated | | Coated Limits | | | Packaging |
|------------|----------|-------|---------------|-------|-----|---------------------------------------|
| | (mm) | (in) | (mm) | (in) | | |
| OD (A) | 77.80 | 3.063 | 78.94 | 3.108 | max | Cardboard cut-outs Box Qty= 40 pcs |
| ID (B) | 49.23 | 1.938 | 48.21 | 1.898 | min | |
| HT (C) | 15.88 | 0.625 | 17.02 | 0.670 | max | |

| Electrical Characteristics | | | Physical Characteristics | | | | | | |
|--|---------------------------|-----|--|-------------------------------|---|---|---------------------------------------|---|---------------|
| Watt Loss @ 100 kHz, 100mT max (mW/cm ³) | DC Bias min (oersteds) | | Voltage Breakdown wire to wire min (V _{AC}) | Break Strength min (kg) | Window Area W _A (mm ²) | Cross Section A _e (mm ²) | Path Length L _e (mm) | Volume V _e (mm ³) | Weight (g) |
| | 80% | 50% | | | | | | | |
| 900 | 58.5 | 133 | 3000 | 141.0 | 1,820 | 221 | 196 | 43,400 | 220 |

| Winding Information | | | | | Temperature Rating | |
|---|------|-------------------|------|---------------------------------|--------------------|-------------------|
| Winding Length Per Turn | | | | Wound Coil Dimensions (mm) | | Curie Temp: 500°C |
| Winding Factor | (mm) | Winding Factor | (mm) | 40% Winding Factor | OD | 86.6 |
| | | | | | HT | 32.3 |
| 0% | 64.8 | 40% | 89.2 | Completely Full Window | Max OD | 112 |
| 20% | 77.3 | 45% | 93.2 | | Max HT | 57.7 |
| 25% | 80.1 | 50% | 97.0 | Surface Area (mm ²) | | |
| 30% | 83.1 | 60% | 104 | Unwound Core | | 13,000 |
| 35% | 86.5 | 70% | 113 | 40% Winding Factor | | 24,000 |
| Notes: | | | | | | |
| Coating Temp (Continuous up to): 200°C | | | | | | |

Typical DC Bias Performance

