

REVISIONS			
REV	DESCRIPTION, ECN, EAR NO.	DATE	APP'D
A	PROPOSAL	OCT 08/14	L.CHAN

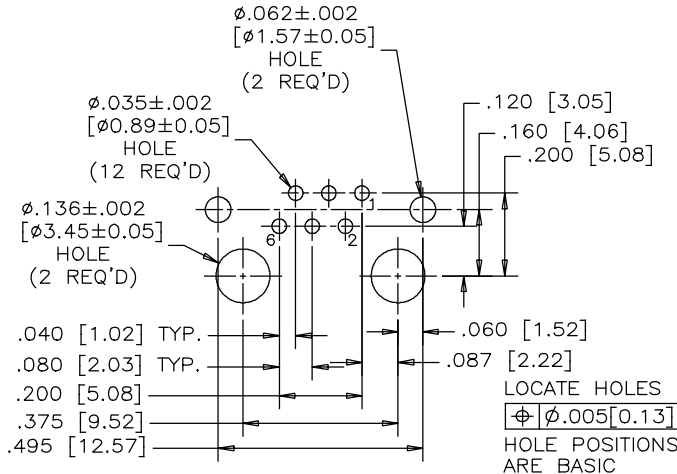

RECOMMENDED P.C.B. LAYOUT  
(COMPONENT SIDE OF BOARD)

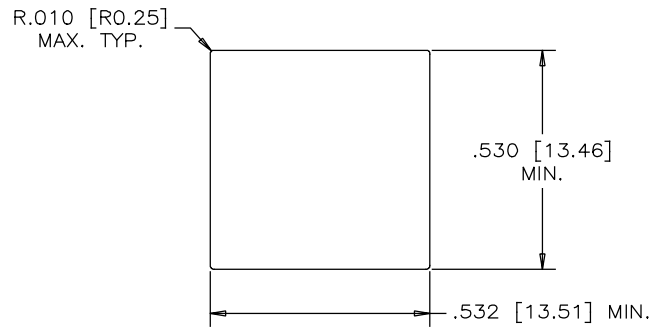

RECOMMENDED PANEL CUTOUT

**MATERIALS:**

- PLASTIC HOUSING: HIGH TEMPERATURE RESISTANT NYLON  
UL FLAMMABILITY RATING 94V-0.  
SOLDER REFLOW PROCESS COMPATIBLE.
- CONTACTS: PHOSPHOR BRONZE
- CONTACT PLATING: GOLD PLATED REFER TO PART NUMBER  
ON MATING SURFACES  
50 MICROINCHES [1.27 MICRONS] MINIMUM NICKEL  
UNDERPLATE  
100 MICROINCHES [2.54 MICRONS] MATTE TIN  
ON CONTACT TAILS.
- SHIELD: COPPER ALLOY; NICKEL PLATED WITH TIN  
DIPPED PCB TAILS.
- RECOMMENDED SOLDERING TEMPERATURE:  
WAVE SOLDERING OR REFLOW SOLDERING AT 260°C  
MAXIMUM FOR 5 SEC MAXIMUM

PART NUMBER: RJE01-X62-01

- GOLD PLATING
- 1 = 6 μ"
  - 6 = 50 μ"
  - G = 15 μ"
  - J = 30 μ"

UNLESS SPECIFIED OTHERWISE	DRAWN <i>Frank W</i>	DATE <i>0ct 08/14</i>	Amphenol Canada Corp. www.amphenolcanada.com
PRIMARY UNITS INCH	CHECKED <i>Lawrence C</i>	DATE <i>oct 08/14</i>	
SECONDARY MILLIMETERS	M.E. APP'D		TITLE HIGH SPEED MODULAR JACK, 1 PORT, 6 POSITION, 6 CONTACTS, SHIELDED WITH SIDE TABS—RoHS COMPLIANT
REFERENCE IN PARENTHESSES	Q.A. APP'D		DWG. NO. P-RJE01-X62-01
GENERAL TOLERANCES	DWG APPR.		REV A
1 DECIMAL PLACE ±0.025	ENG. REL. NO.		CODE ID NO. 03554 DWG SIZE: C SCALE: N/A SHEET 1 OF 1
2 DECIMAL PLACES ±0.020	REF.		
3 DECIMAL PLACES ±0.015	THIRD ANGLE PROJECTION	DO NOT SCALE DRAWING	
ANGULAR DEGREES ±1.0°			

THIS DOCUMENT CONTAINS PROPRIETARY INFORMATION AND SUCH INFORMATION MAY NOT BE DISCLOSED TO OTHERS FOR ANY PURPOSE OR USED FOR MANUFACTURING PURPOSES WITHOUT WRITTEN PERMISSION FROM AMPHENOL CANADA CORP.