

SECTION A-A
SCALE 4:1

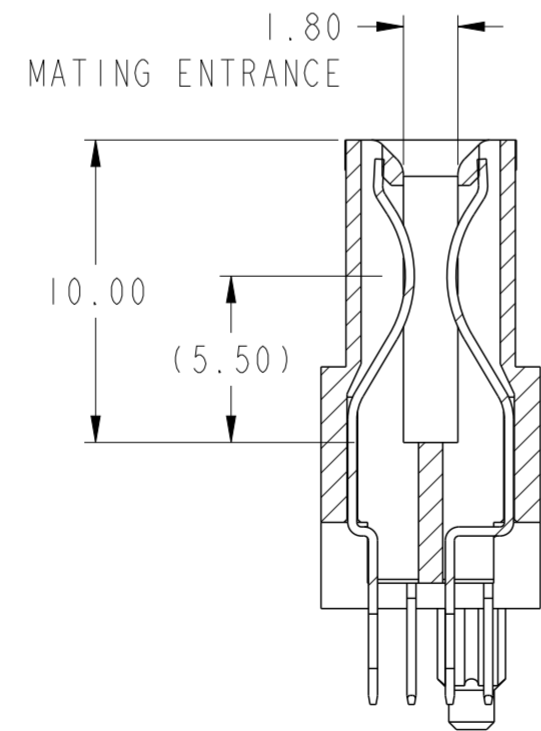

SECTION B-B
SCALE 4:1

| | | | | | | | | | | |
|---------------------------------------|---------------------|------|------------|------------|--|----------|------------------------|----------------|-----------|----------|
| spec ref | - | dr | De-Ming Lu | 2014/02/24 | projection | MM | size | A2 | scale | 4:1 |
| tolerance std | ISO 406 ISO 1101 | eng | Sunny2 Liu | 2016/05/06 | | | ecn no | ELX-DG-24036-1 | rel level | Released |
| TOLERANCES UNLESS OTHERWISE SPECIFIED | | chr | Terris Liu | 2016/05/20 | | | | | | |
| surface | linear | 0.X | ±0.5 | | VERT RECT 12P+16S HIGH POWER CARD EDGE | cat. no. | Product - Customer Drw | sheet 1 of 4 | rev C | |
| | | 0.XX | ±0.25 | | | | | | | |
| | angular | 0° | ±2° | | | | | | | |

| CONTACT TYPE | TOP LAYER DESCRIPTION | TABLE 1 (HPCE / SOLDER TAILS) PLATED THROUGH-HOLE REQUIREMENTS | | | | |
|----------------|-----------------------|---|------------------|--------------------|---------------|------------------------|
| | | DRILLED HOLE DIAMETER | COPPER THICKNESS | TIN-LEAD THICKNESS | TIN THICKNESS | FINISHED HOLE DIAMETER |
| POWER & SIGNAL | TIN-LEAD | 1.10-1.16 (1.15 DRILL) | 0.025 - 0.050 | 0.005 - 0.015 | -- | 0.94 - 1.10 |
| | IMMERSION TIN | 1.10-1.16 (1.15 DRILL) | 0.025 - 0.050 | -- | 0.9 - 1.5um | 0.94 - 1.10 |
| | COPPER (SEE NOTE 8) | 1.10-1.16 (1.15 DRILL) | 0.025 - 0.050 | -- | -- | 0.94 - 1.10 |

| CONTACT TYPE | TOP LAYER DESCRIPTION | TABLE 2 (HPCE / PRESS-FIT TAILS) PLATED THROUGH-HOLE REQUIREMENTS | | | | |
|----------------|-----------------------|--|------------------|--------------------|---------------|------------------------|
| | | DRILLED HOLE DIAMETER | COPPER THICKNESS | TIN-LEAD THICKNESS | TIN THICKNESS | FINISHED HOLE DIAMETER |
| POWER & SIGNAL | TIN-LEAD | 0.81-0.86 (0.85 DRILL) | 0.025 - 0.050 | 0.005 - 0.015 | -- | 0.65 - 0.80 |
| | IMMERSION TIN | 0.81-0.86 (0.85 DRILL) | 0.025 - 0.050 | -- | 0.9 - 1.5um | 0.70 - 0.80 |
| | COPPER (SEE NOTE 8) | 0.81-0.86 (0.85 DRILL) | 0.025 - 0.050 | -- | -- | 0.70 - 0.80 |

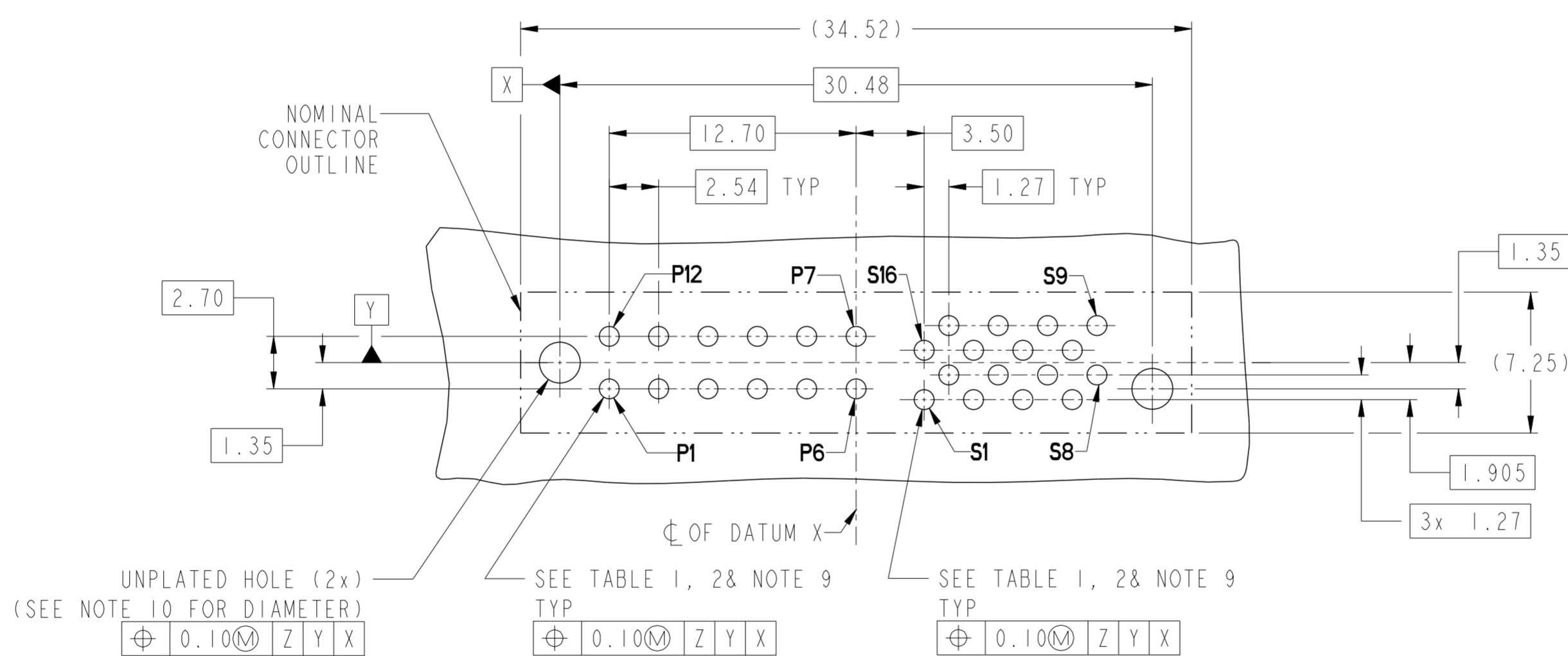

| | | | | | | | | | | |
|---------------------------------------|---------------------|--------------|------------|---|------------|----------|------------------------|----------------|--------------|---------|
| spec ref | - | dr | De-Ming Lu | 2014/02/24 | projection | MM | size | A2 | scale | 4:1 |
| tolerance std | ISO 406 ISO 1101 | eng | Sunny2 Liu | 2016/05/06 | | | ecn no | ELX-DG-24036-1 | | |
| TOLERANCES UNLESS OTHERWISE SPECIFIED | | chr | Terris Liu | 2016/05/20 | | | rel level | Released | | |
| surface | linear | 0.X | ±0.5 | 0.XX | | | ±0.25 | 0.XXX | ±0.10 | angular |
| ISO 1302 | | Amphenol FCI | | VERT RECT 12P+16S HIGH POWER CARD EDGE | | cat. no. | Product - Customer Drw | | sheet 2 of 4 | |

PDS: Rev :C

STATUS:Released

Printed: May 24, 2016

Amphenol FCI

© 2016 APCI

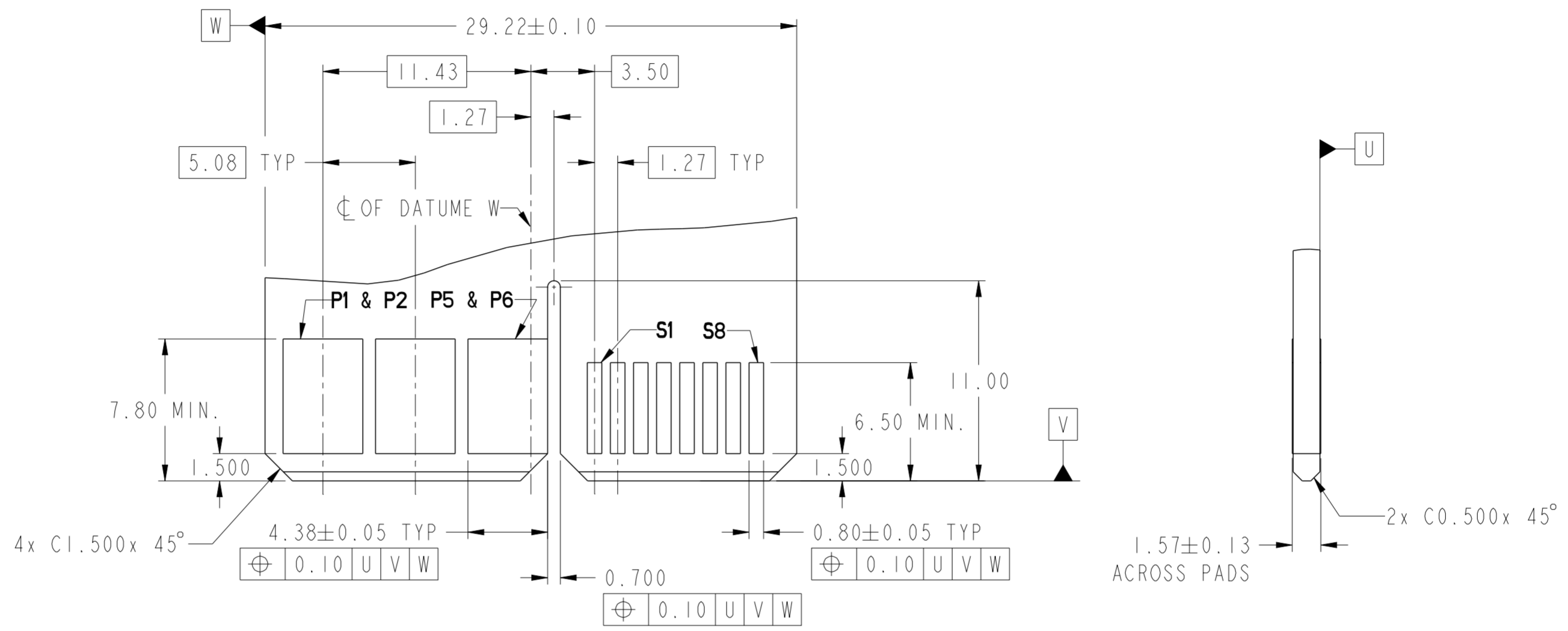

Amphenol
FCi

© 2016 AFci

| | | | | | | | | | | |
|---------------------------------------|---------------------------------------|-----------------|----------------|------------|------------|-------------|------------------------|-----------------|--------------|-----------------------|
| spec ref | - | dr | De-Ming Lu | 2014/02/24 | projection | MM | size | A2 | scale | 4:1 |
| tolerance std | ISO 406 ISO 1101 | eng | Sunny2 Liu | 2016/05/06 | | | ecn no | ELX-DG-24036-1 | rel level | Released |
| TOLERANCES UNLESS OTHERWISE SPECIFIED | | chr | Terris Liu | 2016/05/20 | | | | | | |
| surface | ISO 1302 | appr | Pai-Ming Zheng | 2016/05/24 | | | Product - Customer Drw | | sheet 3 of 4 | |
| linear | 0.X ±0.5 0.XX ±0.25 0.XXX ±0.10 | Amphenol FCi | | cat. no. | | PDS: Rev :C | | STATUS:Released | | Printed: May 24, 2016 |
| angular | 0° ±2° | | | | | | | | | |

HPCE PART NUMBER (TABLE 3)

| PART NUMBER | TAIL TYPE | ORIENTATION KEY | DIM "A" TYPICAL TAIL LENGTH | DIM "B" RECOMMENDED BOARD THICKNESS |
|----------------|-----------|-----------------|-----------------------------|-------------------------------------|
| 10129175-001LF | SOLDER | YES | 3.17 ± 0.25 | 1.59 - 2.38 |
| 10129175-002LF | SOLDER | NO | | |
| 10129175-003LF | PRESS-FIT | YES | 3.17 ± 0.25 | 1.57 MIN |
| 10129175-004LF | PRESS-FIT | NO | | |

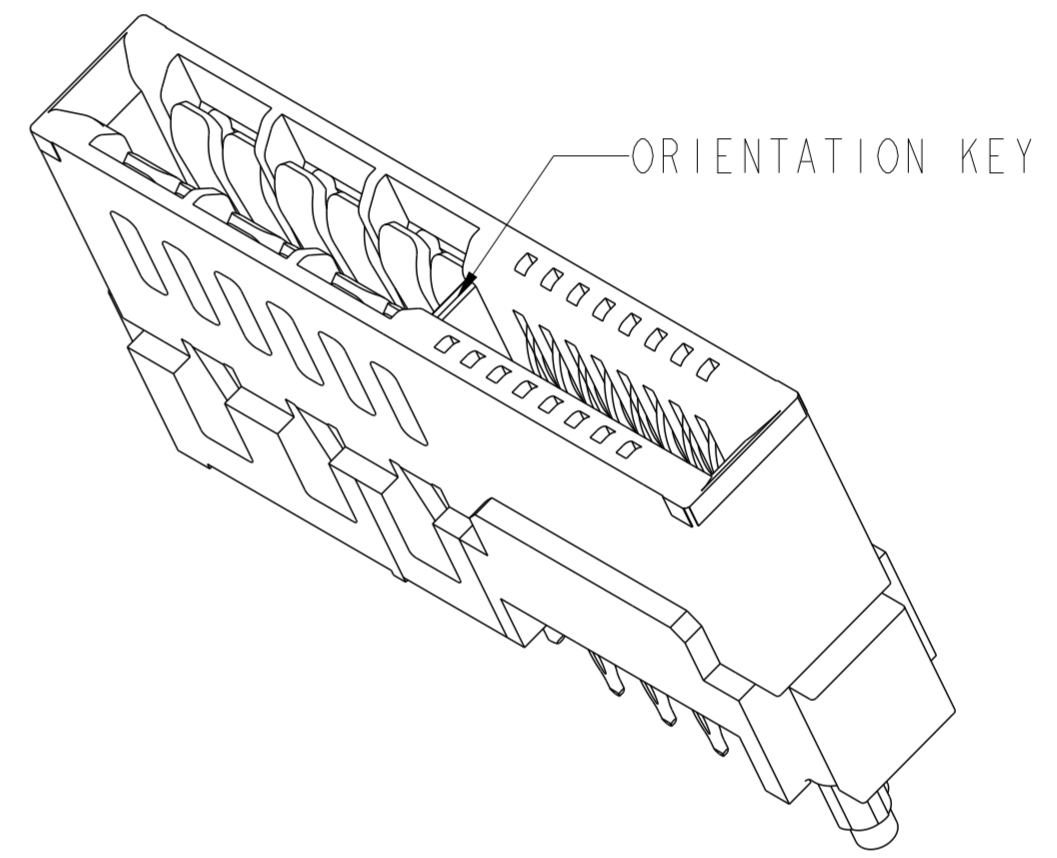

NOTES:

- CONNECTOR MATERIALS:
 HOUSING: HIGH TEMPERATURE THERMAL PLASTIC, BLACK
 UL 94V-0 COMPLIANT
 CONTACTS: HIGH PERFORMANCE COPPER ALLOY.
- CONTACT FINISH REF. GS-12-604 SECTION 5.2.
- PRODUCT SPECIFICATION: GS-12-604.
- APPLICATION SPECIFICATION: GS-20-128.
5. PRODUCT MARKING ON HOUSING IN AREA SHOWN MEETS AFCI SPECIFICATION: GS-24-007.
- PACKAGING MEETS FCI SPECIFICATION GS-14-937.
- HOUSING COMPONENT WILL WITHSTAND EXPOSURE TO 260°C PEAK TEMPERATURE FOR 60 SECONDS IN A CONVECTION, INFRA-RED, OR VAPOR PHASE REFLOW OVEN.
8. COPPER PLATING THICKNESS IN CENTER OF VIA-HOLE CAN BE NO MORE THAN 0.003 LESS THAN OTHER AREAS.
9. ALL HOLE SIZES ARE FINISHED HOLE SIZES.
10. MOUNTING HOLES ARE UNPLATED
 Ø 2.40 +/- 0.1 FOR PRESS-FIT TAILS
 Ø 2.10 +/- 0.1 FOR SOLDER TAILS
- PRESS FIT APPLICATION TOOL DRAWING : 10119453.
- A SYMBOL WILL BE NEXT TO ANY DIMENSION, VIEW, OR NOTE WHICH HAS BEEN MODIFIED WITH THE CURRENT DRAWING REVISION.

Amphenol FCI

© 2016 AFCI

| | | | | | | | | | | | |
|---------------------------------------|---------------------|------|----------------|------------|----------------|----------------------|-----------|------------------------|----------|--------------|---|
| spec ref | - | dr | De-Ming Lu | 2014/02/24 | projection | MM | size | A2 | scale | 4:1 | |
| tolerance std | ISO 406 ISO 1101 | eng | Sunny2 Liu | 2016/05/06 | | ←→ | ecn no | ELX-DG-24036-1 | | | |
| TOLERANCES UNLESS OTHERWISE SPECIFIED | | chr | Terris Liu | 2016/05/20 | | | rel level | Released | | | |
| surface | linear | appr | Pei-Ming Zheng | 2016/05/24 | product family | VERT RECT 12P+16S | | cat. no. | 10129175 | rev | C |
| | angular | | | | | HIGH POWER CARD EDGE | | Product - Customer Drw | | sheet 4 of 4 | |

PDS: Rev :C

STATUS:Released

Printed: May 24, 2016