

STANDARD EXECUTIONS

Butt-welded hub.

- **VCM-SST**: H7 reamed blind hole or threaded blind hole, AISI 304 stainless steel, sandblasted matte finish.
- **VCM-SST-A4**: H7 reamed blind hole or threaded blind hole, AISI 316L stainless steel, sandblasted matte finish.
- **VCM-SST-p**: threaded pin, AISI 304 stainless steel, sandblasted matte finish.
- **VCM-SST-A4-p**: threaded pin, AISI 316L stainless steel, sandblasted matte finish.



ELESA Original design

VCM-SST  
VCM-SST-A4

VCM-SST-p  
VCM-SST-A4-p

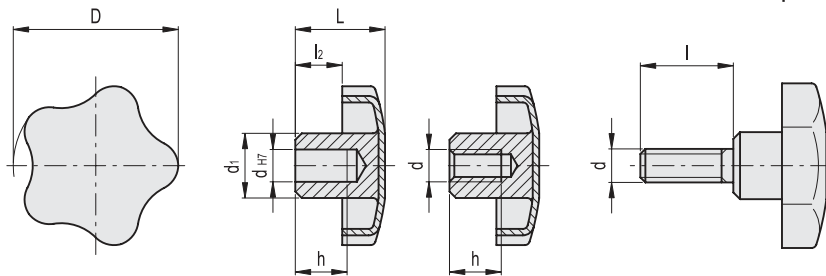

Conversion Table 1 mm = 0.039 inch	
D	
mm	inch
40	1.57
50	1.97
60	2.36

VCM-SST

INOX STAINLESS STEEL METRIC

Code	Description	D	d	dH7	L	d1	l2	hmin.	Δ
169541	VCM-SST-40-8	40	-	8	24	14	12	15	36
169542	VCM-SST-40-M8	40	M8	-	24	14	12	15	37
169546	VCM-SST-50-10	50	-	10	31	18	17.5	18	63
169547	VCM-SST-50-M10	50	M10	-	31	18	17.5	18	65
169551	VCM-SST-60-12	60	-	12	39	20	21	22	105
169552	VCM-SST-60-M12	60	M12	-	39	20	21	22	107

VCM-SST-A4

INOX STAINLESS STEEL METRIC

Code	Description	D	d	dH7	L	d1	l2	hmin.	Δ
169543	VCM-SST-A4-40-8	40	-	8	24	14	12	15	37
169544	VCM-SST-A4-40-M8	40	M8	-	24	14	12	15	37
169548	VCM-SST-A4-50-10	50	-	10	30	18	16.5	18	67
169549	VCM-SST-A4-50-M10	50	M10	-	30	18	16.5	18	68
169553	VCM-SST-A4-60-12	60	-	12	37.5	20	20	22	109
169554	VCM-SST-A4-60-M12	60	M12	-	37.5	20	20	22	114

VCM-SST-p

INOX STAINLESS STEEL METRIC

Code	Description	D	d	L	d1	l	l2	Δ
169561	VCM-SST-40-p-M8x20	40	M8	24	14	20	12	50
169562	VCM-SST-40-p-M8x30	40	M8	24	14	30	12	55
169563	VCM-SST-40-p-M8x40	40	M8	24	14	40	12	56
169571	VCM-SST-50-p-M10x20	50	M10	30	18	20	16.5	95
169572	VCM-SST-50-p-M10x30	50	M10	30	18	30	16.5	97
169573	VCM-SST-50-p-M10x40	50	M10	30	18	40	16.5	100
169580	VCM-SST-60-p-M12x20	60	M12	37.5	20	20	20	150
169581	VCM-SST-60-p-M12x30	60	M12	37.5	20	30	20	155
169582	VCM-SST-60-p-M12x40	60	M12	37.5	20	40	20	162
169583	VCM-SST-60-p-M12x50	60	M12	37.5	20	50	20	169

VCM-SST-A4-p

INOX STAINLESS STEEL METRIC

Code	Description	D	d	L	d1	l	l2	Δ
169566	VCM-SST-A4-40-p-M8x20	40	M8	24	14	20	12	50
169567	VCM-SST-A4-40-p-M8x30	40	M8	24	14	30	12	55
169568	VCM-SST-A4-40-p-M8x40	40	M8	24	14	40	12	56
169576	VCM-SST-A4-50-p-M10x20	50	M10	30	18	20	16.5	95
169577	VCM-SST-A4-50-p-M10x30	50	M10	30	18	30	16.5	97
169578	VCM-SST-A4-50-p-M10x40	50	M10	30	18	40	16.5	100
169586	VCM-SST-A4-60-p-M12x20	60	M12	37.5	20	20	20	150
169587	VCM-SST-A4-60-p-M12x30	60	M12	37.5	20	30	20	155
169588	VCM-SST-A4-60-p-M12x40	60	M12	37.5	20	40	20	162
169589	VCM-SST-A4-60-p-M12x50	60	M12	37.5	21	50	20	169

